

# Govee | Quick Start Guide

## What You Get

- Every H7078 package includes the following:

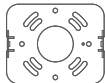
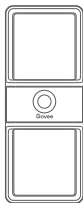

X1



X3



X3



X6



X6

## What You Need

- Prepare the following tools before installing:

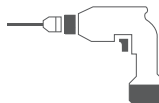

## Safety Instructions

- For your safety, this product must be installed in accordance with local building laws. Consult or engage a registered and qualified electrician to install it for you. If you are installing this product yourself, make sure you notify your local government building control authority to inspect and test your installation.
- Never take risks with electrical safety. Before you start any type of electrical work, make sure the environment is absolutely safe.
- Place the light away from children to avoid dangers resulting from improper operation.
- This product is rated as IP65 Waterproof. It can be used outdoors but cannot be immersed in water.
- During installation, avoid scratching the light cover which might affect the lighting effects.

# Installing Your Device

- 1 Cut off the power where you plan to install the light.
- 2 Use an electric tester pen or voltmeter to test the circuit. Make sure there is no power before operating.

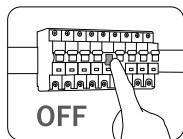

■ Phase wire  
□ Neutral Wire  
■ Ground Wire



- 4 Wire the wall light. The phase wire is black, the neutral wire is white, and the ground wire is bare.  
Note:  
1. Enwind the ground wire to the screw and firmly fix the screw into the specified screw hole.  
2. Make sure the twist-on wire connector is firmly screwed and will not fall.

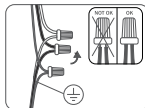
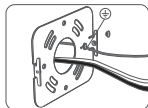

- 6 Make sure the light is in place and then use screws to fix the wall light on both sides.
- 7 Use the sealant to caulk around the wall light.  
Note: This operation is designed to prevent the terminals from being exposed to rainwater.

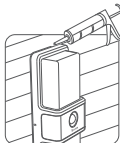
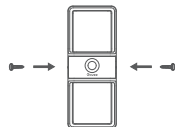

- 3 Install the backplate horizontally.

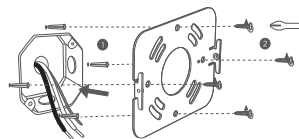

- 5 Align the wall light with the backplate from above and slide down to attach it to the backplate. Please note that the light cover part should point towards the ground.



- 8 Power on and enjoy your light!

