

H61A8英文说明书

版本:1.0

料号:807-0003-00466

折叠尺寸:75×105(mm)

展开尺寸:525×105(mm)

材质:80G书页纸

工艺:单色印刷

折叠方式:风琴页

页数:14页

Safety Instructions

Read and follow all the safety instructions:

● Please note that the neon light and the control box are rated as IP67 waterproof and the adapter is rated as IP65 waterproof.

● You can use the ground plug and mounting clips to install the neon light. Please be safe when using it and keep it away from children.

● Even though the control box and the adapter are waterproof, it is recommended to place them in a location where they will not encounter water when in use to prolong their lifespan.

● Use the product with the provided power adapter only.

● Keep the product away from sharp objects or strong corrosive chemicals.

● Although this product has good bending performance, when bending the neon rope light, please try not to fix the buckle too close and bend it too large, so as not to damage the light beads and then affect the life span.

● Do not install the neon rope light near any heat sources.

● Do not allow children to install the neon rope light alone.

● Avoid installing the neon rope light near potentially dangerous sources (e.g., candles, liquid-filled objects).

● Unroll the neon rope lights before powering them on.

● In the case of only using adhesive to fix the buckle, if you want to get the maximum adhesion, it is suggested that you wait for a period of time to install the neon rope light after fixing the buckle.

● It is recommended that this product should not be stuck to the back of TV and display.

Introduction

Thanks for choosing the Govee RGBIC Outdoor Neon Rope Light. This product is equipped with a 10m RGBIC neon rope light and supports app, voice (Alexa/Google Assistant). RGBIC is Govee's latest lighting display technology. You can give free rein to your imagination and create your own unique neon rope light curve.

What You Get

LED Neon Rope Lights	1
Adapter	1
User Manual	1
Service Card	1

At a Glance

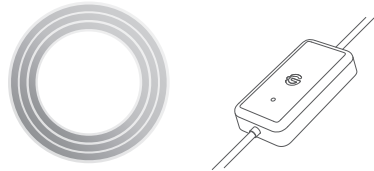

Installing Your Device

Before You Install

① Unpack the box and check all items listed in the packing list.

② Power on the neon rope light and check whether it lights up.

Installing Steps

①

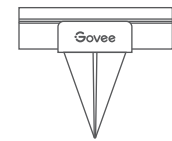

②

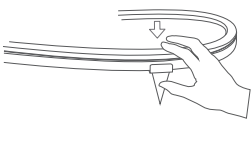

③ Note: It is recommended to install the light with the provided mounting clips and screws for places such as railings.

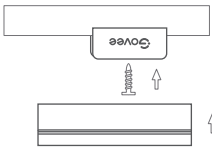

④ Note: Tighten the screw to prevent water from entering the product when installing.



Pairing Your Device with the Govee Home App

What You Need

● A Wi-Fi router supporting the 2.4GHz and 802.11 b/g/n bands. 5GHz is not supported.

● A smartphone or tablet running iOS or Android.

Pairing Instructions

① Download the Govee Home app from the App Store (iOS devices) or Google Play (Android devices).

② Turn on Bluetooth on your smartphone.

③ Open the app, tap the “+” icon in the top right corner and search for “H61A8”.

④ Tap the device icon and follow the on-screen instructions to complete pairing.



Controlling the Device with Your Voice

① Open the app, then tap the device icon to enter detail page.

② Tap the setting icon in the top right corner.

③ Select Using Guidance and follow on-screen instructions to control the device using your voice.

Specifications

Length	10m/32.8ft
Light Displaying Technology	RGBIC
Waterproof	Strip Light:IP67 Control Box:IP67 Adapter:IP65
Control Method	App, Control Box, Voice Control
Power Input (Light)	24VDC 3A



Govee Home App

For FAQs and more information, please visit: [www.govee.com](http://www.govee.com)

## Troubleshooting

### ❶ The adhesive tape is not strong enough.

- Make sure the installation surface is clean and dry.
- Firmly press over the strip after sticking.
- Reinforce the installation via more clips and tape.

### ❷ Cannot connect to Bluetooth.

- Do not skip Bluetooth connection in the app.
- Ensure Bluetooth on your smartphone has been turned on.
- Your smartphone may be incompatible with the Govee Home app. Try using a different smartphone then reconnect.
- Power the neon rope lights and your smartphone Bluetooth off then on, then try again.
- Ensure that your smartphone is within 1m/3.28ft of the neon rope lights when connecting.
- Clear any obstructions that are between the neon rope lights and your smartphone.

### ❸ The neon rope lights does not display the full selected color/Some LED beads do not light up.

- Please contact the Govee support team for rapid product replacement.

### ❹ Cannot sync the neon rope lights to the beat of my music.

- Move the control box closer to the music source.
- Clean the mic on the control box then try again.

### ❺ Cannot connect to Wi-Fi.

- Do not skip the Wi-Fi connecting steps in the app.
- 5GHz network is not supported. Please set the router to 2.4GHz and then reset it.
- Connect your phone to Wi-Fi and check whether the network works well.
- Make sure you have entered the correct Wi-Fi name and password.
- Change your Wi-Fi password to a brief one. 8 numbers and letters are suggested.
- Connect hotspot in your phone to the neon rope lights and check whether the router works with the neon rope lights.

### ❻ Cannot connect to Alexa.

- Pull out every connective part of the neon rope lights and firmly re-connect them.
- Re-connect your phone to Wi-Fi.
- Plug out the adapter port and re-plug it in.

## FCC and ISED Canada Statement

This device complies with Part 15 of the FCC Rules and Industry Canada licence-exempt RSS standard(s). Operation is subject to the following two conditions:

- (1) This device may not cause harmful interference, and
- (2) This device must accept any interference received, including interference that may cause undesired operation.

Warning: Changes or modifications not expressly approved by the party responsible for compliance could void the user's authority to operate the equipment.

Le présent appareil est conforme aux CNR d'Industrie Canada applicables aux appareils radio exempts de licence. L'exploitation est autorisée aux deux conditions suivantes :

(1) l'appareil n' doit pas produire de brouillage, et

(2) l'utilisateur de l'appareil doit accepter tout brouillage radioélectrique subi, même si le brouillage est susceptible d'en compromettre le fonctionnement.

NOTE: This equipment has been tested and found to comply with the limits for a Class B digital device, pursuant to Part 15 of the FCC Rules.

These limits are designed to provide reasonable protection against harmful interference in a residential installation. This equipment generates uses and can radiate radio frequency energy and, if not installed and used in accordance with the instructions, may cause harmful interference to radio communications. However, there is no guarantee that interference will not occur in a particular installation. If this equipment does cause harmful interference to radio or television reception, which can be determined by turning the equipment off and on, the user is encouraged to try to correct the interference by one or more of the following measures:

1. Reorient or relocate the receiving antenna.

2. Increase the separation between the equipment and receiver.

3. Connect the equipment into an outlet on a circuit different from that to which the receiver is connected.

4. Consult the dealer or an experienced radio/TV technician for help.

This Class B digital apparatus complies with Canadian ICES-005. Cet appareil numérique de la classe B est conforme à la norme NMB-005 du Canada.

## FCC and IC Radiation Exposure Statement

This equipment complies with FCC and IC radiation exposure limits set forth for an uncontrolled environment. This equipment should be installed and operated with minimum distance 20cm between the radiator & your body.

la distance entre l'utilisation et l'appareil ne doit pas être inférieure à 20 cm.

This device uses a non-replaceable light source. When the light source reaches the end of its life cycle, this device should be replaced. Not intended for illumination. Only used for creating ambiance.

- 1.Do not connect the rope light to the supply while it is in the packing or wound onto a reel;
- 2.Do not use the rope light when covered or recessed into a surface;
- 3.Do not open or cut the rope light;

The Bluetooth® word mark and logos are registered trademarks owned by Bluetooth SIG, Inc. and any use of such marks by Shenzhen Intellirocks Tech. Co., Ltd. is under license.

### Responsible party :

Name: GOVEE MOMENTS(US) TRADING LIMITED  
Address: 13013 WESTERN AVE STE 5 BLUE ISLAND IL 60406-2448  
Email: support@govee.com  
Contact information: <https://www.govee.com/support>

Govee is a trademark of Shenzhen Intellirocks Tech. Co.,Ltd.  
Copyright ©2021 Shenzhen Intellirocks Tech. Co.,Ltd.  
All Rights Reserved.



FOR INDOOR USE ONLY  
POUR UNE UTILISATION EN INTÉRIEUR UNIQUEMENT

## Customer Service

🛡️ Warranty: 12-Month Limited Warranty

🔧 Support: Lifetime Technical Support

✉️ Email: support@govee.com

🌐 Official Website: [www.govee.com](http://www.govee.com)

📺 @Govee    📷 @govee\_official    📺 @govee.official

🐦 @Goveeofficial    📘 @Govee.smarthome



# User Manual

Model: H61A8

RGBIC Outdoor Neon Rope Light