

H601C 英文说明书

版本:1.0

料号:

成型尺寸:75x105mm

材质:80G书页纸

工艺:单色印刷

折叠方式:风琴页

页数:14页

Safety Instructions

Read and follow all the safety instructions:

- The downlight is not waterproof. Avoid exposing it to splashes or water drops.
- The operating temperature should be within -10°C to 40°C (14°F to 104°F).
- The downlight internal light source is unfixable. If it breaks, the entire downlight must be replaced.
- Do not allow children to install the downlight.
- External dimmers cannot be used with this product.
- Installation and maintenance should be operated by a professional.
- Avoid installing the downlight near heat sources or damp locations.
- Avoid installing the downlight near potentially dangerous sources (e.g., candles, liquid-filled objects).

At a Glance

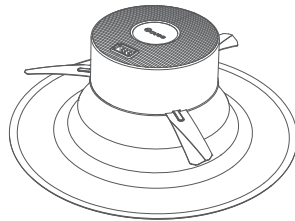

Thanks for choosing Govee Smart LED Downlight. This product can be quickly connected to your smartphone in just a few steps. You can change its color, set timers, and DIY your own lighting scenes.

Specifications

Working Voltage	AC 120V
Power	13W
Lumen	1000lm
Color Temperature	2700K-6500K
Color	RGBWW

Installing Your Device

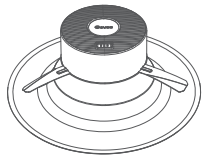

Downlight



Wire terminals

Installation Steps:

- Disconnect the main power switch of the device before installation.
- Screw the E26 adapter into the E26 base.

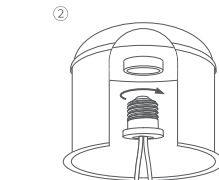
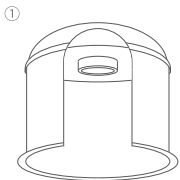

- Plug the orange connector into the downlight.
- Push the downlight into the metal housing.

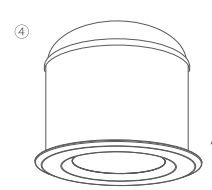
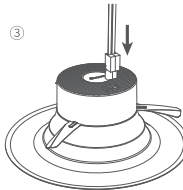

- After completing the above steps, power on and enjoy the light.

Note: If there is an orange connector inside the metal housing, plug it into the downlight and push the downlight into the housing to complete installation.

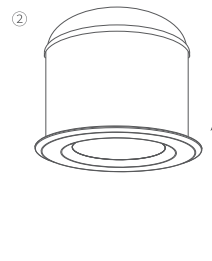
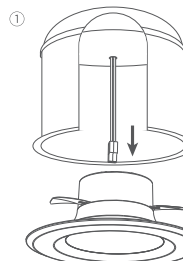

Pairing Your Downlight with Govee Home App

What You Need:

- A Wi-Fi router supporting the 2.4GHz and 802.11 b/g/n bands. 5GHz is not supported.
- A smartphone or tablet running iOS 8.0 (or above) or Android 4.3 (or above).



- Download the Govee Home App from the App Store (iOS devices) or Google Play (Android devices).
- Turn on the Bluetooth in your smartphone.
- Open the app, tap "+" icon in the top right corner and search "H601C".
- Tap the device icon and follow the on-screen instructions to complete pairing.

Controlling the Downlight with Your Voice

- Open the Govee Home App, then tap the device icon to enter the details page.
- Tap the "setting" icon ⚙️ in the top right corner.
- Select "Using Guidance" and follow the on-screen instructions to begin using voice control.



Govee Home App

For FAQs and more information, please visit: www.govee.com

Troubleshooting

❶ Cannot connect the downlight to Govee Home.

- Check whether the downlight is powered on.

- Check whether your smartphone Wi-Fi is enabled. Please make sure Wi-Fi connected to your phone is 2.4GHz (5GHz brand is not supported).

- Make sure your smartphone is close to the device when connecting for the first time.

- Check if you have entered the correct Wi-Fi password during Wi-Fi setup.

- Make sure the distance between the bulb and router is less than 50ft.

- Check whether the home network is stable by connecting downlight to another phone's hotspot.

❷ The downlight lost connection.

- Check whether the device is powered on.

- Check whether your home network is stable.

- Check if there are too many devices connected to the router by connecting downlight to another phone's hotspot.

- Ensure the distance between the smartphone and the device does not exceed 50ft.

- Delete downlight connected in "My Devices" and reconnect the downlight to Wi-Fi following on-screen instructions.

❸ Can I group multiple Govee devices together?

- Yes, you can group multiple downlights and other govee devices by Schemes, Same model, General (Wi-Fi or Bluetooth devices). It depends on the function of different devices.

❹ Can I use group control with voice assistance?

- Please make sure your device is connected to Wi-Fi before using voice assistance.

- Please set voice group control in Alexa/Google Assistant App.

❺ What is the maximum number of devices I can connect via Bluetooth?

- Typically, up to 6 devices can be connected devices may vary based on your smartphone brand.

❻ How many downlights can be connected to one phone?

- Up to 50 downlights can be connected to one phone if the network is normal.

Customer Service

🛡️ **Warranty:** 12-Month Limited Warranty

📞 **Support:** Lifetime Technical Support

✉️ **Email:** support@govee.com

🌐 **Official Website:** www.govee.com

📺 @Govee 📷 @govee_official 🎵 @govee.official

🐦 @Goveeofficial 📘 @Govee.smarthome

FCC and ISED Canada Statement

This device complies with Part 15 of the FCC Rules and Industry Canada licence-exempt RSS standard(s). Operation is subject to the following two conditions:

(1) This device may not cause harmful interference, and (2) This device must accept any interference received, including interference that may cause undesired operation.

Warning: Changes or modifications not expressly approved by the party responsible for compliance could void the user's authority to operate the equipment.

Le présent appareil est conforme aux CNR d'Industrie Canada applicables aux appareils radio exempts de licence.

L'exploitation est autorisée aux deux conditions suivantes :

(1) l'appareil ne doit pas produire de brouillage, et
(2) l'utilisateur de l'appareil doit accepter tout brouillage radioélectrique subi, même si le brouillage est susceptible d'en compromettre le fonctionnement.

NOTE: This equipment has been tested and found to comply with the limits for a Class B digital device, pursuant to Part 15 of the FCC Rules.

These limits are designed to provide reasonable protection against harmful interference in a residential installation. This equipment generates uses and can radiate radio frequency energy and, if not installed and used in accordance with the instructions, may cause harmful interference to radio communications. However, there is no guarantee that interference will not occur in a particular installation. If this equipment does cause harmful interference to radio or television reception, which can be determined by turning the equipment off and on, the user is encouraged to try to correct the interference by one or more of the following measures:

1. Reorient or relocate the receiving antenna.
2. Increase the separation between the equipment and receiver.
3. Connect the equipment into an outlet on a circuit different from that to which the receiver is connected.
4. Consult the dealer or an experienced radio/TV technician for help.

FCC Radiation Exposure Statement

This equipment complies with FCC and IC radiation exposure limits set forth for an uncontrolled environment. This equipment should be installed and operated with minimum distance 20cm between the radiator & your body.

Lors de l'utilisation du produit, maintenez une distance de 20 cm du corps afin de vous conformer aux exigences en matière d'exposition RF.

This Class B digital apparatus complies with Canadian ICES-005.

Cet appareil numérique de la classe B est conforme à la norme NMB-005 du Canada.

Responsible party (this contact information is only for FCC matters) :

Name: GOVEE MOMENTS(US) TRADING LIMITED
Address: 2501 Chatham Rd Suite R Springfield IL 62704
Email: certification@govee.com
Contact information: https://www.govee.com/support

The trademark Govee has been authorised to Shenzhen Qianyan Technology LTD.
Copyright ©2021 Shenzhen Qianyan Technology LTD.
All Rights Reserved.

SUITABLE FOR DAMP LOCATIONS
CONVIENT AUX EMPLACEMENTS HUMIDES

THIS DEVICE IS NOT INTENDED FOR USE WITH EMERGENCY EXITS
NE CONVIENT PAS AUX SORTIES DE SECOURS

SUITABLE FOR TYPE IC or-TYPE NON-IC
CONVIENT AUX TYPE IC or TYPE NON-IC.

USE ONLY RECESSED LUMINAIRE-WITH LAMP COMPARTMENT
DIMENSIONS 5.5 Inch/139.7 MM DIAMETER, 7.5 Inch/190.5 MM DEPTH
UTILISER-UNIQUEMENT APPAREIL À ENCASTRER AVEC LAMPE
DIMENSIONS DU COMPARTIMENT 5.5 Inch/139.7 MM DIAMETRE, 7.5 Inch/190.5 MM MM-PROFONDEUR

SUITABLE FOR OPERATION IN AMBIENT NOT EXCEEDING 40 °C
PEUT ÊTRE UTILISÉ À UNE TEMPÉRATURE AMBIANTE N'EXCÉDANT PAS 40 °C

This luminaire has been modified to operate LED lamps. Do not attempt to install or operate the originally intended lamps in this luminaire
Ce luminaire a été modifié pour faire fonctionner des lampes LED. N'essayez pas d'installer ou d'utiliser les lampes prévues à l'origine dans ce luminaire.



User Manual

Model: H601C
WiFi+Bluetooth RGBWW Downlight