

## Specification

Display: 5 digits LCD/LED

Capacity: 5-180kgs

Division: 1D=0.05Kg/0.11Lb

Unit: KG/LB

USB charging (According to your scale)

Overload Indication: "oL" scale overload, (Maximum weight capacity is indicated on the scale.) Please step off to avoid damage.

Low power indication: "Lo" If power is low. Please install new battery or charge the scale.

Error Indication: "Err" If the scale displays "Err" when you step on the scale, there is an error. Please re-test.

Best working temperature: 5-35 °C

Storage temperature: -10-60 °C

Moisture Environment: ≤90%RH

## Instruction for OKOK App

### Instantly weighing

Open the OKOK APP, it will remind you to switch on Bluetooth. Turn Bluetooth on and the auto-pair process completed automatically. User begin weighing, the weight data will be synchronizing to APP. If the Bluetooth disconnected, the weight data will be saved into memory of the scale, then synced to APP while the Bluetooth connected.

### Type weight data into APP

The user can type weight data into APP to keep a track

### Current weight

Current weight interface displays weight information of the user and family members, and generates the report and give health advice based on the measurement. Including current weight interface, weight list interface, date report and notice.

### Weight trend

Including weekly report, monthly report and quarterly report, indicating the changes of weight through curves.

**Notice** For fat scale, there are 8 data: weight, body fat, visceral fat, muscle, bone, BMR, age, BMI.

### Management of scale

Management of scale including two parts: scale management and connection management

#### Scale management

Manage the process of pairing, bind and unbind

#### Connection management

Including Bluetooth status indication and Bluetooth connection

### Account and user

Including account management and user management

#### Account Management

Including registration, login in, change password, forget password, links to Facebook, Twitter...etc

#### User management

Manage user information, including nickname, birthday, height, gender...etc, also managing family member account and information (under the same registration account).

## Warnings

1. Please keep the scale away from wet floor, don't use the scale if the glass is wet in case of slip.
2. Please stand on the middle of the scale in case of turnover.
3. The platform of the scale is made of glass, please avoid sharp or harsh things scratching the surface, excessive forces or sudden shocks, unexpected fallen-off will break the glass and injure the user.
4. The Bluetooth scale is not waterproof. Keep the surrounding environment dry, do not submerge it in water.
5. Use soft cloth with neutral cleaning liquids to clean the surface, keep away contacting with organic solvent nor chemicals.
6. When the batteries are in low power status, please remove the batteries in case of leaking liquids corrode the scale.

## Notices

1. Please stand on the scale in the right direction.
2. Please stand on the scale no less than 10 seconds if you measure body fat.
3. Please confirm gender, height, weight data is correct

# Bluetooth Smart Scale



## Step 1 Check required specification for Phone or Tablet

① Before installing OKOK App, kindly check if the phone or tablet meets following requirement:



Compatible with iOS7.0 and above with Bluetooth 4.0 and above

Phone 4s, iPhone 5, iPhone 5c, iPhone 5s  
iPhone 6, iPhone 6 Plus, iPod touch 5, iPad 3  
iPad 4, iPad Air, iPad Air 2, iPad mini  
iPad mini 2, iPad mini 3



Compatible with Android 4.3 and above with Bluetooth 4.0 and above

SAMSUNG: galaxy s5, galaxy s4, galaxy s3, galaxy note4, galaxy note3, galaxy note2, galaxy grand2  
XIAOMI: XIAOMI Note, XIAOMI4, XIAOMI3, XIAOMI2/2s, XIAOMI tablet, HONGMI Note 4G, HONGMI 1s  
HUAWEI: Ascend P8, Ascend P7, Honor 6Plus, Honor 6, mate7, Ascend G7

Support Android4.3 and above for selected Android devices with Bluetooth 4.0 and above

## Step 2 Install the batteries

If your scale is a USB one, please charge it before first using, attention to that not charging more than 2 hours. Meanwhile please use the Android charging line and the 5v constant current charger to charge it. If "Lo" is indicated, please stop using right now to charge it.



## Step 3 Install App

1/ Switch on Bluetooth

Let your devices to scan the QR code of the "OKOK Healthcare", then install the App; Or searching the "OKOK international form" in the App Store/ Google play to install it.



## Step 4 Pair the devices, register and complete user information

Open APP, begin to weigh and pair

Register as a user

Complete personal information

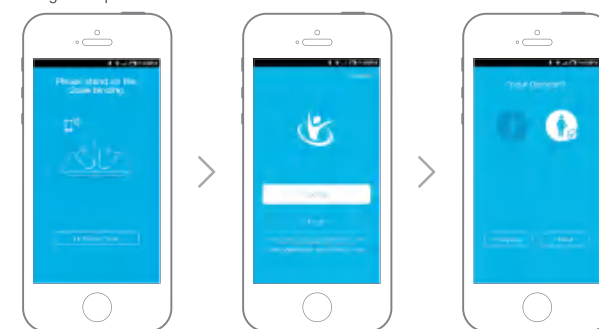

## Step 5 Weighing

Enter into "Dynamic Weight" interface



Stand on the scale and synchronize weight data onto APP



## Step 6 View the test result

Enter into "Weight Trend" interface



View test report

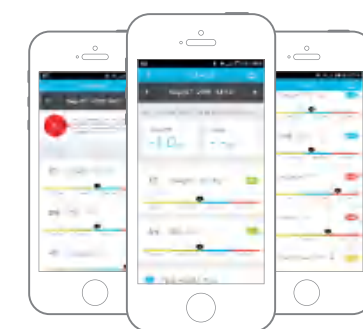

This device complies with Part 15 of the FCC Rules. Operation is subject to the following two conditions: (1) this device may not cause harmful interference, and (2) this device must accept any interference received, including interference that may cause undesired operation

NOTE: This equipment has been tested and found to comply with the limits for a Class B digital device, pursuant to Part 15 of the FCC Rules. These limits are designed to provide reasonable protection against harmful interference in a residential installation. This equipment generates, uses and can radiate radio frequency energy and, if not installed and used in accordance with the instructions, may cause harmful interference to radio communications. However, there is no guarantee that

interference will not occur in a particular installation.

If this equipment does cause harmful interference to radio or television reception, which can be determined by turning the equipment off and on, the user is encouraged to try to correct the interference by one or more of the following measures:

- Reorient or relocate the receiving antenna.
- Increase the separation between the equipment and receiver.
- Connect the equipment into an outlet on a circuit different from that to which the receiver is connected.
- Consult the dealer or an experienced radio/TV technician for help.

Warning: changes or modifications not expressly approved by the party responsible for compliance could void the user's authority to operate the equipment

The device has been evaluated to meet general RF exposure requirements, the device can be used in portable exposure conditions without restriction