



## *Ultra Heater Collection*

# INSTRUCTION'S MANUAL



**Congratulations on your purchase of the WEXSTAR Ultra Series Infrared Heater!**

**You've selected a product that masterfully combines superior power with a sleek, modern design.**

**This heater efficiently warms a much larger area while maintaining its compact and stylish form.**

**With the WEXSTAR Ultra Series, you'll experience the luxury of uniform heat distribution. The advanced infrared technology ensures that heat is absorbed by objects and walls, which then release the warmth back into the room, creating a consistently warm and comfortable environment.**

**Thank you for choosing WEXSTAR, where cutting-edge innovation meets elegant comfort.**

**Enjoy your new level of warmth!**



**By: Spacio Innovations Inc.**

**PLEASE READ AND SAVE THESE USE AND CARE INSTRUCTIONS**

## SYMBOLS



### **Warning**

This symbol indicates a hazard with an average risk level which, if not avoided, can result in severe injury or death.



### **Warning of electrical voltage**

This symbol indicates dangers to the life and health of people due to electrical voltage.

Symbols	Meaning
	<p>This symbol located on the device indicates that it is prohibited to place objects (such as towels, clothes etc.) above or directly in front of the device.</p> <p>To avoid overheating and fire hazards, the device must not be covered.</p>
	<p>This symbol located on the device indicates a danger to life and health due to the hot surface.</p>
	<p>This symbol located on the device indicates that spraying the device is prohibited.</p>
	<p>This symbol on the device and the information marked indicates that operating manual must be observed.</p>

## **CONTENT**

- 1 | WARNING & PRECAUTION
- 2 | FEATURES
- 3 | TECHNICAL INFORMATION
- 4 | SCOPE OF SUPPLY
- 5 | INSTALLATION
- 6 | TROUBLESHOOTING
- 7 | MAINTENANCE & SERVICING
- 8 | STORAGE
- 9 | DISPOSAL
- 10 | WARRANTY
- 11 | OPTIONAL CONTROL MODES

## 1 | WARNING & PRECAUTION

**Read this manual carefully before starting or using the device. Always store the manual in the immediate vicinity of the device or its site of use!**

### **Read all safety warnings and all instructions.**

Failure to follow the warnings and instructions may result in electric shock, fire and / or severe injury. Save all warnings and instructions for future reference.



#### **Warning**

- This appliance is intended for use by adults or supervised children aged 8 years and older. It is also suitable for individuals with physical, sensory, or mental limitations if they have received proper guidance and supervision regarding safe operation and potential hazards.
- Children should not play with the appliance.
- Cleaning and user maintenance should not be performed by children without supervision.



#### **Warning**

Children of less than 3 years must be kept away from the heater unless continuously supervised by an adult.

##### **Children Aged 3 to 8 Years:**

- Can only turn the heater on or off if it is in its normal operating position.
- Must be supervised or instructed on how to use the heater safely and understand the potential hazards.
- Should not plug in, adjust settings, clean, or perform any maintenance on the heater.



### Warning

- Do not use the device in small rooms if there are individuals present who cannot leave the room independently and are not under constant supervision.



### Warning

#### Important Safety Notice

- **Hot Surfaces:** This heater becomes hot during use. To avoid burns, do not let bare skin touch hot surfaces.
- **Combustible Materials:** Keep items such as furniture, pillows, bedding, papers, clothes, and curtains at least 3 feet (0.9 meters) away from the front, sides, and rear of the heater.
- **Extra Caution:** The following individuals should exercise extra caution to avoid burns:
  - Infants and children
  - People with sensitive skin
  - Elderly individuals
  - Those who are ill
  - Individuals who are intoxicated
  - People taking sleeping pills

By following these precautions, you can ensure safe and effective use of your heater.

- Remove any protective films (both on the front and on the back) before using.

#### Electrical Safety Instructions

**Check Voltage:** Ensure the input voltage matches your heater's specifications:

- For a 120V 60Hz heater, the input voltage should be 120V 60Hz.
- For a 240V 60Hz heater, the input voltage should be 240V 60Hz.
- **Power Supply Compliance:** The power supply must comply with

UL & CSA standards.

- **Wiring:**
  - The left wire should be the neutral wire.
  - The right wire should be the live wire.
  - Ensure the heater is properly grounded.

Following these guidelines will help ensure safe and efficient operation of your heater.

- For models with an input voltage of 120V 60Hz, please ensure they are connected to a designated electrical circuit with a 15A capacity for optimal performance.
  - Do not use the device in rooms where there is a risk of explosion.
  - The device may have hot and arcing or sparking parts inside. Do not use it in areas where gasoline, paint, or flammable vapors or liquids are used or stored.
  - Avoid using the device in environments with harsh or aggressive conditions
- Ensure the device is in a stable position.
- Let the device dry out after it is cleaned. Do not operate it when wet.
  - Do not use the device with wet or damp hands.
  - Do not expose the device directly to water streams.
  - Never insert any objects or limbs into the device.
  - Do not cover or transport the device during operation.
  - Do not sit on the device.
  - This appliance is not a toy! Keep away from children and animals. Do not leave the device unattended during operation.
  - Check accessories and connection parts for possible damage prior to use of the device. Do not use any defective devices or device parts.
  - Ensure that all electric cables outside of the device are protected from damage (e.g. caused by animals). Never use the device if the electric cables or the power connection are damaged!
  - The electrical connection must comply with the local regulations and standards.
  - For 120v devices insert the main plug into a properly secured main socket.
  - Do not use the device when the socket or wire overloads.
  - For Extension cable usage ensure the extension cable matches the device's

power input and intended use. Check the cable length to make sure it is suitable for your needs. Always completely unroll extension cables before use. Avoid overloading the electrical circuit to ensure safe operation. By following these guidelines, you can safely and effectively use your heater with an extension cable.

- Do not operate the heater if it malfunctions. Disconnect the power at the service panel and have heater inspected by a certified electrician before reusing it.
- Before conducting any maintenance care or repair work on the device, unplug it from the main socket. Always hold the plug itself when unplugging, do not pull the cable directly. For 240V models, the input power must be turned off before disassembling or assembling the junction box. When connecting the power cable, be sure to tighten the locking nut of the waterproof gland. When installing the cover of the junction box, the screws must be tightened to ensure the waterproof effect.
- Switch the device off and disconnect the power cable from the main socket when the device is not in use.
- To disconnect the heater, turn off the controls. Then, proceed to the main breaker panel and turn off the power supply to the heater circuit. For 120V models, additionally turn off the on/off switch and unplug the power cord.
- Do not use the device if you detect damage on the main plug or power cable. If the supply cord is damaged, it must be replaced by the manufacturer, or a certified electrician to avoid a hazard.
- During the installation of the device observe the minimum distances from walls and other objects specified in the Installation Chapter.
- Never drill into the heating device.
- Do not use the device in immediate proximity to curtains.
- Do not place the device near combustible material.
- Do not touch the surface when the device is on.
- Allow the device to cool down before transport and / or maintenance work.
- Do not use this device near bathtubs, shower trays, swimming pools or other water containers. Risk of electric shock!
- [Ensure the device is installed in a location where the switches and controllers cannot be reached by anyone in a bathtub or shower.](#)

1. Never insert foreign objects into any ventilation or exhaust opening. Doing so may cause electric shock, fire, or damage to the heater.
2. To prevent a possible fire, do not block the air intakes or exhaust in any way.
3. Use this heater only as described in this manual. Any other use not recommended by the manufacturer may cause fire, electric shock, or injury.

## 2 | FEATURES

- The device is designed to provide efficient, comfortable and healthy Heat.
- These devices reduce air circulation and help to maintain a clean, silent, dust free environment.

## 3 | TECHNICAL INFORMATION

Heating element	Stainless steel heating tube
Surface Material	Aluminum with graphene coating
Back Material	Aluminum Sheet
Input Voltage	AC 120 or 240V/60Hz
Surface temperature	330-350°C
Color	White/Black
Options	Built in remote thermostat, built in WIFI & remote thermostat, or no thermostat

<u>Model NO.</u>	<u>Size (mm)</u>	<u>Power (W) - Volt</u>
<a href="#">CR-1000B</a>	636*220*110	<a href="#">1000 - 120V</a>
<a href="#">CR-1000W</a>		
<a href="#">CT-1000B</a>		
<a href="#">CT-1000W</a>		
<a href="#">C-1000B</a>		
<a href="#">C-1000W</a>		

<a href="#"><u>CR-1500B</u></a>	896*220*110	<a href="#"><u>1500 - 120V</u></a>
<a href="#"><u>CR-1500W</u></a>		
<a href="#"><u>CT-1500B</u></a>		
<a href="#"><u>CT-1500W</u></a>		
<a href="#"><u>C-1500B</u></a>		
<a href="#"><u>C-1500W</u></a>		
<a href="#"><u>CR-1800B</u></a>	1036*220*110	<a href="#"><u>1800 - 240V</u></a>
<a href="#"><u>CR-1800W</u></a>		
<a href="#"><u>CT-1800B</u></a>		
<a href="#"><u>CT-1800W</u></a>		
<a href="#"><u>C-1800B</u></a>		
<a href="#"><u>C-1800W</u></a>		
<a href="#"><u>CR-2400B</u></a>	1316*220*110	<a href="#"><u>2400- 240V</u></a>
<a href="#"><u>CR-2400W</u></a>		
<a href="#"><u>CT-2400B</u></a>		
<a href="#"><u>CT-2400W</u></a>		
<a href="#"><u>C-2400B</u></a>		
<a href="#"><u>C-2400W</u></a>		
<a href="#"><u>CR-3000B</u></a>	1586*220*110	<a href="#"><u>3000 - 240V</u></a>
<a href="#"><u>CR-3000W</u></a>		
<a href="#"><u>CT-3000B</u></a>		
<a href="#"><u>CT-3000W</u></a>		
<a href="#"><u>C-3000B</u></a>		
<a href="#"><u>C-3000W</u></a>		
<p>“CR” means it has built-in remote thermostat.</p> <p>“CT” means it has built-in WIFI and remote thermostat.</p> <p>“C” means it has ON/OFF switch.</p> <p>“B” =Black; “W”=White</p>		

# 4 | SCOPE OF SUPPLY

A

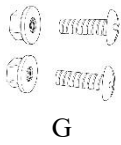
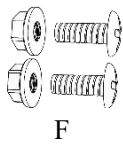
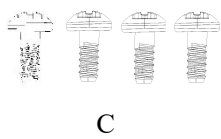
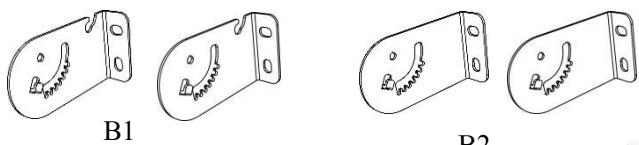
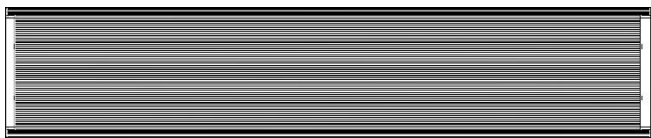

OR

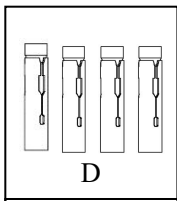

applied to concrete ceilings

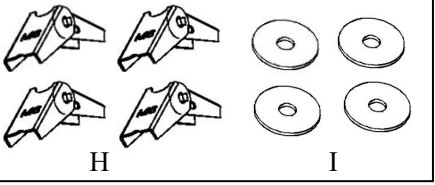
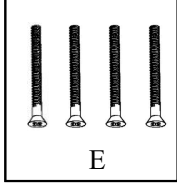

applied to drywall board ceilings

<b>A:</b> Ultra Series infrared heater ×1	<b>B:</b> (B1&B2): Articulating brackets ×4
<b>C:</b> Phillips round-head screw ×4	<b>D:</b> Metal expansion tubes ×4
<b>E:</b> Phillips countersunk screw×4	<b>F:</b> Flange nut kits ×2 (M5)
<b>G:</b> Flange nut kits ×2 (M3)	<b>H:</b> Spring Toggles x 4
<b>I:</b> Washers x 4	<b>J:</b> User Manual ×1
<b>K:</b> Drilling template ×1	<b>L:</b> Remote - controller ×1 ( <i>with selected models</i> )

*Tips: D and E are applied to concrete ceilings, whereas H, I and E are used on drywall ceilings.*

## 5 | INSTALLATION

### Hardwire Installation process for 240v models:

**The installation must be carried out by a professionally certified electrician.**

1. Unscrew the screws at the four corners and remove the junction box cover.
2. Thread the prepared power cable through the cable gland and connect it properly.

*Note: The yellow-green wire is the ground wire, and it must be correctly connected to the ground.*

3. Install the junction box cover and secure it with the screws.

- Ensure connections are made with an **HSJOW or HSJW (16AWGx3C) power cable**.
- If a power cord is used, it must be an **HSJOW or HSJW (16AWGx3C) type**, measuring **1.8 to 2.4 meters** in length.

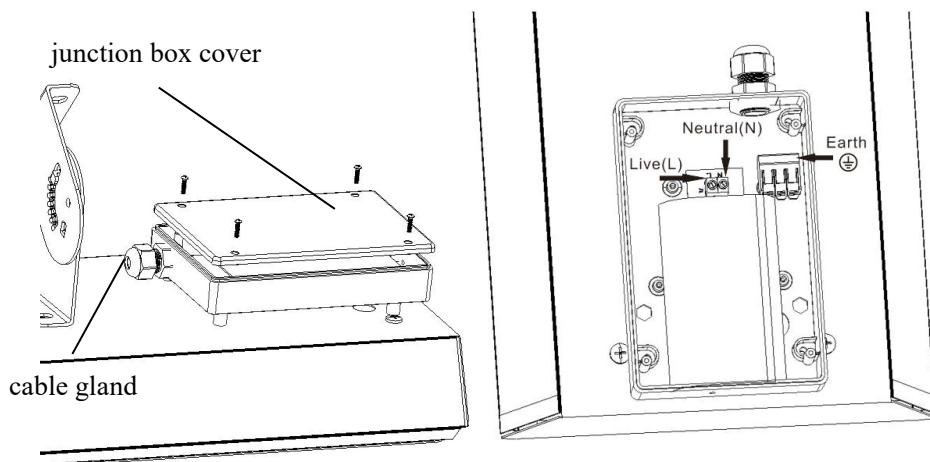

## Grounding instructions

For heater rated for a nominal 120 volt:

This heater is for use on 120 volts. The cord has a plug as shown at 'A'. An adapter as shown at C is available for connecting three-blade grounding-type plugs to two-slot receptacles. The green grounding **lug** extending from the adapter must be connected to a permanent ground such as a properly grounded outlet box. The adapter should not be used if a three-slot grounded receptacle is available.

For heater rated for a nominal 240 volts:

This heater is for use on 240 volts. If the cord has a plug as shown in D. No adapter is available for this blade configuration, and none should be used. The type of outlet is a 240-volt grounding outlet. When properly installed, it provides a ground connection through the cord to the heater to protect the operator from electric shock.

Grounding methods

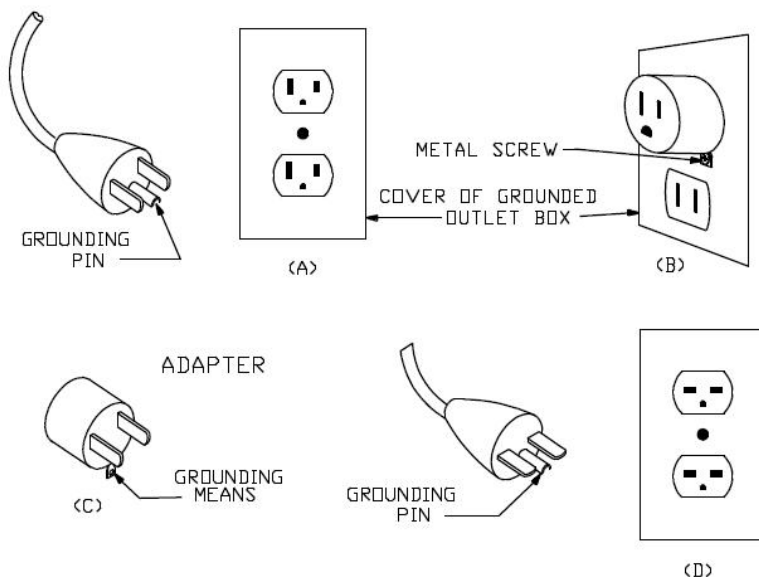

**Make sure you remove any protective films (both on the front**

**and back)!**

### **Instruction for Concrete/ Brick Wall Mounting**

1. Align the two articulating brackets (B2) separately with the pre-drilled installation holes (A) on the back of the product, ensuring that the direction of both articulating brackets remains consistent. Secure each articulating bracket (B2) in place using screws (C).

*Note: Ensure that the two articulating brackets (B2) are oriented in the opposite direction to the two brackets (B1) that are already installed on the wall.*

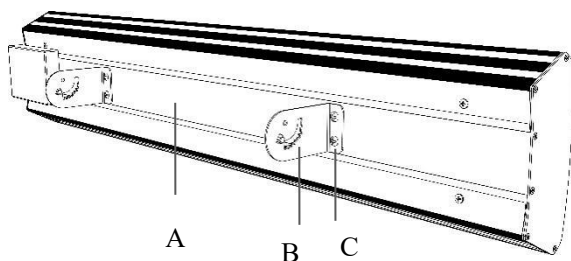

2. Secure the mounting template onto the wall, accurately identifying the corresponding hole positions, and mark the hole locations on the wall for drilling purposes. (Alternatively, you can determine the drilling positions by measuring the distances ab and ac.)

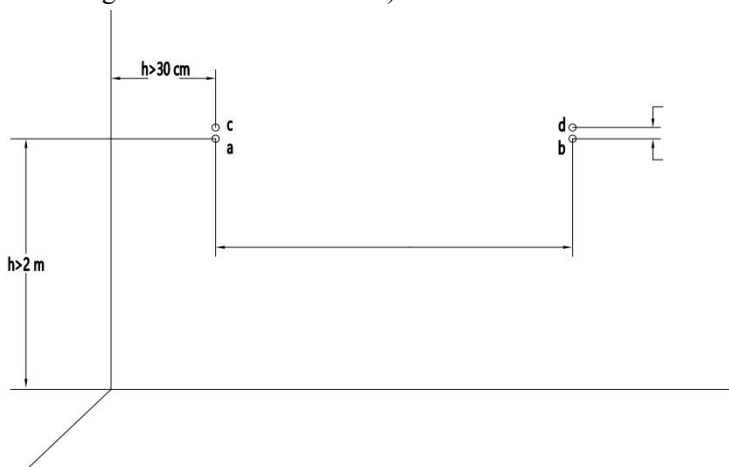

- Install the device at least 2m (6.5ft) above the floor, with both ends at least 30 cm (1 ft) away from the wall.

- **Combustible Materials:** Keep items such as furniture, pillows, bedding, papers, clothes, and curtains at least 3 feet (0.9 meters) away from the front, sides, and rear of the heater.

3. Drill 4×10mm holes at the marked positions.



It is important to avoid using an excessively large drilling diameter during installation.

4. Insert the metal expansion tubes(D) into the drilled holes.

5. Thread the screw(E) through the holes in the remaining two articulating brackets (B1), then secure them into the metal expansion tubes(D).

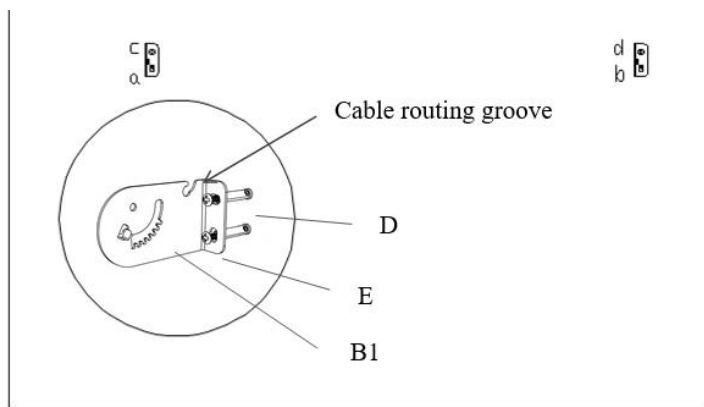
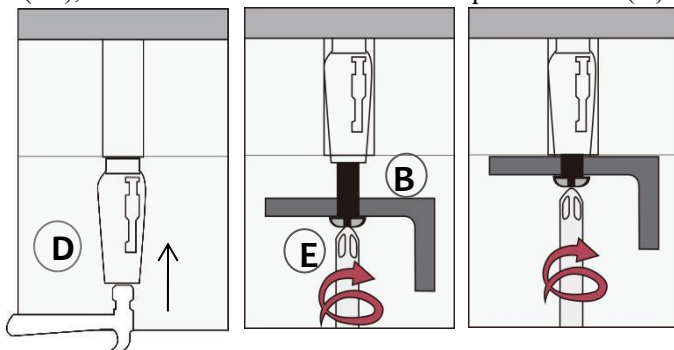

*Note: The cable routing groove on the brackets(B1) should face up*

*during installation.*

6. First, interlock the hanging tabs on one of the articulating brackets (B1) attached to heater (A) with the hanging tabs on the corresponding brackets (B2) on the wall, passing them through the slotted holes and securely engaging them together. Conduct a gentle shake test to ensure that there is no detachment.

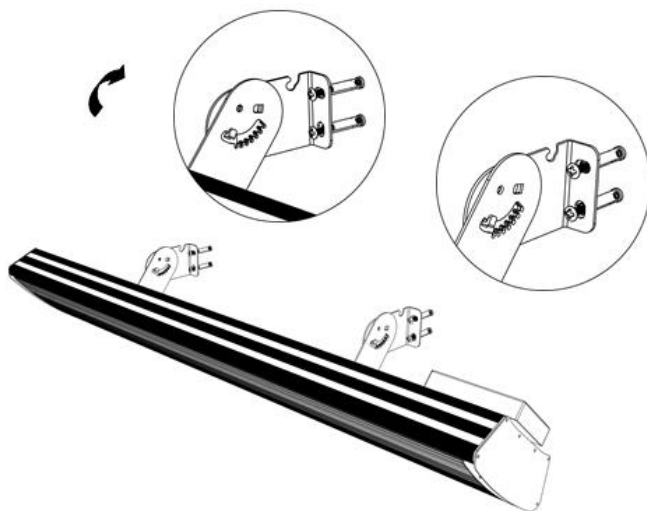

7. Securely engage them through the slotted holes, enabling slight rotational adjustments of the product to different positions.

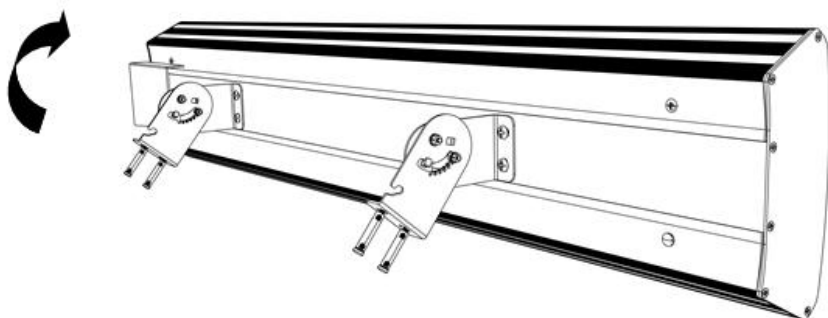

8. Insert the flange nut kits (F) through the pivot hole, securing it with a nut. Next, pass the flange nut kits (G) through the U-shaped groove, adjust it to the desired angle, and secure it by tightening the nut.

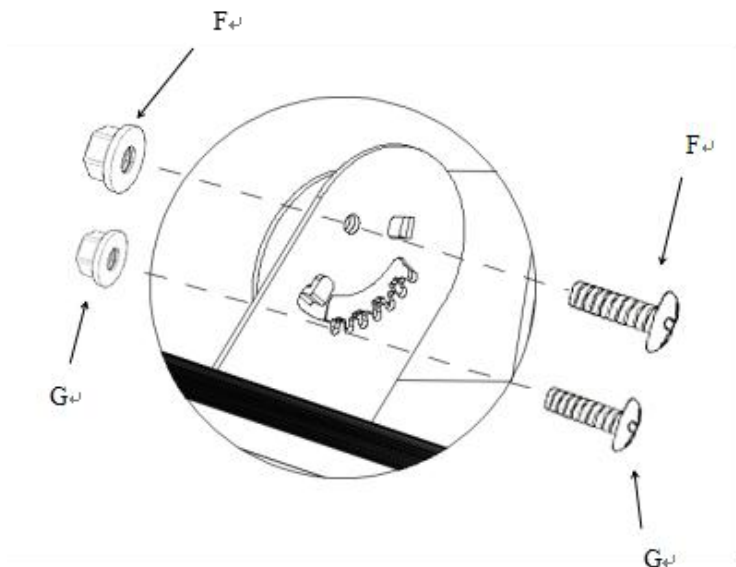

### **Instructions for Drywall Wall Installation**

1. Following Step 1 in the concrete/brick wall mounting installation method, secure the articulating bracket onto the back of the heater.
2. Following Step 2 in the concrete/brick wall mounting installation method, mark the drilling positions.
3. Drill 4×18mm holes at the marked positions.



*It is important to avoid using an excessively large drilling diameter during installation.*

4. Thread the screws (E) through the hole in the articulating bracket (B1), the washer (I), and the spring toggle (H). Then insert the spring toggle into the pre-drilled hole.

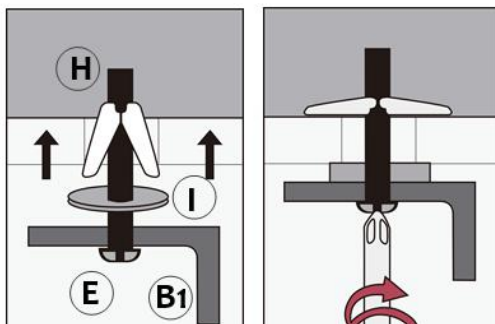
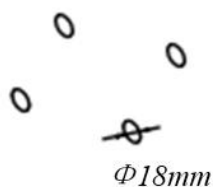

5. Tighten the screws.

6. Following Step 6, 7 and 8 in the wall mounting installation method, securely affix the heater to the wall, completing the installation.



**WARNING:**

- *To mitigate errors, please measure all dimensions before proceeding with the installation.*
- *Install this product at a minimum height of at least 2 meters above the ground level.*
- *The articulating brackets must be securely fastened with bolts before connecting the heater to the fixed electrical circuit.*
  - *The heater must be installed within less than 190cm of a properly grounded outlet.*

**Power Cord Placement Tip:**

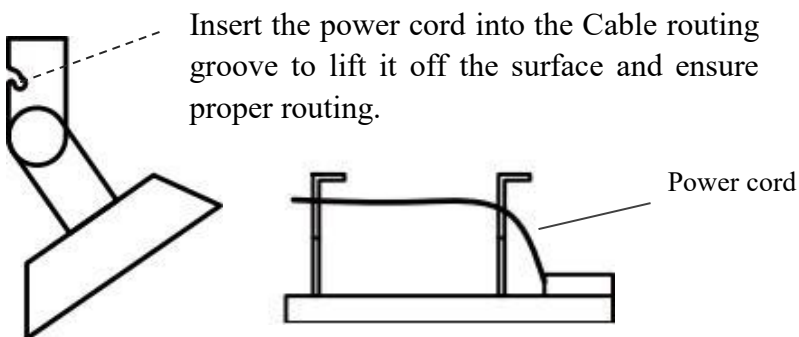

Do not place the power cord on the back of the product!

**Instructions for Ceiling Mounting**

Before starting the installation, please make sure to determine the

**material of the ceiling.** The following are the installation methods for **concrete ceilings** and **drywall ceilings**. Please choose and use appropriate accessories based on the specific situation.

### **a. Concrete ceiling Installation**

For the installation method of concrete ceiling, please refer to the wall mounting installation description above.

### **b. Drywall ceiling Installation**

1. Following Step 1 in the wall mounting installation method, secure the articulated bracket onto the back of the product.
2. Following Step 2 in the wall mounting installation method, mark the drilling positions.
3. Drill 4×18mm holes at the marked positions.



*It is important to avoid using an excessively large drilling diameter.*

Thread the screws (E) through the hole in the articulating bracket (B1), the washer (I), and the spring toggle (H). Then insert the spring toggle into the pre-drilled hole.

*Note: The groove on the brackets(B1) should face up during installation.*

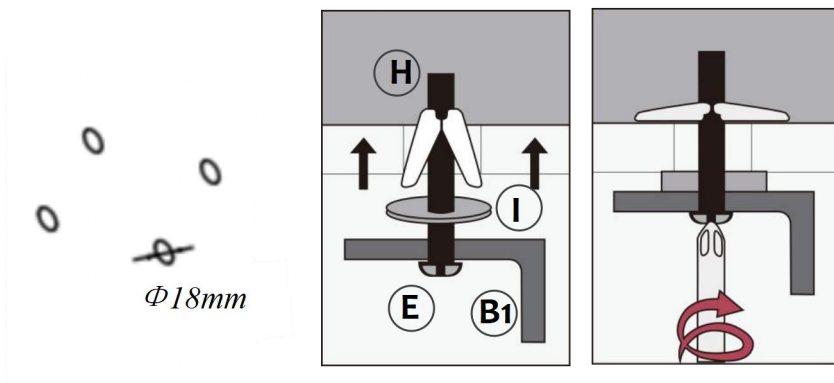

4. Tighten the screws.

5. Following Step 6, 7 and 8 in the wall mounting installation method, securely affix the heater to the wall, completing the installation.



**WARNING:**

- *To mitigate errors, please measure all dimensions before proceeding with the installation.*
- *Install this product at a minimum height of 2 meters above the ground level.*
- *The articulating brackets must be securely fastened with bolts before connecting the heater to the fixed electrical circuit.*
  - *The heater must be installed within less than 190cm of a properly grounded outlet.*

## 6 | TROUBLESHOOTING

Problem	Reason	Measure
It has noise when originally charged with electricity	Due to the structure stress of the heat insulator.	It is a normal temporary phenomenon. No action required.
The surface of the device was slightly raised.	Due to the thermal expansion of the surface material.	It is a normal phenomenon. No action required.
The surface of the heating device is warm.	1. The voltage is low. 2. In a low-temperature environment.	1. Install a voltage regulator. 2. It is normal.

## 7 | MAINTENANCE & SERVICING

### Activities required before starting maintenance.



#### Warning of electrical voltage

Do not touch the main plug with wet or damp hands.

- When unplugging the device, always hold the plug itself. Do not pull the cable directly. For 240V models, the input power must be disconnected before disconnecting the device power cable.
- Allow the device to cool down completely.



#### **Warning of electrical voltage**

Tasks which require the housing to be opened must only be carried out by the manufacturer or certified electrician.

### **Cleaning the device**



#### **Warning of electrical voltage**

Never immerse the device in water!

Clean the device with soft, damp and lint-free cloth. Ensure that no moisture enters the device. Protect electrical components from moisture. Do not use any aggressive cleaning agents such as cleaning sprays, solvents, alcohol-based or abrasive cleaners to dampen the cloth. After cleaning, wipe the housing dry.

## **8 | STORAGE**

When the device is not in use, please follow these storage conditions:

- Keep it dry and protected from frost and heat.
- Store it in an upright position, away from dust and direct sunlight.
- Use a cover to protect it from invasive dust, if necessary.
- Do not place any other devices or objects on top of the heater to prevent damage.

By following these guidelines, you help ensure the longevity and proper functioning of your heater.

## 9 | DISPOSAL



The icon with the cross-out waste bin on waste electrical or electronic equipment stipulates that this equipment must not be disposed of with household waste at the end of its life. Please check the disposal options for your specific area.

The separate collection of waste electrical and electronic equipment aims to enable the re-use, recycling, and other forms of recovery of waste equipment as well as to prevent negative effects for the environment and human health.

The future is in your hands. Don't let it go to waste. Find the proper drop-off location.

## 10 | WARRANTY

WEXSTAR Electric Heaters are warranted against defects in workmanship and materials for three (3) years from the date of purchase. This warranty does not apply if damage or malfunction occurs due to accidents, improper handling or operation, shipping damage, abuse, misuse, alterations, unauthorized repairs made or attempted, damage by accident, theft, fire, flood, external causes such as, but not limited to, improper installation of wiring, operation with connected voltage more than 5% greater than the nameplate voltage, blown fuses, inadequate electrical power, or any use of the product not authorized by the manufacturer, and normal wear and tear. The customer shall be responsible for all costs incurred in the removal or reinstallation of the products including but not limited to labor costs and shipping costs to return the heater to WEXSTAR Service center. Within the limitations of this warranty and at the discretion of Spacio Innovations Inc., we will repair or replace the heater. You shall be responsible for any shipping

& handling charges for both the return of your unit, and the sending of a replacement unit, at the discretion of Spacio Innovations Inc.

SPACIO INNOVATIONS INC.: SHALL NOT BE LIABLE NOR DOES THIS WARRANTY COVER LIABILITY FOR INCIDENTAL OR CONSEQUENTIAL DAMAGES FOR ANY CAUSE WHATSOEVER, INCLUDING BUT NOT LIMITED TO; NEGLIGENCE, TORT, STRICT LIABILITY OR CONTRACT.

## **11 | OPTIONAL CONTROL MODES (Additional instructions)**

The products are offered with 3 different control modes to choose from.

A	With built-in remote thermostat control mode
B	With built-in WIFI and remote thermostat control mode
C	No Thermostat

### **A: Instruction for Control and Operation Way A (Included with Heater models CR)**

#### **I. Technical data of remote controller**

- Battery-powered: DC 3V (2x 1.5V AAA batteries, not included)
- Power Consumption: 3V,0.1mA
- Set temperature range: 5°C~ 35°C, resolution: 1°C
- Room temperature range: 0°C~ 50°C, display resolution: 0.1°C
- Accuracy of the measured temperature:  $\pm 0.5^{\circ}\text{C}$
- Working environment range 1°C~ 50°C
- Dimension: L135mm×W56mm×H18mm
- Weight: 86g
- Radio frequency 433.92MHz
- Technical Data of Built-in Receiver
- Power Supply:AC120/240V,50/60 Hz
- Power Consumption:0.4W

## **II. Function of remote controller**

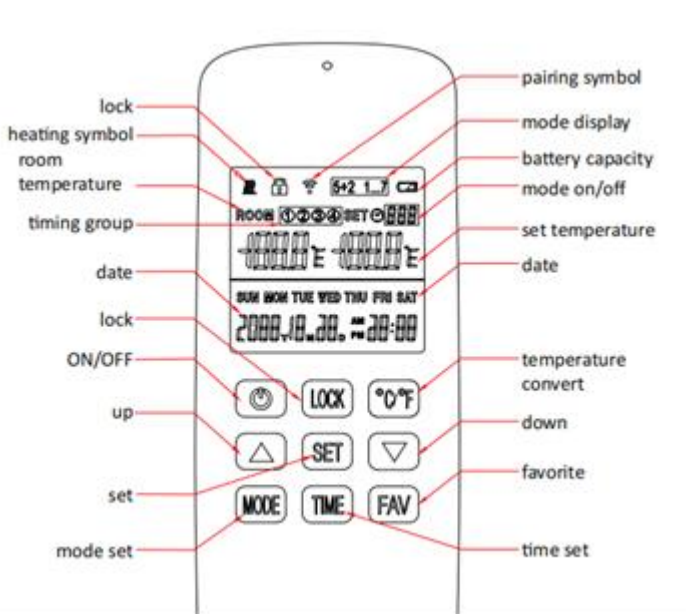

1. Each set consists of two parts: A remote-controller with digital display, which accommodates the electronics, the operating elements and the built-in room temperature sensor built-in receiver, which can receive and decode signal from the remote-controller.
2. The remote controller acquires the room temperature with its integrated sensor and transmits the signal to the receiver to turn on/off the heating device as the ambient temperature changes, to maintain a constant room temperature. When the ROOM temperature is 0.5°C higher than the SET temperature, remote-controller will send OFF commands to receiver; When the ROOM temperature is 0.5°C lower than the SET temperature, remote-controller will send ON commands to receiver, the connected heating device will be in working status to warm the house.
3. The display shows the setting temperature as well as the measured temperature, time, date, modes etc.
4. The remote controller has week programmable temperature setting, favorite temperature, time setting functions etc.
5. The remote controller is powered by 2pcs of 1.5V AAA battery. Please change with new batteries if the battery symbol gets flashing, or else the remote will not be able to control the heaters.
6. The keypad locking function is designed to prevent children from misusing it.
7. The LCD screen only can work in temperature range from 1°C~ 50°C.



## OPERATION AND SETTING

1. Power on the heater, press button  on the remote-controller, then press button °C/°F and MODE buttons at same time to pair the remote-controller and receiver until long beep sound.

### NOTES:

- 1) Pairing should be finished within 1 minute, or else you need to re-power on the heater.
  - 2) Please re-power the heater if you want to pair it with another remote control.
  - 3) Before pairing please do power off those heaters which you don't want to pair.
  - 4) Switch on the receiver ON means it will disable the remote controller. Do not turn it on if you want to control the heater with the remote control.
2. Press button  on remote controller to turn on/off the heater.  
Note: If you press button  on the remote-controller to shut down or

the weekly shutdown time arrives, the display screen of the remote-controller will only show room temperature and OFF, which only means that the receiver has turned off the heater, not that the remote-controller itself has stopped working, and its internal time and temperature are still calculated. And pressing button again or weekly startup time arrives will signal the receiver to turn on the heater.

3. Long press LOCK for 3 seconds to lock/unlock the buttons.
4. Press °C/°F button to convert the temperature display measurement unit.
5. Long press TIME 3 seconds to set year, month, date and time with UP and DOWN buttons.
6. Press UP and DOWN to set target temperature.  
Even during weekly timer on period, users can also press UP and DOWN to set a temporary temperature, and only the current time period is affected.

Tips:

1) The default setting temperature when the product starts up is 19°C (in manual mode).

2) Setting temperature range: 5-35°C.

7. Press and hold FAV for 3 seconds until the setting temperature icon flashes, the default preferred temperature value is 24°C, which can be adjusted by pressing the ▲ and ▼ buttons, and short press FAV button to confirm.

In daily use, setting temperature will convert to favorite temperature by Short pressing FAV button and short press again to switch back to the original setting temperature.

8. Default to manual mode: Long press the MODE button to switch to 5+2 mode. Long press the MODE button again to switch to 1...7 mode. Long press the MODE button again to switch back to manual mode and repeat the cycle.
9. Long press the SET button to enter the programming mode setting state. (Long press again to exit)

Notes:

1) *Programming mode has a time-out limit whereby if no buttons are pressed within 8 seconds, it reverts to the main screen.*

2) *It must be set in 5+2 or 1-7 programming mode. In manual mode, long pressing SET button has no response.*

### 1) **5+2 Programming Mode**

You can program the thermostat to fit your lifestyle — week and weekend, plus up to 4 groups of time interval per day.

**Step 1.** Once in 5+2 mode, Press and hold the SET button for 3-5 seconds until the Program icon ① and MON TUE WED THU FRI are displayed, with ON and the Time Icon is flashing on the screen.

**Step 2.** Press the ▲ button to adjust the hour (+1hour/press) and press the ▼ button to adjust the minutes (+5minutes/press) to set the starting time of Program ①.

**Step 3.** Press the SET button once and the OFF icon will start flashing on the screen. Use the ▲ button to adjust the hour (+1hour/press) and press the ▼ to adjust the minutes (+5minutes/press) to set the ending time of Program ①.

**Step 4.** Press the SET button once again and the set temperature icon will start flashing on the screen. Use the ▲ or ▼ button to set the desired temperature to be maintained for program ①.

*Tips:*

1. *Setting temperature range: 5-35°C*

2. *Short press the FAV button to choose your favorite temperature value.*

**Step 5.** Press the SET button to bring up Program ② of weekdays. Repeat Steps 2-5. Users can set up Program ③ and ④ in a similar manner.

**Step 6.** After finishing the set up for Program ④, press the SET button to bring up the SAT and SUN settings. Repeat steps 2-5 to set Program ①, ②, ③, ④ for the weekend.

### 2) **1-7 Programming Mode**

You can program the thermostat everyday by setting 2 groups of time intervals per day.

Once in 1-7 Mode, Press and hold the SET button for 3-5 seconds until Program icon ① and MON is displayed, with the ON and Time icons flashing on the screen. Users can follow the above step 2-4 to set the

On/Off times and desired temperature for Programs ① and ② from Monday to Sunday in sequence.

**Tips:**

1) The default starting time, the ending time, and default temperature settings are detailed in the following table.

MODE \ TIME			Starting time	Ending time	Default setting temperature (°C)
5+2	MON-FRI	1	00:00	06:30	17
		2	06:30	08:45	19
		3	08:45	17:00	17
		4	17:00	22:30	19
	SAT-SUN	1	00:00	08:00	17
		2	08:00	14:00	19
		3	14:00	17:30	17
		4	17:30	23:15	19
1...7	MON	1	06:30	17:00	17
		2	17:00	22:30	19
	TUE	1	06:30	17:00	17
		2	17:00	22:30	19
	WED	1	06:30	17:00	17
		2	17:00	22:30	19
	THU	1	06:30	17:00	17
		2	17:00	22:30	19
	FRI	1	06:30	17:00	17
		2	17:00	22:30	19
	SAT	1	08:00	14:00	19
		2	17:30	23:15	19
	SUN	1	08:00	14:00	19
		2	17:30	23:15	19

2) The device can still be turned on or off and the temperature can

*be set normally while the weekly timer is on. Only the current time period will be affected.*

- 3) Programming groups allow running across dates.*
  - 4) When programming, please don't set overlapped intervals between workgroups. If the time periods overlap, the group with an earlier starting time will turn ON first, and the group with an earlier ending time will turn OFF, until the next group turns ON.*
  - 5) The programmed time / temperature setting will be restored with the next program entry in the memory.*
  - 6) Once finished setting up the programming mode, the thermostat will work under programming mode ON even if the thermostat is turned off. The heating device will be switched ON or OFF according to the programmed settings.*
10. The thermostat will automatically turn off the heating device if a sudden drop in room temperature is detected.
  11. The symbol  means heating. It is displayed only when the room temperature is 0.5°C (or more) lower than the set temperature.
  12. The backlight will turn ON when any button is pressed while the thermostat is powered on.

## **NOTES**

1. The date and time need to be reset after the battery is replaced. No reprogramming is required.
2. Alkaline batteries are recommended. If ALL the buttons on the remote controller are not working, try replacing the batteries.
3. Please do change the batteries with new ones as soon as the screen battery symbol starts flashing. Else it may result in the device being halted/stuck or not working.
4. If the heater cannot be turned on by the remote control, first check whether the set temperature is higher than the room temperature.
5. If users want the week timer and temperature to work, make sure it has been switched to 5+2 or 1...7 mode.  
If users want it not to work, switch to manual mode.
6. Do not cover or touch the temperature sensor which is at the top of the remote control.

7. Place the remote control in an open, normal room environment. Do not keep it inside a drawer/pocket or under pillow/quilt etc.
8. Please remove the batteries from the remote control if it will not be used for a long time.

## **B: Instruction for Control and Operation Way B (Included with Heater Models CT)**

### **I. Product Description**

An internal WIFI thermostat is normally built into CT series panel heaters and controlled by mobile phone through internet. Functions Included:

- WIFI remote control
- Remote control
- Temperature adjustment
- Weekly program on/off and temperature setting
- Count down power off
- Share with other users

It works with a remote control that measures the room temperature and transmits the signal to the heater's receiver. This remote control has an LCD screen which displays the current room temperature.

The remote control sends a **one-way signal**, while the smartphone app offers **two-way communication**. This means that temperature changes made with the remote will automatically update on the app; however, changes made via the smartphone app will **not automatically reflect** on the remote control.

The heater uses the set temperature on the smartphone app to turn on or off.

The remote control can control the heater if the smartphone app is not connected. It can turn on/off the heater and adjust the set temperature.

The heater can be controlled with the smartphone app only if the remote control runs out of batteries.

### **II. Technical Data of Internal Receiver**

1. Power Supply: AC 120V or 240V (Based on the model)

2. Wireless standard: IEEE802.11b/g/n
3. Frequency range: 2.412~2.484GHz
4. Security mechanism: WEP/WPA-PSK/WPA2-PSK
5. Encryption type: WEP/TKIP/AES
6. Standby power consumption: <0.8W

Working environment: temperature -5 ~ 50 ° C; humidity 10% -95%.

### **III. Technical Data of remote-control**

1. Power supply: DC3V (2\*1.5V AAA batteries, not included)
2. Power consumption: 3V 0.1mA
3. Temperature setting range: 5°C~35°C
4. Temperature display range: 0°C~50°C
5. Maximum work distance: <8 meters
6. Dimension: 140mm×40mm×18mm
7. Weight: 40g

### **IV. Function of remote control**

1. The Built-in receiver and remote controller constitute the temperature control system.
2. The remote control is powered by two 1.5V AAA batteries. Please replace the batteries with new ones if the battery symbol starts flashing, otherwise the remote will not be able to control the heater.
3. The remote control measures the room temperature through the sensor on the top and sends real-time temperature data to the receiver.
4. The screen displays the room temperature, target temperature, child lock, battery level etc.
5. The remote control includes functions such as switching the heater on/off, setting the target temperature, temperature unit conversion, child lock, etc.
6. When the screen of the remote-control is off, it only means that the heater is off, and it does not mean that the remote control has stopped working. The remote continues to detect real-time temperature data and sends it to the receiver every 60s for logical control purposes, regardless of whether it is on or off.

- One remote control can be paired with multiple heaters. Users can pair them one by one or all at once — both methods are supported.

#### IV. Instructions of the remote-control operation

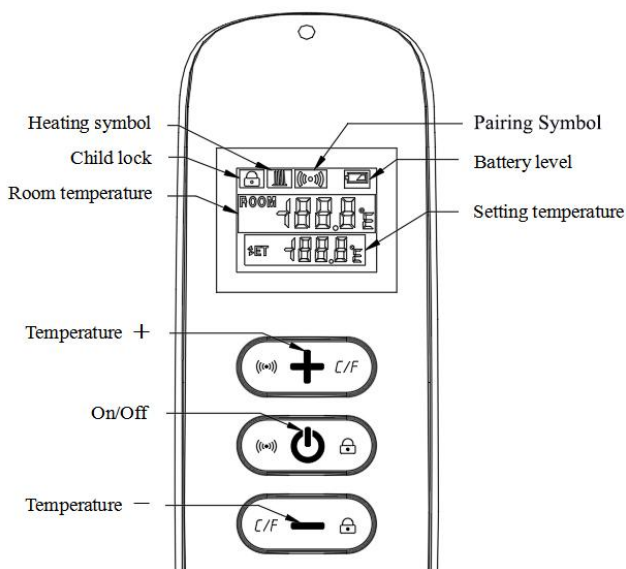

- Power on the heater, and then press  and "+" at the same time within five minutes to start pairing. The pairing symbol will flash three times and send out the pairing code to indicate that pairing is in progress. A single **beep sound from the heater will confirm** successful pairing.

*Note:1. Please turn off any heaters that you do not want to pair before starting the pairing process.2. If the remote control needs to be replaced, please power on the heater again, and complete the pairing within five minutes. If the pairing is not completed within five minutes, the pairing mode*

*will be turned off, and you will need to repeat the above steps to pair again.*

2. Press "⏻" to turn the heater on and press it again to turn the heater off.
3. Press the "+" key to increase the set temperature by 1°C, press the "-" key to decrease the set temperature by 1°C. Hold the "+" key or the "-" key for 3 seconds to continuously increase or decrease the set temperature.
4. Press the "+" and "-" key at the same time to switch the temperature unit between °C and °F.
5. Press the "⏻" key and the "-" key at the same time for 3 seconds to activate the child lock mode. Repeat the action to deactivate it.
6. SET means the target temperature.
  - 1) If the SET temperature is lower than the ROOM temperature, the heating symbol will not be displayed.
  - 2) If the SET temperature is higher than the ROOM temperature, the heating symbol will be displayed.
  - 3) When the room reaches the SET temperature, the heating symbol will no longer appear on the remote control.
  - 4) Every time you press the button, the screen background will light up and will turn off if there is no operation within 5 seconds.

## **VI. Instructions of WIFI Connection (For Heater Models CT)**

1. Before pairing, please make sure your mobile phone is consistently connected to the same 2.4GHz WIFI network.
2. Scan the QR code below to install the Smart Life APP and Register an account.



3. Power on the heater and it will beep automatically. Press and hold the "⏻" and "+" buttons on the remote control to pair it with the heater. Then, press and hold press the "⏻" button on the remote control for 6 seconds until the blue indicator on the Display screen starts

flashing. The heater is now ready for Wi-Fi set up.

*NOTE: The same operation is required if the Wi-Fi hotspot, Wi-Fi password or cell phone is changed.*

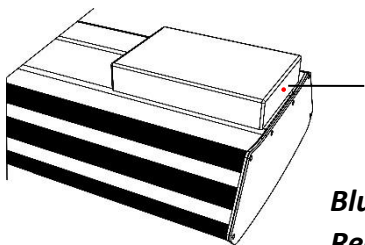

Indicator light with red  
and blue colors

***Blue color means online***

***Red color means heater is heating up***

4. Open the Smart Life App to enter main interface, then tap “Add Device” or the “ $\oplus$ ” icon the upper right corner. A pop-up window will appear as shown in the picture below.

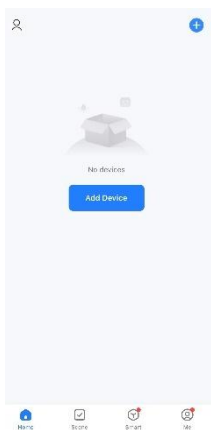

5. Click “Add”. A Wi-Fi Information entry dialog will pop up as follows:

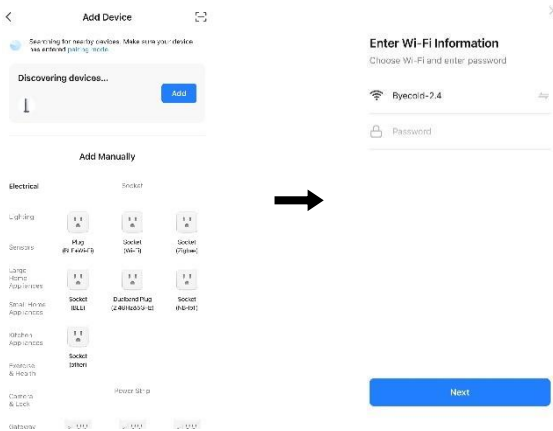

6. Enter the Wi-Fi password and click “Next”. The device will automatically proceed to the next step to connect to Wi-Fi. After 20-30 seconds, the device will be successfully added, and the blue indicator on the display screen will light up. You can then name the device, e.g. “Infrared Panel Heater”.

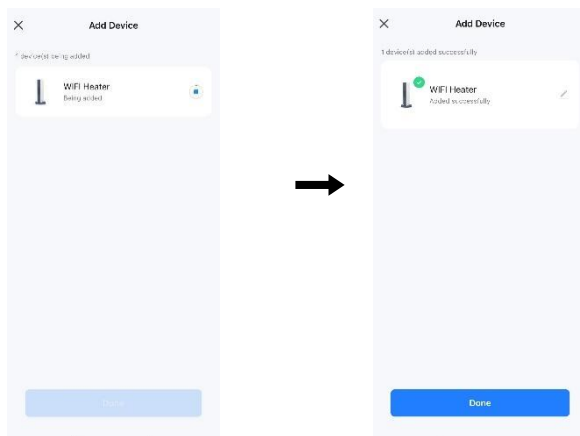

*Note: If the connection times out in Step 6, please repeat Steps 3-6.*



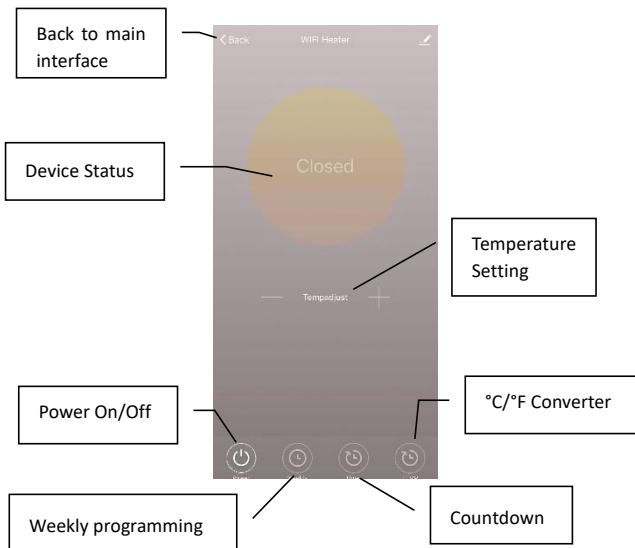

## VII. Operation Instructions

1. The main view of the Smart Life APP after the heater is successfully connected is shown below.
2. Click the Green or Gray  button to turn the heater's power supply on or off. A red indicator light on the heater panel means the heater is powered on.
3. Click the device name "Wi-Fi Heater" to enter the device interface.

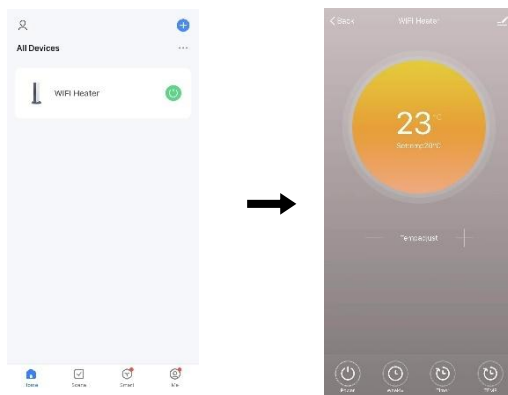

4. This is for turning the heater's power on or off. To power on the heater, the target temperature should be also at least 0.5 °C higher than the room temperature.



This refers to weekly programming mode. In this mode, users can program the heater to change the operation and desired temperature

throughout the week. ON and OFF times are set separately and must be added individually. Don't forget to turn the weekly button

Green after programming.

**Note:** *The weekly schedule will continue to operate as per settings even when the app is powered off.*

5.  This is the countdown function for setting the heater to power off.

6. **Note:** *Powering off the app will cancel the timer setting.*

7.  This allows converting the temperature display between °F and °C.

**Note:** *Weekly, Timer and TEMP: All three functions can only be edited under power on mode!*

8.  This means further editing of the heater, as described below.

- 1) Device Name: Edit the heater's thermostat name.
- 2) Device Information: To review the virtual ID etc. and device information.
- 3) Share Device: You can share control of this thermostat with other mobile numbers/email addresses, if they are registered in the "Smart Life" APP.
- 4) Create Group: You can group different thermostats to be controlled together.
- 5) FAQ & Feedback: To report any problems to the APP supplier.
- 6) Add to the Home Interface: You can turn the heater on directly from the home interface.
- 7) Check Device Network: Check the Wi-Fi connection status of the device.
- 8) Check Update: Get the latest firmware version.
- 9) Remove Device: Remove the thermostat from your APP.

## **VIII. Important note**

1. The heater only supports a 2.4GHz network.
2. The Blue light indicates the heater is online and red light indicates the heater is powering on. (With both lights on, blue and red at the same time, the light will be seen as purple color)
3. Wi-Fi or network disconnection will cause the heater to go offline and power off.
4. The blue LED indicator may not light up immediately after finishing the Wi-Fi connection process. Please wait a few seconds as the device searches for the network and connects.
5. Alkaline battery is recommended for the remote control. Please remove the battery if the remote will not be used for an extended period.
6. If the remote cannot turn the heater on, please check that the target temperature is not set higher than the room temperature.
7. Place the remote control no more than 8 meters away from the heater.  
Do not mount the remote control near any cold or heat source.  
Do not cover the remote control.  
Keep it in a normal, open room environment and not inside a drawer/pocket etc., or under pillow/quilt etc.
8. Do not use the heaters in wet environments or areas with running water.
9. Please unplug the heater from the socket if will not be used for an extended period.
10. Both the remote-control and the App can turn the heater on or off and set the temperature. The remote-control settings can be linked to the app, but the app settings cannot be linked to the remote-control.
11. If the connection between the remote and the built-in receiver is lost and the temperature data can't be received for 5 minutes, the APP will display --., and the heater will stop heating. Meanwhile, the mobile will get a warning message. Once the connection is restored, the APP will display the actual room temperature.
12. If the remote-control is disconnected, please bring the remote-control close to the heater (less than 3 meters) and re-pair.
13. If the remote control is consistently disrupted at one location, try moving

it to another location.

## **FCC Statement**

This equipment has been tested and found to comply with the limits for a Class B digital device, pursuant to part 15 of the FCC Rules. These limits are designed to provide reasonable protection against harmful interference in a residential installation. This equipment generates, uses and can radiate radio frequency energy and, if not installed and used in accordance with the instructions, may cause harmful interference to radio communications. However, there is no guarantee that interference will not occur in a particular installation. If this equipment does cause harmful interference to radio or television reception, which can be determined by turning the equipment off and on, the user is encouraged to try to correct the interference by one or more of the following measures:

- Reorient or relocate the receiving antenna.

- Increase the separation between the equipment and receiver.

- Connect the equipment into an outlet on a circuit different from that to which the receiver is connected.

- Consult the dealer or an experienced radio/TV technician for help.

Caution: Any changes or modifications to this device not explicitly approved by manufacturer could void your authority to operate this equipment.

This device complies with part 15 of the FCC Rules. Operation is subject to the following two conditions: (1) This device may not cause harmful interference, and (2) this device must accept any interference received, including interference that may cause undesired operation.

### **RF Exposure Information**

This equipment complies with FCC radiation exposure limits set forth for an

uncontrolled environment. This equipment should be installed and operated with minimum distance 20cm between the radiator and your body.

#### RF Exposure Information

The device has been evaluated to meet general RF exposure requirement.

The device can be used in portable exposure condition without restriction.

## ISED Statement

English: This device contains licence-exempt transmitter(s)/receiver(s) that comply with Innovation, Science and Economic Development Canada's licence-exempt RSS(s). Operation is subject to the following two conditions:

(1) This device may not cause interference.

(2) This device must accept any interference, including interference that may cause undesired operation of the device.

The digital apparatus complies with Canadian CAN ICES-3 (B)/NMB-3(B).

French: Cet appareil contient des émetteurs/récepteurs exempts de licence qui sont conformes aux RSS exemptés de licence d'Innovation, Sciences et Développement économique Canada.

L'exploitation est soumise aux deux conditions suivantes :

(1) Cet appareil ne doit pas provoquer d'interférences.

(2) Cet appareil doit accepter toute interférence, y compris les interférences susceptibles de provoquer un fonctionnement indésirable de l'appareil.

l'appareil numérique du ciem conforme canadien peut - 3 (b) / nmb - 3 (b).

This device meets the exemption from the routine evaluation limits in section 6 of RSS 102 and compliance with RSS 102 RF exposure, users can obtain Canadian information on RF exposure and compliance.

cet appareil est conforme à l'exemption des limites d'évaluation courante dans la section 6 du cnr - 102 et conformité avec rss 102 de l'exposition aux rf, les utilisateurs peuvent obtenir des données canadiennes sur l'exposition aux champs rf et la conformité.

This equipment complies with Canada radiation exposure limits set forth for an uncontrolled environment.

Cet équipement est conforme aux limites d'exposition aux rayonnements du Canada établies pour un environnement non contrôlé.

#### RF Exposure Statement

The device has been evaluated to meet general RF exposure requirement. The device can be used in portable exposure condition without restriction.

L'appareil a été évalué pour répondre aux exigences générales d'exposition aux radiofréquences. L'appareil peut être utilisé en condition d'exposition portable sans restriction.

This equipment should be installed and operated with minimum distance 20cm between the radiator & your body.

Cet équipement doit être installé et utilisé à une distance minimale de 20 cm entre le radiateur et votre corps.

**Contact Us:**

Spacio Innovations Inc.

Email: [info@spacioinnovations.com](mailto:info@spacioinnovations.com)

[www.spacioinnovations.com](http://www.spacioinnovations.com)

**If any items are missing or damaged when opening the box:  
PLEASE CONTACT US BEFORE RETURNING THE HEATER TO THE  
RETAIL STORE! Please direct all inquiries to:  
[info@spacioinnovations.com](mailto:info@spacioinnovations.com)**