

### FCC Radiation Exposure Statement:

This equipment complies with FCC radiation exposure limits set forth for an uncontrolled environment. This equipment should be installed and operated with minimum distance 20cm between the radiator & your body.

### FCC Warning

This device complies with Part 18 of the FCC Rules.

Refer to FCC Part 18.213(c) and KDB 784748 Annex A section A.5:

(a) Max. Electric Field Emissions: 5.37V/m Max. Magnetic Field Emissions: 0.43V/m

(b) The maintenance of the system is the responsibility of the manufacturer.

© To prevent interference, the product should be as far away from devices operating at the same frequency as possible.

FCC ID: 2A7MQ-MAX800



[aivolt.official@gmail.com](mailto:aivolt.official@gmail.com)

[www.aivoltgroup.com](http://www.aivoltgroup.com)

# PORTABLE POWER STATION

## User Manual

PLEASE READ THIS MANUAL CAREFULLY BEFORE USE.

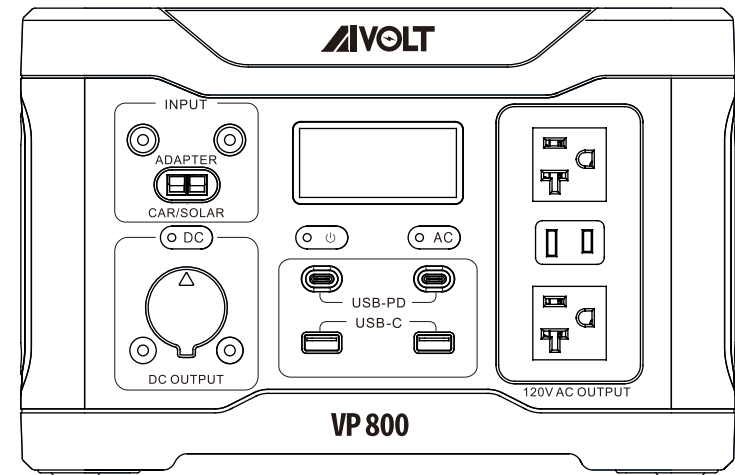

Improper use of the product may result in objects or personal injury. Be sure to read this manual carefully and fully understand this product before use.

This newly designed solar generator VP800 uses high-quality lithium-ion batteries as the main body for energy storage. Compact size, light weight, large capacity, easy to carry, with built-in USB ports, DC and AC outputs, this unit can provide power solutions to you quickly and easily wherever you are in outages or outdoors.

Please read this user manual carefully before using this unit. If you have any questions, please feel free to contact us.

- Use the charger provided to charge the unit and keep it works properly.
- Please read this manual before using this unit, check whether the product is in good condition and whether the accessories are complete.
- Product upgrades, appearance and screen printing will be adjusted locally without notice, please refer to the actual product.

## WHAT YOU GET

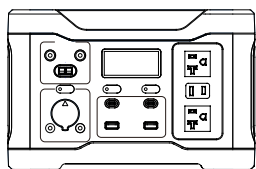

Portable Power Station

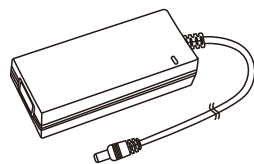

DC Adapter

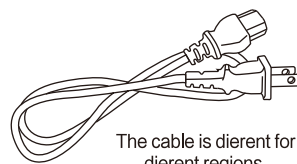

Power Cable

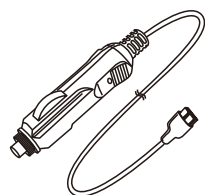

Car Charger Cable

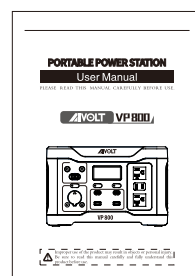

User Manual

## Potential Failure Analysis

### 1. Why is the LCD screen not lit up during charging operation?

**Analysis:** Once no operation for a long time, the LCD display will enter the energy-saving mode: turn off the display backlight board, adjust the display brightness. It may cause the illusion that the display is closed.

**Solution:** Tap the power/AC/DC switch to wake up the display.

### 2. Why does the charger heat up while charging?

**Analysis:** When the charger is in a room temperature environment, the surface temperature should be lower than 70°C, if the charger temperature is lower than 70°C, it is normal, if it is higher than 70°C, it may be a charger malfunction, except for extreme environments such as high temperature.

**Solution:** Charge at 0~40°C or replace with a new charger with the same specification.

### 3. Why does the appliance not work when plug into AC port?

**Analysis:** This unit can only support appliances within 800W, to check if the loaded appliances exceed the rated output power, if so, it will trigger overload protection.

**Solution:** Remove the load appliance, turn on the switch again, and the unit can be used normally.

### 4. Why is the output suddenly stopped during the use of this unit in high temperature?

**Analysis:** In extreme environment with high temperatures, overheating protection may occur in use.

**Solution:** Turn off the unit, after its automatic cooling, turn on the switch, it can be used normally. It is recommended to work below 40°C.

## Tips for Use

- This unit has built-in high-quality lithium-ion batteries, large capacity, long-lasting and durable. We recommend that you use it in the range of 5 to 35°C environment.
- If you do not use this unit for a long time, check that all switches are off.
- In order to extend the lifespan of this unit (lithium battery), it is recommended to charge once in every 3 months, at least once in every 6 months, to prevent the battery from losing power.
- During the use of this unit, do not block the fan exhaust. This unit integrates overload, overheating, short circuit, overvoltage, under voltage and other safety protection technologies, after troubleshooting, turn off the power switch and reopen it to reset the power supply to work again, if the reopening switch is invalid, you need to connect to the charger to charge 5s to wake up the battery, the unit can work normally.
- The LED illumination can be adjusted to five modes 25%,50%, 100% brightness, SOS mode, and flashing mode. Every time it can be adjusted by clicking the light button repeatedly with 1S interval.

## Recycling

Please send the used electronics, batteries and packaging materials to the recycle bin especially for lithium batteries. This can help with waste disposal and promote material recycling, to protect environment!

## Battery Information

This unit has built in high quality lithium-ion batteries. Do not disassemble the unit and remove the battery privately in case of destroying the unit. Batteries can be charged and discharged hundreds of times or more.

## Statement

Please be aware that this manual is only for this unit VP800 and does not represent the manual for others. In addition, this manual is provided as a guide only, the pictures in this manual are for reference only, and all statements, information and suggestions in this manual do not constitute any express or implied warranty. We are always dedicate to the improvement of product itself, therefore, the appearance and performance of units may be slightly different from this manual, please understand.

## Catalog

Safety Information	04
Product Specifications	05
Product Function	06
Smart LCD Display Screen	07
Recharging Ways	08
How to Use	09
Tips for Use	10
Recycling	10
Battery Information	10
Statement	10
Potential Failure Analysis	11

## Safety Information

- Do not disassemble or modify this unit privately.
- Do not use or store this unit in a high temperature environment and avoid direct sunlight.
- Do not use or store this unit in a dusty or humid environment.
- Do not heat this unit or place it in fire, water or other liquid.
- Do not place the unit sideways or upside down while using or storing.
- Do not charge with a non-standard charger.
- It is normal for the charger to heat up when charging.
- Do not charge for a long time, and disconnect the charger as soon as it is fully charged.
- Do not touch the input and output ports of this unit.
- Only use the output outlets to power external devices.
- Check the unit before each use. Do not use it if it is damaged or broken. Keep this unit away from children and do not allow children to use this unit alone. If the unit is accidentally dropped or hit, turn it off immediately.
- Carefully read the instructions for the appliances you intend to connect with this unit.
- Please use this unit with caution to avoid the risk of electric shock.
- If rust, odor, overheating or other abnormalities are observed, discontinue use of this unit immediately and contact us.
- This unit meets the relevant requirements for the transport of dangerous goods.
- Please dispose of the scrap according to the regulations and classify them in time to avoid explosions and pollution.

## How to Use

Example 1:

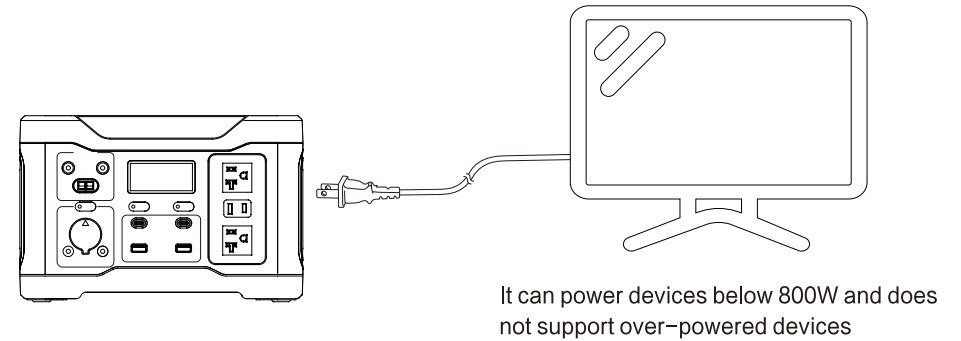

Example 2:

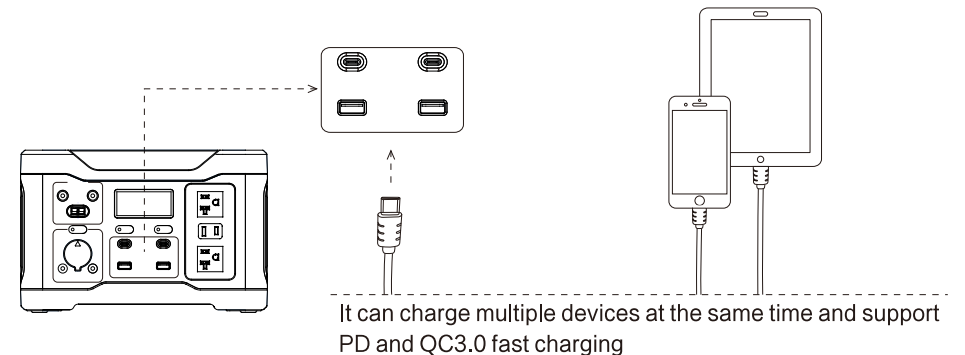

Example 3:

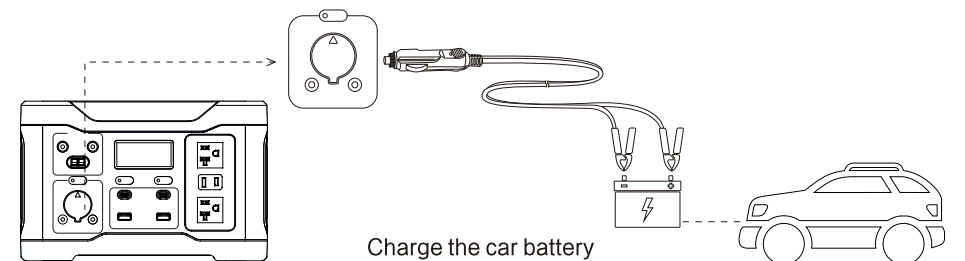

## Recharging Ways

Example 1:

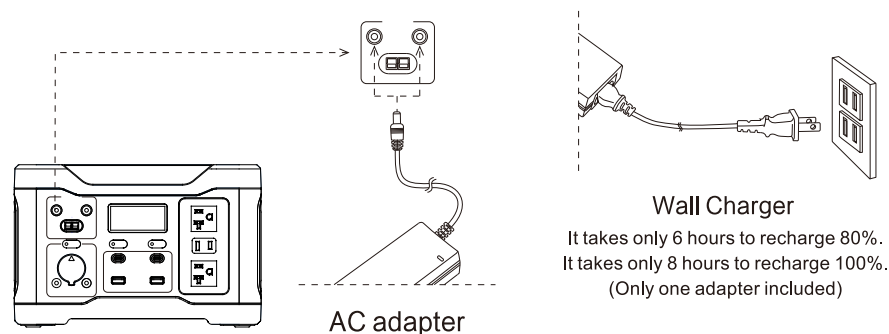

Example 2:

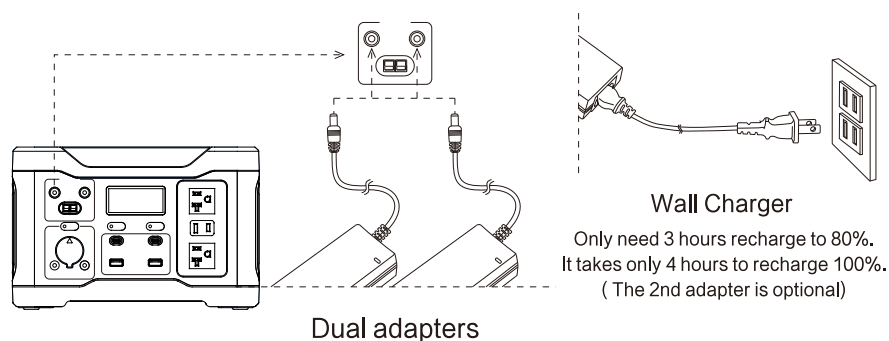

Example 3:

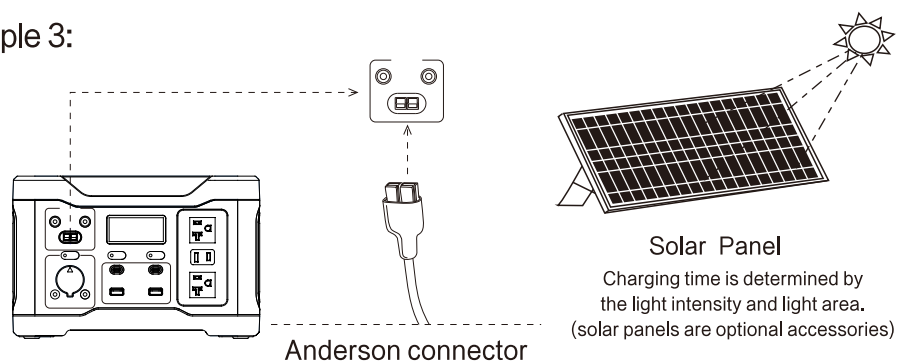

## Product Specifications

### ◆ Basic Specifications

Net weight: 7.4kg(16.31lbs)

Dimension: 279.4 × 193 × 181mm(11 × 7.6 × 7.13inches)

Battery Capacity: 241668mAh, 891.7Wh.

### ◆ Output

Wireless Charging: 15W

DC 5525 Output × 2: 13.6V=5A, Total 8A.

Car Outlet Output: 13.6V=8A

(DC 5525 Output (2)+ car port output: Total 8A max.)

USB-C Output × 2: 5V=2.5A, 9V=2A, 12V=2A(24W max.)

USB-PD Output: 5V/9V/12V/15V/20V=3.2A(65W max.)Total 130W.

AC Output × 3: 120V~ 60Hz, Total 800W.

Discharging Temperature: 14 to 104° F (-10 to 40° C)

Charging Temperature: 32 to 104° F (0 to 40° C)

### ◆ Input

PV Input: 18V-25V=15A max.

DC Input × 2: 48V=2.5A-120W max, Total 240W.

Car Charger Input: 12V, 100W max.

## Product Function

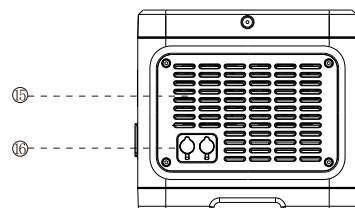
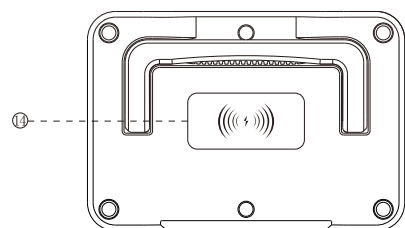
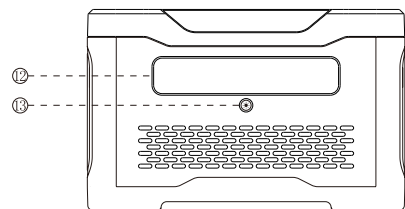
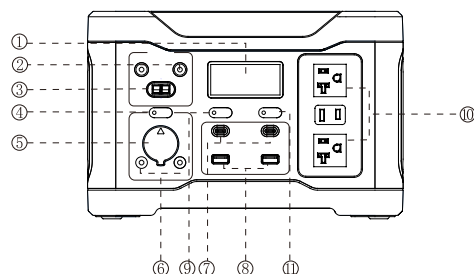

### 1.LCD display

Display the power and usage status of the unit.

### 2.Adapter charging

Plug the adapter connector into this port and connect the power cord to the mains power supply.

### 3.Car/Solar input

Support 3 (100W)solar panels in parallel, and support 18-25V, 300W input;Support car max 100W.

### 4.DC output switch

This button controls the product's auto charge output and the DC output of the two DC output ports.

### 5.Car output

### 6.DC output

This port is an output port, so input charging is prohibited.

### 7.USB-PD output

### 8.USB-C output

### 9.Power switch

click the power button to turn on the product, turn on the USB output port and top wireless charging.  
double click the power button to enter sleep mode.  
long press the power button to turn off.

### 10.120V AC output

Charge a device with a voltage requirement of 120V.(Donot support all excess appliances, the power of the power of the powered device should be less than 800W).

### 11.AC output switch

This button controls the AC outputs, turn off this switch when not in use.

### 12.LED light

The LED light has five modes, including: three brightness adjustments (25%, 50%, 100%), SOS mode and pop mode.

### 13.LED light button

Choose the mode of the LED light.

### 14.Wireless charging

It supports 15w wireless charging function.

### 15.Colling fan

Colling fan prevent the unit from overheating. Be careful not to obstruct the heat dissipation holes.

### 16.Parallel output

Can expand power and capacity.

## Smart LCD Display Screen

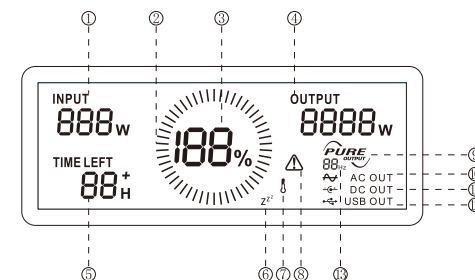

### 1.Input current

Display the current input power of the unit in watts in real time.

### 2.Battery level indicator

Display the remaining battery, and the icon rotates when charging and discharging.

### 3.Battery charge percentage

Display the percentage of remaining battery, and when the remaining battery is less than 5%, charge it.

### 4.Output Current

Display the current output power of the unit in watts in real time.

### 5.Remaining charge/discharge time

The remaining charging/discharging time is based on the current power consumption of the unit.

### 6.Sleep icon

When the unit goes sleep mode, the sleep icon appears on the screen.

### 7.Temperature protection

When the unit temperature is too high or too low, a temperature protection warning icon appears on the screen.

### 8.Warning

When the unit output is abnormal, alert icon appears on the screen.

### 9.Pure sine wave

When the AC output is used, pure sine wave AC output icon appears on the screen.

### 10.AC output icon

When the AC output port is in use, the AC output icon appears on the screen.

### 11.DC output icon

When the DC output port is in use, the DC output icon appears on the screen.

### 12.USB output icon

When the USB output port is in use, the USB output icon appears on the screen.

### 13. Frequency Display Icon

When the frequency displays 50/60 Hz, it indicates the current frequency status.