

# Digital Smart Calendar

FotoCube

User Manual

### 3.5 Sending Blessings

Blessings can be sent to the specified photo frame through the FotoCube APP on the mobile phone [【Refer to 2.7 How to Send Blessings】](#) .

### 3.6 Manage Frames

- **Share the frame pairing code**  
Click to pop up the QR code and pairing code of the frame device. You can take a screenshot to share or copy the digital pairing code for sharing.
- **Remote switch frame mode**  
Select your favorite frame mode for the specified frame device, such as cloud frame, family schedule, or art gallery.
- **Remote set frame background music**  
Send audio content to the specified frame device as the background music of the frame device.
- **Delete the bound frame**  
Click to unbind the frame device.

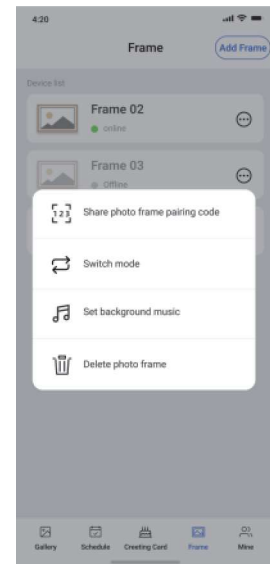

## 4. Language Support

The FotoCube photo frame supports multiple languages such as English, French, German, Portuguese, Spanish, Italian, Russian, Japanese, and Simplified Chinese, and is continuously updated (subject to the actual photo frame device used).

## 5. Warranty, Compliance, Technical Support, and Safety Information

For detailed information on warranty, hardware compliance, technical support, and safety, please refer to the information in the packaging.

<b>1. Getting started</b>	<b>1</b>
<b>2. FotoCube Photo Frame</b>	<b>1</b>
<b>2.1 How to Use FotoCube Photo Frame</b>	<b>2</b>
<b>2.2 How to Bind The Photo Frame Through The FotoCube APP</b>	<b>3</b>
<b>2.3 How to Use FotoCube Frame Offline</b>	<b>4</b>
<b>2.4 Cloud Photo Frame</b>	<b>4</b>
2.4.1 Operation	4
2.4.2 Menu	4
<b>2.5 Family Schedule</b>	<b>6</b>
2.5.1 Calendar	6
2.5.2 Daily To-Do List	7
2.5.3 Importing Schedules	8
2.5.4 Member List	9
2.5.5 Screen-Off	9
2.5.6 Switch Mode	9
<b>2.6 Art Gallery</b>	<b>9</b>
2.6.1 Display of Art Paintings	10
2.6.2 Switching Interval Time	10
2.6.3 Transition Effects	10
2.6.4 Select Mode	10
<b>2.7 How to Send Blessings</b>	<b>10</b>
<b>2.8 System Settings</b>	<b>11</b>
2.8.1 Picture Frame Settings	11
2.8.2 Account Management	11
2.8.3 Display Settings	12
2.8.4 Playback Settings	12
2.8.5 Wi-Fi	12
2.8.6 Help	12
2.8.7 System Information	13
<b>3. FotoCube APP</b>	<b>13</b>
<b>3.1 Quick Setup</b>	<b>13</b>
<b>3.2 Register an Account</b>	<b>13</b>

<b>3.3 Sending Photos and Videos</b>	<b>13</b>
<b>3.4 Manage the family schedule</b>	<b>13</b>
3.4.1 Select the frame to be managed	13
3.4.2 Create New Calendar Events (To-Do Items)	14
3.4.3 Adding New Family Members	14
3.4.4 Edit or Delete Family Members	14
3.4.5 Import Third-Party Schedules	14
<b>3.5 Sending Blessings</b>	<b>14</b>
<b>3.6 Manage Frames</b>	<b>15</b>
<b>4. Language Support</b>	<b>15</b>
<b>5. Warranty, Compliance, Technical Support, and Safety Information</b>	<b>15</b>

## Warning Statement

This device complies with part 15 of the FCC Rules. Operation is subject to the following two conditions:

- (1) This device may not cause harmful interference, and
- (2) this device must accept any interference received, including interference that may cause undesired operation. Any Changes or modifications not expressly approved by the party responsible for compliance could void the user's authority to operate the equipment.

**Note:** This equipment has been tested and found to comply with the limits for a Class B digital device, pursuant to part 15 of the FCC Rules. These limits are designed to provide reasonable protection against harmful interference in a residential installation. This equipment generates uses and can radiate radio frequency energy and, if not installed and used in accordance with the instructions, may cause harmful interference to radio communications. However, there is no guarantee that interference will not occur in a particular installation. If this equipment does cause harmful interference to radio or television reception, which can be determined by turning the equipment off and on, the user is encouraged to try to correct the interference by one or more of the following measures:

- Reorient or relocate the receiving antenna.
- Increase the separation between the equipment and receiver.
- Connect the equipment into an outlet on a circuit different from that to which the receiver is connected.
- Consult the dealer or an experienced radio/TV technician for help.

This equipment complies with FCC radiation exposure limits set forth for an uncontrolled environment. This equipment should be installed and operated with minimum distance 20cm between the radiator & your body.

## 1. Getting started

**If you are just starting to use FotoCube:**

1. Insert the power supply to start the photo frame;
2. Follow the guide on the screen to start setting up the photo frame step by step;
3. Complete the setup and start interacting with your friends and family.

### FotoCube Photo Frame



The FotoCube framework provides three modes: Cloud-Photo-Frame, Family-Calendar, and Art-Gallery. Choose the mode you like.

The touchscreen operation is easy to use, making photo sharing and family schedule management smoother and more convenient, providing you with a high-quality, simple, and enjoyable experience.

### FotoCube APP

The FotoCube app supports rich functions on Android and iOS systems, allowing for easy sharing of connected photo frames anytime and anywhere. No matter where you are in the world, you can send photos, videos, or manage the family schedule online in real-time at any time.

#### Download FotoCube APP

<p><b>F</b> <b>Method 1:</b> Scan the QR code to download the APP</p> <div data-bbox="279 1265 470 1456"></div> <p>Download from Google Play</p> <div data-bbox="518 1265 710 1456"></div> <p>Download from Apple store</p>	<p><b>F</b> <b>Method 2:</b> Search for and download the FotoCube APP in the app store</p> <ul style="list-style-type: none"><li>● <b>Android:</b> Search for "fotocube" on Google Play and then download the APP.</li><li>● <b>iOS:</b> Search for "fotocube" on the Apple Store and then download the APP.</li></ul>
---	--

## 2. FotoCube Photo Frame

### 2.1 How to Use FotoCube Photo Frame

When you use the framework for the first time, you need to set it up.

- **Choose a language:** Select your preferred language as the default language.

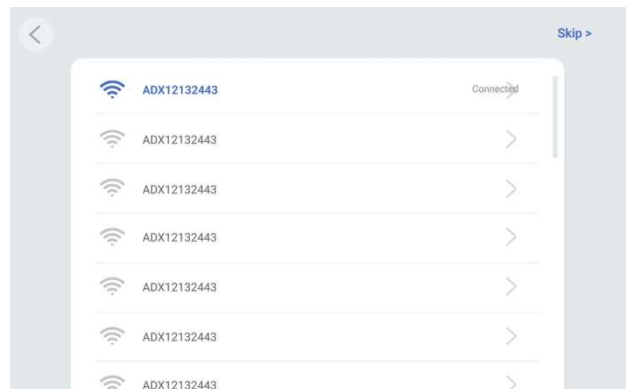
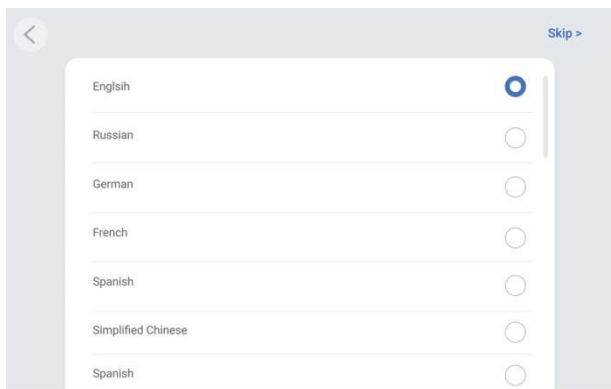

- **Connect to Wi-Fi:** Connect to the Wi-Fi at home to connect the photo frame to the internet.

- **Set Time Zone:** Set the time zone to accurately display time information.

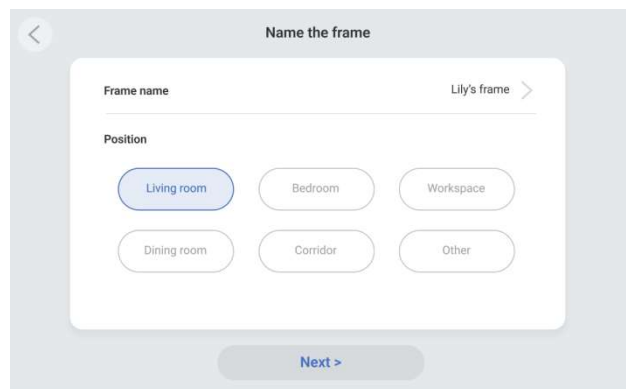
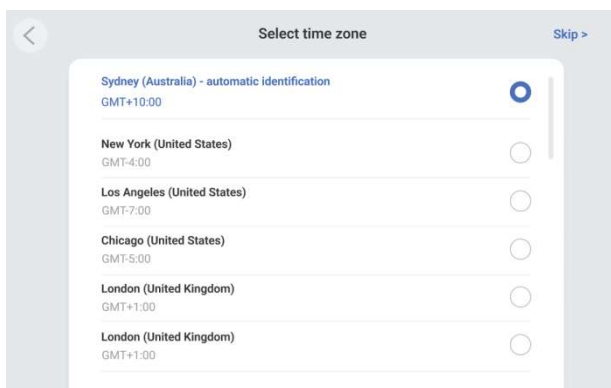

- **Set Time Zone:** Set the time zone to accurately display time information.

- **Novice Guide:** View the quick guide on the FotoCube frame.

- **Name the photo frame:** For example, "Lily's frame".

- **Set the location of the photo frame:** Such as the living room, kitchen, or office, to facilitate the distinction between different photo frame devices.



- **Selection Mode:** FotoCube photo frame supports 3 modes, please select the one you like.
- **Cloud Photo Frame:** Send photos or videos from your phone to the photoframe, which will be displayed on the screen in real time, an intelligent album that connects family emotions.
- **Family Schedule:** Share the family task board, easily add and manage the daily to-do items of the whole family, and improve family collaboration efficiency.

- **Art Gallery:** Automatically loop and play world-class artworks, bringing elegant art into your living space.

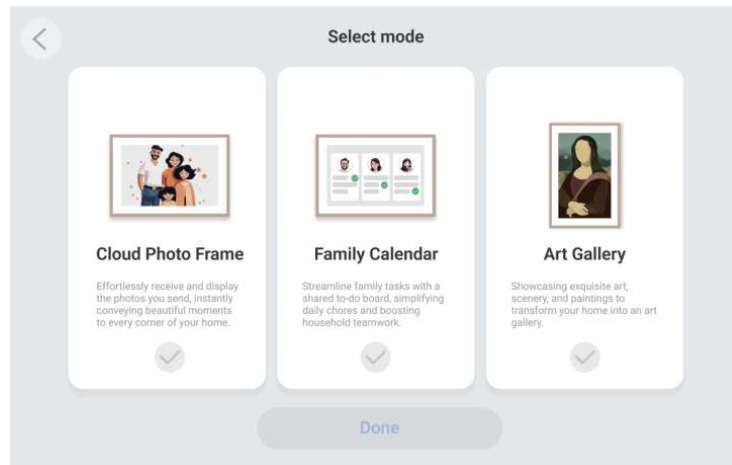

## 2.2 How to Bind The Photo Frame by The FotoCube APP

Make sure your photo frame is correctly connected to the Wi-Fi network and your mobile phone has downloaded and installed the FotoCube application.

### ● Pairing Code

Click the "Add" icon on the photo frame. A dialog box will appear, displaying the QR code and the pairing code (The pairing code is time-limited, please bind it within the valid period).

### ● Share the pairing code

Now, you can share the QR code or pairing code with your friends via your preferred methods, such as SMS, email, instant messaging, or phone calls.

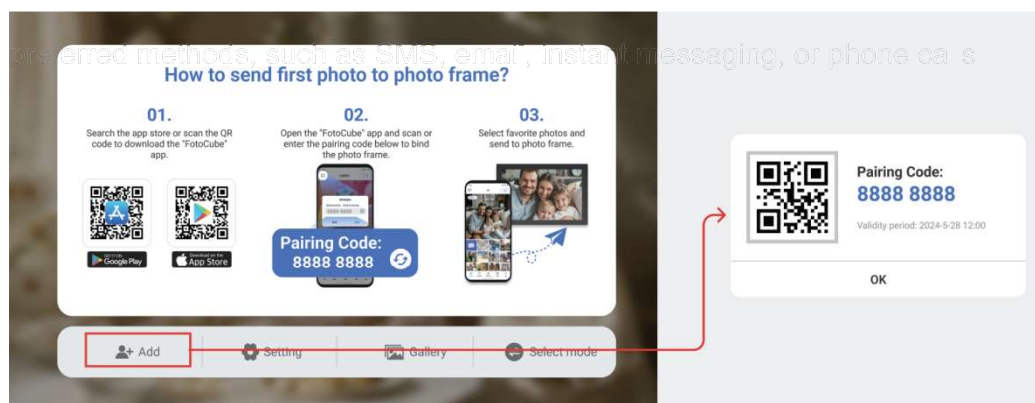

## ● Binding the photo frame with the mobile APP

Open the FotoCube App, register and log in to your account, then click the "Add New Photo Frame" button on the upper left corner. Scan the QR code of the frame or enter the pairing code to add the frame.

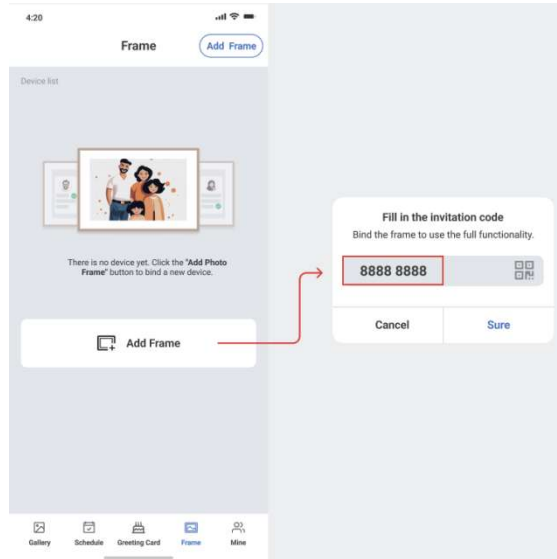

## ● Check connected frames

Once the frame is connected to your FotoCube application, you will be able to find them in "Settings -Account Management" on the frame or in the "Frame Devices" tab of the APP.

## 2.3 How to Use FotoCube Frame Offline

### ● External Storage (SD Card)

You can copy photos and videos to the SD card, then insert the SD card into the frame and view or play them through "Frame" - "Settings" - "Gallery" - "External SD Card".

## 2.4 Cloud Photo Frame

You can send photos or videos from your mobile phone to the photo frame, which will be displayed on the screen in real time. You can interact with the photo frame simply and conveniently through the touch screen.

### 2.4.1 Operation

Swipe left or right to view your photos. To access the menu bar, simply click once on the screen, which will display the menu.

### 2.4.2 Menu

In the menu, you can quickly access functions such as adding friends, settings, gallery, and mode switching. From the menu, you can also make relevant settings for the currently displayed photos, such as using the AI photoprocessing function, deleting, rotating, setting the playback order, and selecting the slide transition effect, etc.

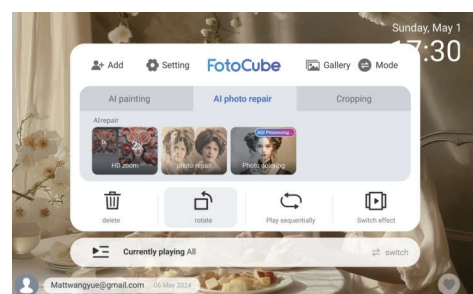



## ● Add more friends

Click the 【 Add 】 icon to generate a pairing code and QR code to connect the device. Use either the pairing code or the QR code to connect the photo frame to your mobile device, and then you can send photos.

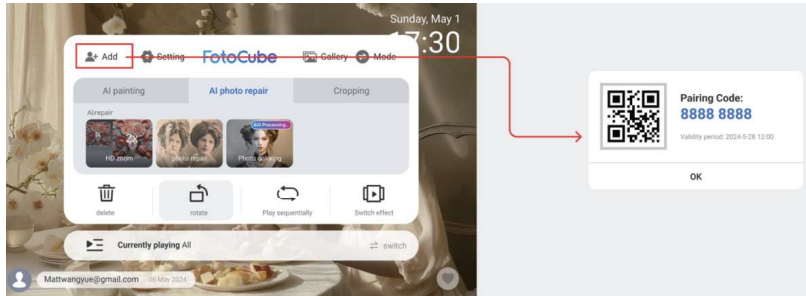

## ● Gallery

Open the gallery and browse the media sources in it.

- You can view the album list created by different accounts and the photos shared in each album.
- You can view the "liked" photos.
- You can start playing photos or videos from the current position of the photo or video you are viewing.
- You can play the album content of a specific account separately.
- You can play photos or videos in the SD card.

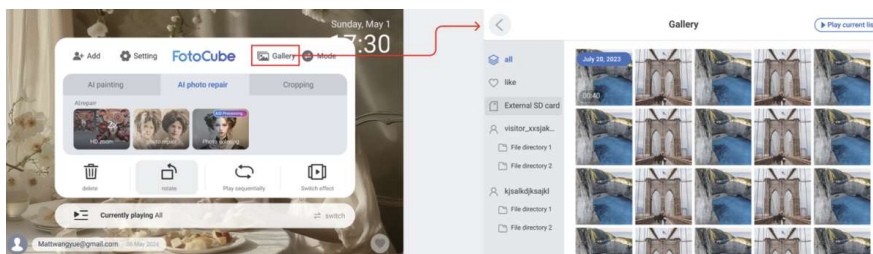

## ● Switching modes

Three modes are supported: Cloud Photo Frame, Family Schedule, or Art Gallery. Select and switch to your favorite mode.

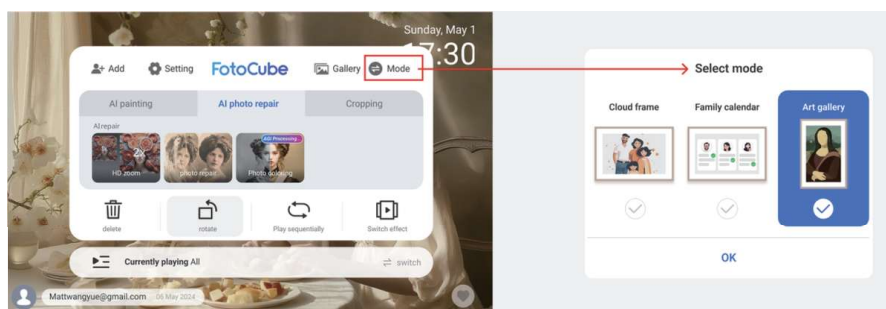

- **Shuffle/Sequential Play**

- **Shuffle Play:** Play the contents of the current playlist randomly.
- **Sequential Play:** Play the contents of the current playlist in sequence.

- **AI Portrait Restoration**

AI Portrait function is supported to restore the old portrait photos currently playing (more AI capabilities are continuously updated).

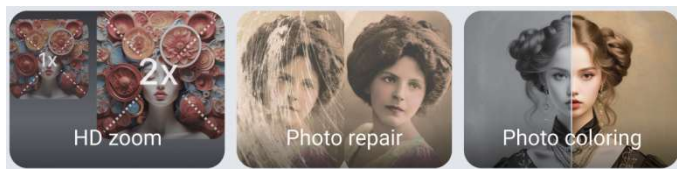

**New Schedule Event**

- **Cropping** The cropped photo is displayed in the frame in its original proportion.
- **Full Screen Photo Display** Click "Menu -> AI Crop -> Display mode -> Full Screen", which supports displaying all photos in full-screen mode.

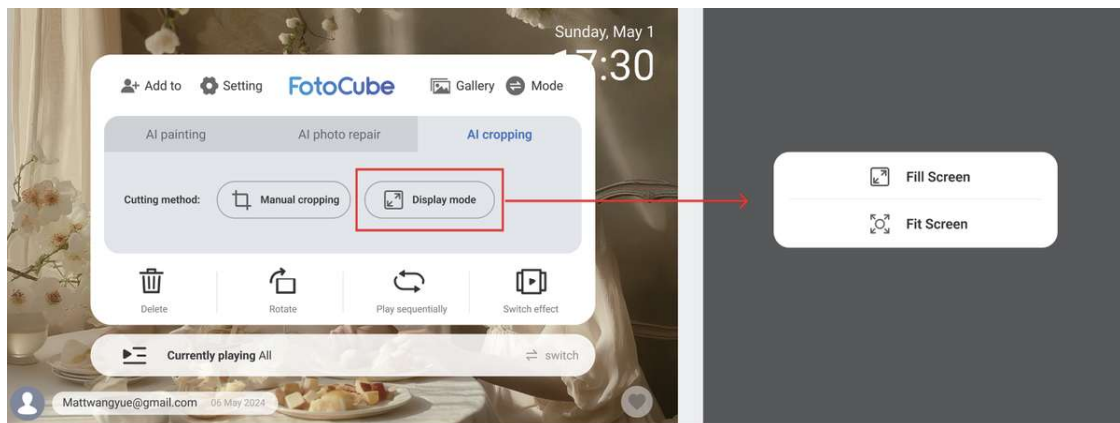

- **Delete** 🗑️ Click the "Delete" button to delete the current photo or video.
- **Rotate Photo** 🔄 You can rotate the photo clockwise by 90, 180, or 270 degrees.
- **Slide Show** 🎞️ Supports multiple slide transition effects, but only valid for photo slides.
- **Like** ❤️ Click the "Like" button on the screen to collect your favorite photos or videos.
- **Volume Settings** For video volume, you can adjust the volume level in "Settings".

## 2.5 Family Schedule

Share the family task board, easily add and manage the daily to-do items of the whole family, and improve the efficiency of family collaboration.

### 2.5.1 Calendar

Display the schedule information of the week/month. Also display the current time, date, and the name of the family photo frame.

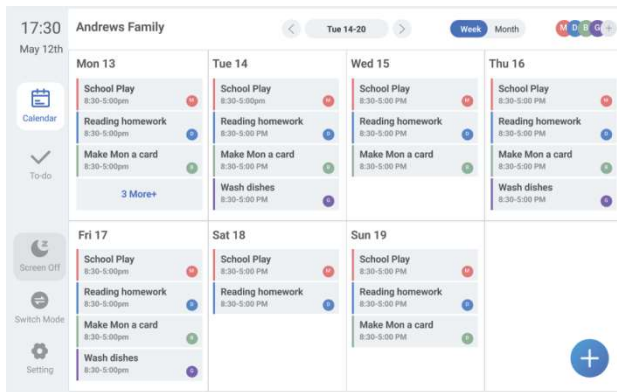

## ● New Schedule Event

**+** **Add Event:** Click the "+" button to create a new schedule, and it will be synced to the schedule list of all members bound to this photo frame via the cloud.

**🎉 Emoji Support:** Content creation supports the inclusion of Emoji expressions, and synchronization of these Emojis is supported between mobile phones and the photo frame for consistent display.

## ● Edit the schedule

Click on the schedule event to edit or delete the schedule.

## ● Switch between week/month views



Supports viewing in "Week" and "Month" views. Click to switch to the next week/month or the previous week/month.

## ● Schedule reminder

Expiring schedules will be reminded in the form of a pop-up window.

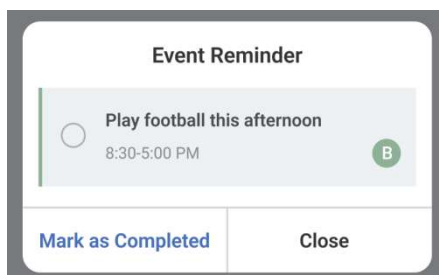

## 2.5.2 Daily To-Do List

Display the daily to-do task list by member dimension.

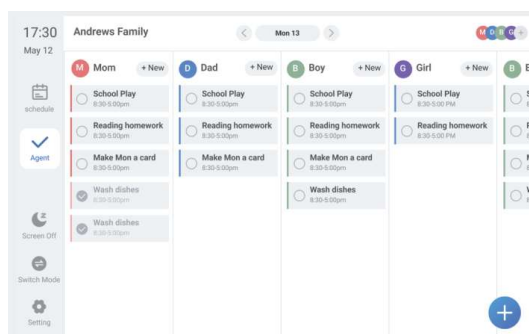

- **Create a To-Do**

Displays the name, time, and person in charge of the to-do item.

- **Edit a To-Do**

Click on the to-do item to edit the content.

- **Complete a To-Do Task**

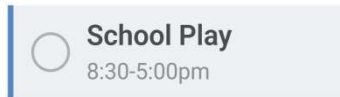

Click the circular button on the left to complete the task.

- **Reminder for Agents**

Expired items will be reminded in the form of pop-up windows.

## 2.5.3 Import Schedule

### Schedule Synchronization:



#### Google Calendar Real-time Sync:

- Open FotoCube -> After logging in, click the "Schedule" tab at the bottom.
- Click the "Import" button in the top-right corner.
- Sync with Google Calendar.
- Log in to your Google Account and authorize consent.
- Choose between one-way or two-way synchronization.
- Select the calendar categories you wish to Sync.
- Complete the schedule synchronization a few minutes later.



#### iCloud Calendar Subscription:

- Open Apple Calendar.
- Click "Calendar."
- Click "Info."
- Turn on the "Public Calendar" switch.
- Copy and paste the URL link.
- Complete the schedule import a few minutes later.

- **Import Local Calendar Events from Mobile Devices:**

Supports importing local third-party schedules from Google Calendar, Apple Calendar, Microsoft Outlook, and other mobile apps.

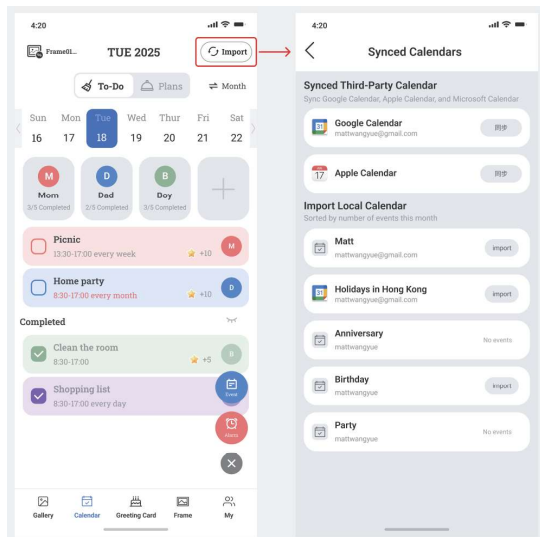

## 2.5.4 Member List

Supports adding, deleting, and editing member information.

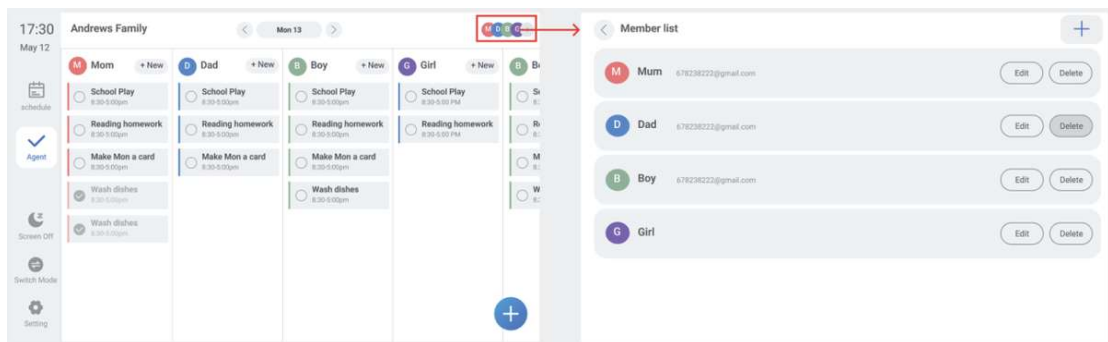

## 2.5.5 Screen-Off

 Click to enter the screen-off state, and clicking the power key on the back of the photo frame will wake up the screen again.

## 2.5.6 Switch Mode

 Click the "Switch Mode" button to pop up the mode switching selection pop-up window, which can quickly switch to Cloud-Photo-Frame or Art-Gallery mode.

## 2.6 Art Gallery

Automatically loops world-class artworks, bringing elegant art into your living space.



## 2.6.1 Display of Art Paintings

The name of the painting, the author and the time.

## 2.6.2 Switching Interval Time

Supports switching of playback intervals of 【5s | 10s | 60s | 5min | 1h | 24h】 , the actual interval is subject to the photo frame device.

## 2.6.3 Select Mode

- ➡ Support clicking the "Switch Mode" button to quickly switch to other Cloud-Photo-Frame or Family-Schedule modes.

## 2.7 How to Send Blessings

1. Open and log in to the FotoCube APP on your mobile phone, and click on the "Greeting Card" tab.
2. Write down your wish in words.
3. Choose a festival style.
4. Select the photo frame to which you want to send your blessing.

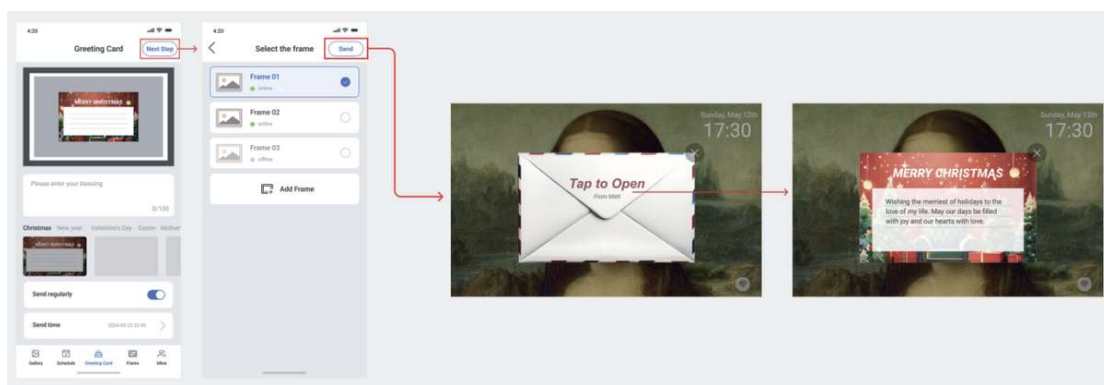

## 2.8 System Settings

You can personalize the photo frame according to your own needs through settings.

### 2.8.1 Picture Frame Settings

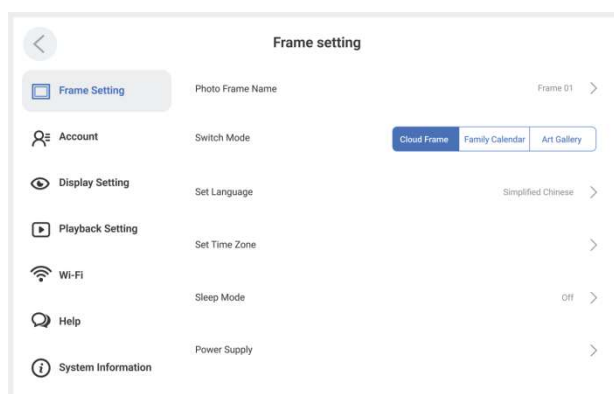



- **Frame name**

Set or modify the frame name. The modified name will be displayed in the family name of the schedule, the connected devices, and the device list of the FotoCube APP.

- **Switch mode**

Supports 3 modes: cloud frame, family schedule, and art gallery. Click to switch to your favorite mode.

- **Set language**

Select your favorite system language.

- **Set time zone**

Select the time zone for the frame to display the accurate time and date.

- **Sleep mode**

Choose whether to enable sleep mode according to your preference. After enabling sleep mode, the device enters a low-power and low-operation state during non-working hours to achieve the purposes of energy saving and reducing interference.

- **Power**

Select shutdown, restart, or screen off by clicking the button.

## 2.8.2 Account Management

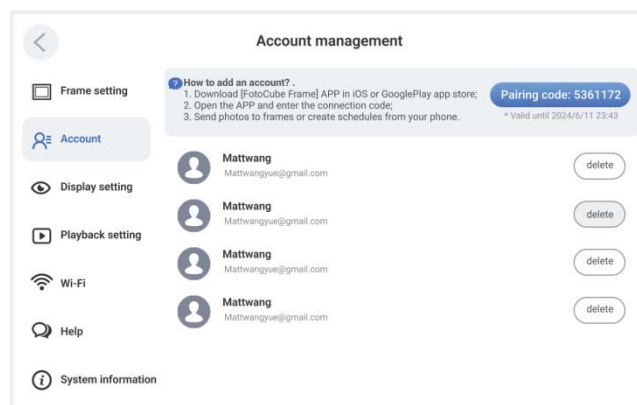

- **Add Account**

The page will display the current valid digital pairing code, and the binding operation can be performed through the FotoCube APP. For details, refer to the chapter [【2.2 How to Bind the Photo Frame through the Mobile FotoCube Application】](#).

- **Bound accounts**

Displays a list of all members with bound accounts. The unbinding operation of the account can be performed by clicking the "Delete" button.

## 2.8.3 Display Settings

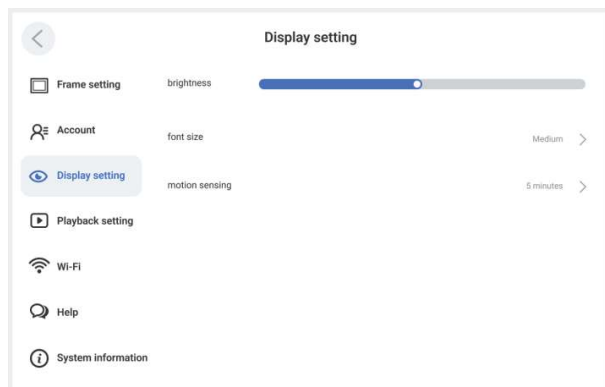

- **Brightness**

Adjust the screen brightness to obtain a comfortable visual experience

- **Font size**

Set the font size of the system language.

## 2.8.4 Playback Settings

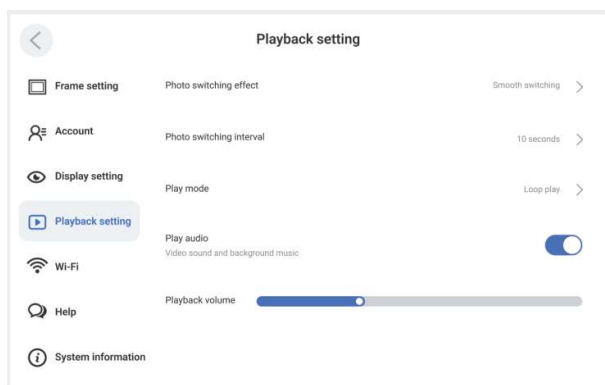

- **Photo transition effect**

Select your favorite transition effect.

- **Photo transition interval**

Select a suitable transition interval.

- **Play mode**

Select your favorite play mode.

- **Play audio**

Choose whether to play video sound and background music.

- **Play volume**

Adjust the volume to a suitable size.

## 2.8.5 Wi-Fi

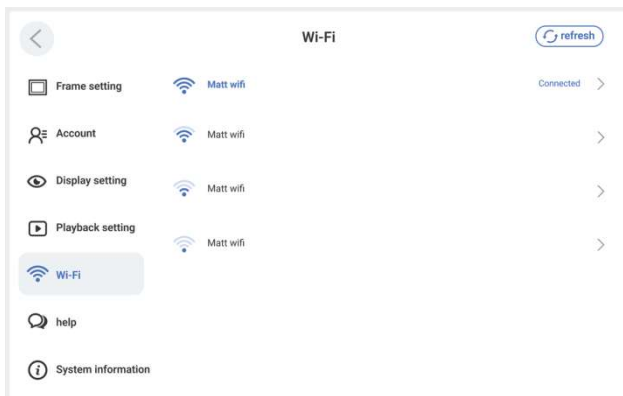

- **Connect to Wi-Fi**

Enter the password to connect to Wi-Fi.

- **Reset Wi-Fi**

You need to go to "Settings" -"System Information" -"Restore Factory Settings"and Wi-Fi will also be restored to factory settings. Data cannot be recovered.

## 2.8.6 Help

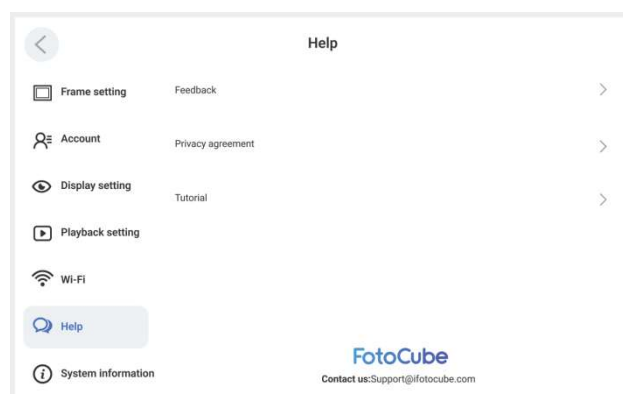

- **Feedback**

Please describe the specific problem you encountered, and we will handle and reply as soon as possible.

- **Privacy Agreement**

Display the content of the privacy agreement.

- **User Guide**

Display the content of the user guide.



## 2.8.7 System Information

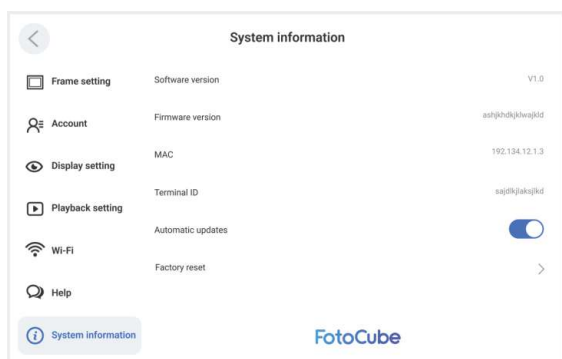

- **Software/Firmware Version**  
Check for frame software/firmware version updates
- **MAC**  
Displays the MAC address of the frame.

- **Terminal ID**  
Displays device ID information.

- **Auto-update**

It is recommended to enable. When enabled, the device will automatically install downloaded higher versions. If disabled, manual installation is required.

- **Restore Factory Settings**

Warning: Resetting the family frame will delete all photos and settings stored on the frame. Please ensure that you have backed up all important data, as once reset, this data cannot be recovered.

## 3. FotoCube APP

### 3.1 Quick Setup

As an important management and connection device, the APP needs to be registered via email, and can be used only after login.

### 3.2 Register an Account

Register an APP account using an email address. After logging into the APP, you can use functions such as sending photos, remote control, and family schedule management.

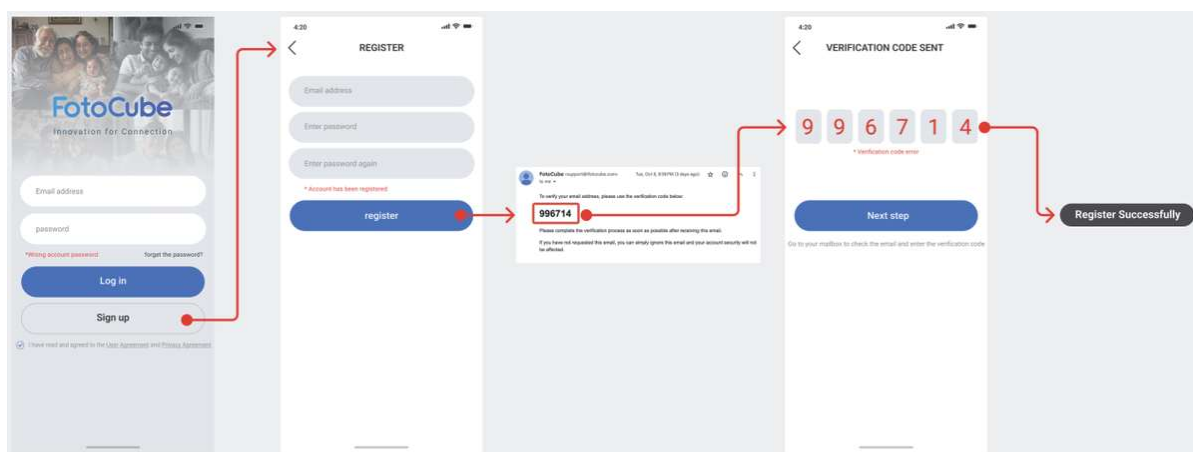

## 3.3 Sending Photos and Videos

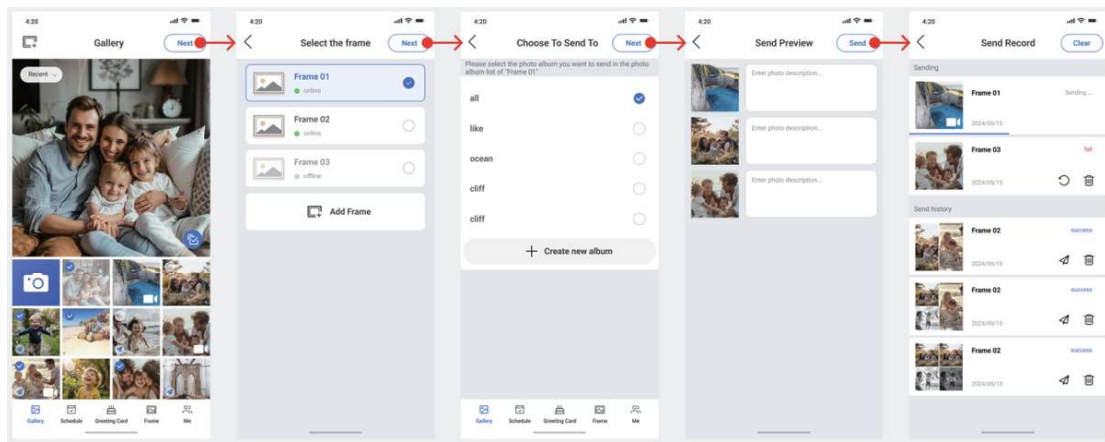

### ● Send Photos

(1) Select one or more photos; (2) Select a photo frame; (3) Select the album to send; (4) Describe the photo; (5) Click "Send".

### ● Send Videos

(1) Select a video; (2) Select a photo frame; (3) Select the album to send; (4) Describe the video; (5) Click "Send".

### ● Create a New Album

You can create a new album and send photo or video content to the specified album. On the photo frame, you can let the photo frame play the photos and videos of the specified album.

### ● Sending History

You can view the status of the photo sending task and perform re-sending and deleting record operations in the sending history list.

## 3.4 Manage the family schedule

### 3.4.1 Select the frame to be managed

The top left corner of the schedule page of the mobile application shows the currently managed frame device. If the frame is not bound, please bind the frame first before performing schedule management operations. For details, refer to the [【2.2 How to bind the frame through the mobile FotoCube application】](#) chapter.

### 3.4.2 Create New Calendar Events (To-Do Items)

- Click the "+" button in the lower right corner, enter the title, select all-day or the start time, select whether to repeat and assign to the corresponding family member, and click the "Add" button to complete the operation of creating a new schedule.
- By default, the information of the newly created schedule will be synchronized to the To-Do list.

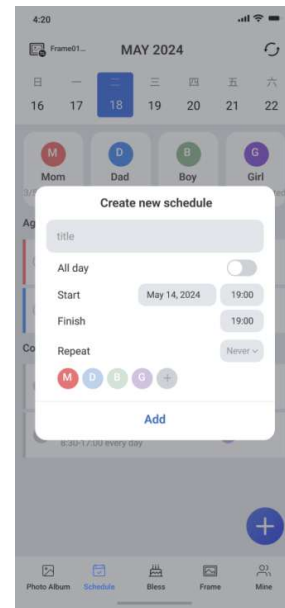

### 3.4.3 Adding New Family Members

Click the "+" button below the date on the schedule page to add new family members. You can set nicknames, email accounts, and exclusive background colors for new family members.

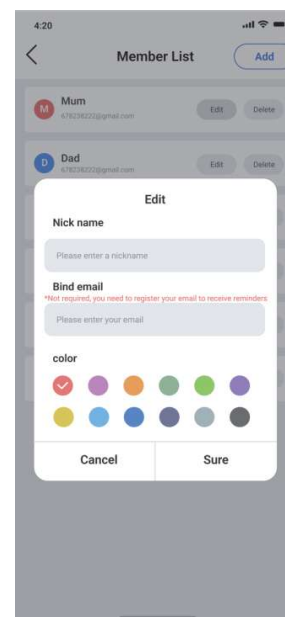

### 3.4.4 Edit or Delete Family Members

You can edit or delete the family members on the current photo frame in the member list of the mobile application.

### 3.4.5 Import Third-Party Schedules

Support importing local third-party schedule data on the mobile phone. Open the FotoCube APP "Home Page" - "Schedule" - "Import", and select the schedule types to be imported [【Refer to 2.5.3 Import Schedule】](#) .

# Digital Smart Calendar

**FotoCube**

Innovation for Connection

