

Wireless Microphone

User Manual



Introduction

Thanks for choosing our product.

This product is a smart wireless microphone that provides professional-grade recording output. Plug and play, no app required. Multiple uses: It can be used in online live broadcast, video Vlog shooting, program interview, recording, video teaching and other occasions.

The wireless Microphone consists of two parts, one is Microphone transmitter, the other one is receiver. (See as below picture)

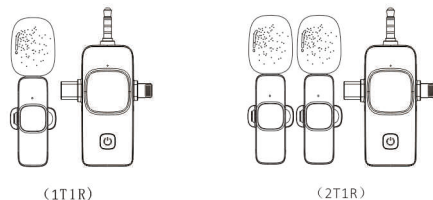

ID Diagram

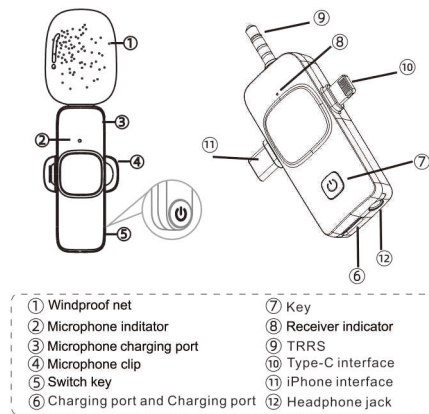

How to use

Short press the power button on the sending end for 1 second to turn on the device, and the indicator light will flash red and green. Press the power button for 1 second on the receiving end, and the receiver will only flash green and enter the automatic pairing state with the transmitter. After successful pairing, the blue lights of the transmitter and receiver will remain on. At this time, the wireless microphone can be connected to the device for recording and use normally.

This product is a multifunctional wireless microphone that can record multiple devices on one device. Sound demand, suitable for Android phones, Apple phones, computers, tablets, Camera, 3.5mm old Android phone light device for recording, and speaker expansion. Note: Please adjust the appropriate volume and Distance to avoid severe howling.

How to use

Short press the power button on the sending end for 1 second to turn on the device, and the indicator light will flash red and green. Press the power button for 1 second on the receiving end, and the receiver will only flash green and enter the automatic pairing state with the transmitter. After successful pairing, the blue lights of the transmitter and receiver will remain on. At this time, the wireless microphone can be connected to the device for recording and use normally.

This product is a multifunctional wireless microphone that can record multiple devices on one device. Sound demand, suitable for Android phones, Apple phones, computers, tablets, Camera, 3.5mm old Android phone light device for recording, and speaker expansion. Note: Please adjust the appropriate volume and Distance to avoid severe howling.

About UI

Transmitter TX

Function/Status	Operate	Lamp effect
Power on	Short press the power button for 1 second	Alternating flashing of traffic lights
Shutdown	Press and hold the button for 3 seconds	All lights off
Search pairing		Alternating flashing of traffic lights
Paired successfully	Automatic connection and pairing upon startup	Green light always on
LOW BATTERY	On state	Red light flashes twice every 10S
Charge	Charging with TC cable	Red light always on, full red light off
Mute	Press the button briefly	Green light flashing
Reverberation function	Short press the button twice	Flashing red light once to turn green light for reverberation
Monitor Function	Plug in the TC analog headphone cable	
Connectionless	After 3 minutes, automatically turn off	All lights off

Receiver RX

Function/Status	Operate	Lamp effect
Power on	Short press the power button for 1 second	Alternating flashing of traffic lights
Shutdown	Press and hold the button for 3 seconds	All lights off
Search pairing		Alternating flashing of traffic lights
Paired successfully	Automatic connection and pairing upon startup	Green light always on
LOW BATTERY	On state	Red light flashes twice every 10S
Charge	Charging with TC cable	Red light always on, full red light off
Sound card/camera mode	Press the button briefly	Blue light, green light, two lights always on (cyan)
Amplifier mode	Press the button briefly	Green light always on
Phone mode	Press the button briefly	Blue light always on

Packing List

- (1) Microphone Transmitter(TX)
- (2) Receiver (RX)
- (3) Type-C charging cable
- (4) User manual

Warning:

This device complies with Part 15 of the FCC Rules. Operation is subject to the following two conditions: (1) this device may not cause harmful interference, and (2) this device must accept any interference received, including interference that may cause undesired operation.

Changes or modifications not expressly approved by the party responsible for compliance could void the user's authority to operate the equipment.

NOTE: This equipment has been tested and found to comply with the limits for a Class B digital device, pursuant to Part 15 of the FCC Rules. These limits are designed to provide reasonable protection against harmful interference in a residential installation. This equipment generates, uses and can radiate radio frequency energy and, if not installed and used in accordance with the instructions, may cause harmful interference to radio communications. However, there is no guarantee that interference will not occur in a particular installation.

If this equipment does cause harmful interference to radio or television reception which can be determined by turning the equipment off and on, the user is encouraged to try to correct the interference by one or more of the following measures:

- Reorient or relocate the receiving antenna.
- Increase the separation between the equipment and receiver
- Connect the equipment into an outlet on a circuit different from that to which the receiver is connected.
- Consult the dealer or an experienced radio/TV technician for help

NOTE: This device and its antenna(s) must not be co-located or operation in conjunction with any other antenna or transmitter

The device has been evaluated to meet general RF exposure requirement. The device can be used in portable exposure condition without restriction.