

TEA MAKER

Instructions for use

Mode d'emploi ♦ Bedienungsanleitung Istruzioni per l'uso

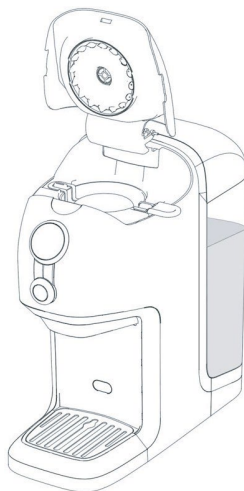

Get the most out of the Bru Tea Machine by downloading the Bru APP.



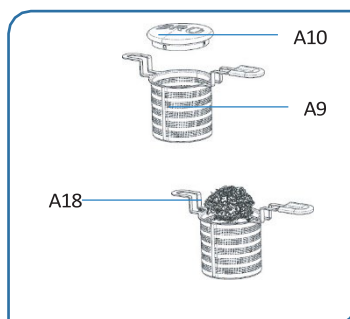
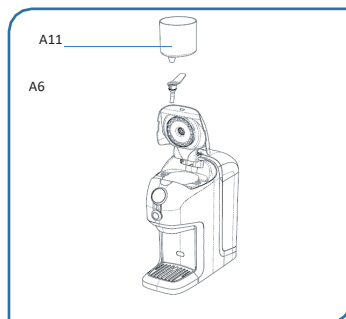
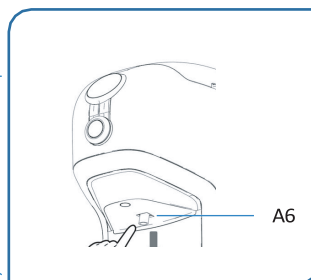
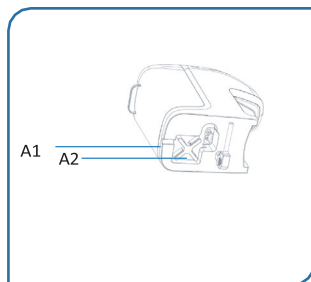
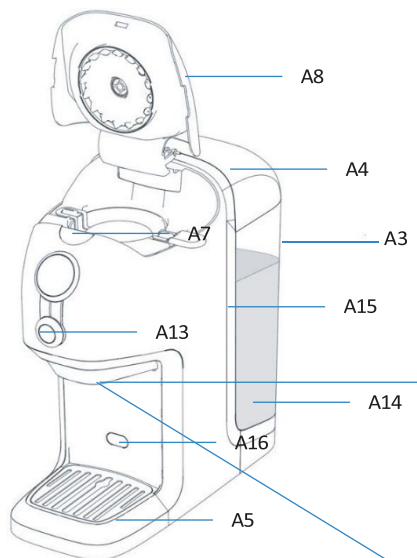

1

2

3

4

5

6

7

8

9

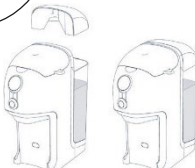
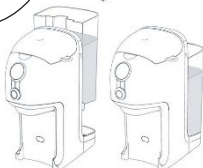
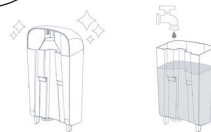
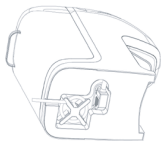

10



11



12



13



14

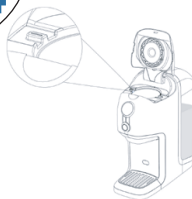

15



16



17

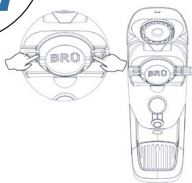

18

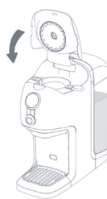

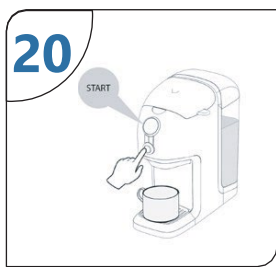
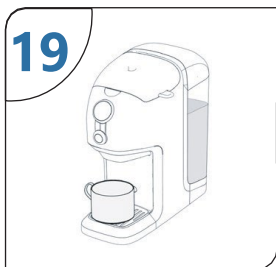

English

Deutsch

Read carefully this user manual before first use. Pay special attention to the security instructions. Keep this manual for later consultation.



WARRANTY AND AFTER-SALES

Warranty conditions

As of 1 January 2022, BRU guarantees the proper functioning of its products for a period of 2 years from the date of purchase. This warranty only applies to products used for domestic purposes. Any other use in the context of professional use by a natural or legal person excludes any application of the warranty. This product is guaranteed against any failure resulting from faulty workmanship or materials. This warranty does not cover defects or damage resulting from improper installation, incorrect use or normal wear and tear of the product. Please keep your proof of purchase to verify any claims under guarantee.

Availability of spare parts

BRU has spare parts for its products for a 2-year period. You can find accessories and spare parts for your BRU products sold by our partners mentioned on our website or directly on our website bru-tea.com. If your accessory or spare part is not available, please contact our after - sales service at info@bru-tea.com

★★★★★ Customer reviews

If you are satisfied with your product, please submit a review on the website where you placed your order to help other users make their choice. If you are not totally satisfied with your product, please write to us at this email address info@bru-tea.com. Our customer service will listen to your complaints or recommendations in order to satisfy you and improve our products. (optional)

INTENDED USE

Tea Brewing Machine – BRU MAKER ONE – is the first smart home, integration IoT, app - connected tea machine with patented technology. It is the only one on the market to work with any kind of tea.

BRU is all about the perfect cup of tea. We develop and sell automated, smart, user - friendly tea making machines for brewing fresh, full -taste tea using either loose - leaf or tea bags, providing a high quality, quick and convenient solution for tea drinkers. The innovative BRU Maker One solves the problems involved with the time consuming, messy and often wasteful business of tea-making, and replaces it with a seamless, more sustainable and effortlessly repeatable process.



SAFETY PRESCRIPTIONS

IMPORTANT! Failure to observe the warnings could result in injury or damage to the appliance

1. Read the Instruction before using. Save these instructions for future reference.
2. **DANGER!** Failure to observe the warning may result in life threatening injury by electric shock.
3. **DANGER!** The appliance must not be immersed.
4. **DANGER!** Avoid spillage on the connector.
5. After removing the packaging, make sure the product is complete and undamaged, and that all the accessories are present. Do not use the appliance if it is visibly damaged. Contact BRU customer services.
6. Do not leave pieces of packaging (plastic bags, polystyrene foam, nails etc.) within reach of children or persons with reduced mental capabilities, since these are potential sources of danger
7. The heating element surface is subject to residual heat after use.
8. The appliance is intended to brew tea or infusion only. Any other use is considered improper and thus dangerous. The manufacturer is not liable for damage deriving from improper use of the appliance
9. This appliance can be used by children aged from 8 years and above if they have been given supervision or instruction concerning use of the appliance in a safe way and understand the hazard involved. Cleaning and user maintenance shall not be made by children unless they are older than 8 and supervised. Keep the appliance

and power cord away from children under 8 years of age. (Not valid for Canada and USA).

10. This appliance is not intended for use by persons (including children) with reduced physical, sensory or mental capabilities, or lack of experience and knowledge, unless they have been given supervision or instruction concerning use of the appliance by a person responsible for their safety. (Only for Canada and USA)
11. The appliance can be used by persons with reduced physical, sensory or mental capabilities or lack of experience and knowledge if they are supervised or have been given instruction concerning use of the appliance in a safe way and if they understand the hazards involved. (Not valid for Canada and USA; for Canada and USA This appliance is not intended for use by persons (including children) with reduced physical, sensory or mental capabilities, or lack of experience and knowledge, unless they have been given supervision or instruction concerning use of the appliance by a person responsible for their safety.)
12. Children should be supervised to ensure that they do not play with the appliance.
13. Cleaning and user maintenance shall not be made by children without supervision
14. Always unplug the appliance when left unattended and before assembly, taking apart or cleaning.
15. This is an electrical appliance and may cause electrical shocks. You should therefore follow these safety warnings:
 - Never touch the appliance with damp hands or feet.
 - Never touch the plug with damp hands.
 - Do not leave the appliance exposed to atmospheric agents (sun, rain, etc.).
 - Make sure the socket used is freely accessible at all times, enabling the appliance to be unplugged when necessary.
 - Unplug directly from the plug only. Never pull the cord as you could damage it.
 - To disconnect the appliance completely you must unplug it from the main socket.
 - If the appliance is faulty, do not attempt to repair. Turn it off, unplug from the main socket and contact Customer Services,
 - Before cleaning the appliance, turn it off, unplug from the main sockets and allow to cool.
16. Always attach plug to appliance first, then plug cord into the wall outlet. To disconnect, turn any control to off, then remove plug from wall outlet.
17. Unplug from outlet when not in use and before cleaning. Allow the appliance to cool down before handling any parts and before cleaning the appliance.

18. This appliance is intended to be used in household and similar applications such as: staff kitchen areas in shops, offices and other working environments; farm houses; by clients in hotels, motels and other residential type environments; bed and breakfast type environments.
19. If the supply cord is damaged, it must be replaced by the manufacturer, its service agent or similarly qualified persons in order to avoid a hazard.
20. Do not let the power cord hang over the edge of a table or counter and do not let it get in contact with hot surfaces or water.
21. If the brewing chamber is damaged, it must be replaced by customer service to avoid any risk
22. Wash Brewing glass chamber can be washed in the dish washer
23. The use of accessories, which were not provided or recommended by the manufacturer may lead to fire, electric shock, or serious personal injury
24. Do not use abrasive cleaners or scouring pads.
25. Do not use appliance when the water dispenser is empty, it may cause mal-function.
26. The brewing Glass chamber should be cleaned once a week
27. The tea sieve should be cleaned after the tea is changed
28. Before connecting the plug to the socket outlet check that the working voltage of the appliance corresponds to the one in your house. If in doubt, contact a professionally qualified technician.
29. Connect the product only to a socket provided of ground connection. The electrical safety of this appliance is ensured only if it is correctly connected to an effective earthing system in compliance with the existing electrical safety standards. BRU AG cannot be held responsible for any damage caused by the lack of an earthing system.
30. If the use of an extension cords is necessary, be sure that extension cord is certified, suitable for the product ratings and provided of ground wire connection; while in use, unwind the cord completely
31. Use and place the product on a flat, stable and heat resistant surface.
32. Do not use the appliance if it has fallen down or if it shows signs of damage, water leakage or defects that alter its operation.

33. In case of failure and/or malfunctioning of the appliance, turn it off and do not tamper with it; do not disassemble the appliance due to any reason;
34. Do not place on or near a hot gas or electric burner, or in a heated oven.
35. Do not place the appliance or power cord close to or on top of hot electric or gas cookers
36. Fill the water tank only with mineral water! Do not insert any other liquid in the tank.
37. Clean all the components before use. Follow the cleaning Instruction (section 5) and never clean by immersing the appliance or any electrical part of it in the water
38. Never place the appliance under running water.
39. Never place the product in the dishwasher for cleaning.
40. This appliance complies with applicable European directive and regulation to which the product must be conform. (not valid for CA and USA)



DANGER OF BURNS

Surfaces marked with this symbol become hot during use.

Glass brewing chamber and Tea sieve can become hot, manage with attention.

Do not move the appliance while in use. Before carrying, transporting or storing the oven, ensure that it has sufficiently cooled down.

Scalding may occur if the lid (A8) is removed during the brewing cycles.

Failure to observe the warning could result in scalds or burns. This appliance produces hot water and steam may form while in it is operation. Avoid contact with splashes of water or hot steam or hot brewing glass chamber.

1. DESCRIPTION OF THE APPLIANCE

	Description of the appliance
A1	Power cord
A2	Powered cord storage
A3	Water tank

A4	Water tank lid
A5	Magnetic drip tray
A6	Silicone nozzle
A7	Lid opening button
A8	Machine lid
A9	Tea Sieve
A10	Tea Sieve lid
A11	Glass brewing chamber
A12	Tea leaves
A13	Main button
A14	Water tank floating magnet
A15	Thermo reset button
A16	Cup Sensor
A17	Descaling
A18	Tea leaves

2. TECHNICAL INFORMATIONS

	Europe	USA-CAN
Supply data	220-240 V; 50 Hz	120 V; 60 Hz
Power input	2200W	1700W
Water Tank Capacity	3 liter	80 Oz
Size LxHxD	40x40x25 cm	5.9' x 8' x 11'
Weight	3,2 kg	6.6lb

3. FAST INSTRUCTION – Setting up the machine

- Plug in the power cord (A1) in the machine
- Adjust the length of the cord as needed in the power cord storage (A2) (picture 2)
- Rinse the water tank (A3), fill it with fresh water (picture 3) *Caution, only use water safe to drink, no other liquids.
- Install the water tank, making sure that is aligned (picture 4)
- Close the water tank lid, making sure that it is aligned (picture 5)
- Assemble and attach the magnetic grip tray (picture 6)
- Check if the nozzle is installed by gently pulling it down otherwise check the FAQ on the website bru-shop.com
- Push the black button to open the machine lid (picture 8)
- The Lids opens slightly
- Completely open the machine lid manually into a horizontal position (picture 10).
- Remove the tea sieve (A9) and glass brewing chamber (A11) from the machine (picture 11).
- Rinse the glass brewing chamber (A11) and the tea sieve (A9). (picture 12)

- Install the glass brewing chamber (A11) (picture 13)
- Make sure the glass brewing chamber is installed below the edge (as shown in picture 14).
- Put your tea in the tea sieve and close it (picture 15) *Caution, always install the sieve according to the guidelines to ensure best results.
- Place the tea sieve (A9) in the machine. (When using tea leaves always close the tea sieve lid (A10), if using a teabag, the sieve can be left open.)
- Make sure the tea sieve is well installed according to picture no 17
- Close the machine lid (A8) (picture 18)

3.1 FAST INSTRUCTION – Brew tea

1. Place the cup on the drip tray (picture 19)
2. Press the encoder (picture 20) to start your tea (see section 7: Explanation of the interface)
3. Your machine will notify acoustically when your tea is ready
4. If you face any errors, check the FAQ on the website bru-tea.com or contact or contact BRU customer service

4. BEFORE FIRST USE

1. Read all the instructions and warnings.
2. Remove all packaging's materials and make sure all items are in good conditions.
3. Remove Brewing Glass chamber and rinse with water, then dry thoroughly before returning to appliance.

5. CLEANING

Cleaning the machine

1. The following parts of the machine must be cleaned regularly:
 - Drip tray (A5)
 - Glass chamber (A11)
 - Tea Sieve (A9)
 - Silicone Nozzle (A6)
- Important, do not use solvents, abrasive detergents or alcohol to clean the tea maker.



Important!

1. Do not use solvents, abrasive detergents or alcohol to clean the tea maker.
2. Do not use metal objects to remove encrustations or tea leaves deposits as they could scratch the metal, glass or plastic surfaces.
3. If the appliance is not used for more than one week, before using it again, we strongly recommend you perform a rinse cycle as described in section first use.



Danger!

1. Never immerse the tea maker in water. It is an electrical device.
2. Before cleaning the outside of the appliance, turn it off, unplug from the mains socket and allow to cool.

Cleaning the drip tray

1. Remove the drip tray, remove the drip tray plate, empty the water and clean the drip tray with a cloth, then reassemble the drip tray.
2. Put the drip tray back in place.

Cleaning the brewing glass chamber

1. Remove the brewing glass chamber, rinse and wash with warm water.
2. Clean the brewing glass chamber with a cloth and then put it back in place.

Cleaning the Silicone Nozzle

1. Remove the silicone nozzle, rinse and wash with warm water.
2. Clean the silicone nozzle with a cloth and then put it back in place.

Cleaning the tea sieve

1. Remove the tea sieve, rinse and wash with warm water, remove all the tea deposits
2. Clean the tea sieve with a cloth and then put it back in place if needed,

Cleaning the water dispenser



1. Clean the silicone nozzle (A6) (about once a month) and whenever you replace the water softener filter with a damp cloth and a little mid washing up liquid.

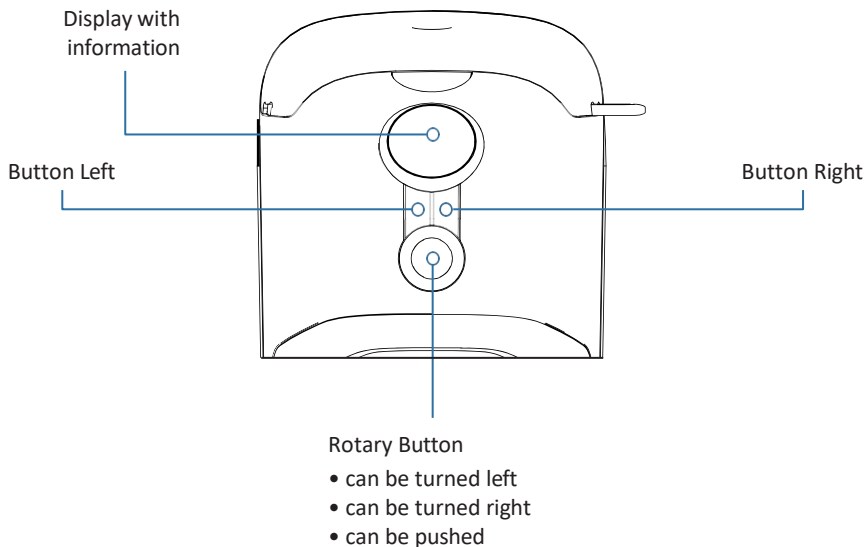

6. USER INTERFACE DESCRIPTION



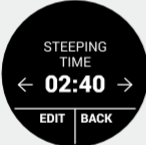

In many menus You can use either the left, or the right button, or the rotary button to go to the menu.

7. EXPLANATION OF THE INTERFACE

Information On The Display	Operation	Explanation of screen
 A circular display with a black background. At the top is a small icon of a coffee cup. Below it, the text '90°C' is displayed in white. In the center, '02:40' is shown in large white digits. Below that, '350 ml' is displayed. At the bottom, there are two buttons labeled 'SETUP' and 'START' in white.	Main Screen The last used settings are displayed	Either push the right button, to start the process, or push the left button to adjust the settings on the main screen. Or use the rotary button to select start or set up, then push to execute the operation.
 A circular display with a black background. At the top, the text 'STEEPING TIME' is displayed in white. In the center, '02:40' is shown in large white digits, flanked by left and right arrow icons. At the bottom, there are two buttons labeled 'EDIT' and 'BACK' in white.	Adjusting the steeping time	Press the left button to edit or press the right button to go back to the main screen.
 A circular display with a black background. At the top, the text 'STEEPING TIME' is displayed in white. In the center, '02:40' is shown in large white digits, flanked by left and right arrow icons. At the bottom, there is a single button labeled 'SAVE' in white.	Editing the steeping time	Turn the rotary knob to adjust the time and push the right button to save.

Information On The Display	Operation	Explanation of screen
 <p>A circular black screen with white text. At the top, it says 'WATER TEMPERATURE'. In the center, it displays '90°C' with left and right arrows. At the bottom, there are two buttons: 'EDIT' on the left and 'BACK' on the right.</p>	Water Temperature Setup Screen	Eighter push the right button to go back to the main screen, or press Edit to edit the water temperature.
 <p>A circular black screen with white text. At the top, it says 'WATER TEMPERATURE'. In the center, it displays '90°C' with left and right arrows. At the bottom, there is a single 'SAVE' button.</p>	Adjusting the temperature	Use the rotary knob to adjust the temperature, and press Save to save it.

 <p>A circular black screen with white text. At the top, it says 'WATER AMOUNT'. In the center, it displays '350 ml' with left and right arrows. At the bottom, there are two buttons: 'EDIT' on the left and 'BACK' on the right.</p>	Water Amount Adjustment Screen	Press the left button to edit, or the right button to go back to the main screen.
 <p>A circular black screen with white text. At the top, it says 'WATER AMOUNT'. In the center, it displays '350 ml' with left and right arrows. At the bottom, there is a single 'SAVE' button.</p>	Editing water amount	Use the rotary knob to adjust the amount or push the right button to save it.



Turn the rotary knob to the right to access additional functions and features.



1



2



3

Preset Screen

Preset 1-3 can be used to quickly use different brew settings. To start the process, push the right button. To edit the presets, push setup.



Water Dispensing Mode

To start push the right button. To adjust the temperature or the water amount push the left button.



If the amount is selected to infinity, the machine will dispense water until the stop button is pressed.



Alarm Mode

If selected the machine will prepare tea with the settings from the main screen at the desired time. To set the alarm push the right button, to set up the alarm time push the left button.



Machine Setup

To enter the machine settings push the right button, to go back to the main menu, press the left button.

8. SYMBOLS EXPLANATION



Conforms to European legal norms



Class I appliance



Restriction of hazardous substances



Food safe materials



Do not dispose of with normal household waste



Read instructions

INFORMATION FOR USERS

in accordance with European Directive 2012/19/UE on electric and electronic equipment waste disposal.

- The barrel symbol of the rubbish bin shown on the equipment indicates that, at the end of its useful life, the product must be collected separately from other waste.
- Therefore, any products that have reached the end of their useful life must be given to waste disposal centres specialising in separate collection of waste electrical and electronic equipment, or given back to the retailer at the time of purchasing new similar equipment, on a one for one basis.
- The adequate separate collection for the subsequent start-up of the equipment sent to be recycled, treated and disposal of in an environmentally compatible way contributes to preventing possible negative effects on the environment and health and optimises the recycling and reuse of components making up the apparatus.
- Abusive disposal of the product by the user involves application of the administrative sanctions to the laws in force.

FCC

- Changes or modifications not expressly approved by the party responsible for compliance could void the user's authority to operate the equipment.
- This device complies with Part 15 of the FCC Rules. Operation is subject to the following two conditions:
 - this device may not cause harmful interference, and
 - this device must accept any interference received, including interference that may cause undesired operation.
- This transmitter must not be co-located or operating in conjunction with any other antenna or transmitter.
- Note: This equipment has been tested and found to comply with the limits for a Class B digital device, pursuant to Part 15 of the FCC Rules. These limits are designed to provide reasonable protection against harmful interference in a residential installation. This equipment generates, uses, and can radiate radio frequency energy, and if not installed and used in accordance with the instructions, may cause harmful interference to radio communications. However, there is no guarantee that interference will not occur in a particular installation. If this equipment does cause harmful interference to radio or television reception, which can be determined by turning the equipment off and on, the user is encouraged to try to correct the interference by one or more of the following measures:
 - Reorient or relocate the receiving antenna.
 - Increase the separation between the equipment and receiver.
 - Connect the equipment into an outlet on a circuit different from that to which the receiver is connected.
 - Consult the dealer or an experienced radio/TV technician for help.
- This device complies with FCC radiation exposure limits set forth for an uncontrolled environment. This device should be installed and operated with minimum distance 20cm between the radiator & your body.