

- Open the APP, click on the upper right corner to add a device, click on the device corresponding to the Bluetooth mac address. After the addition is complete, the device name turns blue.

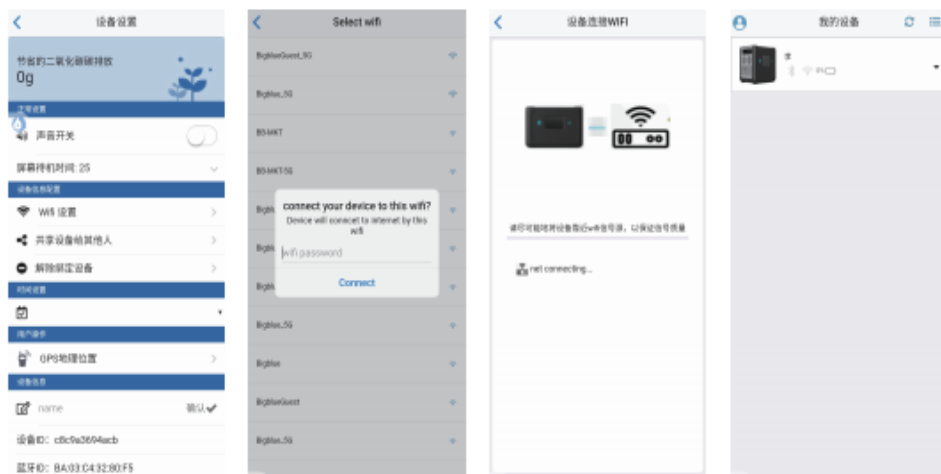

2. WIFI connection

- The mobile phone is connected to a valid WiFi network. Click to enter the Bluetooth-bound device, click the “ ” button in the upper right corner to enter the setting interface, select Wi-fi settings, select Yes.



3. OTA upgrade

This machine supports OTA upgrade. When the product performance is continuously optimized and brings new experience, you can complete the OTA upgrade through the APP operation in the state of WIFI connection.

APP operation

Through the APP, the AC output can be turned on and off, the DC output can be turned on and off, and the working information and parameter settings of the product can be viewed.

Product Instructions

This product uses a resistive touch screen. When operating, please hear a "di" sound and release it.

【Notice】

- During the use of this product, the current real-time power and remaining battery time displayed are for reference only. The actual real-time power and remaining time of use are subject to the actual use of the product.
- The intelligent cooling fan will automatically turn on and run according to the charging and discharging power of the product and the internal temperature of the product to protect the host and prevent internal heating. The power station is low-speed at 0-600W, medium-speed at 600-1500W, and high-speed operation above 1500W.
- This product has multiple ports working at the same time, the maximum AC 2500W+DC 400W power output, and the maximum power 2900W Max.

Use AC output

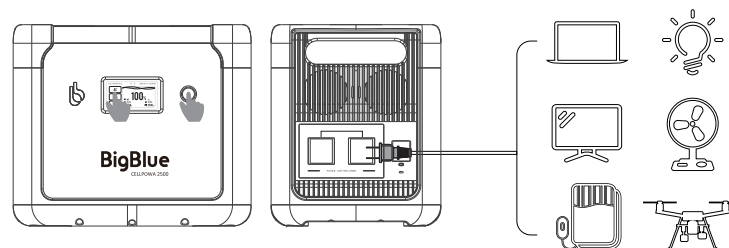

- Turn on the main switch (long press for 3S), the screen will light up, click the product AC icon on the screen to turn on the AC.
- UPS function, this product supports UPS. Connect the CP2500 to the power grid with an AC cable, and your appliance can use the AC output of this product. At this time, the AC power is from the power grid. If there is a power failure in the grid, the CP2500 will switch to the internal battery to supply power to your device within 10 ms.

【Notice】

- The AC output of this product defaults to constant voltage mode. This mode is suitable for devices that require stable voltage. When using constant voltage mode, please ensure that the power of your device is not greater than 2500W. If the power exceeds 2500W, AC overload protection will be triggered. 3 consecutive overloads will cause the load to fail. Manual operation is required.

- This product AC supports constant power mode. It can support products whose power is greater than 2500W and less than 3500W, and whose input voltage is suitable for wide voltage operation. When using this type of appliance, please select the constant power mode. The output load power of CP2500 will be limited to 2500W.
- If your CP2500 is connected to the mains grid (AC input), the smart inverter circuit will give priority to the grid (inverter bypass) for power supply. At this time, the total power of your load cannot be greater than 2500W. If it exceeds 2500W, the bypass overload function will be activated and the AC output will be stopped.
- If the AC output is short-circuited, it will trigger the product to start short-circuit protection and turn off the AC output.
- Communication regular mode. The AC standby time is 6H, mainly for your very low power equipment (less than 5W). When the AC socket is not in use, please click the AC control button to turn off the AC output to save energy.

Use DC, USB-A, USB-C output

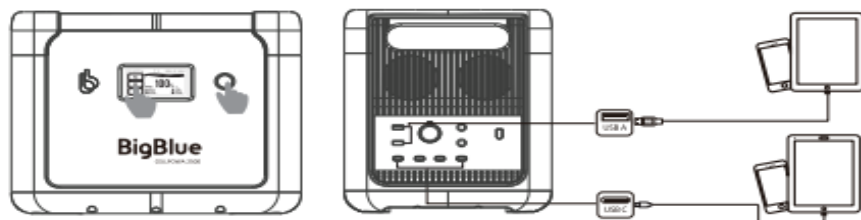

1. Turn on the power switch (press and hold for 3 seconds), the screen will light up. Click the DC icon on the screen to turn on the DC, USB-A, USB-C output.
2. USB-A fast charging output: support 5V?3A, 9V?2A, 12V?1.5A maximum 18W charging, smart devices that support QuickCharge 3.0, used for smart USB devices such as mobile phones or tablets that also support QuickCharge 3.0 technology for fast charging Battery life. The two ports are independent and can support up to 36W fast charging for two devices at the same time.
3. 2xPD45W USB-C output: Power Delivery 5V/3A, 9V/3A, 12V/3A, 15V/3A, 20V/2.25A (45W Max) fast charging. It is used for fast charging and battery life of smart devices such as mobile phones or laptops that also support the PD fast charging protocol.

[Notice]

- Note that when using the USB-A/USB-C output, the DC switch must be turned on first. If you do not use the DC output, please turn it off in time to save energy.

- The USB output is short-circuited or the power of the load device exceeds the output power of the USB port of this product, it will trigger the product to start short-circuit protection or over-current protection and turn off the USB-A or USB-C output, (no output after overload and short circuit), after removing the load Automatically restores DC output.

Use DC output

- DC5521*2 output: 12V/5A, two simultaneous outputs Max: 12V/10A.
- Cigarette lighter output DC12V/10A.
- When 3xDC ports are output at the same time, they share 12V/10A.

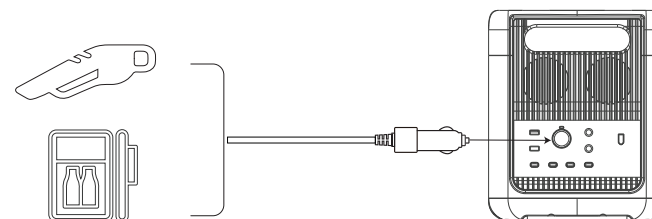

[Notice]

- The output voltage of the DC5.5mm port of this product and the car charger cigarette lighter is 12.5V-13.5V.
- The DC5.5mm port of this product is a DC5.5*2.1 port. If you want to use this port function, please confirm whether the port of the electrical device is a DC5.5*2.1 port, and you can also consult the device manufacturer for more information.
- 2xDC5.5mm ports output 5A. When a single DC output power device exceeds 68W, the port will be over-current/overload protected and the DC output will be turned off.
- When the DC output is not in use, please turn off the DC switch in time to save energy. You can short press the DC control button to turn off the DC output.

Electrical settings

- Normal mode

When your CP2500 is set to normal mode and no load is connected (or the output power is less than or equal to 5W), the CP2500 will automatically shut down after 6 hours.

- Eco mode

When your CP2500 is set to power saving mode, when the AC load is less than or equal to 5W, it will automatically turn off the AC output after 10 minutes.

GPS positioning function

- Click the menu---click GPS---click the GPS switch to select ON, GPS will automatically collect satellites and locate. After the positioning is completed, the latitude and longitude coordinates are displayed.



Product charging instructions

- This product can be used as UPS, AC, DC, USB output can work when the energy storage power supply is charging.

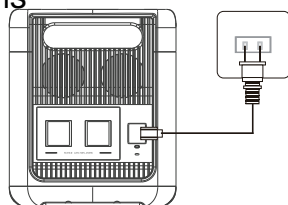

Use AC fast charging

- Connect the included standard AC power charging cable to the AC power input port, and then plug the other end into a household AC power outlet to start charging the product. The maximum AC charging power is about 1200W.
- When the power on the screen keeps fluctuating upwards, it means that the machine is charging, and at the same time, the digital power indicates the current charging power; the screen displays the current charging power, the current discharging power, and the remaining reference time for charging.
- When the screen power progress bar is full and no longer fluctuates, and the digital power indicator is 100%, it means the product is fully charged. Please remove the charger in time and unplug it from the AC outlet.
- This product has fast charge/slow charge multi-level charging power, and the charging power is divided into three levels: 400W, 800W, and 1200W. The charging input power can be switched by operating the APP or the local charging settings. The factory default charging power defaults to 1200W.
- This product supports shallow charging AC charging technology, which can switch between 20% and 100% of full power detection.

[Notice]

- The intelligent cooling fan will automatically turn on and run according to the charging and discharging power of the product and the internal temperature to protect the host and prevent internal heating.

- If your CP2500 is fully charged and not connected to the load, the charging protection will disconnect the external charging device, and then turn to the local battery to supply power. If the charging cable is not removed in time at this time, the AC input bypass switch of the inverter board Still in working state, it will cause your battery to drop slowly, this is a normal phenomenon, the product will restart charging after the battery has dropped by 5%.

Use solar fast charging

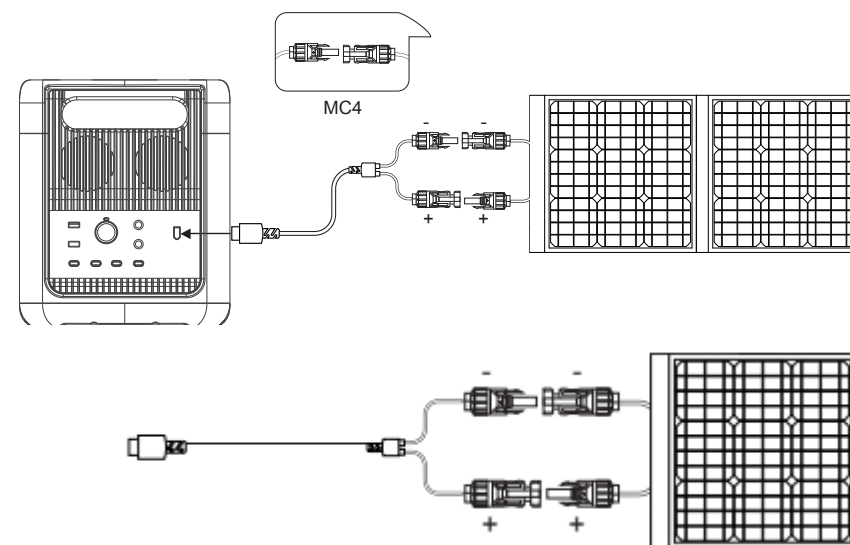

- Place the BigBlue SP200 or SP400 solar panel at an appropriate angle and connect the corresponding DC cable to the DC-XT60 charging input port of the generator.
- When the power on the screen keeps fluctuating upwards, it means that the machine is charging, and at the same time, the digital power indicates the current charging power; the screen displays the current charging power (if not displayed, it is 0W) and the current discharging power (if not displayed, it is 0W), the remaining reference time for charging.
- When the screen power progress bar is full and no longer fluctuates, and the digital power indicator is 100%, it means that the product is fully charged, please remove the charging adapter in time.
- The input port of XT60 is dedicated solar charging input with built-in solar MPPT function. It is forbidden to charge the product with a high-power adapter exceeding 30V/250W, otherwise your solar MPPT charging circuit may be damaged.
- It is forbidden to use solar panels above 35V to charge the product after connecting in series.
- If your battery's charging capacity is often set at 80%, please manually set the charging capacity to 100% after every 5 charge-discharge cycles, and complete at least one charge-discharge cycle from 0% to 100%. Your battery SOC accuracy.

Use car charger

- This product can be charged using the car charger port on the car. This product supports 12V car charger/24V car charger charging, and the default charging current is 10A. It is necessary to use the car charger to charge after the car is started, so as not to cause the car battery to be depleted and unable to start. At the same time, ensure that the car charger port and the cigarette lighter of the car charger input line are in good contact. The company shall not be held responsible for any loss caused by non-compliance with the standard operation.

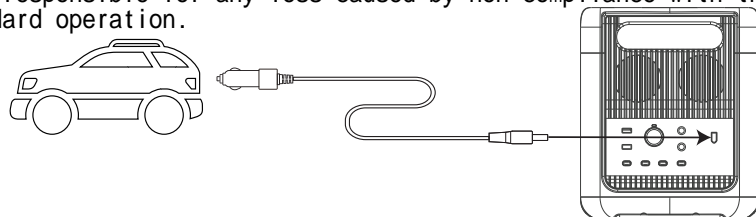

【Notice】

- This product features maximum power point tracking (MPPT) for faster charging.
- The charging voltage range of the solar/car charger input port of this product is 12-65V. To avoid damage or other unpredictable risks, do not use solar panels with voltages above or below this range to charge this station.
- Use solar panels to charge this product, do not expose the power station to sunlight to avoid unpredictable risks such as shortening the product life.

Warnings and Notices

Please read all instructions before using this product.

1. To reduce risk, close supervision is required when using this product near children.
2. The use of accessories recommended or sold by non-professional product manufacturers may result in the risk of electric shock.
3. When the product is not in use, please pull out the power plug from the product socket.
4. It is forbidden to disassemble the product. After disassembling the product, it may cause unpredictable risks such as fire or electric shock.
5. Please charge the product in a well-ventilated place, and do not restrict the ventilation of the product in any way.
6. Please put the product in a ventilated and dry place to avoid getting wet by rain, and there is a risk of electric shock if the product enters the water.
7. Please dispose of scrapped products in accordance with regulations.
8. Do not put your fingers, palms or any part of your body into the product.

9. Please avoid storing this device with metal objects such as coins, jewelry, keys, etc.
10. Do not heat the device or dispose of it in fire, water or other liquids, including high temperature environments such as direct sunlight.
11. Do not drop, place heavy objects or strongly impact this product.

Battery usage

- This product has built-in high-quality original lithium iron phosphate battery, no memory effect, large capacity, durable, this product supports -20 ~ 45 work.
- It is recommended that users use this product in the temperature range of 10 ~30 to obtain the best charge and discharge capacity.

Certification



Recycle

Be sure to send used electronics, batteries, and packaging materials to a dedicated collection point. This prevents uncontrolled.

Warranty

Our company provides customers with a 24-month warranty from the date of purchase.

Contact details

For any questions or comments about our products, please contact us at support@ibigblue.com and we will get back to you as soon as possible reply to you.

FCC Warning

This device complies with part 15 of the FCC rules. Operation is subject to the following two conditions: (1) this device may not cause harmful interference, and (2) this device must accept any interference received, including interference that may cause undesired operation.

Changes or modifications not expressly approved by the party responsible for compliance could void the user’s authority to operate the equipment.

NOTE: This equipment has been tested and found to comply with the limits for a Class B digital device, pursuant to part 15 of the FCC Rules. These limits are designed to provide reasonable protection against harmful interference in a residential installation. This equipment generates uses and can radiate radio frequency energy and, if not installed and used in accordance with the instructions, may cause harmful interference to radio communications. However, there is no guarantee that interference will not occur in a particular installation. If this equipment does cause harmful interferenceto radio or television reception, which can be determined by turning the equipment off and on, the user is encouraged to try to correct the interference by one or more of the following measures:

- Reorient or relocate the receiving antenna.
- Increase the separation between the equipment and receiver.
- Connect the equipment into an outlet on a circuit different from that to which the receiver is connected.
- Consult the dealer or an experienced radio/TV technician for help.

Radiation Exposure Statement

This equipment complies with FCC radiation exposure limits set forth for an uncontrolled environment. This equipment should be installed and operated with minimum distance 20cm between the radiator and your body.

ISED Statement

This device complies with Industry Canada’s licenseseexempt RSS Operation is subject to the following two conditions:

- This device may not cause inter/er ence;
- This device must accept any inter/ e  rence, including interfe  rence that may cause undesired operation of the device

Le present appareil est conforme aux CNR d’Industrie Canada applicables aux appareils radio exempts de lic ence. l’exploitation est autorisee aux deux conditions suivantes:

- l’appareil ne doit pas produire de brouillage;
- l’utilisateur de l’appareil doit acce pter tout b  rouillage radioelectrique subi, meme si le brouillage est susc eptible d’en compromettre le fonc tionnement.