

EP03

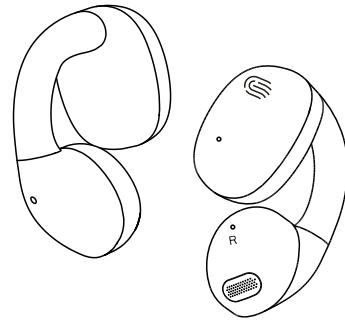

User Manual

Thank you for purchasing the EP03 Wireless Earbuds. Please review this manual thoroughly before operating your device. In order to avoid unnecessary injuries, please do not disassemble this product by yourself. For your better consumer experience, We provide you with warranty. Please scan the following QR code:



Package Content

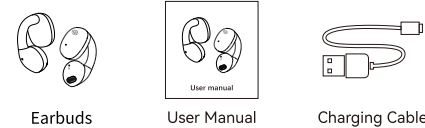

Product Overview

- ① Touch area (Multi-function buttons)
- ② Microphone
- ③ Earbuds Indicator
- ④ Earbuds Power Indicator
- ⑤ Charging Case Indicator
- ⑥ Type - C Charging Port
- ⑦ Sound Outlet

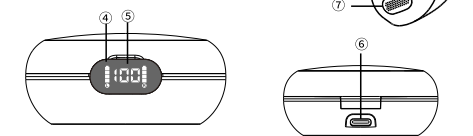

PAIRING

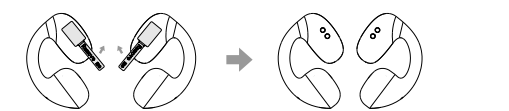

1. For first-time use, remove the insulation stickers on the earbuds.

2. Return earbuds to the charging case.
3. Take out the earbuds or hold the Multi-function buttons for 3 seconds to turn them on.
4. Once paired automatically, the LED indicator of the master earphone will flash red and blue alternately; The sub-earphone flashes a blue light every 3s. A voice prompt will say "Pairing".
5. Select "EP03" on your phone to connect from the Bluetooth list. Once connected, the indicators will be off. A voice prompt will say "connected".

Note: Earbuds will turn off automatically after 5 minutes if they have not been paired with any device.

RESET

1. Delete "EP03" in the Bluetooth list and turn off the Bluetooth function of your phone.
2. When both earbuds are turned on (including the playback state), quickly tap them 4 times at the same time, the blue indicator flashes 3 times then turns off, resetting successfully.
3. If it fails, repeat the above three steps.

WEARING

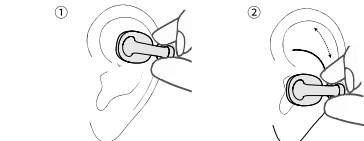

1. Gently clamp the earbuds onto the upper part of your auricles. Make sure the front side (Sound Outlet) faces your ear canal and the back side with touch control rests behind your ear.
2. Move the earbuds upwards or downwards until the earbuds fit securely and you can hear the sound well.
3. Dust, earwax or other debris will accumulate in the earplugs. In order to maintain the best sound quality, please gently clean the earplugs with a cotton swab regularly.

CHARGING

1. Fully dry off the earbuds and the USB-C charging port before charging.
2. Connect the charging case to a power supply by using the provided USB-C charging cable.

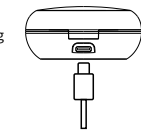

CONTROL

| | |
|-------------------------|---|
| Power on | Take out from the case/press and hold the L/R Multi-function buttons for 3s |
| Power off | Put into the case/press and hold the L/R for 5s (in standby mode) |
| Play/pause | Double-click L/R |
| Volume +/- | Press and hold for L/R 1.5s |
| Next | Triple-click R |
| Answer/hang up a call | Double-click L/R |
| Reject a call | Press and hold for 2s |
| Turn on voice assistant | Triple-click L |

LED INDICATORS

| | |
|-----------|--|
| Power on | blue indicator stays on for 1 second and then turns off |
| Power off | red indicator stays on for 1 second and then turns off |
| Pairing | master earphone LED will flash red and blue alternately; sub-earphone flashes a blue light every 3s. |
| Connected | The indicator turns off |

Specifications

| | |
|------------------|--|
| Model | EP03 |
| Wireless Version | 5.4 |
| Profile | HFP/HSP/AVRCP/A2DP |
| Range | Up to 10 meters / 33 feet |
| Frequency Range | 20-20KHz |
| Charging time | Earbuds : Up to 1.5 hours Charging case : Up to 2 hours |

FCC Warning:

This equipment has been tested and found to comply with the limits for a Class B digital device, pursuant to part 15 of the FCC Rules. These limits are designed to provide reasonable protection against harmful interference in a residential installation. This equipment generates, uses and can radiate radio frequency energy and, if not installed and used in accordance with the instructions, may cause harmful interference to radio communications. However, there is no guarantee that interference will not occur in a particular installation. If this equipment does cause harmful interference to radio or television reception, which can be determined by turning the equipment off and on, the user is encouraged to try to correct the interference by one or more of the following measures:

- Reorient or relocate the receiving antenna.
- Increase the separation between the equipment and receiver.
- Connect the equipment into an outlet on a circuit different from that to which the receiver is connected.
- Consult the dealer or an experienced radio/TV technician for help.

Caution: Any changes or modifications to this device not explicitly approved by manufacturer could void your authority to operate this equipment.

This device complies with part 15 of the FCC Rules. Operation is subject to the following two conditions: (1) This device may not cause harmful interference, and (2) this device must accept any interference received, including interference that may cause undesired operation.

The device has been evaluated to meet general RF exposure requirement. The device can be used in portable exposure condition without restriction.

Model: EP03
FCC ID: 2A7GB-EP03
MADE IN CHINA

