

360\*70mm

## Magnetic Bluetooth camera grip

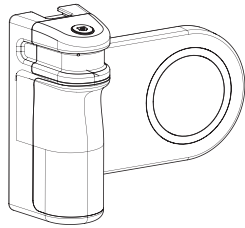

YW-85A

instruction

### Product description

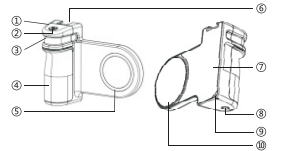

1. Remote control
2. Camera button (on/off button)
3. Remote control indicator light
4. Handle
5. CD pattern
6. Cold shoe opening
7. Microfiber fabric
8. 1/4 standard screw
9. Hanging rope hole
10. MagSafe magnet

### Bluetooth

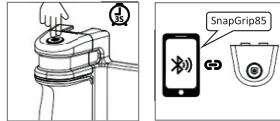

1. Press and hold the camera button for 3 seconds to turn on the remote control, the blue indicator light flashes, and press and hold for 3 seconds to turn off the device.
2. Turn on your phone's Bluetooth to enter search mode.
3. In the device list, select "SnapGrip85" to prompt "SnapGrip85" pairing, click pairing, and the prompt "linked" indicates successful pairing; At this point, the blue light indicator light is off, and the phone enters camera mode. Press the blue light once to flash and take a photo.
4. Press the camera button to control the phone to take photos; Enter the recording interface, click the button to start recording, and click again to stop recording.
5. The red light remains on continuously during charging, and automatically turns off when fully charged.
6. Turn on the Bluetooth connection and the phone will automatically shut down after 20 minutes of inactivity. If the phone is not connected for 5 minutes, turn off the phone. After turning off the phone, restart it and Bluetooth will automatically connect to the last connected device.

### Compatibility

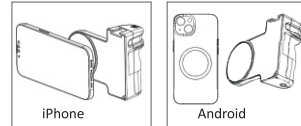

1. iPhone models: Suitable for all 12/13/14 models, requiring direct bare metal use or equipped with a magnetic case. iPhone models below 12 require a magnetic guide or magnetic ring for use.
2. Android models: All mobile phone models need to be equipped with magnetic pads or magnetic rings for use.

### Bluetooth shutter button

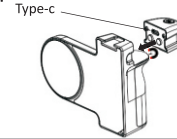

#### Notice!

1. The product is equipped with a built-in lithium battery, eliminating the need to replace the ground.
2. It is recommended to use a 5V/0.5A adapter for charging. When the charging is completed, the red light will turn off.
3. When not in use for a long time, it is recommended to charge it once every 2 months to maintain normal backup functions.
4. USB-C input voltage: 5V/1A (fully charged within 30 minutes).
5. Maximum input current 350mA.
6. Battery fully charged voltage: 2V-4.25V.
7. Battery capacity: Capacity 110mAh.
8. Battery life: The maximum working time when the pool is fully charged is 10 hours, and the standby working time is about 400 days.

### list

phone grip 1  
instructions 1  
Type-C charging cable 1  
Magnetic guide plate 1

### parameters

- Product material: ABS+PC+silicone+copper nut+aluminum alloy+CD pattern+magnet+microfiber panel
- Product weight: 85g ± 5g
- Product size: 119 \* 91 \* 44mm ± 2mm
- Packaging size: 118 \* 93 \* 48mm ± 3mm

FCC Warning Statement  
Changes or modifications not expressly approved by the party responsible for compliance could void the user's authority to operate the equipment. This equipment has been tested and found to comply with the limits for a Class B digital device, pursuant to Part 15 of the FCC Rules. These limits are designed to provide reasonable protection against harmful interference in a residential installation.

This equipment generates uses and can radiate radio frequency energy and, if not installed and used in accordance with the instructions, may cause harmful interference to radio communications. However, there is no guarantee that interference will not occur in a particular installation. If this equipment does cause harmful interference to radio or television reception, which can be determined by turning the equipment off and on, the user is encouraged to try to correct the interference by one or more of the following

measures:  
-- Reorient or relocate the receiving antenna.  
-- Increase the separation between the equipment and receiver.  
-- Connect the equipment into an outlet on a circuit different from that to which the receiver is connected.  
-- Consult the dealer or an experienced radio /TV technician for help.

This device complies with part 15 of the FCC Rules. Operation is subject to the following two conditions: (1) This device may not cause harmful interference, and (2) this device must accept any interference received, including interference that may cause undesired operation. The device has been evaluated to meet general RF exposure requirement. The device can be used in portable exposure condition without restriction.