

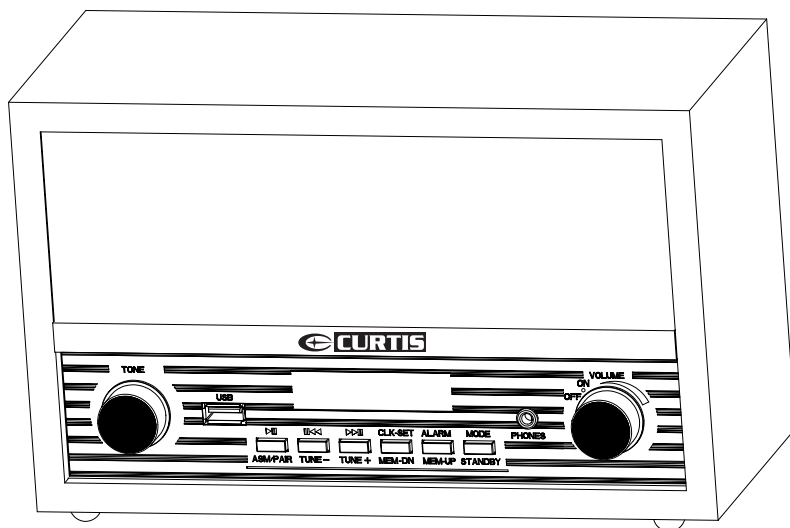

NOSTALGIA BLUETOOTH FM RADIO

INSTRUCTION MANUAL

MODEL NO.: CRC1490



Thank you for buying this product. You may already be familiar with using a similar unit , but please take the time to read these instructions.

CURTIS™ IS A REGISTERED TRADEMARK OF CURTIS INTERNATIONAL LTD.

FCC Statement

Note: This equipment has been tested and found to comply with the limits for a Class B digital device, pursuant to part 15 of the FCC Rules. These limits are designed to provide reasonable protection against harmful interference in a residential installation. This equipment generates, uses and can radiate radio frequency energy and, if not installed and used in accordance with the instructions, may cause harmful interference to radio communications. However, there is no guarantee that interference will not occur in a particular installation. If this equipment does cause harmful interference to radio or television reception, which can be determined by turning the equipment off and on, the user is encouraged to try to correct the interference by one or more of the following measures:

- Reorient or relocate the receiving antenna.
- Increase the separation between the equipment and receiver.
- Connect the equipment into an outlet on a circuit different from that to which the receiver is connected.
- Consult the dealer or an experienced radio/TV technician for help.

This device complies with part 15 of the FCC Rules. Operation is subject to the following two conditions: (1) This device may not cause harmful interference, and (2) this device must accept any interference received, including interference that may cause undesired operation.

Any changes or modifications not expressly approved by the party responsible for compliance could void the user's authority to operate the equipment.

This equipment complies with FCC radiation exposure limits set forth for an uncontrolled environment. This equipment should be installed and operated with minimum distance 20cm between the radiator & your body.

WHERE TO PUT YOUR RADIO

It is important that you consider carefully in advance where your radio will be situated and make sure that it is:

- * On a flat and stable surface with sufficient ventilation
- * Within 1.4metres of a power socket (if using mains power)
- * Where you can fully extend the telescopic aerial
- * Away from bright sunlight or heat sources, such as a radiator or naked flame and lighted candles must not be placed on the radio
- * Not in a humid or very damp place such as a bathroom

IMPORTANT SAFETY INSTRUCTIONS

Please read this instruction manual carefully before attempting to use the radio and keep the manual for future reference

The radio is for indoor use only

Do not move the radio while it is connected to the mains supply via the adapter

Clean the radio with a slightly damp cloth and do not use abrasive cleaners

Children should be supervised to ensure that they do not play with the radio

WARNING:

If the flexible cable of the adapter is damaged, it must be replaced by the manufacturer or his service agent or a similar qualified person in order to avoid a hazard

LOCATION OF CONTROLS

1. Wooden Case
2. Speaker Net
3. Function Panel
4. TONE +/-
5. USB Port
6. ►II/■/ASM/PAIR
7. I◄◄ / TUNE -
8. ►► / TUNE +
9. CLK-SET / MEM-DN
10. ALARM / MEM-UP
11. MODE / STANDBY
12. PHONES
13. ON & OFF / VOLUME +/-
14. Rubber Feet
15. Telescopic Aerial
16. DC 9V Input

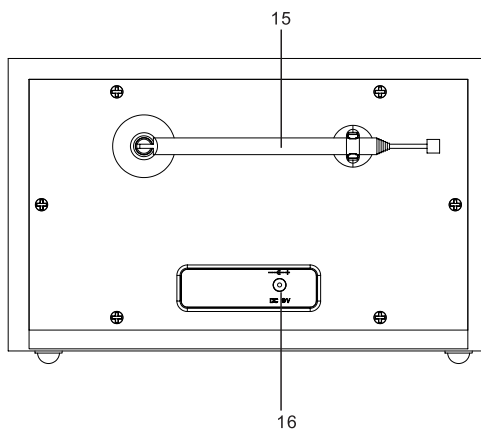
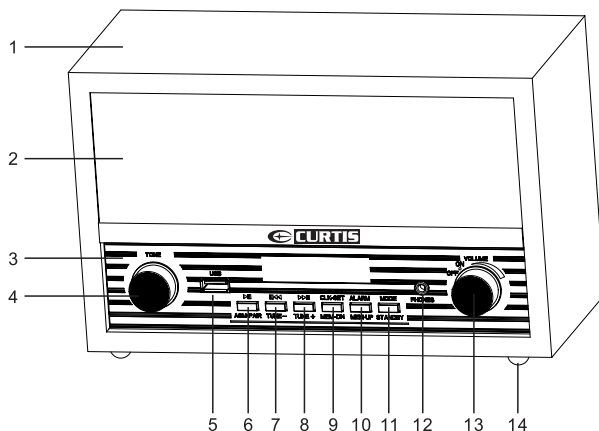

SETTING UP

Connect the mains power lead into the socket on the back of the radio (**DC 9V**) and plug the power adaptor into the mains power wall socket and switch on. Fully extend the radio aerial in a vertical position to obtain the maximum signal strength. To switch on the radio, rotate the **ON/OFF** knob clockwise, the defaulted clock 00:00 will be displayed on the LCD, then long press the **MODE / STANDBY** button to activate the unit. (This process may take a few minutes depends on different signal strength and working environment.)

The clock is defaulted to 00:00

The alarm is defaulted to 00:00 and off

GETTING STARTED

Time Set Up

Switch the radio into **MODE / STANDBY**.

Press and hold the **CLK-SET / MEM** button to enter into clock set.

To set clock display format, press **◀◀/ TUNE-** or **▶▶/ TUNE+** to choose between 12/24 Hour. To set clock, press **◀◀/ TUNE-** or **▶▶/ TUNE+** to adjust clock by 01 minute and 01 hour. Each step needs to be confirmed by pressing the **CLK-SET / MEM** button

Alarm Set Up

Switch the radio into **MODE / STANDBY** mode.

Press the **ALARM / MEM-UP** button to enter into alarm set.

To set time, press **◀◀/ TUNE-** or **▶▶/ TUNE+** to adjust clock by 01 minute and 01 hour. To set mode, press **◀◀/ TUNE-** or **▶▶/ TUNE+** to select outputs from Buzzer or Tuner. Each step needs to be confirmed by pressing the **ALARM / MEM-UP** button. The clock symbol will be displayed on the LCD screen after it is successfully set.

Alarm Wake up

When it wakes up to **TUNER**, the radio will play FM program.

When it wakes up to **BUZZER**, Beep tone rings.

When alarm rings, you can press any button to stop the ring.

If you want to terminate the alarm, press and hold the **ALARM / MEM-UP** button, the clock symbol is gone.

FM OPERATION

1. Press the **MODE / STANDBY** button repeatedly until the LCD screen shows **FM**.
2. To scan stations manually, short press **◀◀/ TUNE-** or **▶▶/ TUNE+** to adjust stations by 0.1MHz until you get your favorite station.
Long press **◀◀/ TUNE-** or **▶▶/ TUNE+** to activate auto scan. If the station signal is available, scan will stop automatically and the radio will play this station, repeat this operation if it is not on the program you would like to listen.
3. To auto scan stations, long press **▶II/■/ASM/PAIR** button, it will activate a full stations searching. A progressing bar will show the progress of the scanning and the number of stations found during the scanning. The stations scanned will be stored automatically when the scanning is completed.
4. To store a station, you must first tune to the station you wish to set as a preset. Then press the **▶II/■/ASM/PAIR** button to activate storing function, "Pxx" will be displayed on the LCD screen, and the number "xx" will flash.
Press **◀◀/ TUNE-** or **▶▶/ TUNE+** to scroll through the numbered preset locations(P01-30), press the **▶II/■/ASM/PAIR** button to store the station, frequency will be displayed on the LCD screen. 30 stations can be stored in total. To tune to a saved/preset FM station, press the **ALARM / MEM-UP** button to scroll through the stations. Stop when you see the station you would like to listen. The radio will begin to play.
5. Rotate **VOLUME** knob to adjust the volume.
6. Rotate **TONE** knob to adjust high (treble) and low (bass) frequency range.

BLUETOOTH OPERATION

1. Press the **MODE / STANDBY** button repeatedly until the LCD screen shows **BT**, you will hear an activation sound from the unit.
2. Turn on the Bluetooth function of your audio devices, search for **CURTIS CRC1490** and pair.
3. Once your device is successfully paired with the unit, you will hear a confirmation sound from the unit.
4. Play and stream music from your audio devices to the unit.
5. Press the **▶ II/■/ASM/PAIR** button to choose play or pause, you can also do it via your audio device in the normal way.
6. Press the **◀◀/ TUNE-** to play previous song and **▶▶/ TUNE+** to play next song or do it via your audio device in the normal way.
7. Rotate **VOLUME** knob to adjust the volume.
8. Rotate **TONE** knob to adjust high (treble) and low (bass) frequency range.

USB OPERATION

1. Press the **MODE / STANDBY** button repeatedly until the LCD screen shows **USB**.
2. Insert your USB into the USB port and the unit will read the USB automatically.
3. The unit will play music from your USB.
4. Press the **▶ II/■/ASM/PAIR** button to choose play or pause.
5. Press the **◀◀/ TUNE-** to play previous song and **▶▶/ TUNE+** to play next song.
6. Press the **CLK-SET / MEM** to choose play modes: normal, single repeat, all repeat.

7. Rotate **VOLUME** knob to adjust the volume.
8. Rotate **TONE** knob to adjust high (treble) and low (bass) frequency range.

HEADPHONE OPERATION

1. Connect the headphone lead into the **PHONES** Jack in the front of the radio and listen to radio privately.
2. Rotate **VOLUME** knob to adjust volume

SPECIFICATIONS

Radio Frequency range	FM: 87.5-108.0MHz
Power Source	DC 9V 1A
Power Consumption	12W Max
Input	AC100-240V, 50/60Hz, 05.A Max

To make a warranty claim, please email support@curtiscs.com or call 1-800-968-9853.

90 day Warranty

This product is warranted to be free from defects in material and workmanship for a period of ninety (90) days from the date of original purchase. During this period, your exclusive remedy is repair or replacement of this product or component found to be defective, at our option; however, you are responsible for all costs associated with returning the product to us. If the product or component is no longer available, we will replace with a similar one of equal or greater value. Prior to a replacement being sent, the product must be rendered inoperable or returned to us.

This warranty does not cover glass, filters, wear from normal use, use **not** in conformity with the printed directions., or damage to the product resulting from accident, alteration, abuse, or misuse. This warranty extends only to the original consumer purchaser or gift recipient. Keep the original sales receipt, as proof of purchase is required to make a warranty claim. This warranty is void if the product is used for other than single-family household use or subjected to any voltage and waveform other than as on the specified rating on the label (e.g., 120V~60Hz).

We exclude all claims for special, incidental, and consequential damages caused by breach of express or implied warranty. All liability is limited to the amount of the purchase price. **Every implied warranty, including any statutory warranty or condition of merchantability or fitness for a particular purpose, is disclaimed except to the extent prohibited by law, in which case such warranty or condition is limited to the duration of this written warranty.** This warranty gives you specific legal rights. You may have other legal rights that vary depending on where you live. Some states or provinces do not allow limitations on implied warranties or special, incidental, or consequential damages, so the foregoing limitations may not apply to you.

For faster service, locate the model, type, and serial numbers on your appliance.

ATTACH YOUR PROOF OF PURCHASE HERE, PROOF OF PURCHASE IS REQUIRED TO OBTAIN WARRANTY SERVICE.

Please have the following information available when you contact the Support Team:

- Name, address and telephone number.
- Model number and serial number.
- A clear, detailed description of the problem.
- Proof of purchase including dealer or retailer name, address and date of purchase.