

8.Real-time Monitoring and Play back

14.Real-time Monitoring

Click the screen on the homepage to access real-time monitoring

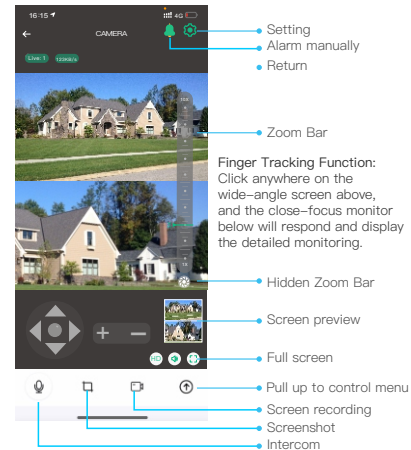

15.Video Playback of Memory Card

Click the video playback button on the homepage of the pull-up control menu to enter playback, select memory card playback.

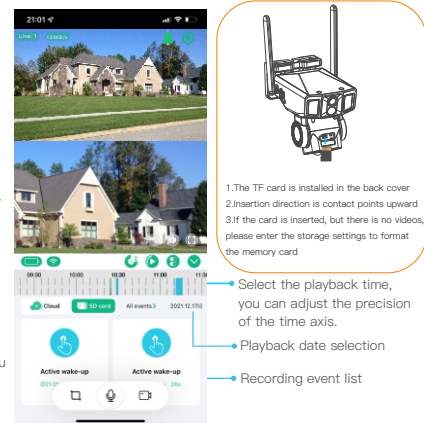

16.Video Playback of Cloud Storage

Click the video playback button on the homepage of the pull-up control menu to enter playback, select cloud storage playback.

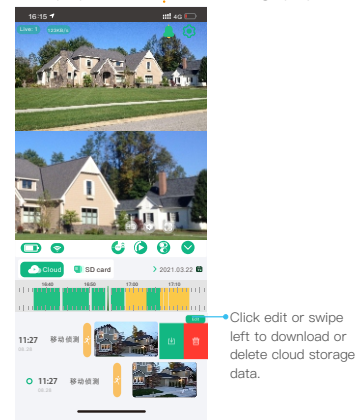

9.Control Instructions

17.PTZ Control

Click the pull-up menu to enter the control page,
Click the to control the PTZ camera.



Tracking Calibration:

When there is a difference in the rotation direction of the camera's pan/tilt, you can click the reset, and the camera's pan/tilt will self-detect and calibrate the position of the pan/tilt.

Preset:

When the user has multiple fixed-point to monitoring, can control the PTZ to the position that requires fixed-point monitoring and save the reserved position for quick positioning.

Guard:

When human tracking is turned on, the camera will follow the human figure to rotate. Set the guard position to ensure that your key position can be monitored at any time.
The setting method is to control the PTZ to your key monitoring point and click the guard position.

10.Intelligent Tracking and Linkage

18.Intelligent Tracking and Linkage

In the detection settings, choose to Turn on or Turn off humanoid tracking

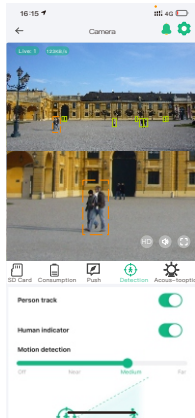
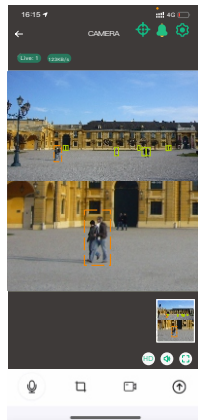

Finger Tracking Function:

Clicking anywhere on the upper wide-angle screen, the ptz monitoring below will be positioned there automatically.

Humanoid tracking function:

Tuning on the Humanoid tracking function, the human shape will be judged by the upper wide-angle camera, and the PTZ camera will be linked for pan-tilt tracking. When double-clicking any position on the wide-angle screen, the lower focus monitor will be positioned.

Humanoid Mark:

When a person is detected within the monitoring range, a point frame will be displayed around the person

11.System Settings

19.Quick Settings

Click  to enter the camera quick settings.

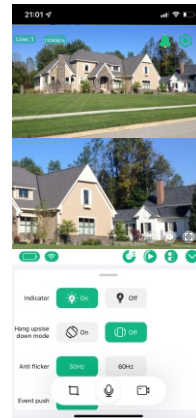

20. Device Information

Click  to enter device information, check firmware version and upgrade.

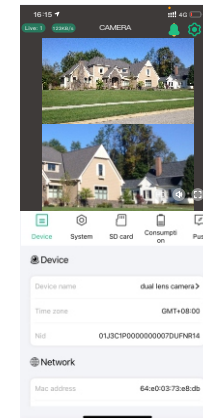

21.System Settings

Click  to enter system settings, change the camera's displaymode and other system settings.

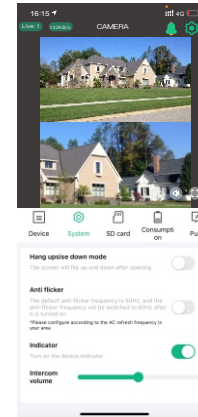

22.Memory card Settings

Click  to enter memory card settings, you can check its usage status and format.

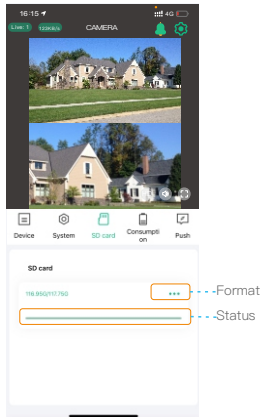

23.Alert Push Settings

Click  to enter the push settings of the camera, select the information to be accepted according to your needs.

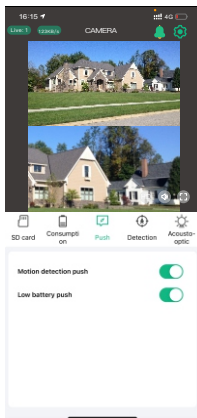

24.Detection Settings

Click  to enter camera motion detection settings, you can set the sensitivity and detection distance adjustment.

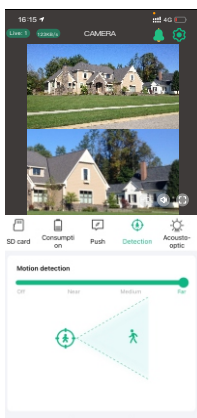

25.Power Consumption

Click  to enter power management, select the use mode according to the environment and user needs, which can better manage the use of the battery.

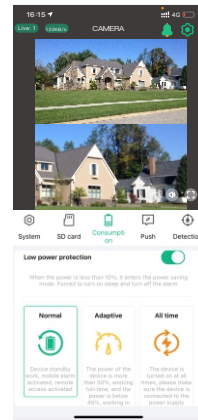

Low power protection:

It is recommended to turn on this function. When the power of the camera is lower than 10%, the camera will automatically turn off PIR and other power-consuming functions.

 Normal mode:

It is the most energy-saving and efficient working mode. When the mobile phone is not remotely monitored, the camera is in standby mode. When a human body passes by, it will automatically activate the alarm and video record and push to the mobile APP at the same time.

 Adaptive mode:

When the power is more than 50%, it will start recording at full time. If lower than 40%, it will work on standby.

 All time mode:

The camera is working at all times, please make sure to connect the power supply to charge in this mode.

26.Sound & light settings

Click  to enter camera sound and light settings, setting working mode of infrared led, white lights and alarm.

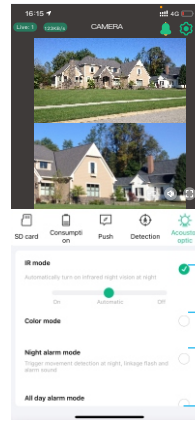

 Infrared leds control

 White lights are on at night, camera video is full color.

 At night, when human passes by, the white lights flash and sound alarm.

 All day alarm mode, when human passes by, the white lights flash and sound alarm.

11. Wall Mounted Installation Instructions

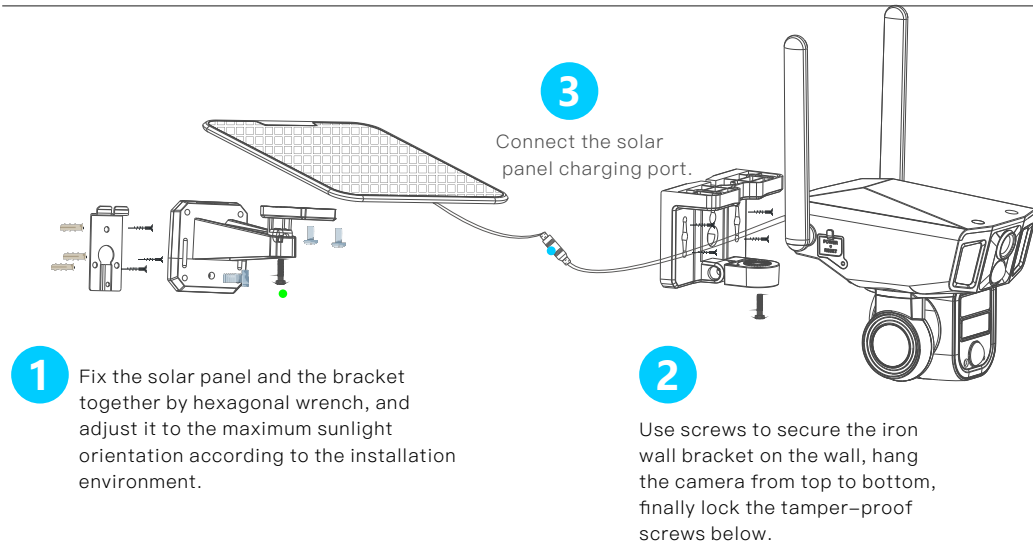

12. Ceiling Mounted Installation Instructions

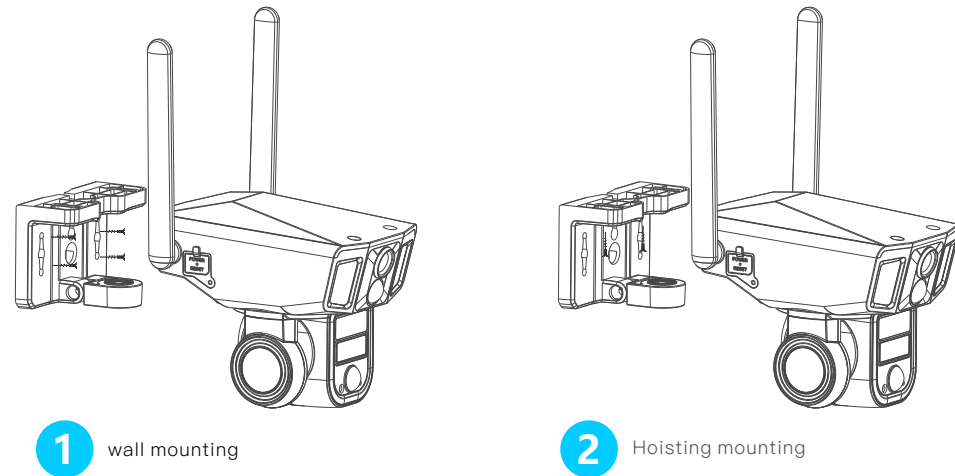

13..Commissioning Instructions

After adjusting the tilt angle of the wide-angle camera, tighten the thumbscrew to fix the lens position.

The horizontal direction of the upper wide-angle camera bracket can be adjusted left and right, and the positioning screw can be fixed after adjustment.

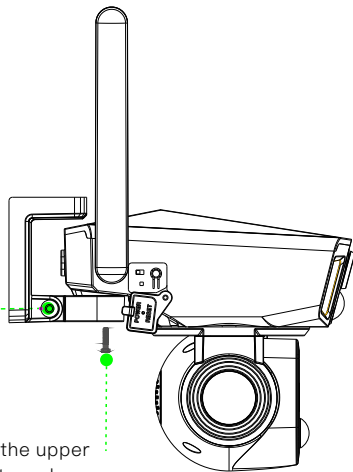

14.Technical Analysis

1. Q:Why doesn't the Wi-Fi name appear when I connect to Wi-Fi?

A: On IOS devices with iOS13 and above, you need to turn on the "location permission" for the app in the system settings and change it to "allow when using".

2. Q:Will the camera show red lights when night vision is activated?

A: The built-in infrared leds make the camera only show some dim red lights when night vision is activated, but the image quality is still clear under no light environment.

3. Q: How far should the device be from the router?

A: After testing, the Wi-Fi connection distance can normally reach up to 220 meters in the open area. However, the actual situation depends on the strength of Wi-Fi and its surrounding environment (thick walls, electromagnetic devices, large metal objects will all cause interference to the Wi-Fi signals). If the camera connection signal is weak or unstable, please place the camera as close to the router as possible.

4. Q: What is the longest recording time?

A: The camera has three working modes.

The default mode is low power consumption mode. When someone passes by, the camera will automatically start recording for 15 seconds. When the person is in the monitoring range, the camera will keep recording. The built-in battery of the camera can work for 6000 wake-ups, and the solar energy supplements 250 wake-ups per hour. In theory, it can be used all the time. The second mode is the adaptive mode. When the battery is above 50%, the camera will record 24 hours. When the power is below 45%, the low-power working mode is turned on. When someone passes by, the camera will automatically start recording for 15 seconds. When the person is in the monitoring range, the camera will keep recording. The third mode is the full-time mode. In this mode, a continuous power supply is required. At full power, if there is no power supply, it can only work for 36 hours.

Technical Analysis

5. Q:How to check the video playback?

A: Click the video playback button on the homepage of the pull-up control menu ,select memory card playback or cloud storage playback.

6. Q: Do I need to always connect my mobile device to any WiFi if I'd like to watch the videos?

A:No, you don't. You can use WLAN or Cellular Data to watch them only if your camera is well connected to your router's WiFi.

7. Q: What will happen when the memory card runs out of space?

A:The oldest footage will be overwritten by the latest one. Please back up the important videos timely or delete the unnecessary videos to release more space. Alternatively, you can subscribe to a cloud plan.

8. Q: What should I do if the WiFi connection failed?

- A:
- * Please make sure your camera is connecting to a 2.4GHz WiFi, not a 5GHz WiFi.
 - * Move the camera and your mobile device closer to your router when connecting.
 - * Check if the WiFi password you entered was wrong or if there are special symbols in the password.
 - * Make sure the power of your camera is enough and your router did not disconnect power.

9. Q: Why does the camera disconnect to WiFi sometimes?

- A:
- * Please check the network connection of your mobile device and the router.
 - * If the camera can't receive a strong signal, please try to move your router closer to the camera, or use a WiFi extender.
 - * Make sure the power of your camera is enough and your router is connected to power.

10. Q: How many cameras can I connect to the same account?

A: You can add 50 cameras, but we recommend adding up to 10 devices for a better experience.

11. Q: How many accounts can a camera share with?

A: 8 accounts.

Technical Analysis

12.When I click on the wide angle screen, if the tracking of the below PTZ lens is not accurate, what should I do?

A. First, click the PTZ reset button on the PTZ control interface, then operate the camera as normal.

If there is still an error in the positioning, please adjust the camera to minimum zoom, and click the Auto Coordinate Calibration button  in the upper right corner of the home page. Wait for 5 minutes, the camera will be re-calibrated according to your monitoring environment, do not exit the APP during this process.

About batteries and solar power

This camera adopts advanced low-power technology. If no motion is detected, the camera will enter sleep mode. After being fully charged, if the camera contains a 20000mAh battery, it can be awakened 6000 times by detecting human movement. If it works for 15 seconds at a time and is charged by solar energy, when the sun is full, the replenished power can be used for 300 wake-ups per hour.

Tips:

If the camera is woken up frequently or detects the movements of human body for many times, the power of the camera will be consumed quickly. Charging the camera regularly is recommended. The battery in the camera can be charged for 500 times. If we charge the camera once a week, the life span of the battery can extend more than 9 years.

The recommended operating temperature of the camera is 14°F~122°F(−10°C~50°C). Battery performance may drop at low temperatures. At −4°F(−20°C), the battery may drain in short time, or even may not charge. It will work normally as the temperature rises.

NOTE: This equipment has been tested and found to comply with the limits for a Class B digital device, pursuant to part 15 of the FCC Rules.

These limits are designed to provide reasonable protection against harmful interference in a residential installation. This equipment generates, uses and can radiate radiofrequency energy and, if not installed and used in accordance with the instructions, may cause harmful interference to radio communications. However, there is no guarantee that interference will not occur in a particular installation. If this equipment does cause harmful interference to radio or television reception, which can be determined by turning the equipment off and on, the user is encouraged to try to correct the interference by one or more of the following measures:

- Reorient or relocate the receiving antenna.
- Increase the separation between the equipment and receiver.
- Connect the equipment into an outlet on a circuit different from that to which the receiver is connected.
- Consult the dealer or an experienced radio/TV technician for help.

Changes or modifications not expressly approved by the party responsible for compliance could void the user's authority to operate the equipment.

This device complies with Part 15 of the FCC Rules. Operation is subject to the following two conditions:
(1) this device may not cause harmful interference, and (2) this device must accept any interference received, including interference that may cause undesired operation.

RF Exposure Warning Statements:

This equipment complies with FCC radiation exposure limits set forth for an uncontrolled environment. This equipment shall be installed and operated with minimum distance 20cm between the radiator & body.