

6.Configuration and Addition of WiFi Devices

3. Add Camera

Run the app, click the upper right corner “+” to add.

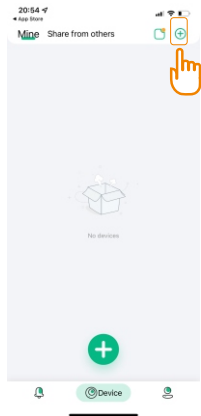

4. Choose Network Type

Select the WiFi option on the left.

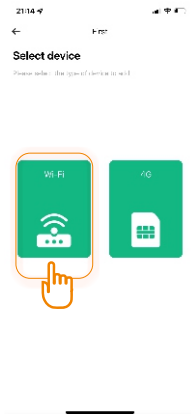

5. Confirm Camera Status

Follow the prompts to determine whether the indicator light on the front of the camera is flashing alternately in red and blue. If the indicator light flashes red and blue alternately, just click “To connect”.

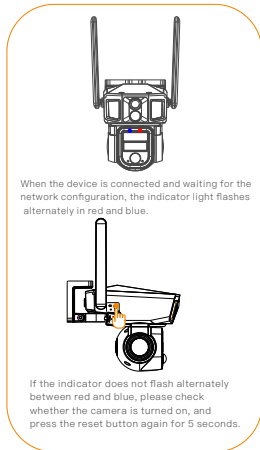

6. Enter Network Information

Click Switch WiFi to select your home WiFi SSID, and enter the password below. (In order to avoid input errors, after the input is completed, you can click the eye pattern on the right to check whether the password is entered correctly).

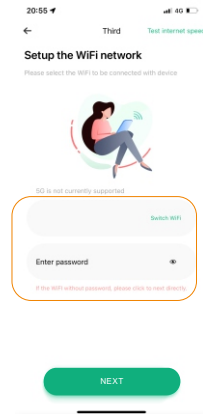

Enter the WiFi SSID and password below

Attention:
5G is not currently supported

7.Scan QR code to Add Devices

Scan the QR code of the camera body, and click “connect” after hearing the mobile phone scan prompt voice. The APP and the camera will be automatically connected to network.”.

Notice: Versions below iOS11 require manual connection to the camera hotspot network. Please follow the APP prompts, go to the phone settings interface to connect to the hotspot starting with NMEW_XXXXX, then return to the APP interface to configure the network.

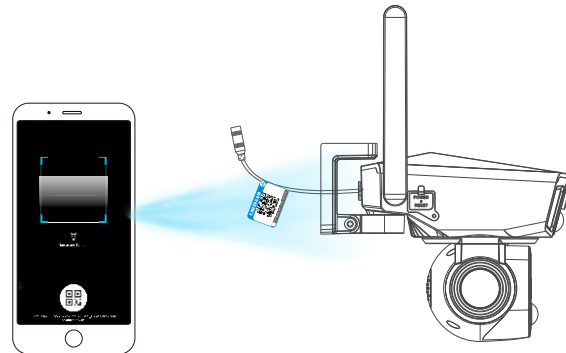

7.APP Homepage Instructions

8.Homepage Function

Introduction of camera's functions in the home page.

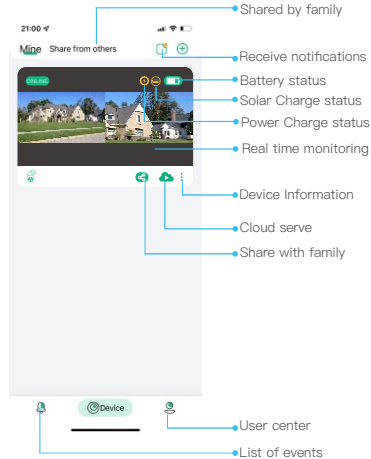

9.Sharing Function

After your family has registered the account, click to share with them.

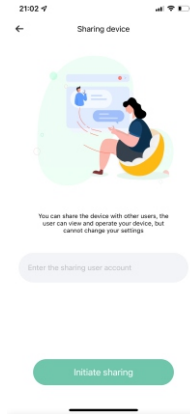

10.Do not Disturb Mode

At the top of the page Enter the Do Not Disturb mode setting. When PIR is triggered, you will get the notifications in the real time. If you do not want to receive notifications, you can turn on Do Not Disturb mode.

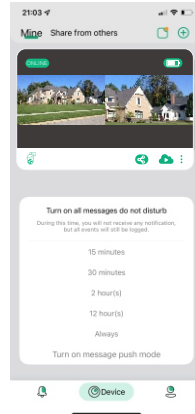

11.Viewing the Event List

Click "Event" at the bottom of the page to enter the event list to view the alarm list of the device.

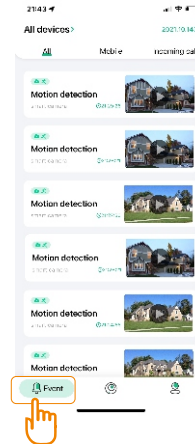

12.Cloud Storage Service

Click at the homepage to purchase the cloud storage packages.

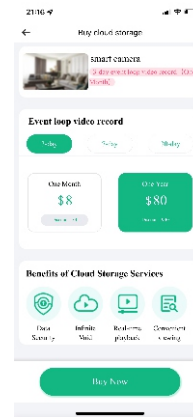

13.Manage Account Information

Click "Mine" at the bottom of the page to enter the APP page, you can modify the login password and manage all functions.

