

VIVOSUN



VIVOSUN GrowHub E25 USER MANUAL

The background of the entire image is a vibrant green with a complex, wavy, wood-grain-like pattern. The lines of the pattern flow diagonally from the top-left towards the bottom-right, creating a sense of movement and organic growth.

Love what you grow™

Welcome to **VIVOSUN**

Thank you for choosing VIVOSUN. We are committed to product quality and friendly customer service. If you have any questions or suggestions, please don't hesitate to contact us.

CONTENTS

Dimensions.....	1
Installation	2
Warranty Information.....	8
FCC ID Statement	9

DIMENSIONS



Top View



Side View

INSTALLATION

Search "VIVOSUN" in the Apple App Store or in the Google Play Store to download the VIVOSUN App. With the VIVOSUN App, you can check and control your GrowHub from anywhere in the world—whether you are on your couch, visiting your family, or traveling abroad.

1. Remote control the devices with manual or cycling mode.
2. Grow Recipes: Enables you to set your lights, circulation fans, and duct fans based on different growth stages. The recipes provided in the VIVOSUN App are created by professional growers. All you have to do is click "apply" and the your VIVOSUN setup with take care of the rest.



INSTALLATION

E25 Installation

Insert E25 to the type C port of AeroLight. E25 will enter WiFi configuration.

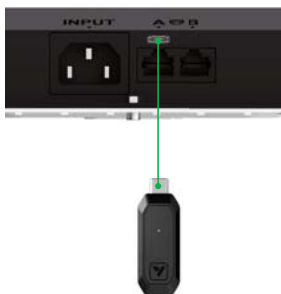

INSTALLATION

WiFi Configuration

During WiFi configuration, the Green LED will flash fast. Then follow the WiFi configuration process on the Vivosun APP

Step 1:

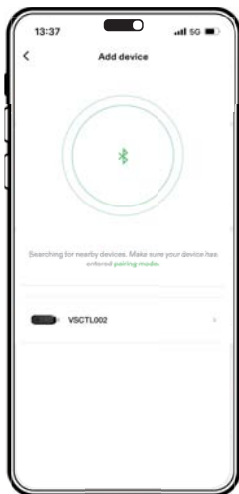

Step 2:



INSTALLATION

Step 3:



Step 4:



INSTALLATION

After WiFi configuration success, the green LED stops flashing and goes off.

If E25 is offline (i.e., no Wi-Fi connection or you do not have internet access), the green LED will flash slowly. It will continue flashing until E25 has a Wi-Fi connection again.

Status Indicator

Quick press the button. The green LED will flash slowly 3 times to show it is working.

Reset

Long press the button for 3 second until the green LED is on, then release the button. The green LED will turn off and reset success. E25 will restart and enter WiFi configuration.

OTA

The green LED will flash fast during OTA.

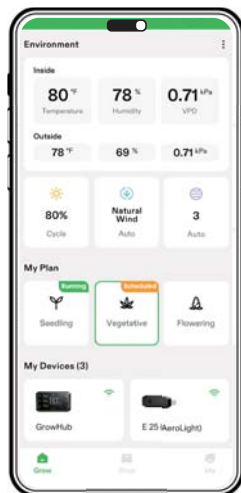

INSTALLATION

CONNECTION OF CONTROLLER AND MULTIPLE LIGHTS

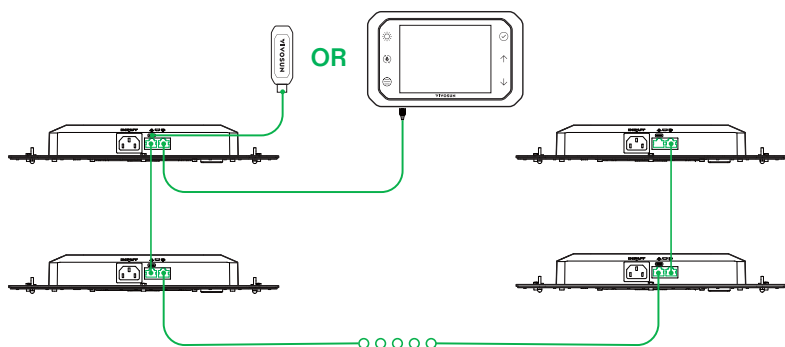

Connect multiple AeroLights with RJ45 cables, and the first light to a VIVOSUN GrowHub controller E42 or E25 to control all the lights for dimming, spectrum tuning and ON/OFF cycle setting. Each light needs to connect the AC power separately and the GrowHub controller only need to connect to an AeroLight to run. Please see the VIVOSUN GrowHub controller E42 manual for information about light control and more if connected to E42.

WARRANTY INFORMATION

WARRANTY TERMS

1. We offer a 3-year warranty against manufacturing defects for all of our products from the date of purchase. If you need warranty assistance, please contact us as soon as possible.
2. The warranty does not cover damage due to high moisture levels, water damage, power surges, improper hanging/mounting, improper use, dust build-up, or users' unauthorized modifications.
3. In the USA, if any light ceases working within 30 days of use, you can choose:
 - (A) Exchange: We will email you a pre-paid return label. Please ship the light back to our USA warranty center and a replacement will be sent to you free of charge as soon as we receive the defective product.
 - (B) Refund: We will email you a pre-paid return label. Please ship the product to our USA warranty center and we will issue a refund as soon as the light has been received. Refund periods may depend on the processing time of your bank or institution—usually, a refund takes about 5 business days to be processed.
4. Our company reserves all rights to the final explanation of this warranty structure. If you have any questions about our warranty policy, please contact us.

FCC ID STATEMENT

This device complies with part 15 of the FCC Rules. Operation is subject to the following two conditions:

(1) This device may not cause harmful interference, and (2) this device must accept any interference received, including interference that may cause undesired operation.

NOTE: This equipment has been tested and found to comply with the limits for a Class B digital device, pursuant to part 15 of the FCC Rules. These limits are designed to provide reasonable protection against harmful interference in a residential installation. This equipment generates, uses and can radiate radio frequency energy and, if not installed and used in accordance with the instructions, may cause harmful interference to radio communications. However, there is no guarantee that interference will not occur in a particular installation. If this equipment does cause harmful interference to radio or television reception, which can be determined by turning the equipment off and on, the user is encouraged to try to correct the interference by one or more of the following measures:

- Reorient or relocate the receiving antenna.
- Increase the separation between the equipment and receiver.
- Connect the equipment into an outlet on a circuit different from that to which the receiver is connected.
- Consult the dealer or an experienced radio/TV technician for help.

Warning: Changes or modifications not expressly approved by the party responsible for compliance could void the user's authority to operate the equipment.

Portable device statements

The device has been evaluated to meet general RF exposure requirement. The device can be used in portable exposure condition without restriction.

Designed by **VIVOSUN** in California.
Assembled in PRC.