

CARRO

Ultrasonic Humidifier

Model: ME-F800W

Rated voltage: 120V

Rated power: 24W

Frequency: 60Hz

Warning Notice: Before using this product, please read this manual carefully and keep it for future reference.

The design and specifications are subject to change without prior notice for product improvement. Consult with your dealer or the manufacturer for details.

USER MANUAL

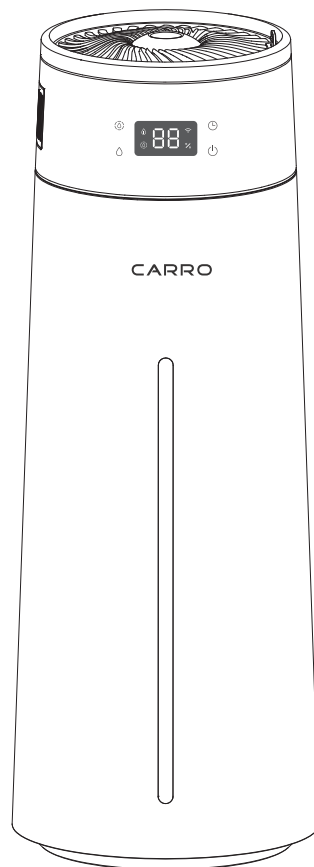

READ AND SAVE THESE INSTRUCTIONS

Read This Manual

Inside you'll find many helpful hints on how to use and maintain your appliance properly. Just a little preventive care on your part can save you a great deal of time and money over the life of your appliance. You'll find many answers to common problems in the troubleshooting tips - you should be able to fix most of them quickly before calling customer service. These instructions may not cover every possible condition, so attention to safety details is required when operating and maintaining this product.

SAFETY PRECAUTIONS

To prevent injury to the user or other people and property damage, the instructions shown here must be followed. Incorrect operation due to ignoring of instructions may cause harm or damage. The different levels of risk is shown by the following indications.



This symbol indicates a hazardous situation which, if not avoided, could result in death or serious injury.



This symbol indicates a hazardous situation, which, if not avoided, could result in minor or moderate injury.



This symbol addresses practices not related to physical injury.

IMPORTANT INSTRUCTIONS

- In the case of power up, do not plug or unplug the power cord with wet hands to avoid electric shock;
- Do not force the water tank to work in the case of no water;
- Do not add any additives not produced or supervised by the company to the water tank;
- Do not put or place anything or pets into the water tank;
- Do not add water to the atomization outlet;
- When the humidifier is working, do not touch the water in the water tank or the parts sank in the water;
- Do not cover the atomization outlet, and please keep it clear above the outlet;

IMPORTANT INSTRUCTIONS

- Do not replace the power cord without authorization, or connect the power cord halfway or use other appliances in parallel;
- Do not place the appliance near water source;
- Do not disassemble, modify or repair internal parts without authorization;
- Do not climb or sit on the appliance;
- Do not store flammable or explosive materials around the humidifier;
- Do not place it near heat source;
- Do not directly flush the humidifier with water;
- Do not turn off the humidifier by unplugging the power cord directly;
- Do not use volatile oil, alcohol, thinner, etc. to clean the machine, otherwise, the product may be damaged;
- Please keep a distance of more than 12 inch between the humidifier and other products;
- Do not modify the use and function of the product without permission;
- Do not place the water container on the live product, the water immersing in the product will weaken the electrical insulation, resulting in Electric shock, fire, etc;
- When the power is turned off in low temperature weather, the water must be drained.

CAUTION

Matters that may cause minor injury or property damage

Please unplug the power plug when filling and cleaning.

The power supply must be within the specified voltage range of the product.

- Please use purified water for humidification;
- Please do not use a damaged or worn power cord; Do not replace the power cord without authorization. If the power cord is damaged, it must be replaced by the manufacturer, its service department or professional from similar department to avoid danger.
- The power must be cut off in thunderstorm;
- When an abnormal phenomenon (like a burnt smell) occurs, the operation must be stopped and the power supply is cut off.
- Please unplug the power cord and clean the water tank, when the appliance is not used for a long time;
- To avoid bacterial growth, please always change the water in the water tank.
- When the appliance is moved, please unplug the power cord to keep the water tank stable and to prevent the water from overflowing in the water tank;
- If the appliance is tilted when filled with water, be sure to unplug the power cord immediately and send it for inspection.
- Suitable temperature for this product: 41°F -104°F; relative humidity: less than 80% RH (please fill purified water with water temperature below 104°F).

RULES FOR SAFE OPERATION

WARNING

- Please be sure to unplug the power cord before filling water.
- The level of the water added shall not be higher than the highest water level;
- Please be not to add the water in the atomization outlet when the water is added;
- Please do not add additives like essential oil, perfume, drug, etc. to the water.
- Please use the purified water below 104°F(Do not use distilled water).

ASSEMBLY

This humidifier is pre-assembled in factory.

SPECIFICATIONS

NOTICE

- The following are the design parameters of ME-F800W the measured parameters are subject to the product;
- The humidification amount will vary, depending on the temperature and humidity in the room.
- Actual humidification amount is not less than 90% the standard 390mL/h.

Model	Rated voltage	Rated frequency	Rated power	Noise	Volume of tank
ME-F800W	120V ~	60Hz	24W	38dB	2.1lGal

PARTS AND FEATURES

NOTICE

- The pictures of the Manual are for reference only, and the actual product in the packing box shall prevail
- The product appearance and function vary with the model; Please be subject to the real product, with optional reading of the respective function description.

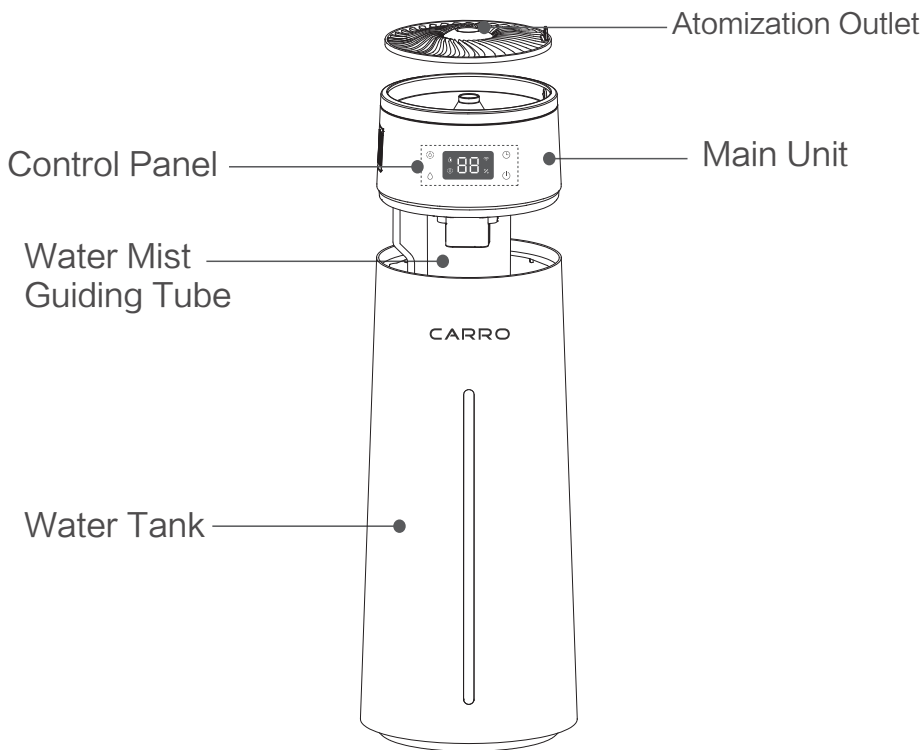

Manual × 1

INSTRUCTION FOR USE

Two methods for water filling

Method A

Fill the water tank directly through the main unit cover. Please use purified water. Please do not add the water in the atomization outlet.

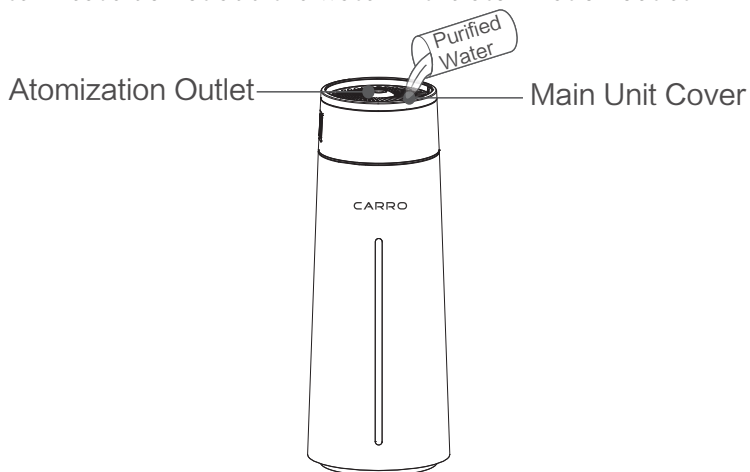

Method B

Lift the main unit of the humidifier up and fill purified water directly from top of the water tank.

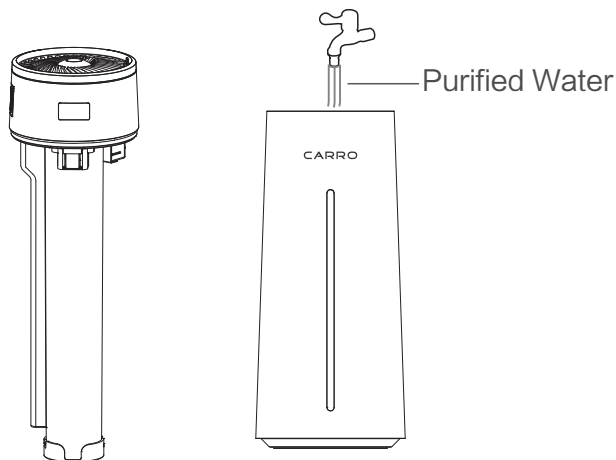





OPERATION INSTRUCTIONS



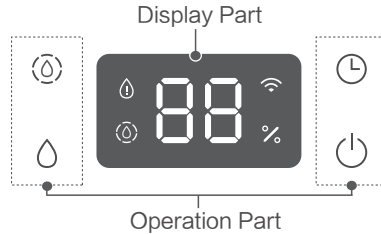

⚠ NOTICE

- If the indoor temperature is too low or the humidity is too high, and the mist cannot be fully diffused, it is recommended to reduce the volume of water mist.
- When humidity setting lower than current humidity, the atomizing mist will stop within two minutes.

Control Panel



Buttons	Operation
 On/Off	<ol style="list-style-type: none"> 1. Shortly press this button to enter the on/idle state. 2. In the on/idle state, press and hold 3 seconds till hear “beep”, the WIFI signal on the screen will blink and enter the CARRO HOME APP connection Mode.
 Atomization adjustment	<p>Under working conditions, the humidity and atomization amount can be set to three levels (small, medium and large). Press and hold till hear “beep” to turn off the display screen light.</p>
 Timing button	<ol style="list-style-type: none"> 1. Shortly press in the working conditions, you can cycle to set the timer function. The timer setting can be 0h→1h→2h→4h→8h→0h. 2. In the process of setting, the setting timer time will be displayed first, and then if you do not operate, the timer will flash 3 times and then switch to display the humidity of the current environment. 3. The timer time displays in a countdown way. After setting the timer, if you press the timer button again, the operation screen will display the remaining time before shutdown, and then press the timer button again to re-set the timer. 4. After the timer is turned on, press and hold the timer button for 3 seconds to exit the timer setting state.

 Humidity On/Off	<p>Humidity setting On/Off, this On/Off button for preventing mistakenly touching. The default humidity setting is 60%RH.</p>
 Water shortage indicator light	<p>The indicator light is on when the humidifier is shortage of water.</p>
 WiFi indicator light	<p>When connecting to the network, the indicator light is on.</p>
	<p>01 small atomization amount 02 medium atomization amount 03 large atomization amount 0h/01h/2h/4h/8h timer Display the humidity of the environment, such as 60%.</p>

CLEANING AND MAINTENANCE

WARNING

- IMPORTANT TIP: DO NOT leave the humidifier plugged in for prolonged periods (i.e. several days or more) without use.
- This causes premature failure of the circuitry. When the humidifier is not in use, press the control button until the light goes off, then UNPLUG it.
- Before cleaning or descaling, be sure to unplug the power cord.
- Do not use abrasive, corrosive, or flammable cleaners (such as bleach or alcohol) to clean any part of the humidifier.
- The humidifier must regularly clean the scale and debris in the water tank and sink. It is recommended to clean it once a week.



Clean the outside part of the machine.

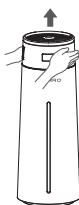

Lift the main unit up in the direction of the arrow.

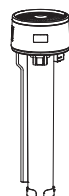

Clean the outside part of the machine.

Cleaning the outer casing

Wipe and clean the surface of the whole machine with a slightly damp soft cloth. In case of stubborn stains, add a small drop of detergent to clean it, and then wipe the detergent away.

Warning: Do not use a dripping soft cloth to clean the outer casing, or rinse it with a shower.

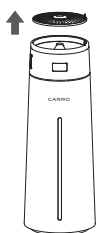

Lift the main unit cover.

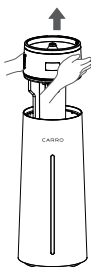

Lift the main unit up in the direction of the arrow.

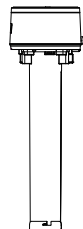

Placed the main unit on the platform and stabilize it.

Tank cleaning

First take out the main unit cover, then lift the main unit upwards, shake the main unit slightly, so that the water in the mist guiding tube flows back to the water tank, put the main unit aside, then pour clean water into the water tank, and add an appropriate amount of detergent for cleaning. Use a clean cloth to dry the inside and outside of the water tank.

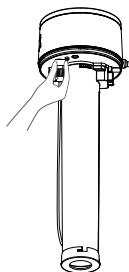

Fig 1

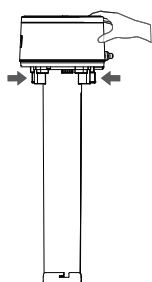

Fig 2

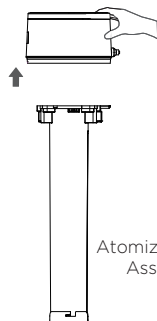

Fig 3



Fig 4

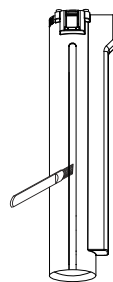

Fig 5

Cleaning the inside & outside of the mist guiding tube, and the atomizing head

1. Rotate counterclockwise to unscrew connecting hose of the main unit and the atomizing head as shown in **Fig 1**.
2. Hold the main unit with one hand, press the spring switch of the mist guiding tube with the other hand at the same time as shown in **Fig 2**, and remove the main unit in **Fig 3**.
3. Rotate the lower cover of the tube clockwise to remove the cover, and then take out the atomizing head assembly as shown in **Fig 4**.
4. Clean the dirt inside the tube with a long-handled soft brush as shown in **Fig 5**, and then wash the tube in the sink.

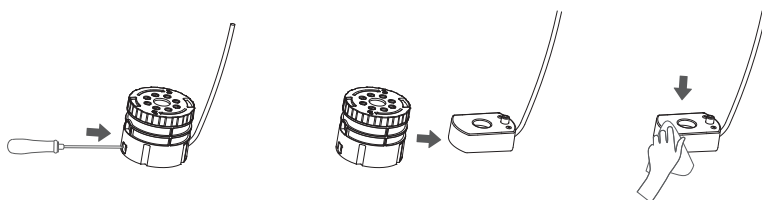

Fig 6

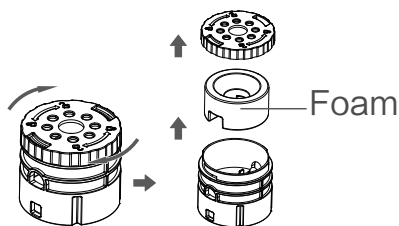

Fig 7



Fig 8

5. Use a screwdriver to poke the small hole in the back of atomizing head assembly, and take out the atomizing head for cleaning as shown in **Fig 6**, and wipe the center of it with a damp soft cloth.
6. When cleaning the components of the float, first rotate the upper shell of the float clockwise and take it out, and then take out the foam of the float as shown in **Fig 7**.
7. Wipe the upper shell of the float with a clean damp cloth, use a soft brush to clean the lower part of the float as shown in **Fig 8**, and then put it in sink to clean it.

⚠ NOTICE

The foam of the float in **Fig 7** is important part of atomizing head assembly, **DO NOT** mistakenly discard it as part of the packaging.

Mist tube assembly installation

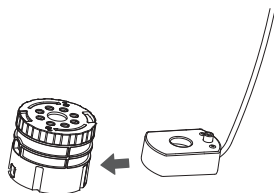

Install the atomizing head on the float assembly.

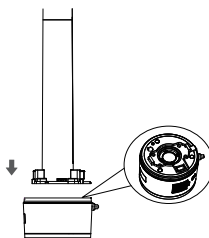

Put the main unit on the table, and align the mist guiding tube with slot of it for installation.

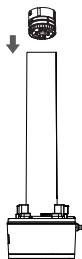

Install the float assembly into the mist tube.(The upper shell of the float faces the direction of the main unit.)

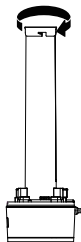

Rotate the lower cover of the tube clockwise.

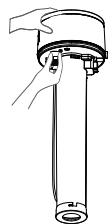

Connect the atomizing head hose to the main unit.

APP Control Connection:

1.First download the free Carro Home app from the App Store or Google Play or scan the QR Code as below.

Note: This humidifier needs to use 2.4Ghz wifi to work when you connecting the device, and after connecting it can use the 5Ghz or 2.4Ghz.



2.Open the Carro Home app to create your account. The account with "Carro Home" can be registered through E-mail or Mobile phone.

3.Connect the device to the Carro Home APP(The WIFI signal on the screen is blinking):

- Press "+" button,select "Smart Home Appliances" on the sidebar menu on next page,then select "Humidifier".
- Connect to your home WIFI (Only for 2.4Ghz).
- Press the Smart Humidifier "+" button to wait for the connection to complete.

Note:Press and hold the "⏻" till hear "beep", the WIFI will blink and enter the CARRO HOME APP connection Mode.

4.Connect the device to the Alexa:

- Make sure you have connected the device to the app and working normally.
- Open Alexa app, go to the skill to search "Carro Home" skill.
- Link the skill, log in with your Carro Home app account and password, then authorize and connect with Carro Home app.
- Then the Alexa will find out the device automatically.

5.Connect the device to the Google Home

- Make sure you have connected the device to the app and working normally.
- Open Google Home app, Set up a device, choose "Works with Google".
- Search "Carro Home", log in with your Carro Home app account and password, then authorize and connect with Carro Home app.
- Then the Google Assistant will find out the device automatically.

6.Connect the device to the Siri shortcuts

- Make sure you have connected the device to the app and working in functional.
- Tap "Smart" on the main menu.
- Tap "+" button.
- Tap "launch Tap To Run".
- Tap "Run the device".
- Choose the device you want to control by Siri.
- Select the function you want to control by Siri.
- Then save it.
- Add to Siri, choose the scene you just made, Add to Siri.
- Enter the sentence you want to say to make the device works, Add to Siri.

SERVICE GUIDE

Fault Handling

NOTICE

- If the humidifier does not work properly after the following suggestions, please contact the customer service center or local service station.

PROBLEM	CAUSE	SOLUTION
The humidifier does not work	The power plug is not plugged well	The power plug is plugged well
	There is no water in the water tank	The water is added to the tank
	The water tank is not in place	The water tank is fastened in place
Mist has a bad odor	The water tank is not clean.	The clean water is refilled, or the water tank cleaned
	New machine	Leave the water tank open in the shade for 12 hours.
Humidifier is emitting a white dust/residue.	Use of tap water with a high mineral content, aka "hard water."	Clean tank and use only demineralized or purified water.
There is abnormal noise	The appliance is not in place, tilted or unstable	The appliance is placed on a solid surface or a flat place
The water tank shows water shortage, but is filled with water; the humidifier does not work for a long time.	Excessive tilting of the appliance at an angle causes the water level in the water tank to be judged as low water level, so the appliance automatically starts protection mode and stops.	The appliance is put on a flat and firm place, and kept steady
The display screen shows "P1"	The water tank is short of water	The water is added to the tank
Small amount of mist	Fouling of atomizing head assembly	Clean the atomizing head assembly.
	Too little ,or too much water(above the maximum water mark)	Fill enough water,or pour out some water.
The display screen is on,windy but no mist	The atomizing head is stuck	Clean and gently drag the hose of the atomizing head, make it smooth.

ONE (1) YEAR LIMITED WARRANTY

WHAT IS COVERED

This warranty covers any manufacturing defect for the humidifier, with the exceptions stated below.

HOW TO GET SERVICE

Please keep your receipt or other document so that we may process your warranty request. To obtain service, contact by E-mail : cs@carrohome.com
Tel: 888-253-2374.

HOW LONG COVERAGE LASTS

This warranty runs for one (1) years from the date of purchase.

WHAT IS NOT COVERED

The warranty applies only to the original Purchaser within the USA and does not cover:

- Wear and tear
- Stains
- Misuse or improper maintenance
- Alteration or repair by unauthorized representatives
- Damage resulting from transit or handling
- Damage caused by improper placement (such as placing products near heating pipes, etc.)
- Deterioration caused by Force Majeure (unforeseeable circumstances, such as fire, earthquake, flood, lightning and other natural disasters, environmental pollution)
- Any humidifier outside of the contiguous 48 states
- Any claim made outside of the warranty period

QUESTIONS? CONTACT US.

Carro USA Inc.

1431 S. Baker Ave. Ontario CA 91761

Tel: 888-253-2374

www.carrohome.com | cs@carrohome.com

FCC Statement:

This device complies with part 15 of the FCC Rules. Operation is subject to the following

two conditions: (1) This device may not cause harmful interference, and (2) this device

must accept any interference received, including interference that may cause undesired

operation.

This equipment has been tested and found to comply with the limits for a Class B digital

device, pursuant to part 15 of the FCC Rules. These limits are designed to provide reasonable protection against harmful interference in a residential installation. This equipment generates, uses and can radiate radio frequency energy and, if not installed and used in accordance with the instructions, may cause harmful interference to radio communications. However, there is no guarantee that interference will not occur in a particular installation. If this equipment does cause harmful interference to radio or television reception, which can be determined by turning the equipment off and on, the

user is encouraged to try to correct the interference by one or more of the following measures:

- Reorient or relocate the receiving antenna.

- Increase the separation between the equipment and receiver.

- Connect the equipment into an outlet on a circuit different from that to which the receiver is connected.

- Consult the dealer or an experienced radio/TV technician for help.

Caution: Any changes or modifications not expressly approved by the party responsible

for compliance could void the user's authority to operate the equipment.

This equipment complies with FCC radiation exposure limits set forth for an uncontrolled environment. This transmitter must not be co-located or operating in conjunction with any other antenna or transmitter.

This equipment should be installed and operated with minimum distance 20cm between the radiator&your body.