

Statement

Thank you for purchasing our product! This quick user guide will talk about main usages of the product. More information can be found on our website and the help center. This user guide may contain inaccurate content due to hardware and software upgrade. It is subject to change without previous notice.



Safety Caution

- 1 Please do not put any fluid container on the product.
- 2 Please use the product in ventilated environment and prevent blocking the vents.
- 3 Please use included power supply with the product to prevent damage to the product.
- 4 Please use the product under its standard working temperature and humidity. (advised in this manual or distributor's website)
- 5 Dust on PCB may cause short circuit. It is suggested to clean the dust on PCB timely to make the product work properly.
- 6 Please obey the regulation and policy in your country and area during the installation of this.



NVR

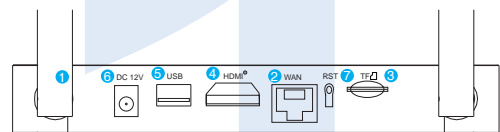

- 1 Antenna port: Dual antennas expand the WIFI range;
- 2 WAN port: Connect the NVR to the Internet;
- 3 TF card slot: TF card interface;
- 4 HDMI interface: Connect to high-definition TV;
- 5 USB port: Connect mouse and U disk;
- 6 Power supply: DC power input (12V 2A);
- 7 RESET: Press and hold for 3 seconds to reset (clear the password, network and other settings, do not clear the camera channel, release the button and restart to take effect), continue to press the reset button for 10 seconds to reset all (clear the password, including all settings such as camera channels and so on);



IPC

Mini NVR can be combined with different cameras to form a kit. The interface description below only takes common cameras as an example. Please refer to the actual interface position of the camera in the package.

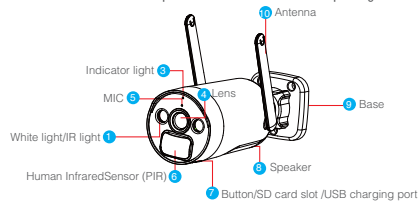

The instructions of LED light :

- Green light flashes for 2s and goes out: The device is powered on and connecting to the network
- Green light + red light is always on: The camera is being previewed remotely (privacy light)
- Green light is always on: The device is connected to the network or awakened

- Green light flashes continuously: Upgrading
- Green light flashes continuously and slowly: Charging
- Red light flashes 3 times quickly: Power off
- Red light is always on: Low battery
- The traffic light is always off: In standby

Button operation for Two-button model:

- Press and hold the on/off button for 2s when shutting down: Turn on
- Press and hold the on/off button for 2s when powering on: Power off
- Press and hold the reset button for 3s: Reset

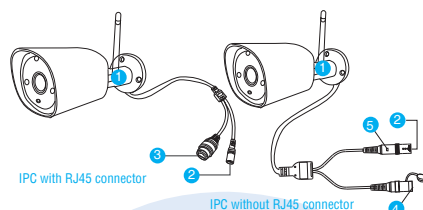

- 1 Wireless antenna: Wireless connection with NVR
- 2 DC Port: Input power 12V 1A;
- 3 RJ45 Port: For matching code and wired connection between IPC and NVR. Anyway, there is range limitation for the wireless signal from NVR. When cameras are out of this range, they can't be connected to NVR wirelessly. Then users can use network cable to connect cameras and NVR.
- 4 Reset button: Press reset button for 5 seconds to restore factory setting and enter into matching-code mode.

Status light:

Unbright: IPC system is not ready or abnormal

Flash: IPC is in the code-matching state

Long time bright: IPC and NVR have been coded, the connection status is normal

Slow Flash: IPC is coded with the NVR, but the connection is disconnected

Note: In night vision mode, the device is normal for 5s, the indicator light will be turned off to prevent light interference.



Hard disk installation

- 1 Open the hard disk cover on the back of the chassis and remove the cover.
- 2 Align the hard disk socket with the wiring port on the NVR, insert the hard disk, and pay attention to the direction of the hard disk.
- 3 Align the hard disk with the hard disk socket and push it to the left to fix the hard disk.
- 4 Close the hard disk cover.



System connection and installation

Connect the system as shown in the steps below

- 1 Insert one end of the HDMI cable into the HDMI port of the NVR rear panel, and the other end into the HDMI port of the TV or monitor;
- 2 Insert the USB mouse into the USB port on the NVR rear panel;
- 3 Connect one end of the network cable to the WAN network interface of the NVR rear panel, and the other end to the home router or network access point;
- 4 Connect the power adapter connector to the power socket on the NVR rear panel, and then insert the adapter into the surge protector or uninterruptible power supply (UPS); make sure that the surge protector or uninterruptible power supply (UPS) switch is ON. After a few moments, the NVR splash screen will appear on the screen;
- 5 Press and hold the power button of the camera for 2 seconds to turn it on.

System wiring diagram

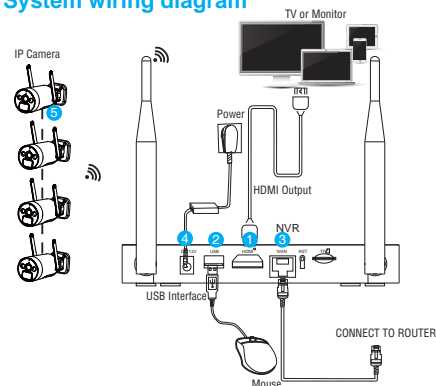

Configure WNVR on TV or Monitor

After powering on, please follow the steps of the setup wizard to complete the settings of language, network, time, view real-time screen, password, hard disk and download APP and device. If you see the prompt "Network status is good!" in the network setup wizard interface, it means your recorder has successfully connected to the Internet.

(Tips: If there is no Internet near your video recorder device, you can also choose to use it without connecting to the Internet. This method will make it impossible to use the mobile APP to watch the video from a long distance.)



> Menu bar

Right-click and you'll go to the main menu, right-click again to exit the menu or go back.

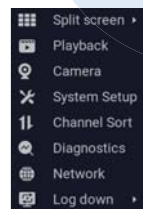

- Split screen selection: Change the view state, you can choose to view multiple or single cameras.
- Video playback: Enter the video playback interface to play the recorded video.
- Camera Settings: View the settings related to the added camera.
- System Settings: Manage all system settings.
- Channel Sort: Adjust the camera channel sorting order.
- Device Diagnosis: Diagnose camera status, signal and firmware version.
- Network Settings: View your device's network connection.
- Exit the system: Logout, restart, shutdown functions.

> System Settings

Right click on the mouse → select System Settings: You can modify system-related settings.

- General settings: Set language, display resolution, audio volume and view firmware information.
- Camera settings: All camera settings, alarm settings, recording settings.
- Date/Time: Set device time, date and time zone information.
- Network settings: Network connection to router settings, wireless channel settings.
- Device Diagnosis: Device and added camera status detection and diagnosis.
- Storage settings: View hard disk or TF card information and format.

> Channel Toolbar

Move the left mouse button to the corresponding channel, and the toolbar at the bottom of the pop-up channel will be activated. Click the corresponding icon to enable the corresponding function settings.

From left to right: Audio output switch button, camera light control and color adjustment button, PTZ control button, talkback button, channel full-screen playback button.



Recording settings

Right click on the mouse → select camera settings → select recording mode on the right side of the interface

1 Camera working mode

The battery camera includes three modes: Best power saving, best video recording, and always video recording;

The constant power camera includes two modes: constant recording and event recording; the specific mode function introduction is entered into the setting interface for detailed viewing, and the corresponding working mode is selected according to the usage scene of your device.



2 Smart detection settings

Right click on the mouse button → select camera settings → enable smart detection on the right side of the interface, click smart detection settings. You can set the camera's detection area, sensitivity level, detection type (humanoid), humanoid frame switch and other functions;



3 Smart detection period setting

Right-click on the mouse → select camera settings → detect time period settings on the right side of the interface.

During the set time period, the device will detect the motion and start recording, here you can set any time period you want to record, such as 0:00:00-23:59:59 every day, which is 24h*7 days of recording; video recorder When the hard disk is detected, the system defaults to record 24h*7 days.

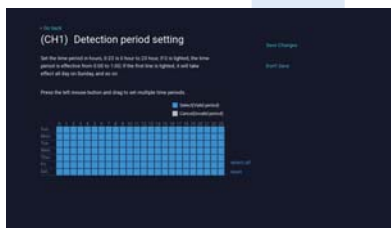

Video Playback

1. Right-click on the video preview interface and enter the playback interface, it will automatically start retrieving the video of the day (default video playback);
2. Select the video playback type (video playback or smart playback), select the date and channel, and select the recording type (movement, timing, humanoid), and the recording will be retrieved in real time;
3. Function introduction:
 - 1 Button description: Play: Fast forward 2 times, 4 times, 8 times; Switch between 1 and 4 channels; Play in full screen;

- Timeline:** You can click 24h, 1h, 30m in the lower left corner to switch the unit of the time axis. In the area with the video time axis, click the left mouse button to start playback from the time the mouse clicked.
- Smart playback:** Click the video thumbnail below to play the video recording, and select the options of human shape, and mobile recording to view only the corresponding type of video clips(Note:SD card video recording does not support intelligent layback.
- All recordings:** Click on all recordings to display the required recording clips of the current channel, and you can select the recordings in the corresponding time period to play.



Video Backup

You can use a USB flash drive to backup videos, which is easy and convenient. In the video playback interface, select the channel window that needs to be backed up → click the backup video button in the lower right corner → insert the U disk → select the export folder → click export.

(Reminder: U disk format currently only supports U disk in FAT32/exFAT format for backup, and video files are packaged once an hour)

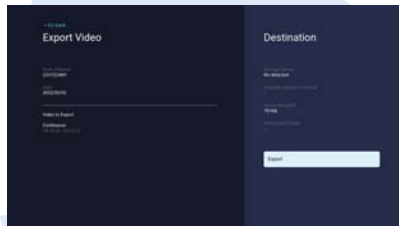

Add IP Camera (IPC)

- Automatically add:** The wireless camera that is shipped together with the recorder equipment, just connect the power supply, wait for a period of time, the recorder will automatically add the camera, and you can view the successfully added camera screen in the preview interface.

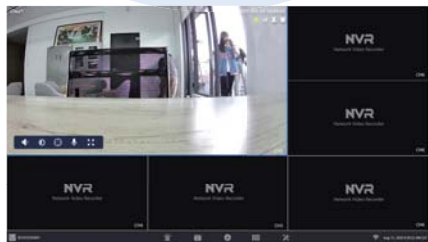

- Manually add:**
Step 1: Click the "+" icon at the bottom of the preview interface.
Step 2: Reset the camera or connect the camera to the recorder with a network cable, click Next.
Step 3: After the camera to be added is found in the waiting list, click Next.
Step 4: Check the video screen of the camera, after confirming that the camera has been added successfully, click Next to enter the preview interface.

(Tips: When adding a camera, please try to place the camera and the recorder as close as possible)

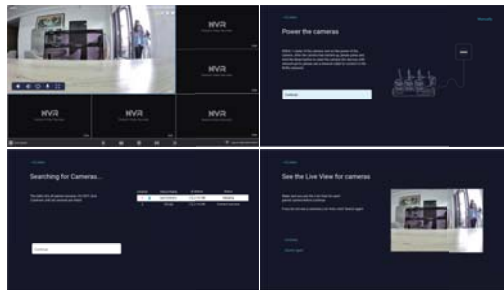

APP remote viewing video

- Download and install**
You can search for "EseeCloud" in App Store, App Store and other application markets to download. Or scan the QR code below to download.
Note: Apple mobile phone system requires iOS system 9.0 or above, Android mobile phone system requires Android 5.1 or above.



- Registration and Login**
1). Click Register, input your mobile phone number/email, input the verification code, and complete the registration;
2). Enter your registered mobile phone number and password on the login interface, and click Login;
3). Click the third-party application icon at the bottom of the login interface, and you can log in successfully after completing the authorization.

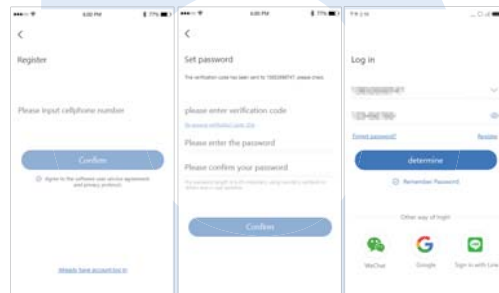

- Add device**
1). Click "+" on the device list interface to add a camera;
2). Scan the ID QR code on the recorder (click the QR code icon in the lower right corner of the preview interface);
3). Set the device name to add successfully.

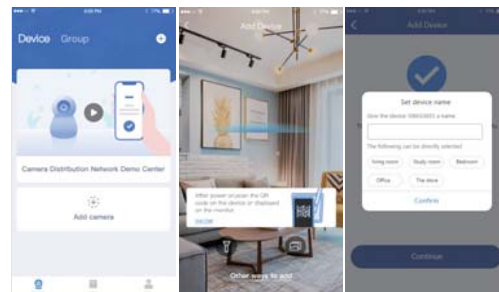

View video screen and video playback

Device List Click the device card to enter the video preview interface, select View Playback to view the channel video recording of the recorder.

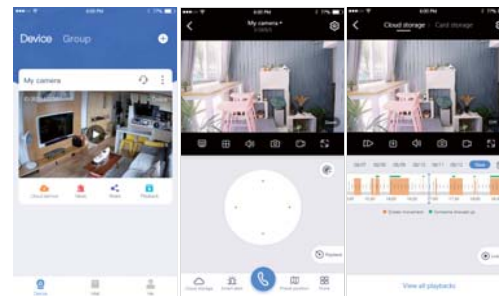

(Tips: Please make sure that your video recorder is connected to the Internet when using the EseeCloud APP to add and view the video recorder screen)

Expand Wireless Coverage

Wireless connection is simple and convenient, but wireless is not everything! Because of the wireless characteristics, in some complex scenarios, there is a signal attenuation situation after passing through obstacles. Extend the signal transmission distance by placing the antennas reasonably as follows.

> Reasonably adjust the antenna and optimize the signal radiation direction

As can be seen from the bar antenna gain chart as shown on the right, the signal coverage of the antennas similar to an apple. The antenna is located in the center of the apple, and the signal around the antennas strong. The upper and lower ends of the antenna are recessed, and the signal is weak.

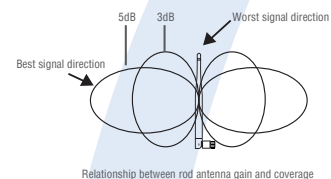

According to the signal transmission characteristics of the antenna, in order to ensure the optimal image transmission effect of the wireless NVR Kit, it is required:

- The antennas of the NVR and IPC should be placed in a high and open place, and not near the walls, metal, glass and other obstacles, which will affect the signal's outward divergence.
- The antenna of the IPC should be placed in parallel with the NVR antenna as much as possible so that the respective maximum radiation direction angles are opposite to form the maximum signal coverage, as shown in the figure below.

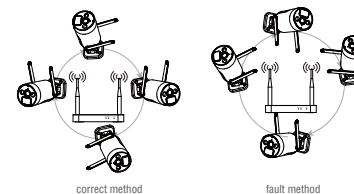

> Camera installation method

Note: Here we only take the battery camera as an example to illustrate the installation method of the camera and solar panel.

- Use positioning paper to punch holes, the cement wall needs to be nailed with rubber plugs;



- Fix the base with screws;

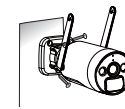

- Adjust the tilt angle of the camera to a suitable position and then tighten the fixing screws;

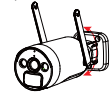

- Install the solar panel as far as possible in the position with the longest sunlight.

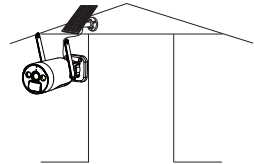

Warning

Notes:

- Device will not in guarantee if caused by below reason:
- Accident; negligence; disaster; mis-operation.
 - Do not conform to the environment and conditions, such as power improper, working temperature too high or too low, lightning stroke ect.
 - Ever be maintained by other center which not belong to the real factory.
 - Goods already sold more than 12 months.



FCC RADIATION NORM

FCC

This device complies with Part 15 of the FCC Rules. Operation is subject to the following two conditions:
(1) this device may not cause harmful interference, and (2) this device must accept any interference received, including interference that may cause undesired operation.

FCC Compliance Statement

These limits are designed to provide reasonable protection against frequency interference in residential installation. This equipment generates, uses, and can radiate radio frequency energy, and if not installed or used in accordance with the instructions, may cause harmful interference to radio communication. However, there is no guarantee that interference will not occur in television reception, which can be determined by turning the equipment off and on. The user is encouraged to try and correct the interference by one or more of the following measures:

- Reorient or relocate the receiving antenna.
- Increase the separation between the equipment and the receiver.
- Connect the equipment into an outlet on a circuit different from that to which the receiver is connected.
- Consult the dealer or an experienced radio/TV technician for help.

CAUTION!

The Federal Communications Commission warns the user that changes or modifications to the unit not expressly approved by the party responsible for compliance could void the user's authority to operate the equipment.

NOTE: This equipment has been tested and found to comply with the limits for a Class B digital device, pursuant to part 15 of the FCC Rules. These limits are designed to provide reasonable protection against harmful interference in a residential installation. This equipment generates, uses, and can radiate radio frequency energy and, if not installed and used in accordance with the instructions, may cause harmful interference to radio communications. However, there is no guarantee that interference will not occur in a particular installation. If this equipment does cause harmful interference to radio or television reception, which can be determined by turning the equipment off and on, the user is encouraged to try to correct the interference by one or more of the following measures:
—Reorient or relocate the receiving antenna.
—Increase the separation between the equipment and the receiver.
—Connect the equipment into an outlet on a circuit different from that to which the receiver is connected.
—Consult the dealer or an experienced radio/TV technician for help.

:

FCC WARNING

This device complies with part 15 of the FCC Rules. Operation is subject to the following two conditions: (1) this device may not cause harmful interference, and (2) this device must accept any interference received, including interference that may cause undesired operation.

Any changes or modifications not expressly approved by the party responsible for compliance could void the user's authority to operate the equipment.

NOTE: This equipment has been tested and found to comply with the limits for a Class B digital device, pursuant to Part 15 of the FCC Rules. These limits are designed to provide reasonable protection against harmful interference in a residential installation. This equipment generates, uses and can radiate radio frequency energy and, if not installed and used in accordance with the instructions, may cause harmful interference to radio communications. However, there is no guarantee that interference will not occur in a particular installation.

If this equipment does cause harmful interference to radio or television reception, which can be determined by turning the equipment off and on, the user is encouraged to try to correct the interference by one or more of the following measures:

- Reorient or relocate the receiving antenna.
- Increase the separation between the equipment and receiver.
- Connect the equipment into an outlet on a circuit different from that to which the receiver is connected.
- Consult the dealer or an experienced radio/TV technician for help.

To maintain compliance with FCC's RF Exposure guidelines, This equipment should be installed and operated with minimum 20cm distance between the radiator and your body: Use only the supplied antenna.