

Car A/V & Navigation System

User Manual

Before using this product, please read the product brochure carefully and keep it for future reference.

Basic operation

Turn on/off unit

Power on

- 1: If the last time is to turn off the ACC, re-insert the key, the unit can automatically boot.
- 2: If the last time power off by pressing the panel power button, press the power button to boot.

Power of

- 1: Pull out the car keys, the unit will power off
- 2: Long press the power button for more than 2 seconds, the system will automatically shut down.
(According to the actual model)

Main function interface

- * Built-in FM/AM stereo radio function.
- * Built-in music, video player.
- * Built-in Bluetooth hands-free phone, phone book, Bluetooth music player and other functions.
- * Support USB audio and video playback.
- * Support Apple, Android mobile phone mirror link function.
- * Support the original car steering wheel control.
- * Support IGO, Navitel, Sygic map and so on.
- * Support the original car CANBUS, OBD information display.
- * Support the original car air conditioning control function.
- * Built-in browser.
- * Rear view.
- * Front view, side view optional.
- * Built-in WIFI.
- * 3G and 4G surfing internet function optional.
- * DVR optional.
- * External DVD optional.
- * USB / SD maximum readable capacity of 32GB.
- * Easy to read USB / SD.
- * Canbus /Car auto

Basic operation

Main interface summary

The following icons are for reference only and adjusted according to different series



Basic operation

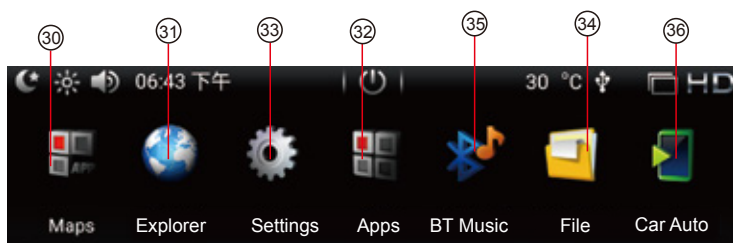

Main interface summary

- | | |
|---------------------------|---------------------|
| 1、Power off | 20、Refuse |
| 2、Turn off screen | 21、Sound adjustment |
| 3、Drightness | 22、Time |
| 4、Current time | 23、Date |
| 5、HD | 24、Week |
| 6、WIFI connection display | 25、Calendar |
| 7、Temperature | 26、Current function |
| 8、Shrink the screen | 27、Previous |
| 9、Navigation | 28、Pause |
| 10、Radio | 29、Next |
| 11、Music | 30、App customize |
| 12、Picture | 31、Explorer |
| 13、Bluetooth | 32、Apps |
| 14、Video | 33、Setting |
| 15、PhoneLink | 34、File Manager |
| 16、Home | 35、BT Music |
| 17、Back | 36、Car Auto |
| 18、Answer | |
| 19、Bluetooth connection | |

Radio

Enter Exit

Click the radio icon enter to the radio interface

Basic Function

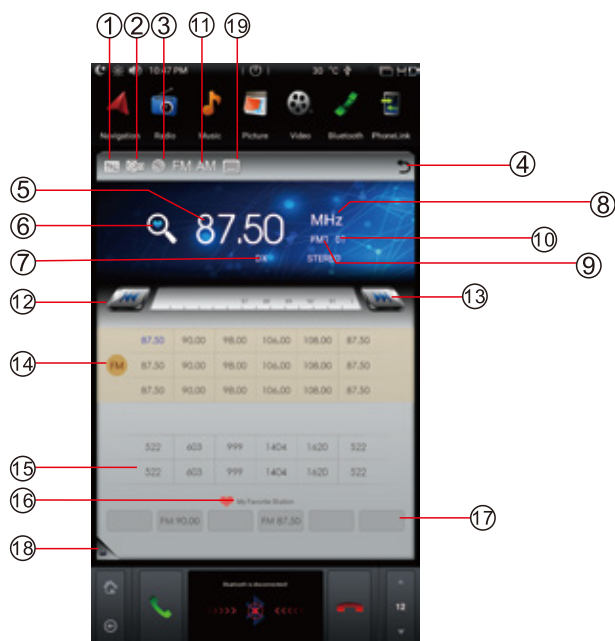

- | | |
|----------------------------|------------------------------|
| 1、EQ | 11、FM/AM Switch |
| 2、Channel | 12、Search backward |
| 3、Local/remote | 13、Forward search |
| 4、Back | 14、FM Radio |
| 5、Current frequency | 15、AM Radio |
| 6、Scan radio channel | 16、My favourite station |
| 7、Mode display | 17、Radio list |
| 8、MHZ | 18、Semi-collection interface |
| 9、Broadcast frequency | 19、Keyboard |
| 10、Frequency serial number | |

Function Description

- ※ Press icon 1 to enter EQ sound settings interface.
- ※ Press the icon 2 to switch mono, stereo.
- ※ Press the icon 3 to switch the local / remote effect.
- ※ Press the icon 4 to return to the previous page.
- ※ Icon 5 is used to display the frequency of the currently playing station.
- ※ Press the icon 6 to scan the radio station.
- ※ Icon 7 display the current mode.
- ※ Icon 8 display the unit of frequency.
- ※ Icon 9 Broadcast frequency
- ※ Icon 10 frequency serial number
- ※ Press the icon 11 to switch FM / AM
- ※ Press the icon 12 to search all the backwards stations, Search will appear on the below list
- ※ Press the icon 13 to search all the forward stations, and the search will be displayed on the following list.
- ※ Press the icon 14 to change the FM to the current mode.
- ※ Press the icon 15 to change the AM to the current mode.
- ※ Icon 16 my favorite station title.
- ※ Icon 17 my favorite station list.
- ※ Press the icon 18 to fold half of the radio screen.

Music playback format

Support AAC, MP3, WMA, WAV, APE, FLAC and so on audio format

Music interface

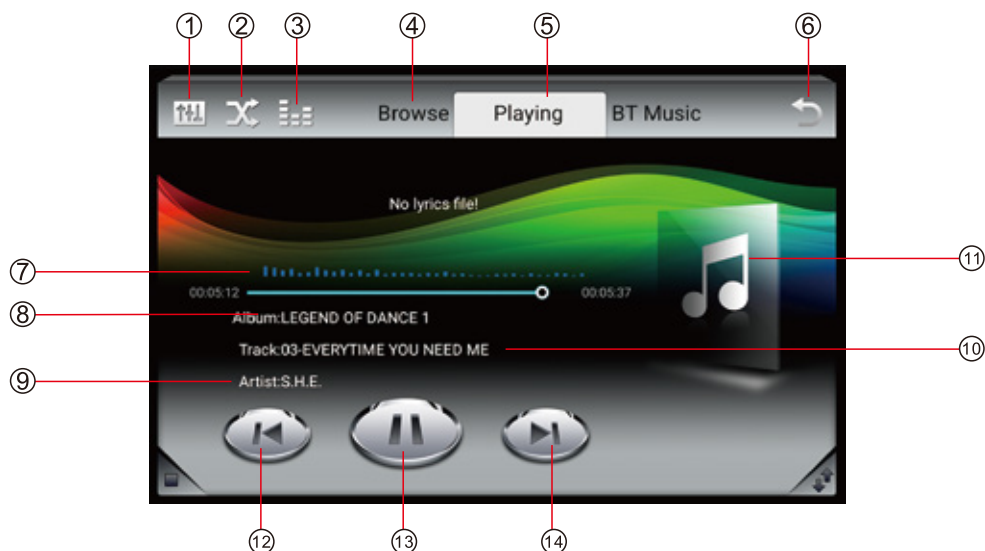

- | | |
|---|--|
| 1、EQ Setting | 8、Currently play album |
| 2、Single cycle, all repeated switching | 9、The current singer |
| 3、Spectrum, lyrics switch | 10、The song name is currently playing |
| 4、Scan the storage device to find the song folder | 11、The song comes with an image display area |
| 5、Show currently playing song | 12、Previous |
| 6、Exit the music interface button | 13、Pause playback |
| 7、Spectrum, lyrics display area | 14、Next |

Function Description

This interface is different depending on the model, this interface is for reference only

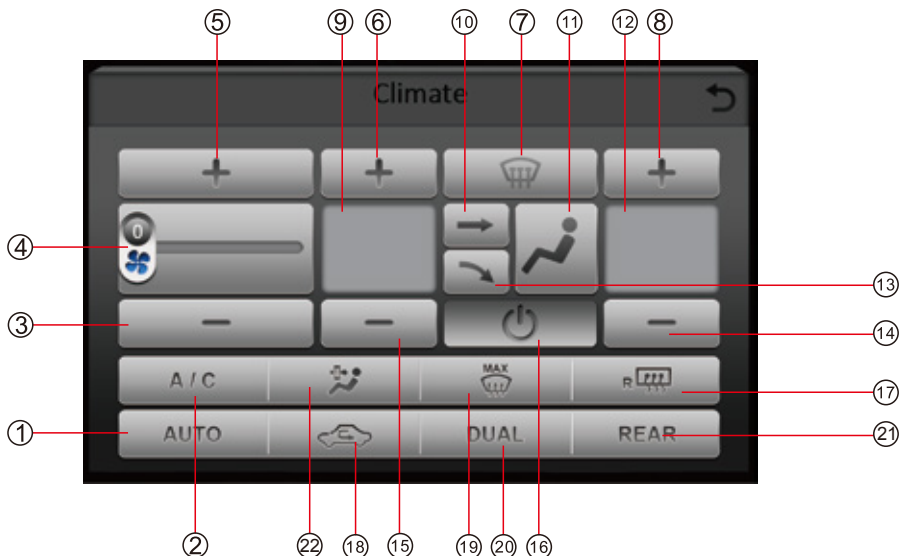

1. AUTO Mode
2. A/C Mode
3. Reduced wind speed
4. Wind speed control button(Draggable)
5. Increase wind speed
6. Plus: to increase the temperature of the air conditioner on the left side
7. Defogging
8. Plus: to increase the temperature of the air conditioner on the right side
9. The left side of the car air conditioning temperature display
10. Wind mode: blow on the body
11. AC mode display
12. The right side of the car air conditioning temperature display
13. Wind mode: Blow on the feet
14. Minus: to decrease the temperature of the air conditioner on the right side
15. Minus: to decrease the temperature of the air conditioner on the left side
16. Turn off AC
17. Rear window defogging
18. Inner loop
19. MAX Mode
20. DUAL Mode
21. REAR
22. Center console air outlet

1: Bluetooth interface is relatively more, if repeated function icon doesn't repeat the description.

Bluetooth dialing

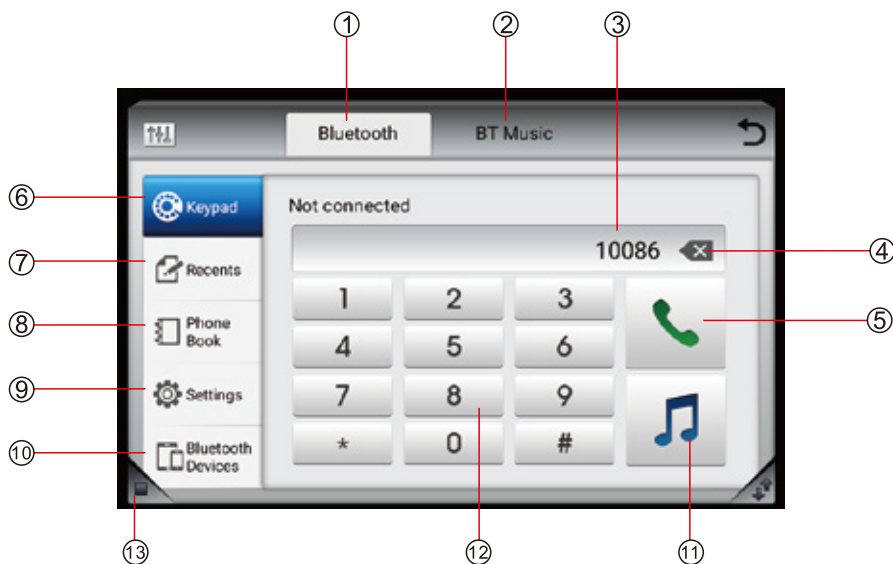

- 1、Bluetooth phone
- 2、Bluetooth music
- 3、Telephone number input display frame
- 4、Delete button
- 5、Dial button
- 6、Dial-up label, The current interface is the dialing interface
- 7、Call records
- 8、Bluetooth phone number book
- 9、The phone Bluetooth device pairing connection
- 10、Bluetooth device search
- 11、Bluetooth music playback
- 12、The digital input button
- 13、Expand the Bluetooth interface

Call Records

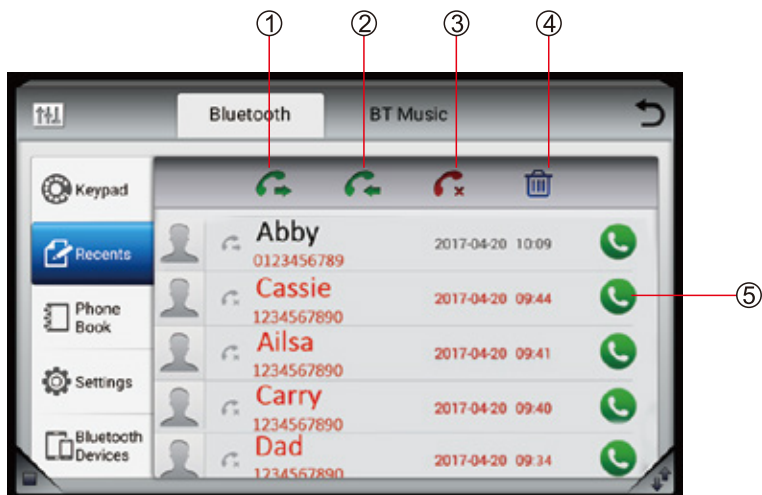

- 1、Dialed calls
- 2、Received calls
- 3、Missed calls
- 4、Delete the call records
- 5、Dial button

Phone book

Pic. 1

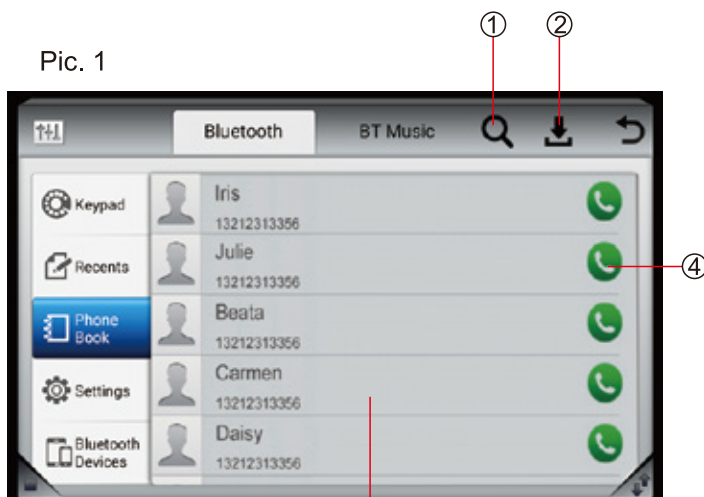

Pic. 2

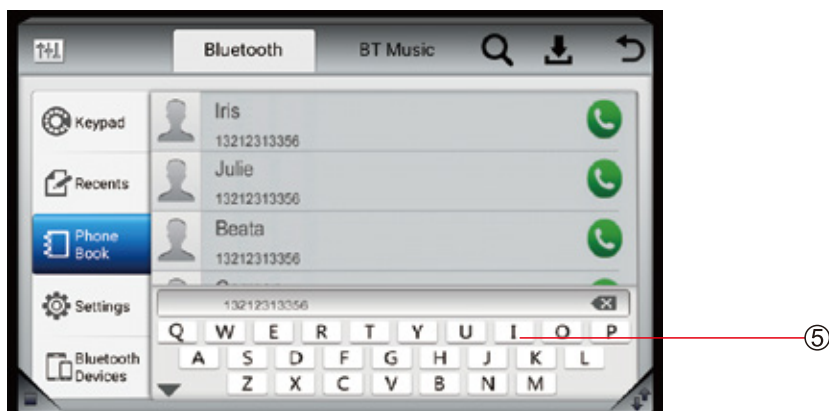

- 1、 Search the phone book number.
(Pic. 2 will be shown when this button is pressed)
- 2、 Download the phone book from the phone
- 3、 Telephone number information display area
- 4、 Fast dial button
- 5、 Keyboard buttons

Bluetooth settings

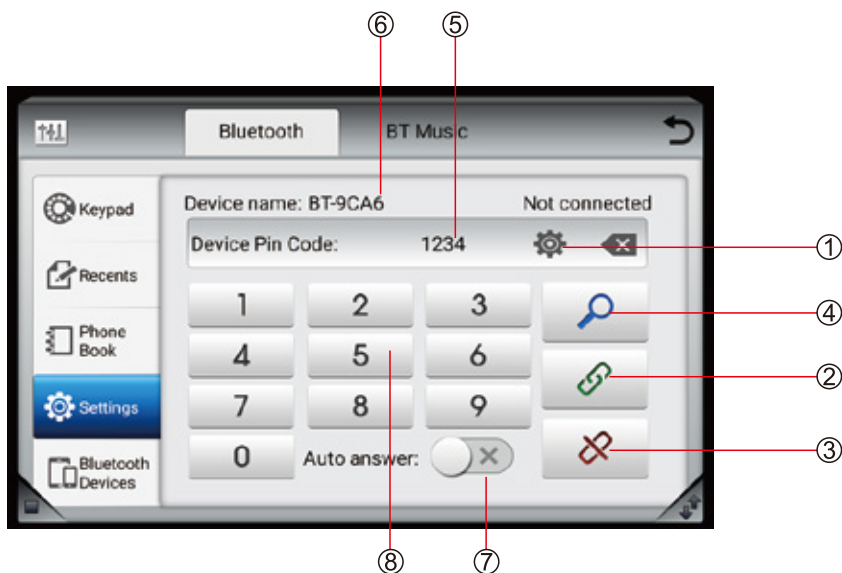

- 1、Bluetooth connection password set button, click to enter the password settings.
- 2、Connect the Bluetooth phone.
- 3、Disconnect the Bluetooth connection.
- 4、Search for mobile phones.
- 5、The password set digital display frame.
- 6、The model Bluetooth name.
- 7、Automatically answer switch button.
- 8、The keyboard area.

Bluetooth

OBD

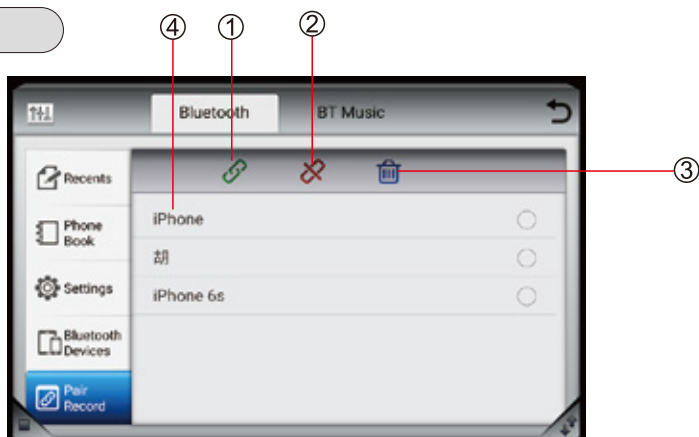

1、Connection 2、Disconnect 3、Delete 4、Connected device

Bluetooth call

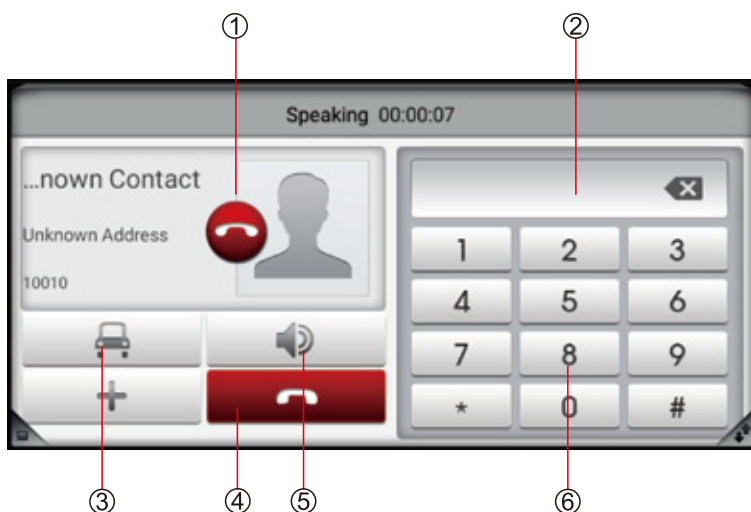

- 1、Caller number information display.
- 2、The digital input display frame.
- 3、Phone, car amplifier and sound toggle button
- 4、Hang up the phone.
- 5、Mute.
- 6、The input keyboard.

Bluetooth music

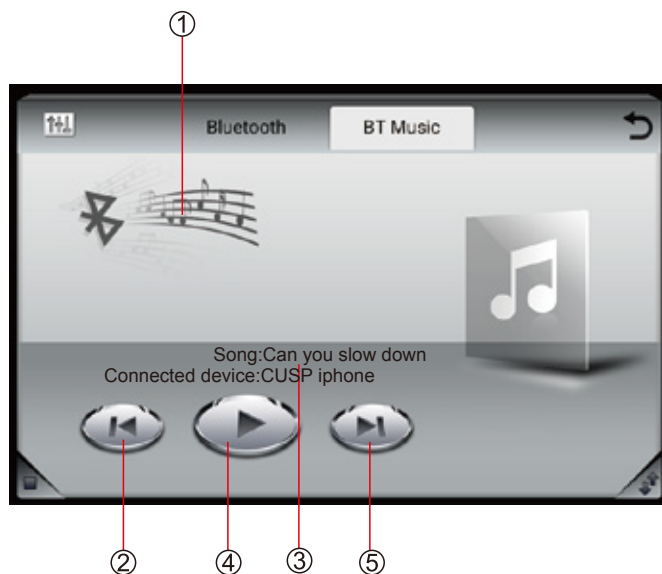

- 1、 The frequency spectrum.
- 2、 Previous.
- 3、 The currently playing song.
- 4、 Play, pause.
- 5、 Next.

Functional description

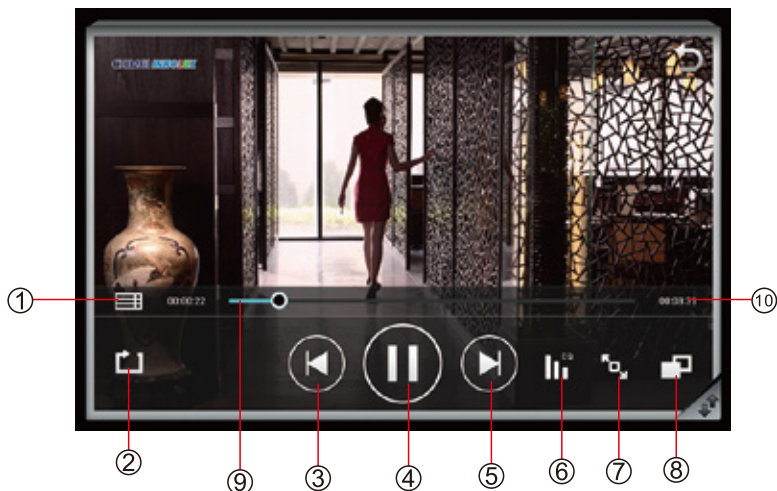

▲ Pic. 1

▼ Pic. 2

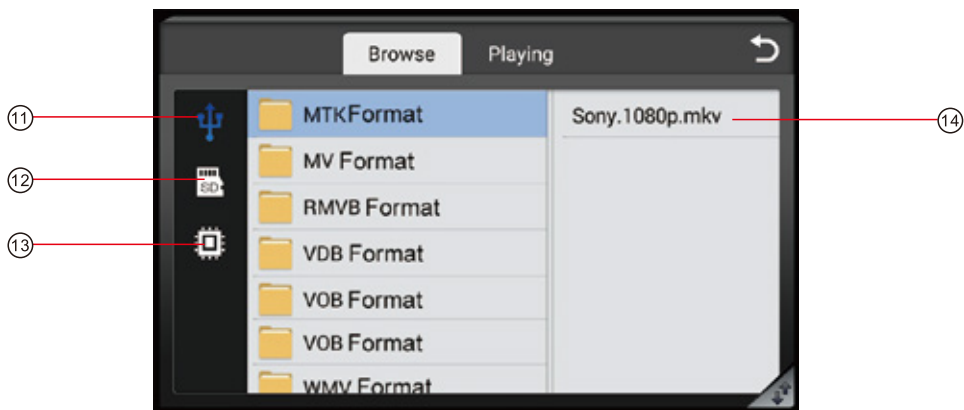

- 1、Into the list (pic.2)
- 2、Fandom, loop, all repeatedly toggle button
- 3、Previous
- 4、pause, play
- 5、Next.
- 6、EQ
- 7、Full-screen playback

- 8、PIP
- 9、The time schedule
- 10、The time required to Play the song
- 11、USB device
- 12、SD card device
- 13、local equipment
- 14、The current equipment selected video

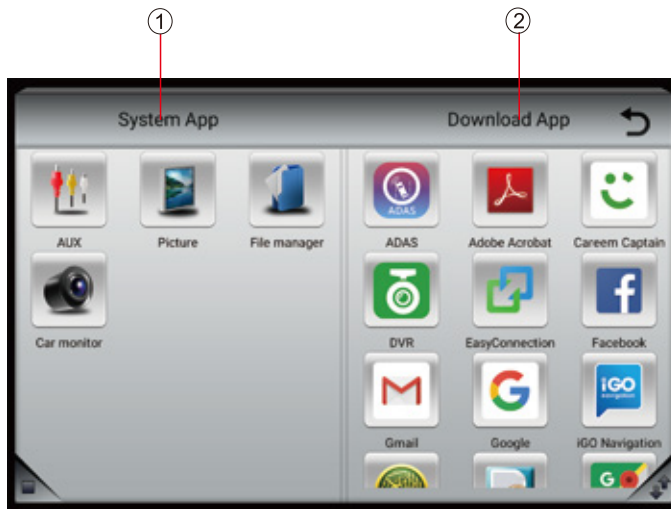

- 1、 Built-in applications, i.e., the system comes with the application.
- 2、 The software developed by the third party company will be displayed in this location after installation.

Exterior surveillance

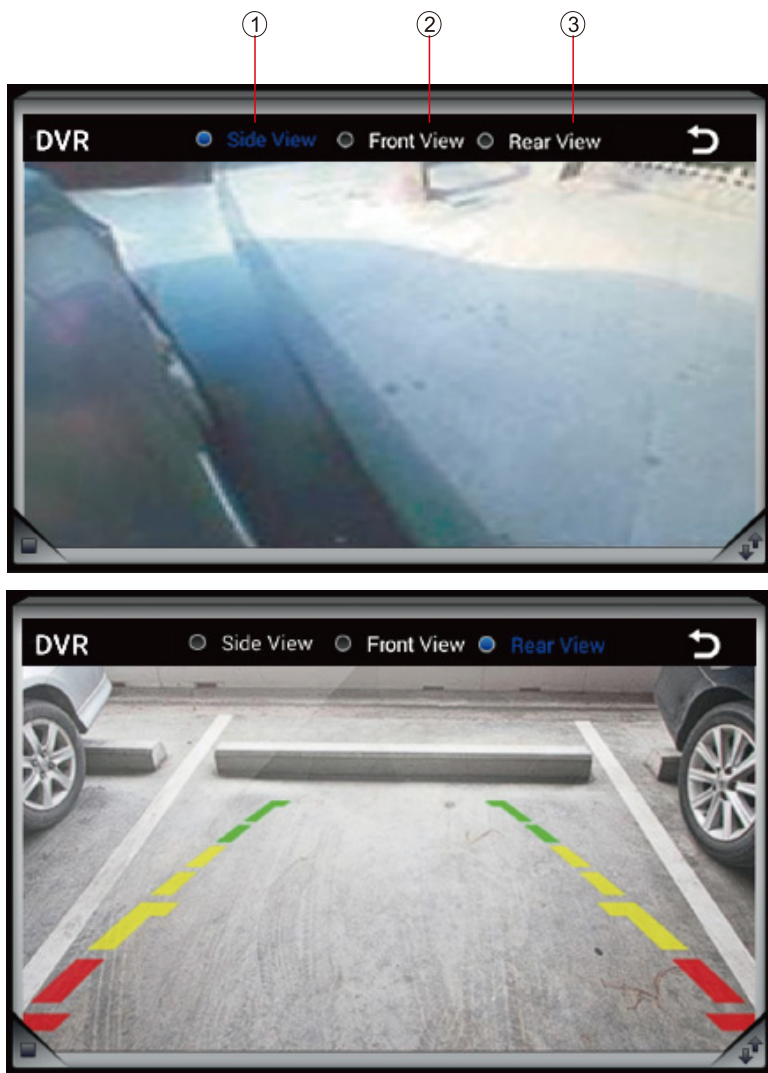

- 1、Right view video (optional)
- 2、Front view video (optional)
- 3、Rear view video

Navigation settings

The following icons are for reference only, depending on the series have to make adjustments without prior list

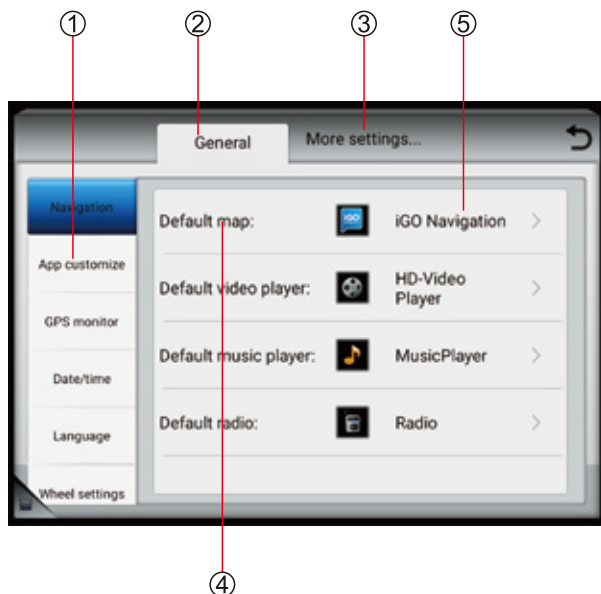

- 1、Function list, a list of which functional details of the function will be displayed at point 6th
- 2、The car model system commonly used function settings.
- 3、Android system comes with more settings.
- 4、Default features
- 5、Click to select default features

GPS Monitor

This tool can monitor your current GPS status, display GPS latitude and longitude, speed, altitude, the program since the operation of the displacement distance, this is your travel essential essentials.

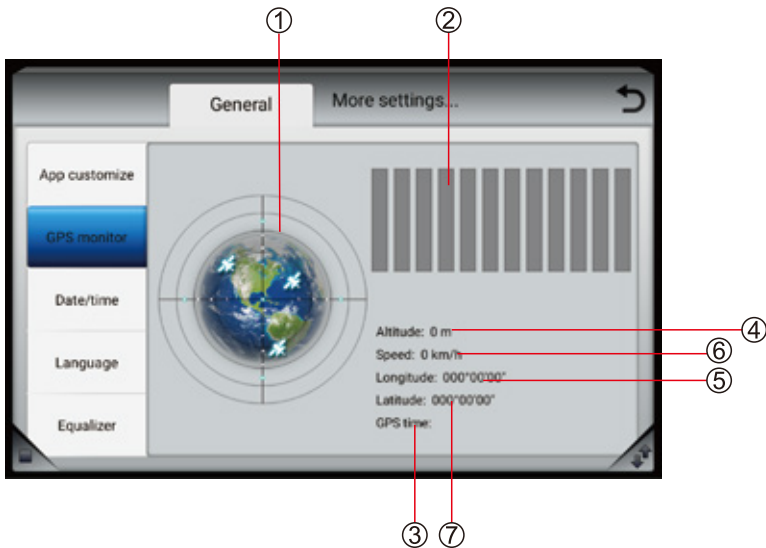

- 1、 Satellites above the earth location.
- 2、 The cylindrical display bar will also show the signal strength with different levels of green depending on the signal level.
- 3、 The current satellite time.
- 4、 The current coordinates of the altitude.
- 5、 The current location of the longitude.
- 6、 The current moving speed.
- 7、 The current location of the latitude.

Time setting

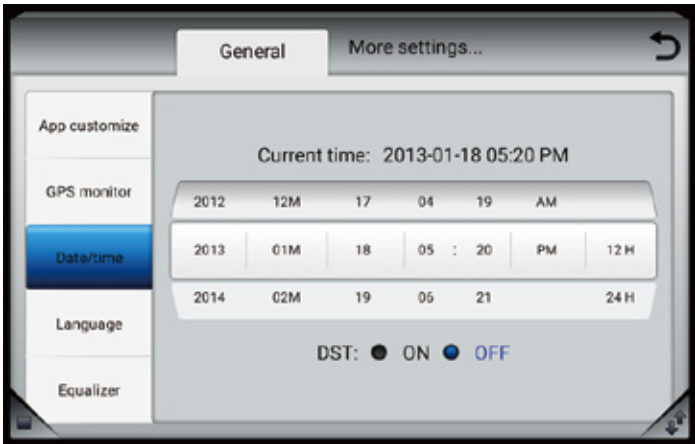

The time set the interface, to use, you can slide up and down the number of bars to adjust the time, that is, as on the following.

Picture:



Setting

Language settings

The system can be set into 14 languages, select the icon of the corresponding country, it will automatically transform to the corresponding language.

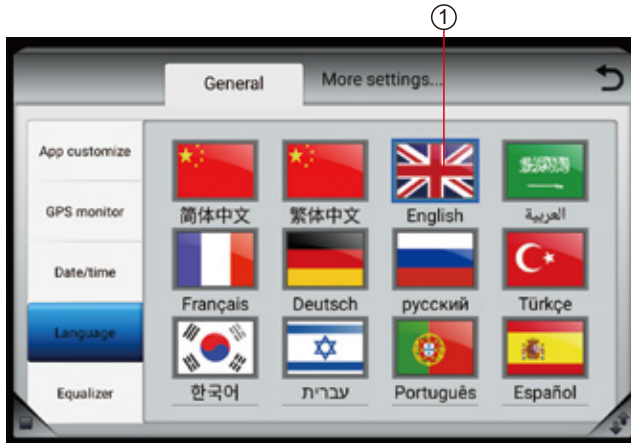

1、the system language set to English.

Backlight settings

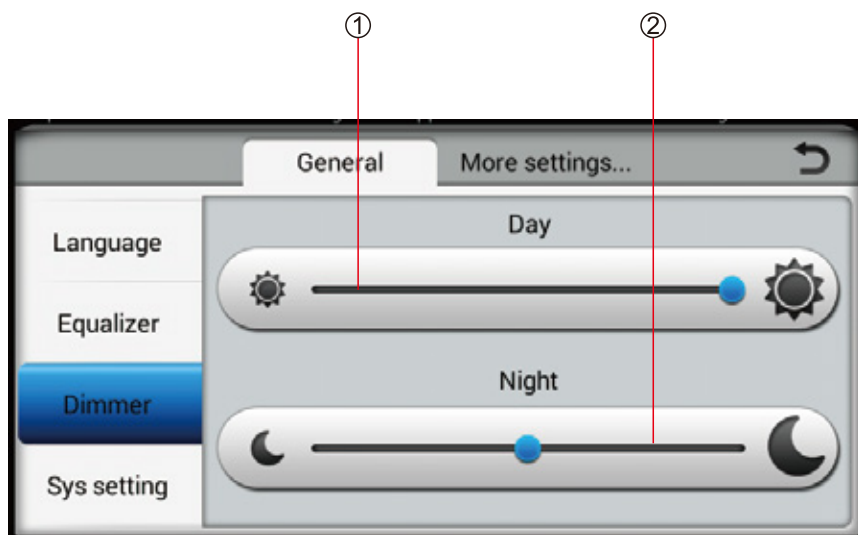

- 1、 Adjust the brightness of the daytime screen.
When the headlamp is not open, the brightness of the model's screen is the brightness of the progress bar, and it is useful to adjust the progress bar at this time. Adjustment 2 will not change the backlight.
- 2、 Adjust the brightness of the screen at night. When the headlamp is turned on, the brightness of the model screen is displayed for this progress bar. At this time to adjustment 1, the brightness of the screen will not change.

System settings

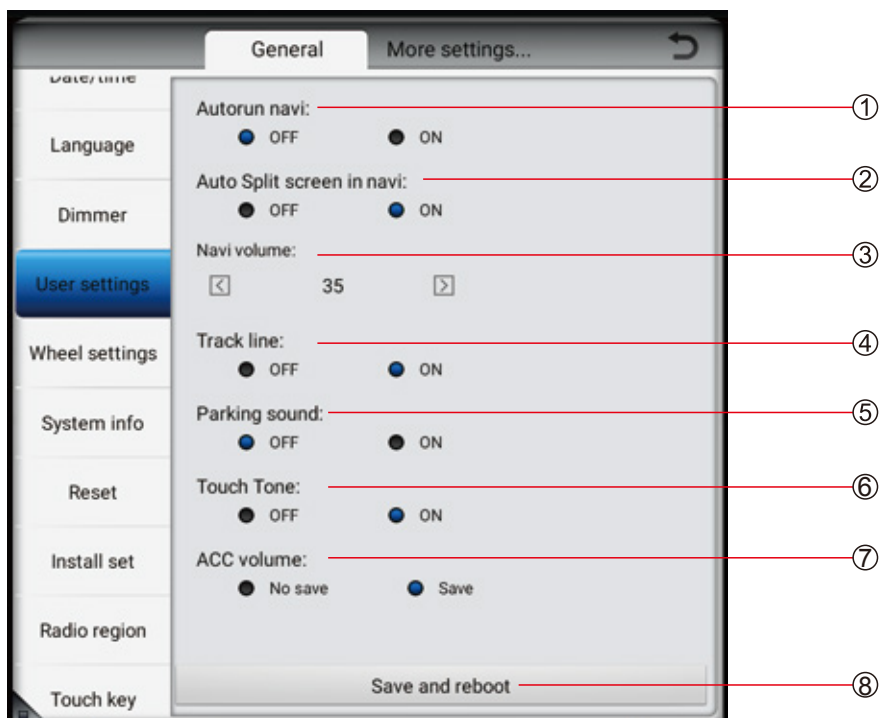

- 1、Power on start navigation.
- 2、Auto Split screen in navigation.
- 3、Adjust volume during navigation.
- 4、Track line during reversing.
- 5、Prompt sound during parking.
- 6、The machine button tone switch.
- 7、When power off keep this time volume.
- 8、After setting up, save and restart.

Setting

Factory settings

Used to restore factory settings

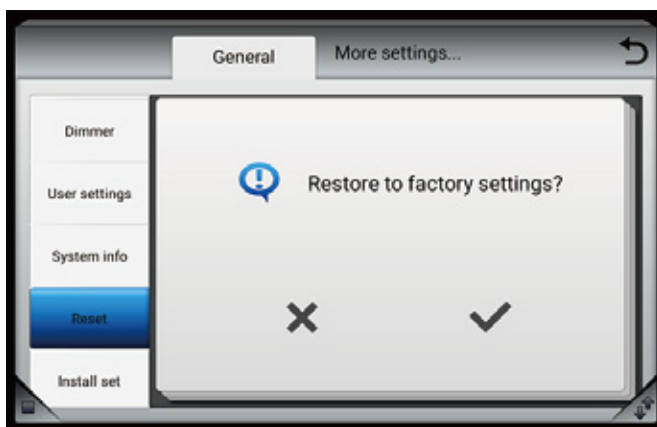

App customize

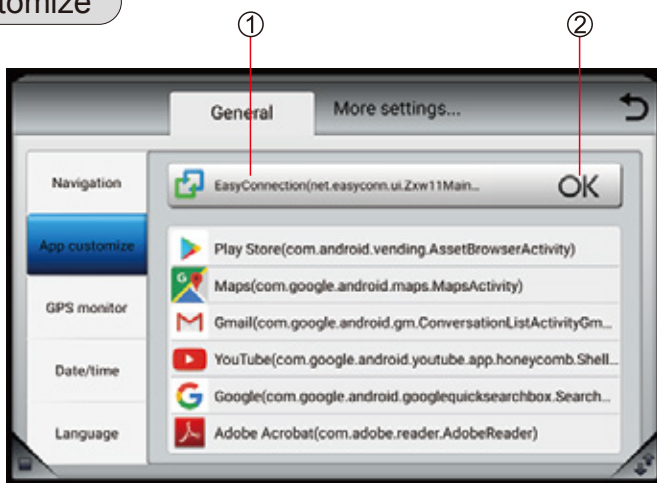

1、Click to choose the default program

2、Click to jump to this program

More settings

This interface is the original car Android system interface.

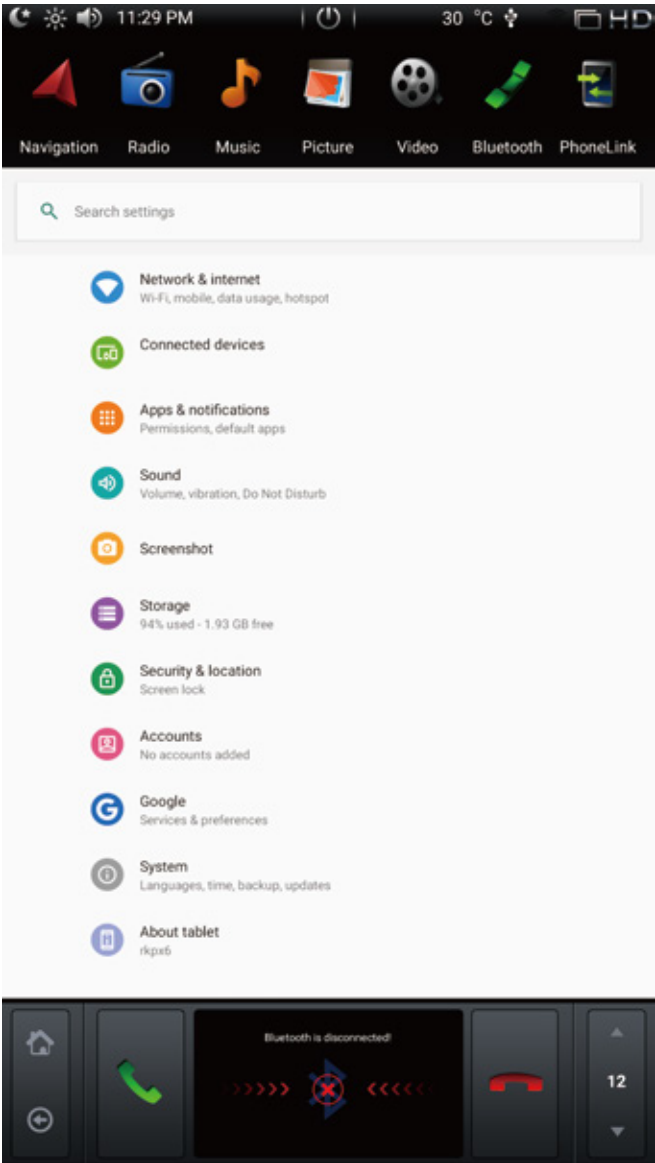

Music setting

When you open the music interface, you can click the DSP icon to enter the DSP interface.



1、Strong bass

4、Sound field

2、16-segment EQ

5、Sound presets

3、Balance

6、filter

Function Description

When your phone is connected to car multimedia via a data cable, you can click the Phonelink icon on the main interface to enter the Phonelink interface.

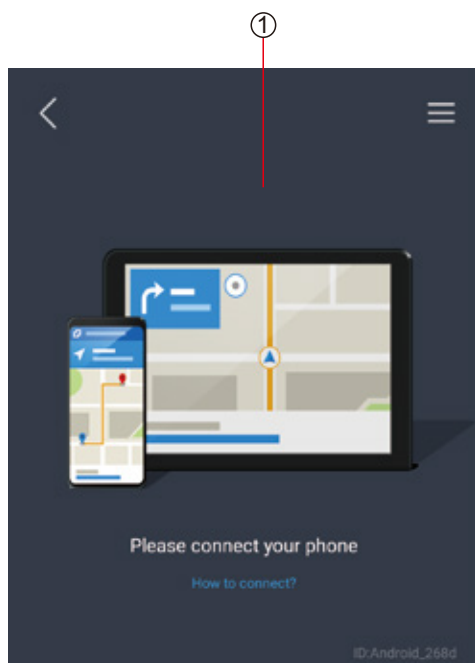

- 1、 If your phone is not connected, you will be prompted how to connect your phone to use Phonelink.
- 2、 If your phone is connected, you will be able to see the real-time Picture of your phone on car multimedia.

Troubleshooting

| Phenomenon | Reason | Countermeasure |
|---------------------------|---|--|
| The machine cannot boot | Check that the cable is connected properly | Re-connect the cable properly |
| | Whether the car key is inserted and opened | Make sure the key is inserted and opened |
| | Check if the power fuse is melting | Replace the same type of fuse |
| | Some factors cause MPU to operate incorrectly | Use the pen to press the faceplate button "RESET" to reset the key |
| | Ignition line ACC and power supply positive BATT connection error | Re-connect the cables correctly |
| The radio signal is poor | whether the length of the antenna is appropriate, or the radio antenna hole is not inserted. | Replace a long antenna and confirm that the antenna is inserted into the radio antenna hole. |
| | Check if the antenna is fully extended or broken, and if it is broken, replace the new antenna. | Confirm that the antenna is fully extended, or for a new antenna; |
| | The local broadcast signal is too weak. | Replace a wide place. |
| GPS can not be positioned | Whether GPS antenna is damaged | Replace the GPS antenna |
| | Whether the map is randomly distributed, the parameters are correct | Make sure the parameters are correct |
| | Car explosion-proof membrane or other shield caused | Remove the car explosion-proof membrane or other shields |
| | The weather is bad | When the weather is good, re-test the GPS |

| Brand | Car | Model | Modification |
|--------|--------------|---|---|
| Toyota | Land Cruiser | 2007-2009Land Cruiser Navigation Edition | Remove the original car screen,the original car CD player,support the original car amplifier.The media of the rear seat of the original car is not supported |
| | | 20010-2011Land Cruiser Navigation Edition | Dismantling the original car screen,the original car CD player,does not supprt the original car amplifier (the power amplifier is used as an extension cable),does not supportr the original car rear seat media,and does not support 360 cameras |
| | | 20012-2015Land Cruiser Navigation Edition | Dismantling the original car screen,the original car CD player,does not supprt the original car amplifier (the power amplifier is used as an extension cable),does not supportr the original car rear seat media,and does not support 360 cameras |
| | | 2007-2015Land Cruiser Low and medium | |

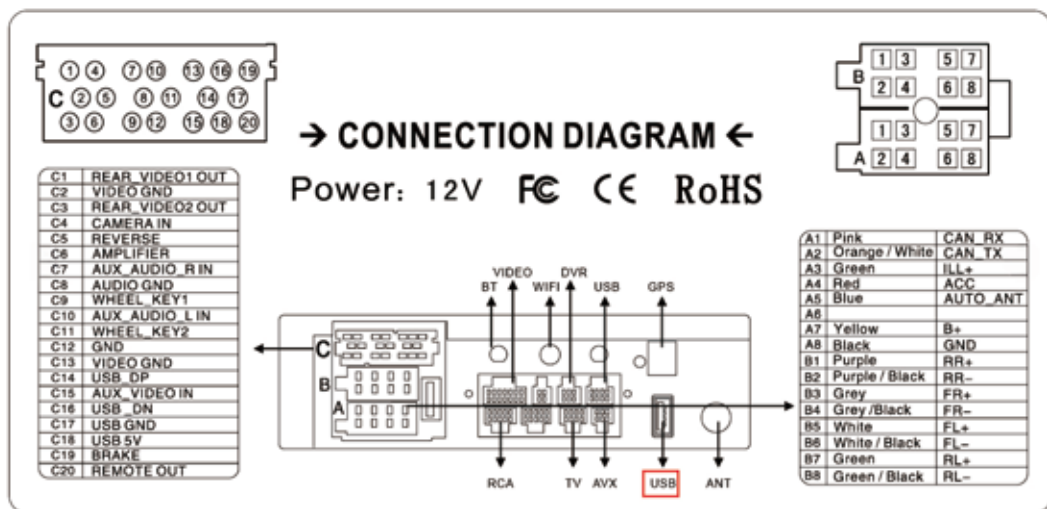

1. Connect iPhone to HU over BlueTooth, then click [Use CarPlay]
2. If iPhone's WLAN is Off, then click [Turn on WLAN & Use CarPlay]
3. Then, enjoy CarPlay!
4. If show [Open Siri] ,Then, Open iPhone-settings --> Siri --> Open Siri

FCC Warning

This device complies with part 15 of the FCC Rules. Operation is subject to the following two conditions: (1) This device may not cause harmful interference, and (2) this device must accept any interference received, including interference that may cause undesired operation.

Any Changes or modifications not expressly approved by the party responsible for compliance could void the user's authority to operate the equipment.

Note: This equipment has been tested and found to comply with the limits for a Class B digital device, pursuant to part 15 of the FCC Rules. These limits are designed to provide reasonable protection against harmful interference in a residential installation. This equipment generates uses and can radiate radio frequency energy and, if not installed and used in accordance with the instructions, may cause harmful interference to radio communications. However, there is no guarantee that interference will not occur in a particular installation. If this equipment does cause harmful interference to radio or television reception, which can be determined by turning the equipment off and on, the user is encouraged to try to correct the interference by one or more of the following measures:

- Reorient or relocate the receiving antenna.
- Increase the separation between the equipment and receiver.
- Connect the equipment into an outlet on a circuit different from that to which the receiver is connected.
- Consult the dealer or an experienced radio/TV technician for help.

This equipment complies with FCC radiation exposure limits set forth for an uncontrolled environment. This equipment should be installed and operated with minimum distance 20cm between the radiator & your body.