

HiFuture

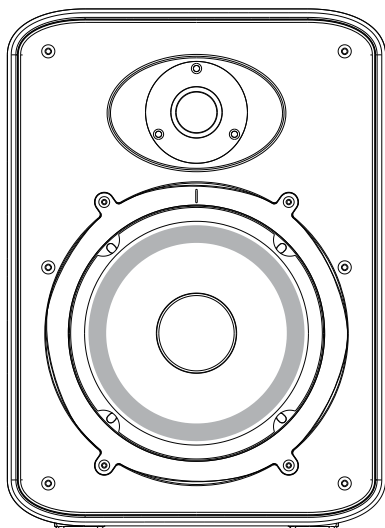

EVENT

Quick Start Guide

Please read this instruction carefully before using the product and keep it properly

Package List

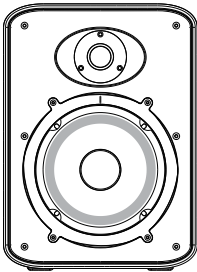

X1



X1

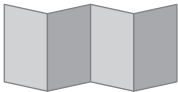

X1

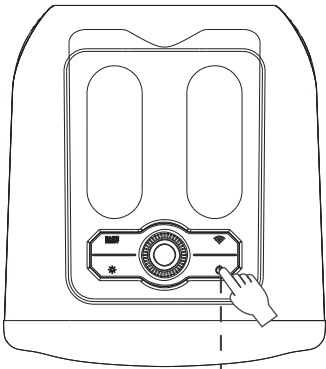

Hold on 2s

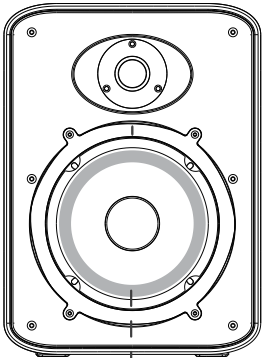

ON



OFF

Auto OFF: - No connection for 10min.
Auto Disconnect: - No music playing for 30min. after BT connected

Diagram

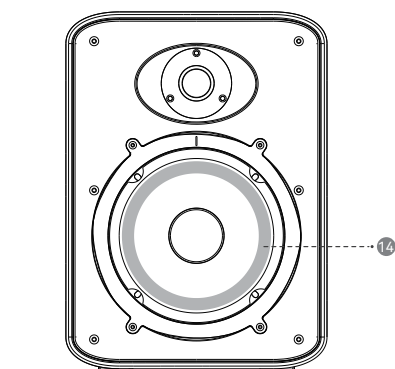
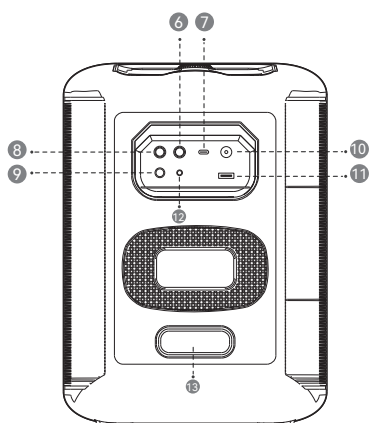
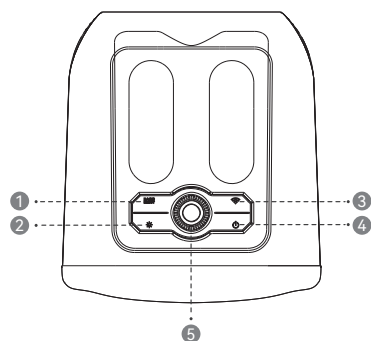

1. Bass Boost , to enable Bass Mode or General EQ
2. RGB Light Power ON/OFF , single press to switch different color style or Power ON/OFF by pressing 2S
3. Wireless Button, long press 7S to remove pairing
4. Power ON/OFF Button, with speaker Power ON, press once to check remain battery capacity
5. Volume+/Volume-/Play/Pause/Previous song/Next song
6. Microphone ECHO Knob
7. Type-C Charging Port
8. Microphone Volume Knob
9. Microphone Input (6.35mm)
10. TWS Connection,make sure neither speaker is connected with any BT device, press the TWS button on either speaker to connect.
11. USB -A Port, to play WAV,MP3,WMA by USB Flash Disk or power bank for external devices (5V@1A)
12. 3.5mm Aux in
13. Label & SN
14. RGB Light

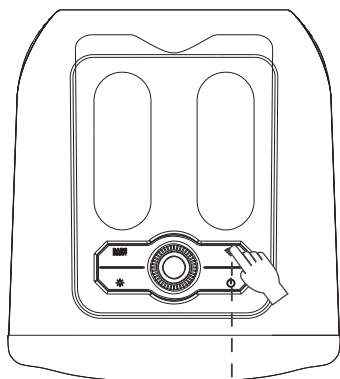

Press Once

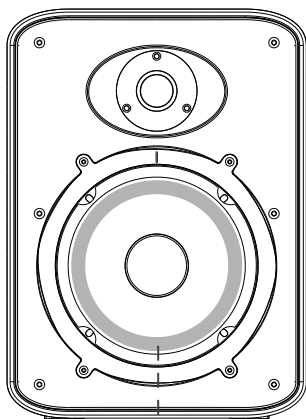

or



Connected:Blue light Disconnected:Flashing blue

*Priority: USB > Aux > BT. When using USB disk or Aux cable to play music, BT connection/BT reconnection is invalid.

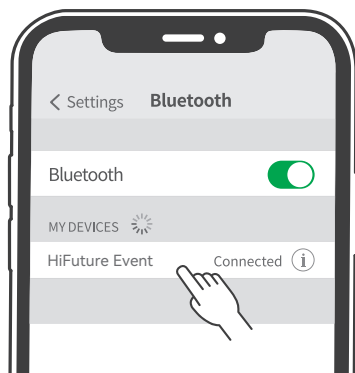



<3.3ft(1m)

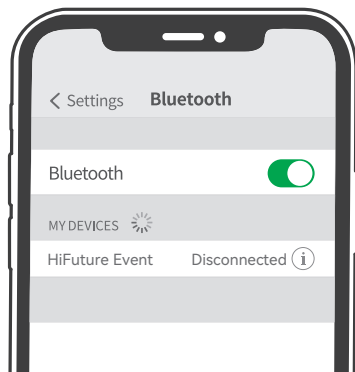

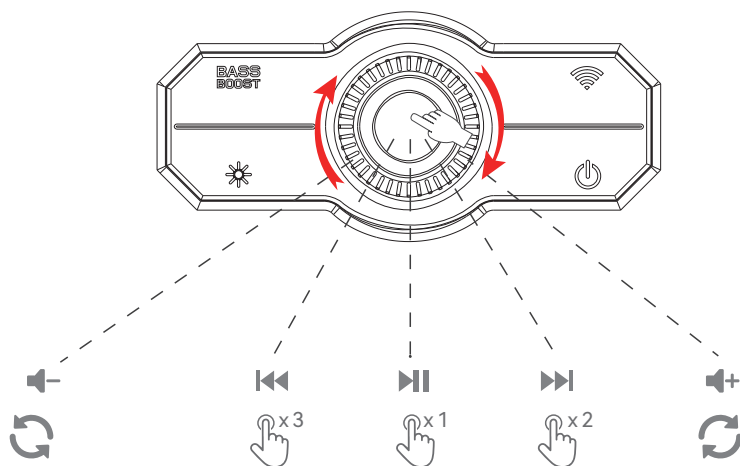

Counterclockwise rotation Press three times Press Once Press twice Clockwise rotation

Dual EQ

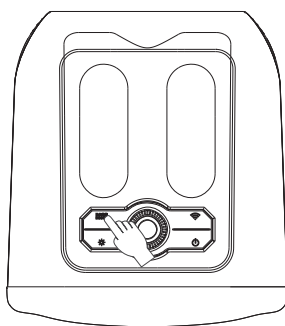

One Click

One click to cycle through EQ1 or EQ2

*EQ1: General EQ, yellow lights

*EQ2: Bass Boost EQ, white lights

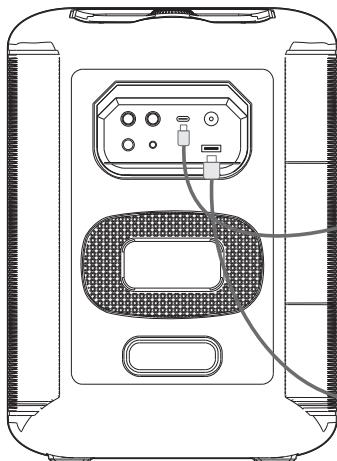
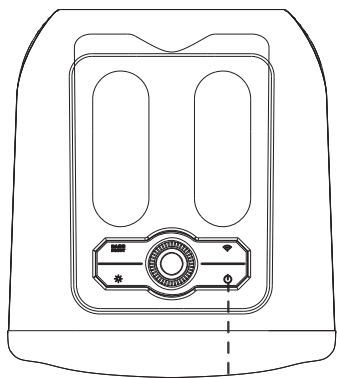

Switch Between 2 Wireless Devices

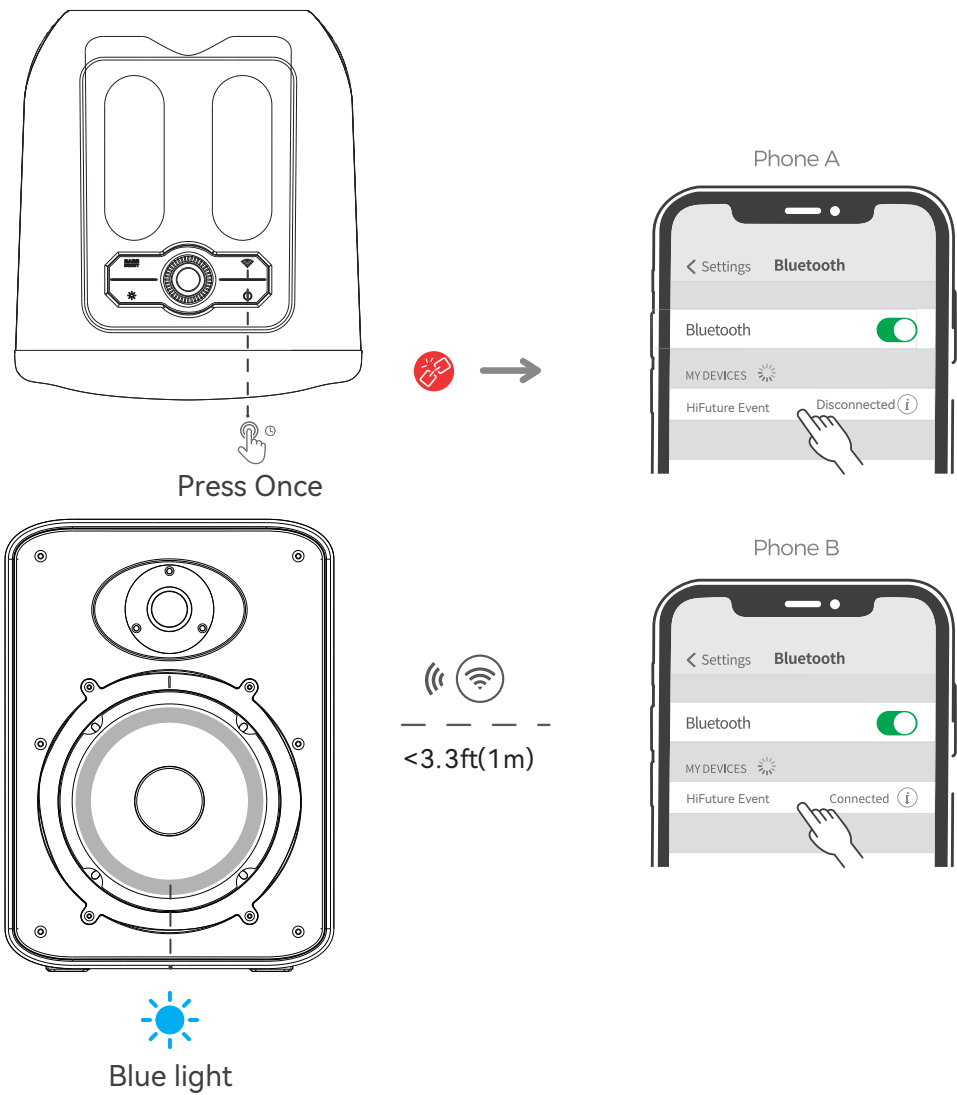

When the speaker is connected, click the wireless button to disconnect the current connection, the speaker will flash blue with a prompt tone. Switch to another BT device to start the new pairing.

TWS Connection (Twin Speakers Mode)

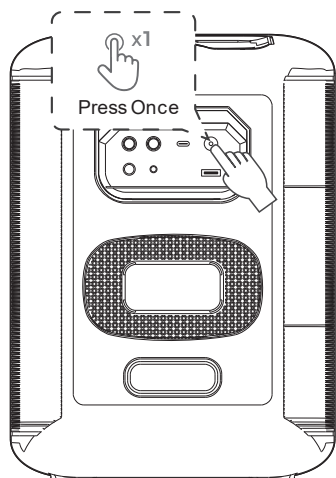

main unit/left channel

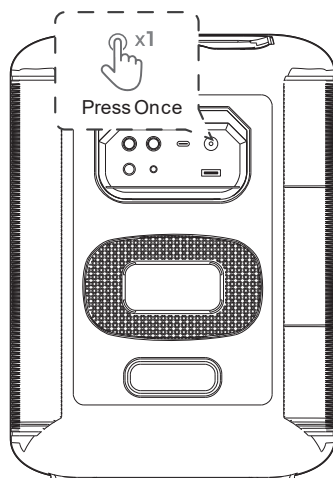

sub unit/right channel

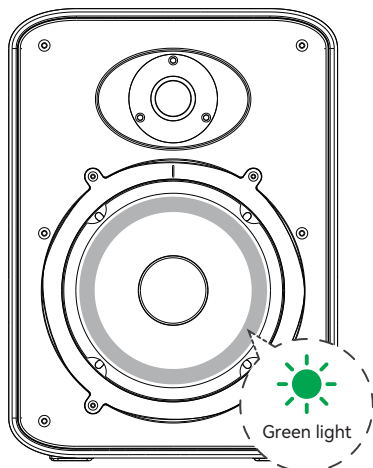

Speaker 1

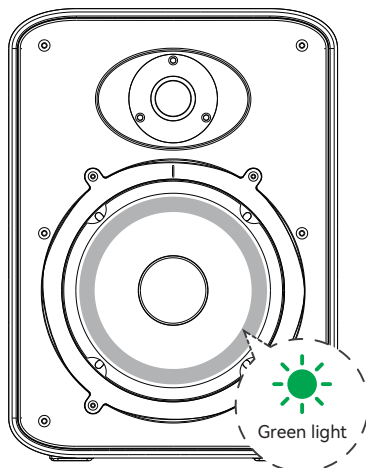

Speaker 2

Make sure neither speaker is connected with any BT device, press the TWS button on either speaker to connect. The speaker you press button with will flash green light with a prompt tone which means the TWS connection is complete. The speaker you press button with is main unit/left channel, the other speaker is sub unit/right channel.



Restore factory settings

Reset the Event: With Event is powered on, long press the () for 7 seconds, there will be a prompt tone, which means the Event has been reset successfully. Power the speaker off and on again to start the new pair.

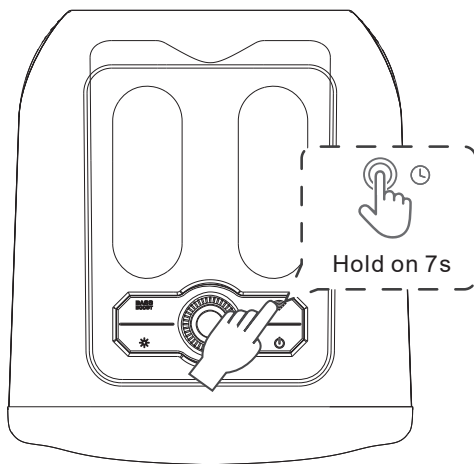

* You might need to Reset the Event if it's not in correct connection with your devices.

*After the reset, remove "HiFuture Event" from your device first and then search the pair name again.

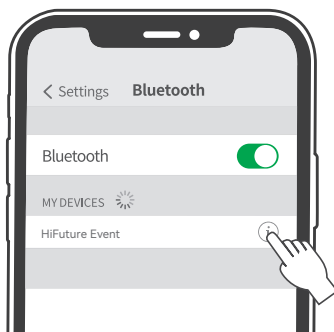

Forget this device

After the rest is successful, make sure the speaker is powered off and on again before starting a new connection.

How to place the EVENT

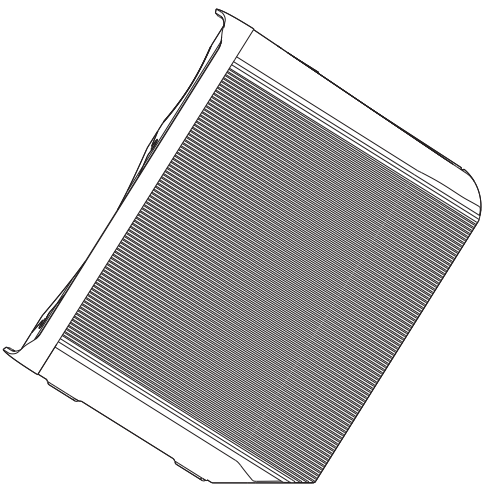
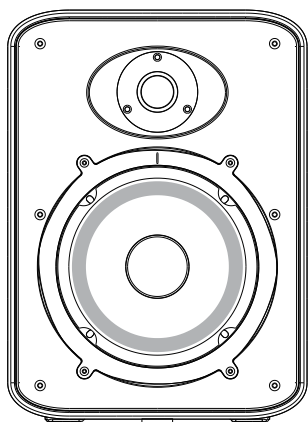

33° stand placing

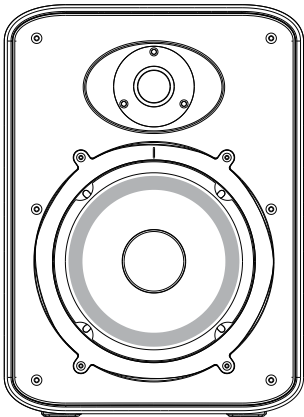
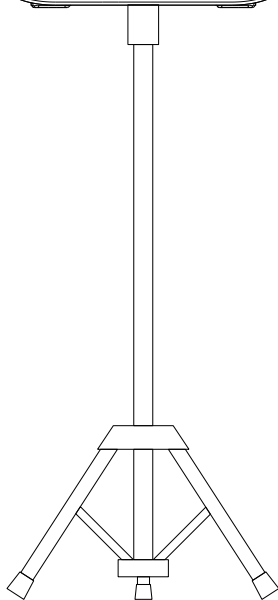

Stand Placing

Optional Speaker stand and adapter

Technical Specifications

Type:	Portable Wireless Speaker	BT Chipset:	BP1048B2
Amplifier & DSP:	ACM8625P	Audio Decode:	SBC/CVSD
Preset EQ:	Dual EQ (General or Bass Boost)	Driver Type:	Dynamic Woofer +Tweeter
Wireless Version:	Wireless 5.3	Speaker diameter:	6.5inch + 1inch
Support profile:	A2DP1.3/AVRCP1.6/HFP1.7	Speaker impedance:	Woofer:4ohms(±15%) Tweeter:6ohms(±15%)
Speaker Frequency Response:	40Hz-20KHz(±6dB)	Speaker rated power:	1*50W +1*30W
Battery type:	Li-ion polymer battery 4000mAh	Rated power:	80W
Battery lifetime:	Remain 80% capacity after 300 cycles	SPL:	86dB/1m/1W
Music playback time:	6Hours*	SNR:	>=81dB
Charge Voltage & Current:	DC5V@2A	THD+N:	<=1% (50W/1kHz)
Wireless Range:	10m(Free space)	Standby time:	300Days
Dimension(HWD):	337*245*280mm	Charging time:	3hours
Water resistance:	N/A	Charge port:	Type C
Manufacturer Warranty:	1 Year Limited Warranty	Net Weight:	5.8kg

*Play time testing base on HiFuture testing standard at 1/4 rated power with -13dB pink noise.

FCC regulatory conformance

This device complies with Part 15 of the FCC Rules. Operation is subject to the following two conditions:

- (1) This device may not cause harmful interference.
- (2) This device must accept any interference received, including interference that may cause undesired operation.

NOTE: This equipment has been tested and found to comply with the limits for a Class B digital device, pursuant to part 15 of the FCC Rules. These limits are designed to provide reasonable protection against harmful interference in a residential installation.

This equipment generates uses and can radiate radio frequency energy and, if not installed and used in accordance with the instructions, may cause harmful interference to radio communications. However, there is no guarantee that interference will not occur in a particular installation. If this equipment does cause harmful interference to radio or television reception, which can be determined by turning the equipment off and on, the user is encouraged to try to correct the interference by one or more of the following measures:

- Reorient or relocate the receiving antenna.
- Increase the separation between the equipment and receiver.
- Connect the equipment into an outlet on a circuit different from that to which the receiver is connected.
- Consult the dealer or an experienced radio/TV technician for help

NOTE: The manufacturer is not responsible for any radio or TV interference caused by unauthorized modifications to this equipment. Such modifications could void the user's authority to operate the equipment.

RF Exposure

This equipment complies with FCC radiation exposure limits set forth for an uncontrolled environment. This equipment should be installed and operated with minimum distance of 20 cm between the radiator and your body. This transmitter must not be co-located or operating in conjunction with any other antenna or transmitter.

Event



<http://www.hifuturegroup.com/>

MAKES LIFE
MORE VALUABLE

Made by ShenZhen Future Access Technology Co., Limited



www.hifuturegroup.com | Made in China