

材质: 157g 铜版纸  
尺寸: 140X140MM  
装订方式: 扇形折  
颜色: 四色印刷

User Manual  
Wi-Fi Pet Feeder  
F01W

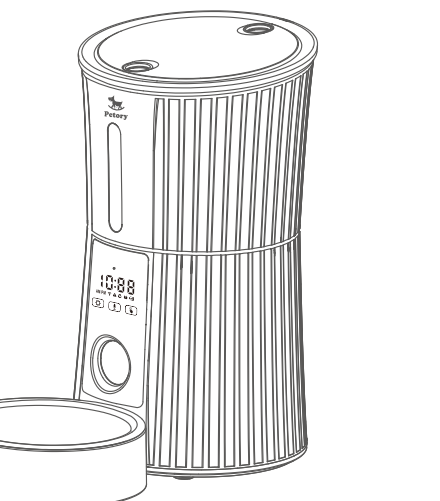

Please read this manual careful before using.  
0.3.0.02 PF1W00-PF-01

IMPORTANT SAFETY INFORMATION

Thank you for choosing Petory F01W Pet Feeder. Petory brand dedicated to using technology to create a better life for you and your pets.

WARNING

- Dispose of all packaging materials properly. Some items may be packed in plastic bags; these bags could cause suffocation; keep away from children and pets.
- Do NOT allow small children to play with, in or around the pet feeder.
- To reduce the risk of injury, please keep close supervision when an appliance is used near children.
- Do NOT use the feeder with pets not able to reach the food tray or with any physical disability.
- Do NOT immerse the base part in water at any time as it may damage electronic components like the control panel.
- Do NOT place any foreign object in the pet feeder.
- Do NOT use outdoors. Check operation frequently to be sure the unit is dispensing properly.
- Do NOT use wet, canned or moist food.
- Do NOT disassemble the unit other than as instructed in this User Guide.
- Do NOT use the feeder for anything other than its intended use.
- Only use attachments recommended or sold by the manufacturer. The use of attachments not recommended or sold by the manufacturer may cause an unsafe condition. Do not modify the pet feeder.
- Do not operate any appliance if the unit is malfunctioning or has been damaged. Do not attempt repairs on the pet feeder yourself. Contact our customer service immediately for further instructions.
- Examine the feeder after installation. Do not plug in if there is water on the power cord or plug.
- To avoid tripping, always position power cord out of the way of foot traffic.

CAUTION

- Do NOT allow pets to chew on or swallow any parts. If you are concerned about the power cord, purchase a cord conduit (a hard-plastic protector) at any hardware store to protect the power cord.
- If an extension cord is necessary, one unit with a proper rating should be used.
- Do NOT install or store the pet feeder where it will be exposed to weather or temperatures below 4°C/40°F.
- Use alkaline D batteries to power. Do NOT use rechargeable batteries.
- Check the batteries regularly. Before Leaving for extended time, always replace batteries with new ones.
- Do NOT lift the pet feeder by lid, food tank, or food tray. Lift and carry it using both hands and the base, while keeping the unit in an upright position.
- Suitable for dry food ONLY, with kibble size ranging from 5-18mm/0.2-0.7in in diameter. Larger kibble may get stuck at the food outlet.
- Do not put your fingers into the food outlet or let your fingers touch the motor.
- Read and observe all important notices listed on the pet feeder and in the packaging.

Product Overview

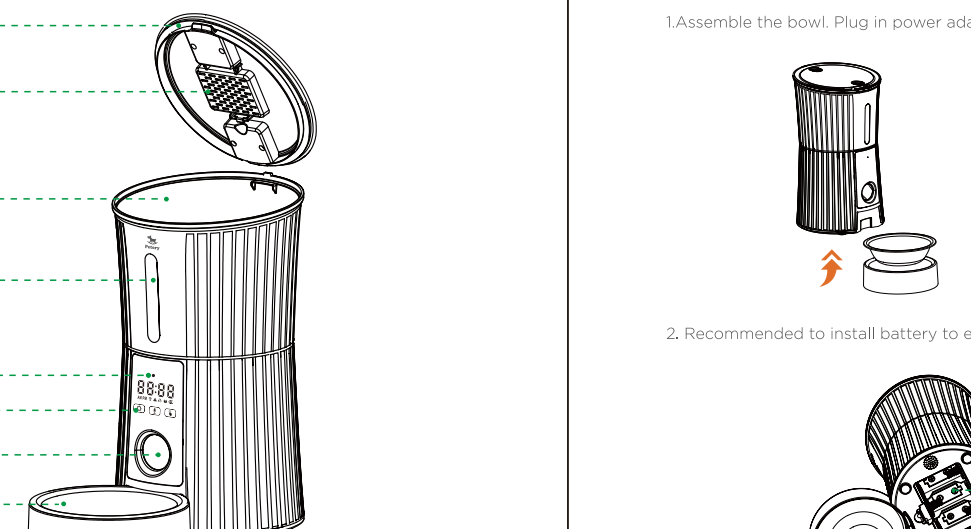

Product Specifications

Product Model	F01W
Input	DC5V
Dimensions	13*7*14 inches; 4.45 Pounds
Dual Power	Type-C/3 cell D batteries
Capacity	16.9 Cups(only dry food)
Programmable	1-50 portions; 10g per portion; 10 meals per day

Prepare for setting

1. Assemble the bowl. Plug in power adaptor, make sure the Power Switch at "I" location.

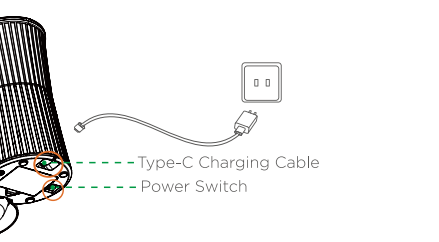

2. Recommended to install battery to ensure that the feeder works properly when the power is off.

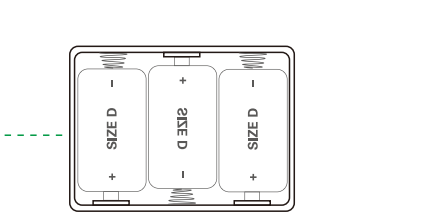

3. Press inward at the same time to open the lid.  
• Recommended kibble size: 5-18mm/0.2-0.7 inch in diameter.

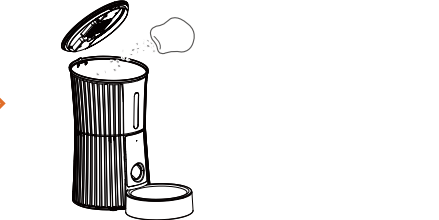

Operation Interface

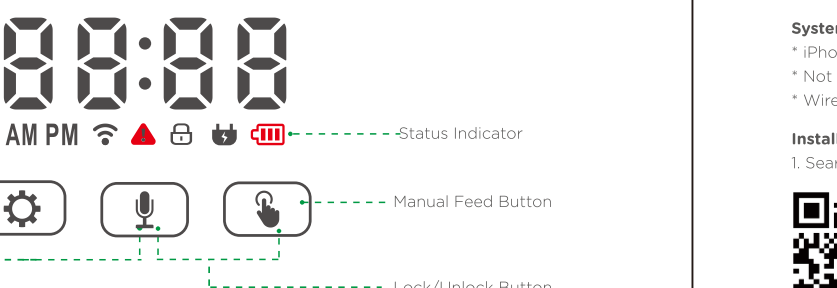

Indicator/Button Quick Guide

Icon	Meaning
10:08	Initial setting time is 10:08, automatically synchronize network time when connected to the network
Wi-Fi icon	<b>White blinking:</b> Waiting to connect to network <b>White solid:</b> Connected to Wi-Fi <b>Red blinking:</b> Offline
Warning icon	<b>Red blinking:</b> Mechanical error
Lock icon	<b>White solid:</b> Button locked
Power icon	<b>White solid:</b> Connected external power
Battery icon	<b>Red blinking:</b> No battery <b>White solid:</b> Batteries installed <b>Red solid:</b> Low battery
Wi-Fi icon	Long press to switch Wi-Fi indicator status
Record icon	Long press to record or cancel audio
Lock/Unlock icon	Press and hold 2s at the same time to unlock/lock the feeder

Note: The screen will be locked automatically without operation for 90s.

Connect to APP

System Requirements:  
• iPhone with iOS 11.0.0 or later or compatible Android smartphone 5.0.0 or later  
• Not suitable for iPad  
• Wireless router 2.4GHz

Install the APP and Log in  
1. Search for "Petory" in your phone's app store or scan the QR code to download the app.



2. Sign up and log in your account

Add the Device  
A: Add the feeder via Bluetooth mode

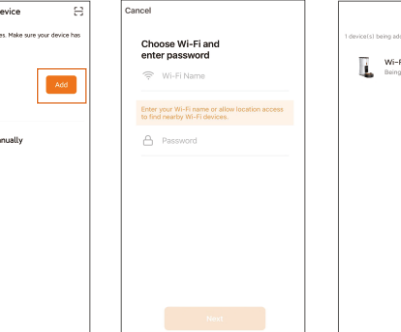

Open Bluetooth and click "Add Device"

Choose "Add Manually"

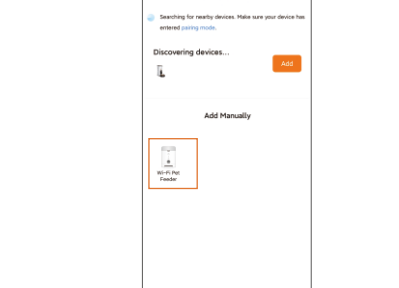

Choose "AP Mode" confirm the Wi-Fi indicator is flashing slowly

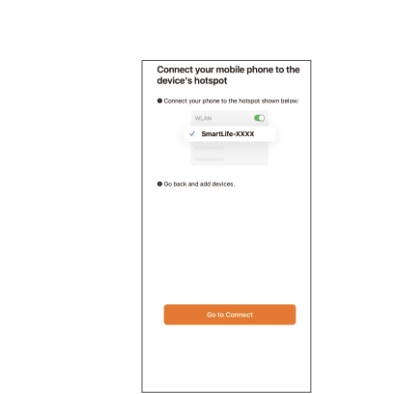

Go to the Wi-Fi connection interface on your phone, find the device "SmartLife-xxxx" and tap to connect

Back to APP and waiting for connecting

Manual Feeding

Choose "Feed Portion" -> "Manual Feed"  
(For reference: 1 portion about 1/10 cup)

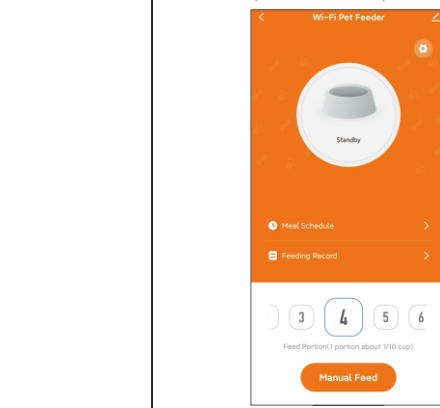

Setting Page Guide

Device Button Disabled:  
Turn on this, all feeder buttons are disabled, the screen displays "LLLLL" when button is pressed.

Slow Feeding Interval(minutes)  
Set interval time between each portion

Display Light  
Turn on/off the indicators on the display

(If the power supplied by the adaptor only, the display will always be lit. If it's supported by 3\*D batteries only without operation for 2 min, the screen will turn off automatically. Press any button can awake it.)

Battery Status  
Show battery level, low battery, and no battery

Reboot the feeder  
Reboot feeder, the feeding setting that have been set will not be changed.

Reboot the feeder

Reboot the feeder

Reboot the feeder

Reboot the feeder

Reboot the feeder

Reboot the feeder

Reboot the feeder

Reboot the feeder

Reboot the feeder

Reboot the feeder

Reboot the feeder

Reboot the feeder

Reboot the feeder

Reboot the feeder

Reboot the feeder

Reboot the feeder

Reboot the feeder

Reboot the feeder

Reboot the feeder

Reboot the feeder

Reboot the feeder

Reboot the feeder

Reboot the feeder

Reboot the feeder

Reboot the feeder

Reboot the feeder

Reboot the feeder

Reboot the feeder

Reboot the feeder

Reboot the feeder

Reboot the feeder

Reboot the feeder

Reboot the feeder

Reboot the feeder

Reboot the feeder

Reboot the feeder

Reboot the feeder

Reboot the feeder

Reboot the feeder

Reboot the feeder

Reboot the feeder

Reboot the feeder

Reboot the feeder

Reboot the feeder

Reboot the feeder

Reboot the feeder

Reboot the feeder

Reboot the feeder

Reboot the feeder

Reboot the feeder

Reboot the feeder

Reboot the feeder

Reboot the feeder

Reboot the feeder

Reboot the feeder

Reboot the feeder

Reboot the feeder

Reboot the feeder

Reboot the feeder

Reboot the feeder

Reboot the feeder

Reboot the feeder

Reboot the feeder

Reboot the feeder

Reboot the feeder

Reboot the feeder

Reboot the feeder

Reboot the feeder

Reboot the feeder

Reboot the feeder

Reboot the feeder

Reboot the feeder

Reboot the feeder

Reboot the feeder

Reboot the feeder

Reboot the feeder

Reboot the feeder

Reboot the feeder

Reboot the feeder

Reboot the feeder

Reboot the feeder

Reboot the feeder

Reboot the feeder

Reboot the feeder

Reboot the feeder

Reboot the feeder

Reboot the feeder

Reboot the feeder

Reboot the feeder

Reboot the feeder

Reboot the feeder

Reboot the feeder

Reboot the feeder

Reboot the feeder

Reboot the feeder

Reboot the feeder

Reboot the feeder

Reboot the feeder

Reboot the feeder

Reboot the feeder

Reboot the feeder

Reboot the feeder

Reboot the feeder

Reboot the feeder

Reboot the feeder

Reboot the feeder

Reboot the feeder

Reboot the feeder

Reboot the feeder

Reboot the feeder

Reboot the feeder

Reboot the feeder

Reboot the feeder

Reboot the feeder

Reboot the feeder

Reboot the feeder

Reboot the feeder

Reboot the feeder

Reboot the feeder

Reboot the feeder

Reboot the feeder

Reboot the feeder

Reboot the feeder

Reboot the feeder

Reboot the feeder

Reboot the feeder

Reboot the feeder

Reboot the feeder

Reboot the feeder

Reboot the feeder

Reboot the feeder

Reboot the feeder

Reboot the feeder

Reboot the feeder

Reboot the feeder

Reboot the feeder

Reboot the feeder

Reboot the feeder

Reboot the feeder

Reboot the feeder

Reboot the feeder

Reboot the feeder

Reboot the feeder

Reboot the feeder

Reboot the feeder

Reboot the feeder

Reboot the feeder

Reboot the feeder

Reboot the feeder

Reboot the feeder

Reboot the feeder

Reboot the feeder

Reboot the feeder

Reboot the feeder

Reboot the feeder

Reboot the feeder

Reboot the feeder

Reboot the feeder

Reboot the feeder

Reboot the feeder

Reboot the feeder

Reboot the feeder

Reboot the feeder

Reboot the feeder

Reboot the feeder

Reboot the feeder

Reboot the feeder

Reboot the feeder

Reboot the feeder

Reboot the feeder

Reboot the feeder

Reboot the feeder

Reboot the feeder

Reboot the feeder

Reboot the feeder

Reboot the feeder

Reboot the feeder

Reboot the feeder

Reboot the feeder

Reboot the feeder

Reboot the feeder

Reboot the feeder

Reboot the feeder

Reboot the feeder

Reboot the feeder

Reboot the feeder

Reboot the feeder

Reboot the feeder

Reboot the feeder

Reboot the feeder

Reboot the feeder

Reboot the feeder

Reboot the feeder

Reboot the feeder

Reboot the feeder

Reboot the feeder

Reboot the feeder

Reboot the feeder

Reboot the feeder

Reboot the feeder

Reboot the feeder

Reboot the feeder

Reboot the feeder

Reboot the feeder

Reboot the feeder

Reboot the feeder

Reboot the feeder

Reboot the feeder

Reboot the feeder

Reboot the feeder

Reboot the feeder

Reboot the feeder

Reboot the feeder

Reboot the feeder

Reboot the feeder

Reboot the feeder

Reboot the feeder

Reboot the feeder

Reboot the feeder

Reboot the feeder

Reboot the feeder

Reboot