

USER MANUALS

HELLFLOWER  
ANAL PLUG

[Thank you for using this product, please read this booklet  
carefully before using it!]

Thank you for using this product, please read this booklet carefully before using it!

# User manuals



Product Name: Hellflower Anal Plug  
Place of Origin: China · Guangdong

# Are you happy with this product?

---

NO 🙄

We apologize for any inconvenience caused. If there is any problem with your order: any part is missing, the item is defective, not what you expected or wanted, please give us a chance to improve your experience by contacting our after-sales service staff on the order platform and we will solve it as soon as possible.

Sincerely thank you for using our products, we will work tirelessly to develop more interesting new products to bring you better experience and service.

We apologize for any inconvenience caused to you, we will continue to improve to provide you with better service and experience, also welcome you to continue to experience our other products.

YES 😊

We are honored by your satisfaction and look forward to hearing more from you.

We look forward to hearing more from you, and welcome you to continue to experience our other products, we will provide you with better service and experience.

# 01/ APP operation instructions

---

1. After scanning the QR code, download the corresponding software;



2. Register and memorize your account;

3. When you enter the homepage of the software for the first time, you will be prompted to use Bluetooth, click “Allow” .

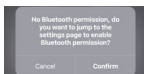

4. In the app, scan the QR code to connect your device or enter the device code 671780 to connect. When the product is correctly displayed in the app, the product will be added and you can start exploring your new toy.

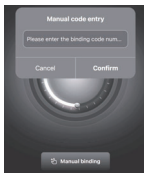

## APP USER'S GUIDE

Scan the code to view the detailed APP guide



## 02 / Operating Instructions

---

### Single control mode electronic function:

1. Long press the "⏻" power button to turn on the machine, the machine vibrates for a while, the indicator light is long lit, into standby mode. Then press the "⏻" key, open and close the telescopic vibration motor into the first frequency mode, a total of 9 frequency cycle in turn;
2. Long press "⏻" power button to turn off the machine, within 1 minute after shutdown, press the power button to reset the opening and closing function.



### Remote control mode electronic function:

1. in standby mode, long press the remote control "⏻" key, the indicator light is on, the remote control mode is on; long press the "⏻" key, the indicator light is off, the remote control is off, the host enters standby mode.
2. short press "⏻" key, motor vibration on, and then short press to switch to the second frequency, a total of 9 frequencies in turn cycle; long press the key vibration off;
3. short press "⏻" button, open and close the telescopic function on, and then short press to switch to the second frequency, a total of 9 frequency cycle, long press the button open and close the telescopic off (indicator light off).

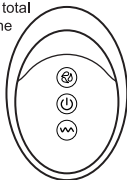

## 03 / Specification

---

Product Name: Hellflower Anal Plug  
Product Size: 152\*115\*48mm  
Product material: ABS + silicone  
Function Mode: 9-frequency opening and closing /  
9-frequency vibration  
Noise level:  $\leq 65\text{dB} \pm 10\%$   
Rated current:  $\leq 1000\text{mA} \pm 10\%$   
Operating voltage: 3.7V  
Battery capacity: 800mAh  
Shelf life: 3 years  
Suitable for people: 18 years old and above

## 04 / Charging instructions

---

1. Please use the supplied magnetic charging cable to connect the charging port of the product for charging. Charging time is about 120 minutes, using time is about 45 minutes.
  2. When charging, the indicator light blinks, full often light, when working condition, the LED light blinks with the frequency of the motor.
  3. Please use a charger that complies with the parameters to charge, charging with a charger that does not comply with the parameters may affect the battery life or cause damage to the product.
- Note: Not to be used while charging.

## 05 / Care and Maintenance

---

Clean the product thoroughly before and after each use. Make sure the product is turned off and in the off position before cleaning. Wash the silicone part of the product with water and soap and towel dry. Do not use cleaning agents containing alcohol, petroleum solvents or acetone.

Please store the product in a cool, ventilated and dry place, and make sure the product is protected from high temperature, heavy pressure and humidity. If the product appears to shut down automatically, it may be caused by insufficient power, start the self-protection mode, please charge it in time.

## 06 / Security matters

---

As a close companion of the majority of users, to be able to safely and healthily use this massager is the user and our common responsibility.

We would like to remind you that this product is only suitable for adults over 18 years of age, please keep it away from children. Please do not

use excessive force during use, please pay attention to avoid injury. Do not mix this product with others. If you feel unwell during use, stop using the product immediately. Regularly check the product for damage and stop using it immediately if damage is found. This product should be treated as waste electrical and electronic products and recycled to the appropriate waste electrical and electronic products recycling station.

## 07 / Disclaimers

---

1. Declare that this manual is only for product use tutorials, all interpretation rights belong to the company.

2. Please use this product carefully, any party of any abuse use of this product our company shall not take any responsibility.



**FCC Warning:**

This equipment has been tested and found to comply with the limits for a Class B digital device, pursuant to part 15 of the FCC Rules. These limits are designed to provide reasonable protection against harmful interference in a residential installation. This equipment generates, uses and can radiate radio frequency energy and, if not installed and used in accordance with the instructions, may cause harmful interference to radio communications. However, there is no guarantee that interference will not occur in a particular installation. If this equipment does cause harmful interference to radio or television reception, which can be determined by turning the equipment off and on, the user is encouraged to try to correct the interference by one or more of the following measures:

- Reorient or relocate the receiving antenna.
- Increase the separation between the equipment and receiver.
- Connect the equipment into an outlet on a circuit different from that to which the receiver is connected.
- Consult the dealer or an experienced radio/TV technician for help.

**Caution:** Any changes or modifications to this device not explicitly approved by manufacturer could void your authority to operate this equipment.

This device complies with part 15 of the FCC Rules. Operation is subject to the following two conditions:

(1) This device may not cause harmful interference, and (2) this device must accept any interference received, including interference that may cause undesired operation.

This equipment complies with FCC radiation exposure limits set forth for an uncontrolled environment. This equipment should be installed and operated with minimum distance 0cm between the radiator and your body.