

2-zone bluetooth water timer

USER MANUAL

DWV010

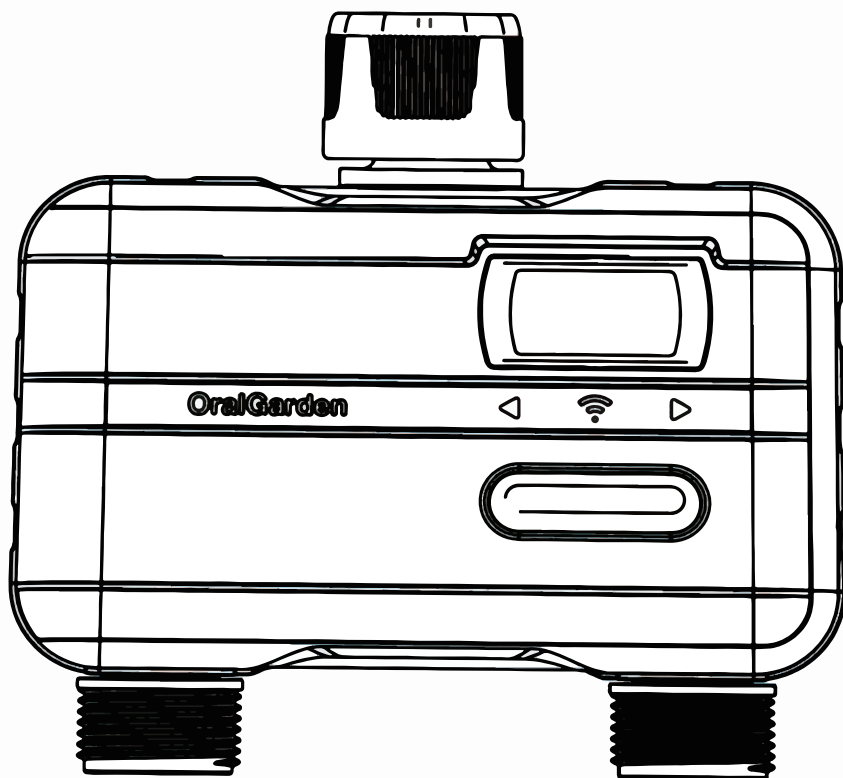

DIRECTORY

Product Overview	1
1.Product Appearance	1
2.Product Specification	1
Main Functions	2
Installations	2
1.Download the Smart Life App	2
2.Power the Bluetooth Water Timer	3
3.Add a Device	3
4.Add the WiFi hub	5
5.Basic information of Home Screen	8
6.Manual Operation	9
7.Weather Delay	10
8.Schedule and settings	10
9.Irrigation Record	13
10.Setting	14
Warranty & Warnings	15

Product Overview

1.Product Appearance

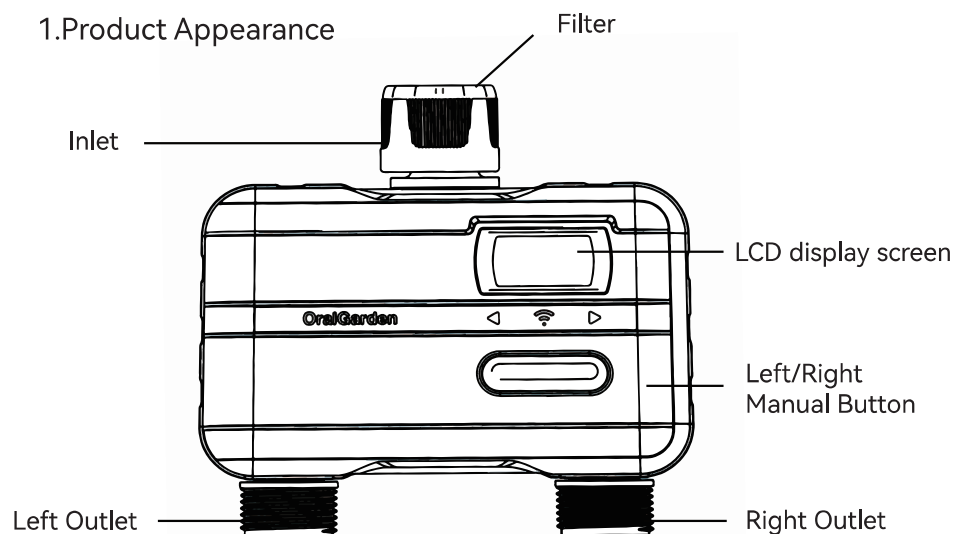

2.Product Specifications

Working Pressure	0.5bar-8bar (7.25 psi-116 psi)
Flow Rate	5L/Min-35L/Min
Working Temperature	2°C-50°C
Waterproof	IP54
Inlet	NH(US) for 3/4"faucet/hose BSP (EU) for 1"or 3/4" faucet/hose
Outlet	For 3/4" standard garden hose
Battery Status	Voltage > 2.8V:100% 2.6V<Voltage<2.8V:50% 2.4V<Voltage<2.6V:10% (low battery) Voltage<2.4V:0%
Bluetooth Type	BLE 4.2
Battery Life	≥12 months
Transmission Distance	≥60m

Main Function

- Set and check last and next irrigation schedule or water volume through smart phone APP, connecting with Bluetooth-WIFI hub.
- Manually ON/OFF the water timer.
- With 2 schedule types: Normal Schedule, and Cycle & Soak mode.
- Max 10 plans in each schedule type.
- Irrigation history track to avoid operation error.
- Water consumption statics by daily, monthly and annua
- The LCD screen make all settings easy to read of each zone
- Weather delay 24/48/72 hours.
- Low power indicator.

Installations

1.Download the Smart Life App

Scan the QR code below or search for “Tuya Smart” and download the free Andriod or IOS app, then install the APP.
Follow the prompts to register account or log in with an existing account.
If you have already installed the Smart Life APP, go to step 2.



2.Power the Bluetooth Water Timer

Remove the back case pull out battery cover of Smart Watering Timer SWV-02 and load 2xAA batteries (not included). Press and hold the button until the green LED flashes rapidly, which means the devices is ready to connect.

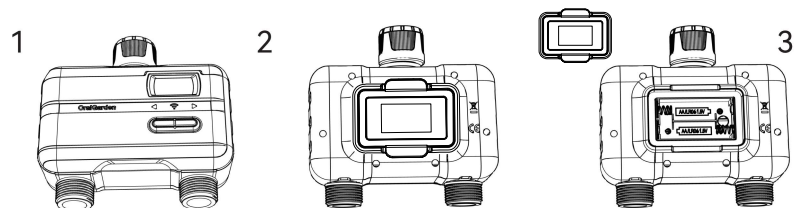

3.Add the Device

Launch APP, tap “” button on the top right corner, or tap “Add Device” directly, the App will search for nearby device, tap “Add” when the devices are discovered. Then follow the instructions on the App page to complete pairing.

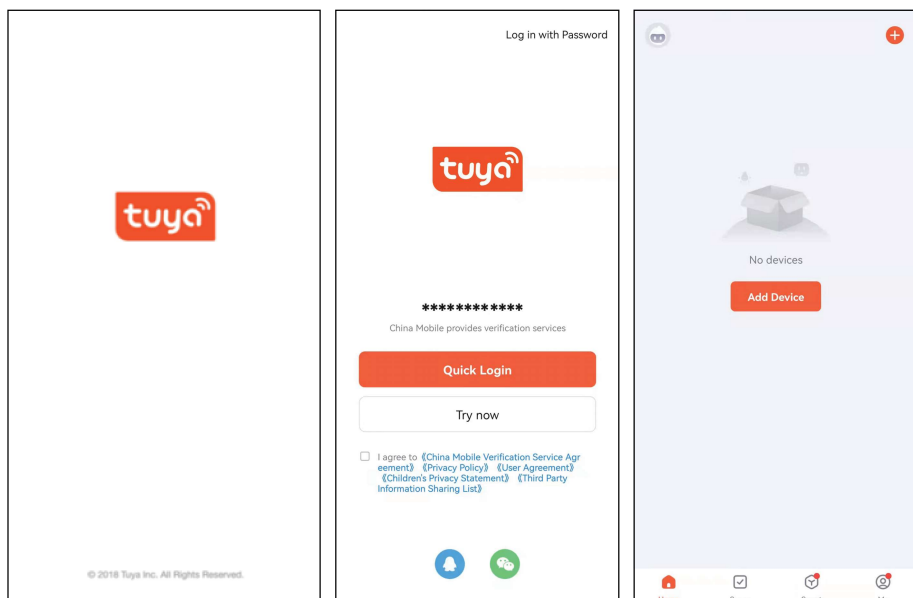

Press the “Add ” button on the right of the found device and tap “Done” button after connection finished.

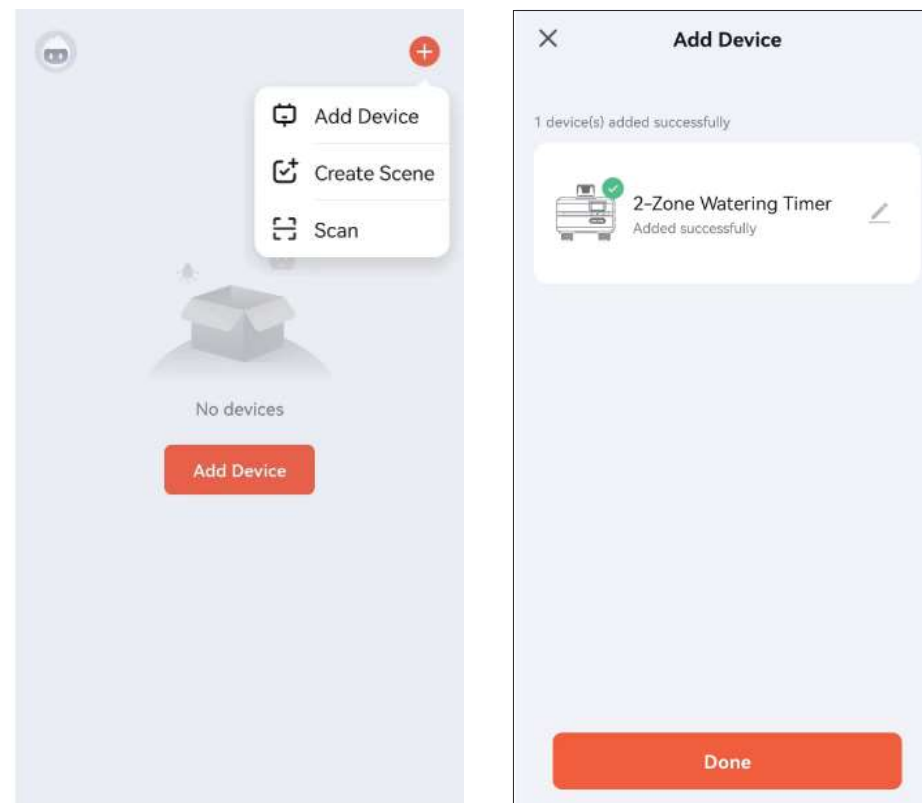

4.ADD THE WIFI HUB

(1). Power Your Wi-Fi Hub

Plug the GWB-03 Wi-Fi hub(with adapter) into an indoor outlet. And wait 10 seconds for the device initialization to complete.LED color in Blue/Purple alternating every 1-second means device is in pairing mode.

TIPS:

1.Choose an indoor location for your hub near the outside location of your timer and within range of Wi-Fi.Avoid areas where the signal must travel through more than one wall, or thick steel barriers.

2.If you need to reconnect, press and hold the button for about 10 seconds until the indicator light goes out, and the Bluetooth-Wi Hub will automatically enter pairing mode when the indicator light returns to blinking.

(2). Pair Your Hub

Step ①. Open Tuya Smart App and tap “Add device ” to add WIFI Hub.

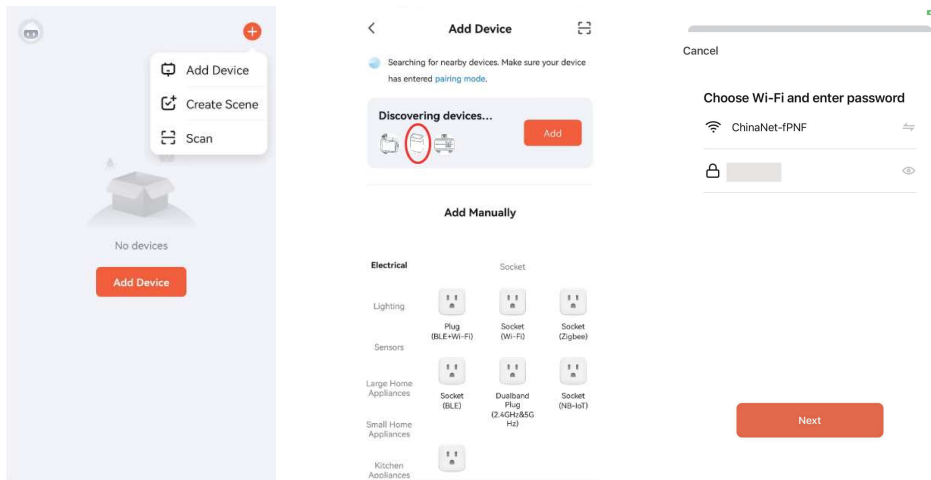

Step ②. Enter your Wi-Fi password and connect to the network. (Only 2.4 Ghz Wi-Fi is supported). You are waiting for bonding to be 100%.

Tap “Done” and the WIFI Hub icon will be on the device list.

Tap “ ” edit the name you favorite.

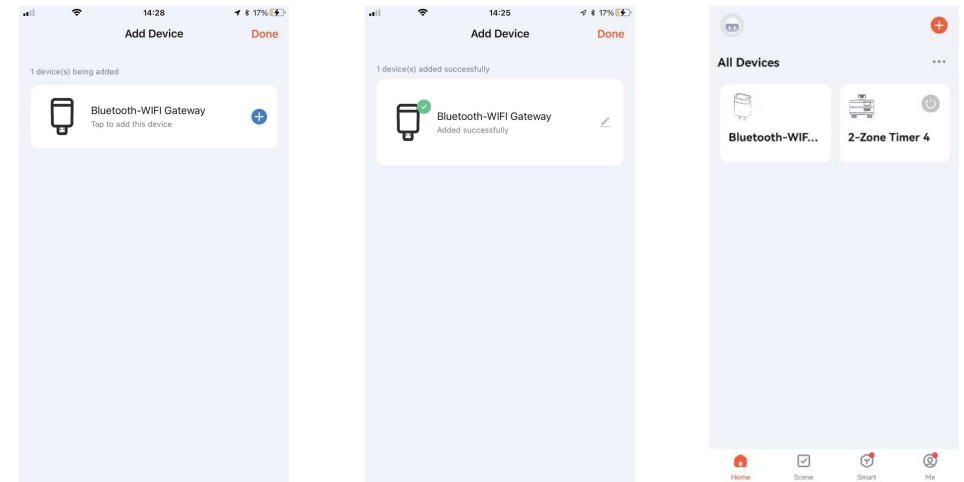

(3). Add the Water timer

Step ①. Once the connection is complete, the paired device will be listed on the home screen. Tap the “ Bluetooth-Wi-Fi gateway ” icon to enter the device details screen.

Step ②. Tap “Add existing ” and select “Smart Watering Timer ,” tap “ ”. Confirm Timer added successfully and listed on the hub screen. Now you could program the watering schedule.

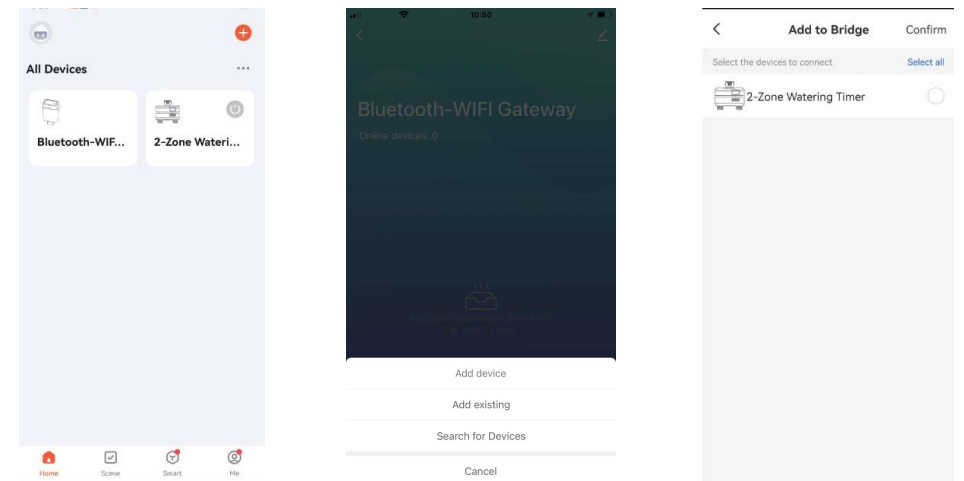

Once the connection is complete, the paired devices will be shown on the home page.
Click the Bluetooth Waterring Timer and get into main page of the device.

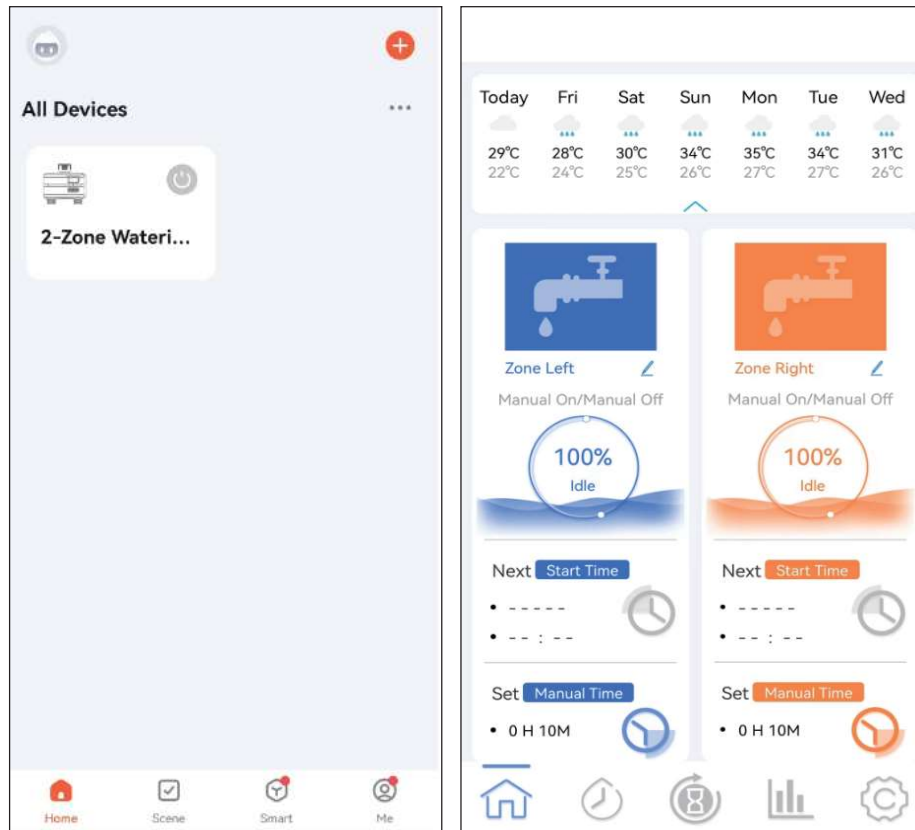

5. Basic information of Home Screen

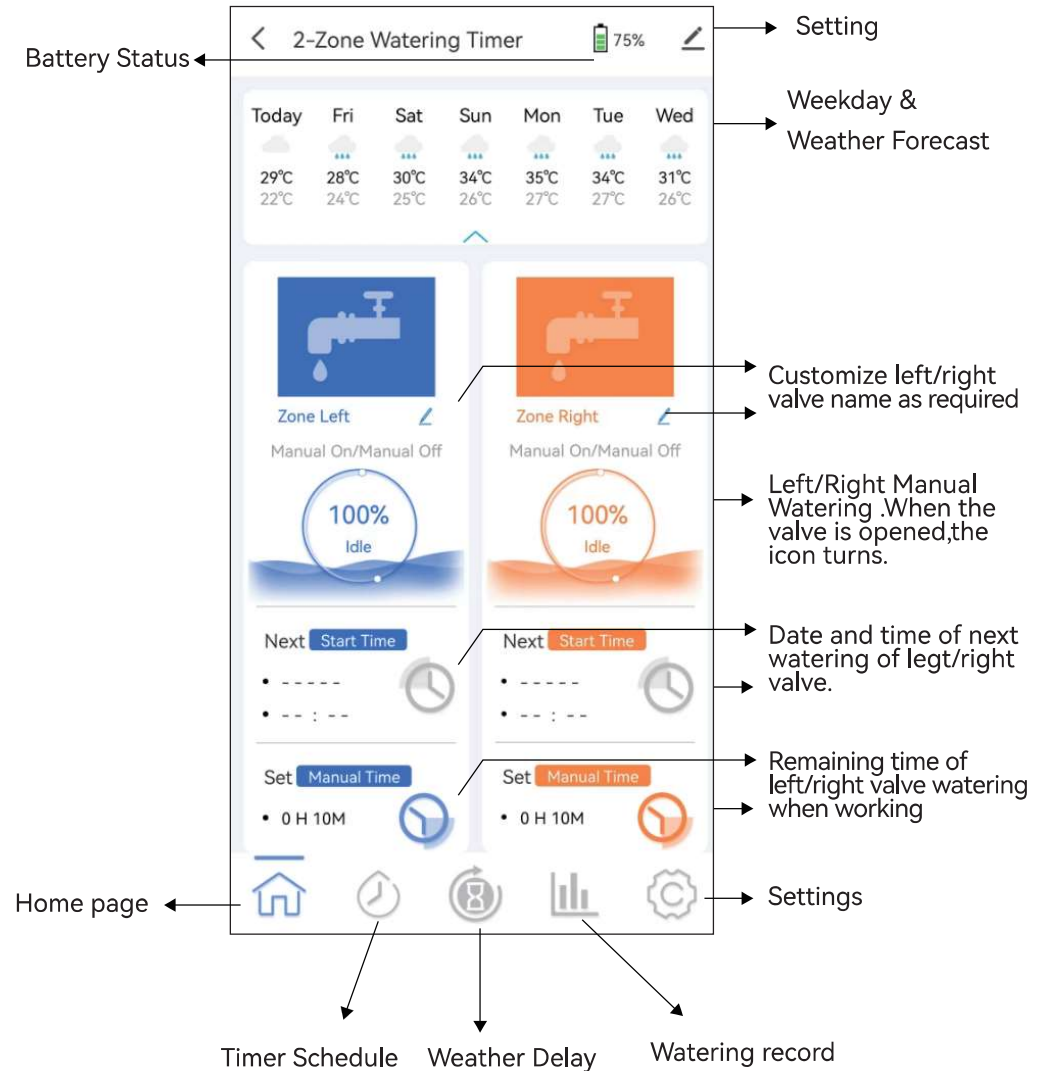

Press the button on the top right to set the timer name as your requirements.

Click the Smart Watering Timer to enter the device details pages. This page displays the following information: Weekday & Weather Forecast, battery status, device status, irrigation time, next run time.

At the bottom, there is an operation panel with several options: Home page, weather delay, Schedule and settings, Watering record, settings.



Remote control button for instant watering. Check the working status of the left and right valves.



Schedule Setting with normal schedule and cycle & soak schedule for options.



Weather delay for 24/48/72 hours.



Irrigation history and water consumption for irrigation events track and avoid false operation.



To set flow unit (L/GAL), temperature unit (°C/°F) and time scale (24 hours / 12 hours)

6. Manual Operation

Method 1: 1-1, To set the watering duration, the default watering duration is 10 minutes, if you want to customize the watering duration, you need to click the "⌚" icon in the manual time setting area under the left/right valve on the home page to enter the setting without running the schedule, select the watering duration according to your needs and click the confirmation to save. 1-2. Start/Stop, click the "100%" icon on the



home page to water manually until the set watering time is over and it will stop automatically, or you can click the icon "100%" again to stop watering, the remaining watering time will be shown at the bottom of the home page.

Method 2: Press the button at the bottom of the timer screen to control the left and right valves, the left button controls the left valve and the right button controls the right valve. The default watering time is 10 minutes, if you want to customize the watering time, please set the manual watering time through APP.

Note: When the left/right is in working state, the screen of the timer device will switch the display between the remaining working time of the current working valve and the amount of water already used.

7. Weather Delay

Tap the icon "⌚" to enable the rain delay function. The weather delay can be set with 24H, 48H, 72H and cancel. After the delay mode is enabled, all plans of the device will be suspended during the delay period, and all watering plans will resume normal operation when the delay is over.

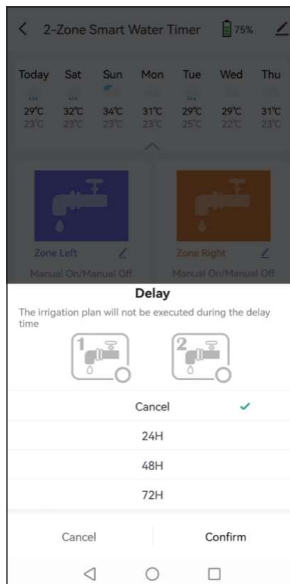

Note: When the left/right valve is in the delay state, the timer device will display the "DELAY" icon on the screen, and then display the remaining time at an interval of 3 seconds.

8.Schedule and settings

Click the timer“⌚” icon at the bottom of the home page to enter the timer setting, the timer type is divided into Timed Watering Schedule and Cyclical Watering Schedule.

1.Timed Watering Schedule: You can irrigate according to the specified time point, click "Timed Watering Schedule" to set the watering time and watering duration of the corresponding valve (by volume),select weekly cycle, odd days or even days as needed (note: only one of the three can be selected), click save after selection, thecorresponding valve willbe watered according to the set schedule. watering according to the set schedule.

2. Cyclical Watering Schedule: The timer device can be used for interval watering within a set period of time. Click on "Cyclical Watering Schedule" to set the start time, end time, irrigation time (or volume irrigation) and interval time of watering for the corresponding valve. Select weekly cycle, odd days or even days (note: only one of the three can be selected), click save after selection and the corresponding valve will be watered according to the set schedule.

3. If you need to pause the plan, slide the button to the right of each plan, green is on, gray is pause. If you need to delete the plan, you need to click into the plan, slide to the bottom, select delete and confirm.

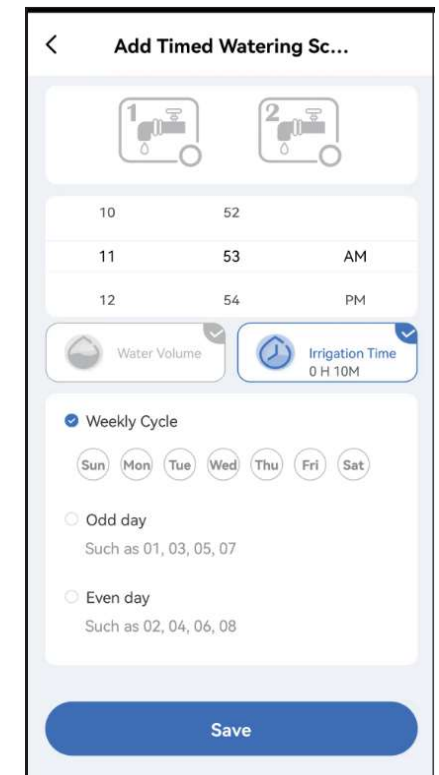
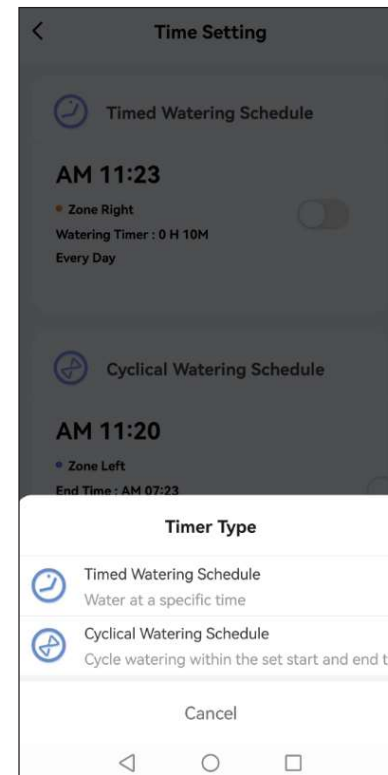

Note: 1. When the left/right is in working state, the screen of the timer device will switch the display between the remaining working time of the current working valve, the amount of water already used, and if the irrigation is by volume, the screen will display the remaining water amount. By volume irrigation, it means the corresponding valve will automatically close to stop watering after finishing the set amount of water irrigation.

Irrigation by time:



Irrigation by volume:



9.Irrigation record

Click on the "📊" icon at the bottom of the home page and enter to view the historical water consumption statistics and irrigation records of the left/right valves. You can also choose to view the water consumption statistics of the dual valves by "week" (previous week), "month" (previous month), and "year" (previous year) for the corresponding time period.

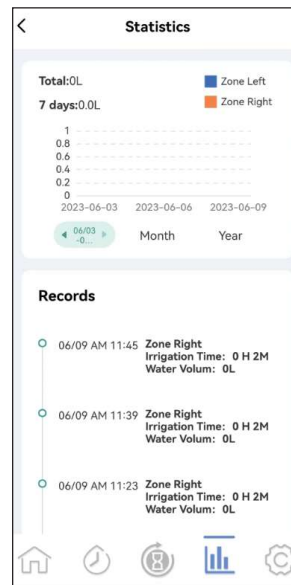

10.Setting

Click the "⚙️" icon at the bottom of the home page to enter and set the flow rate unit (L/GAL), temperature unit (°C/°F) and time system (24 hours/12 hours) as required.

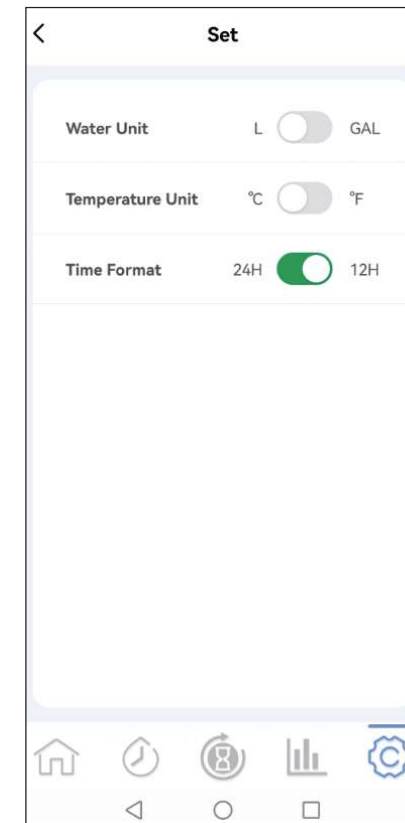

11.Tips:

1. After the valve is opened, if there is no water flow through within two minutes, the valve will automatically close and notify the no-water alarm on the APP. If there is still water flowing through after the valve is closed, the Tuya Smart APP will issue a water leak alarm.
2. When all valves of the watering timer are closed, the timer device screen displays the last water consumption of the left valve, the last water consumption of the right valve and the cumulative water consumption of the watering timer, switching between the three values every 3 seconds, with the following display effect:



Warranty & Warnings

1. Please make sure the smart phone is near the Bluetooth water timer when connecting or setting the watering plan. The best range for connection and operation is within 60 meters in the open area.
2. The watering timer will follow and perform the preset watering schedule after application set successfully, even if the phone is out of the best connecting range.

FCC Caution:

This device complies with part 15 of the FCC Rules. Operation is subject to the following two conditions: (1) this device may not cause harmful interference, and (2) this device must accept any interference received, including interference that may cause undesired operation.

Any changes or modifications not expressly approved by the party responsible for compliance could void the user's authority to operate the equipment.

NOTE: This equipment has been tested and found to comply with the limits for a Class B digital device, pursuant to Part 15 of the FCC Rules. These limits are designed to provide reasonable protection against harmful interference in a residential installation. This equipment generates, uses and can radiate radio frequency energy and, if not installed and used in accordance with the instructions, may cause harmful interference to radio communications. However, there is no guarantee that interference will not occur in a particular installation.

If this equipment does cause harmful interference to radio or television reception, which can be determined by turning the equipment off and on, the user is encouraged to try to correct the interference by one or more of the following measures:

- Reorient or relocate the receiving antenna.
- Increase the separation between the equipment and receiver.
- Connect the equipment into an outlet on a circuit different from that to which the receiver is connected.
- Consult the dealer or an experienced radio/TV technician for help.

To maintain compliance with FCC's RF Exposure guidelines, This equipment should be installed and operated with minimum distance between 20cm the radiator your body: Use only the supplied antenna.