

Product Number: UT02  
160401-24081301 V10



## USB Wireless Audio Transmitter UT02

# Product Details



Item	Name	Description
①	UT02 main part	USB Type-C interface Wireless Audio Transmitter, use for PC/Mac/Pad/Phone/PS4/PS5.
②	Type-C to USB-A Adapter	Combined use with UT02 main part, convert Type-C to USB-A for computer with USB-A interface.
③	3.5mm Microphone	Microphone for PS4/PS5 controller.





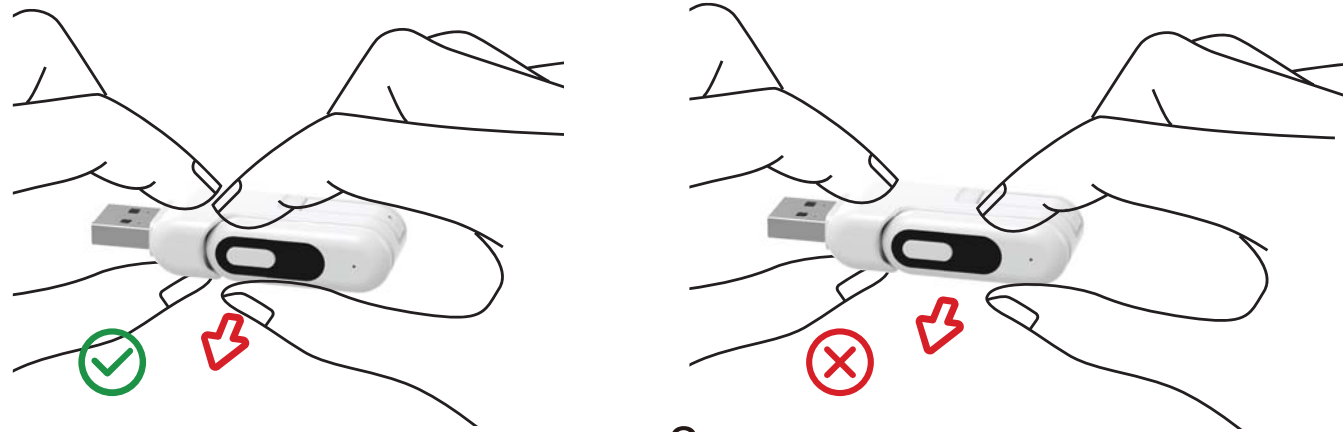





## Attention:

When pull out UT02 main part from adapter, it can only be pulled out by pinching at MFB button side with your fingers, because the Type-C connector is located on the side close to the MFB button, if you pinch it in the wrong position, it will be difficult to pull it out or the connector will be easily deformed and damaged.









# Basic Operation



Function	MFB Button Control	LED States	Remark
Power On	First time use, auto power on and enter pairing mode automatically	White 1x, then Red and Blue alternately , if not, please refer page 6	If there is no device paired with UT02, it will auto power off in 1minutes
Enter Pairing Mode	Long press MFB for 3 seconds	Red and Blue alternately  	Refer to Page 6
Exit Pairing Mode	Long press MFB for 3 seconds	Return to previous state	
Pairing Success	N/A	White 3x   	
Waiting Reconnect	N/A	Repeat 	
Manual Switch to HFP Mode	Double press MFB fast within 0.5 seconds	HFP mode=White 	Refer to Page 4
Exit HFP Mode	Double press MFB fast within 0.5 seconds	Return to previous state	
Manual Disconnect	Click MFB	LED Off	
Manual Reconnect	Click MFB	Return to previous state	
Reset Paired List	Long press MFB for 10 seconds	Red 3x   	

# Audio Encoding Format and LED Color

Audio Encoding Format	LED Color
SBC	
APTX	
APTX-AD	
APTX-HD	
APTX-LL	
HFP	

## \* HFP (Hands-free Profile Mode) Mode Notes:

At HFP mode, UT02 will enable the microphone of Bluetooth headphone, then you can chat with others over Bluetooth headphone, but if there is music playback at the same time, the music sound quality will decrease due to Bluetooth technical bottlenecking.

In most application scenarios, UT02 can automatically switch between normal mode and HFP mode according by the usage scenario. When automatic switching is not possible, it can be manually switched by double click MFB.

SONY PS4/PS5 cannot automatically switch between normal mode and HFP mode, it needs manually switch.

If you need best sound quality of music playback and voice chat at the same time, you can use 3.5mm Microphone in the accessories as a sound input device.

# Application Scenarios

UT02 is a USB interface wireless audio transmitter, it using USB protocol to connects with PC/Mac/Pad/Phone /PS4/PS5/SWITCH, and convert music playback to Bluetooth and transmits to Bluetooth headphones or speakers paired with it.

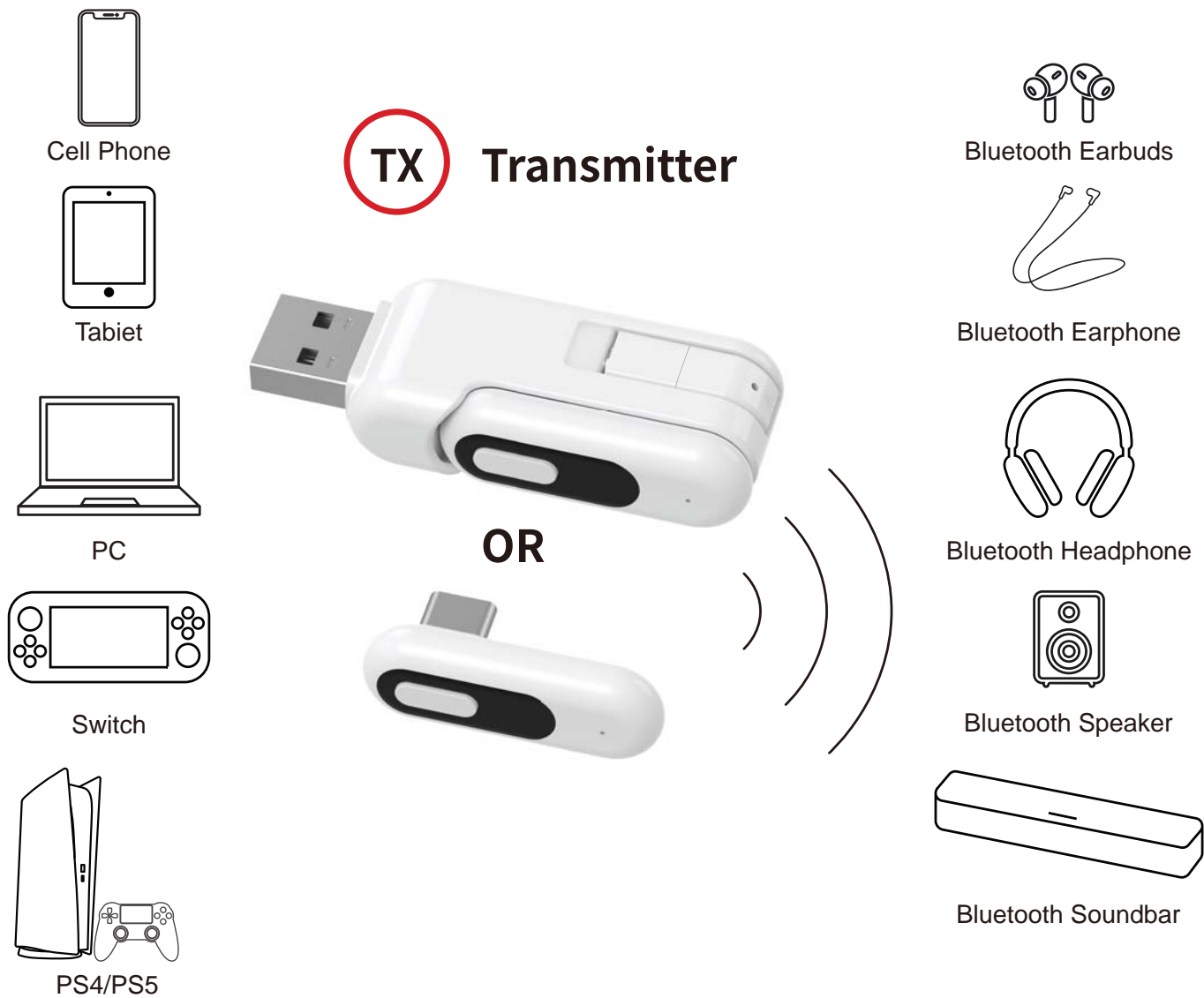

## How to Use

- ① Plug UT02 into Type-C or USB-A port, and UT02 will auto power on.

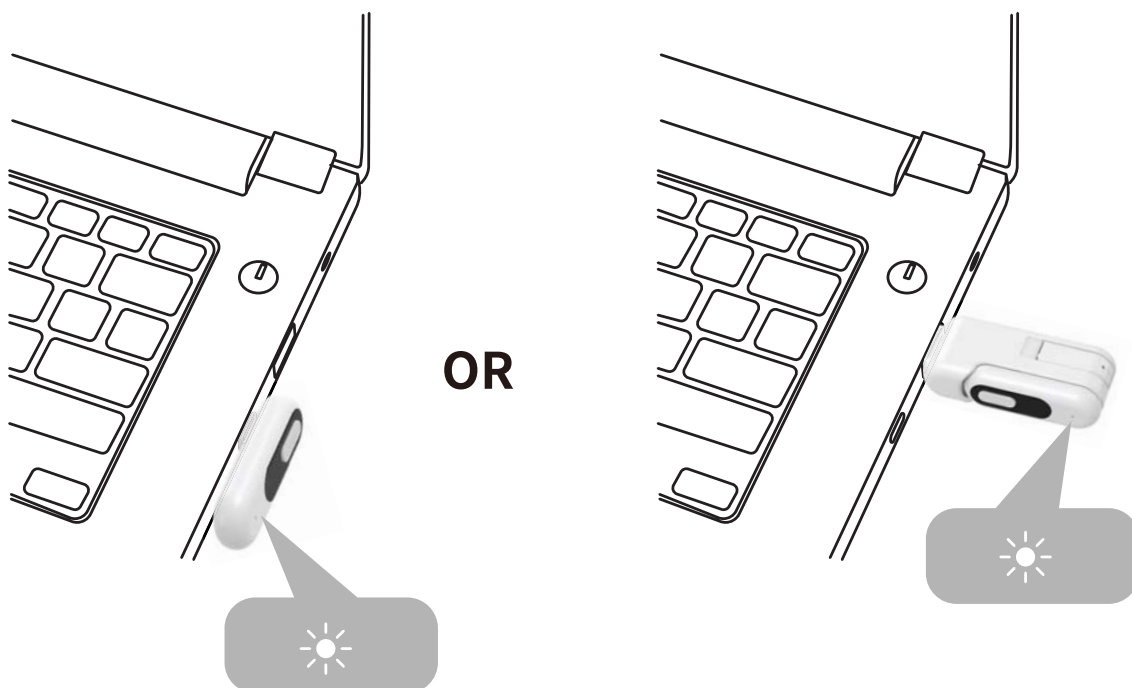

- ② Long press MFB for 3 seconds to enter pairing mode.

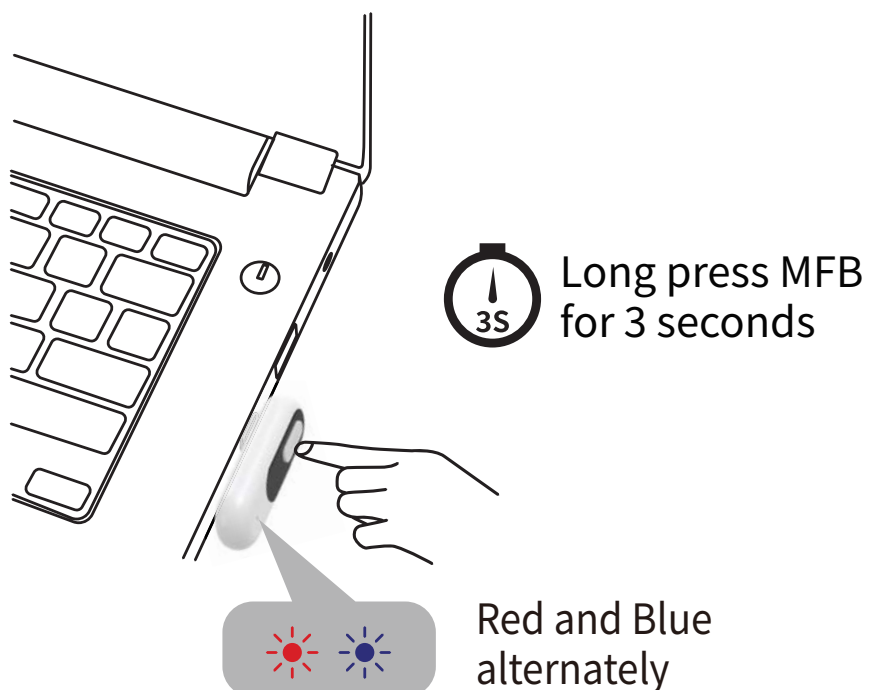

③ Put the Bluetooth earbuds to be used by entering pairing mode.

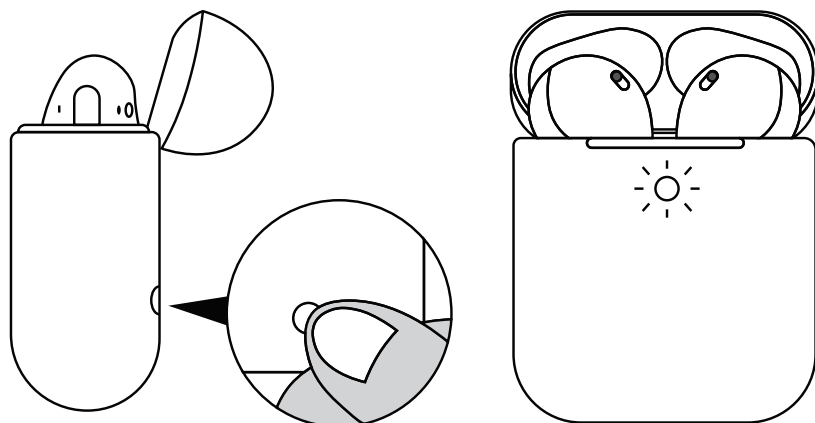

④ Wait for a moment for them to automatically paired successfully.

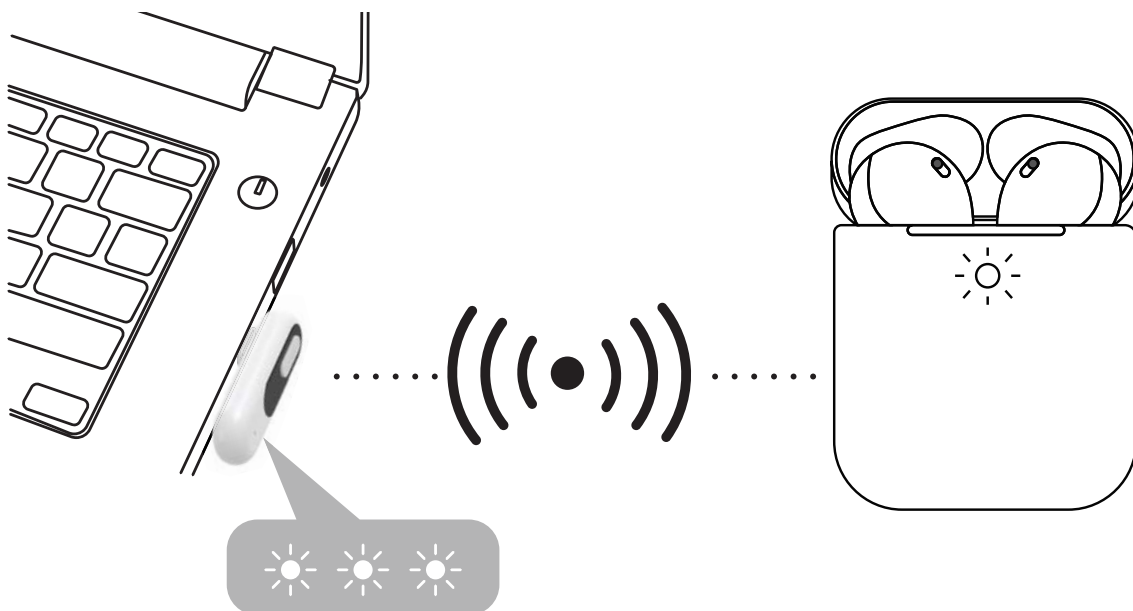

⑤ Set UT02 as your default Input/Output device in your MAC/PC/Gaming Console's audio setting menu.

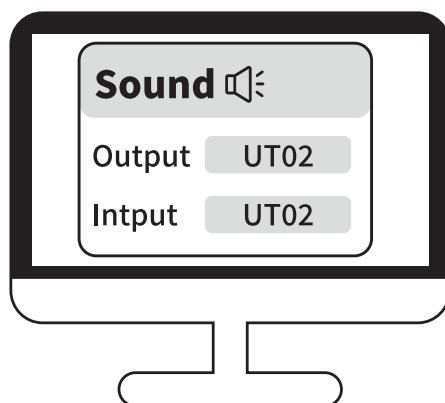

## Windows:

Settings -> System -> Sound -> Output device -> Speaker (UT02)

Settings -> System -> Sound -> Input device -> Microphone (UT02)

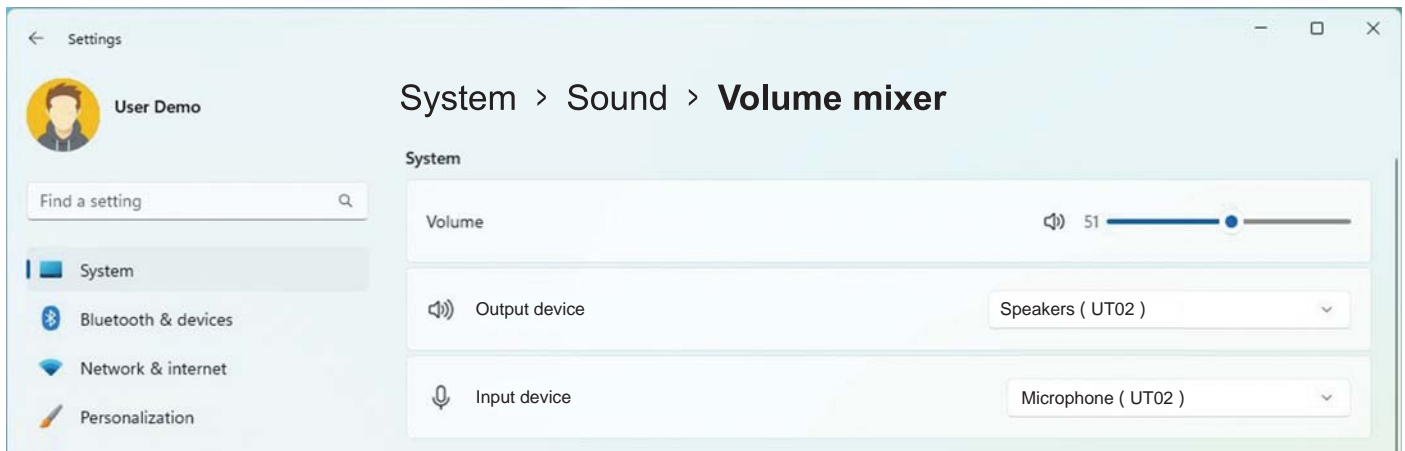

## MacBook:

Settings -> Sound -> Output -> UT02

Settings -> Sound -> Input -> UT02

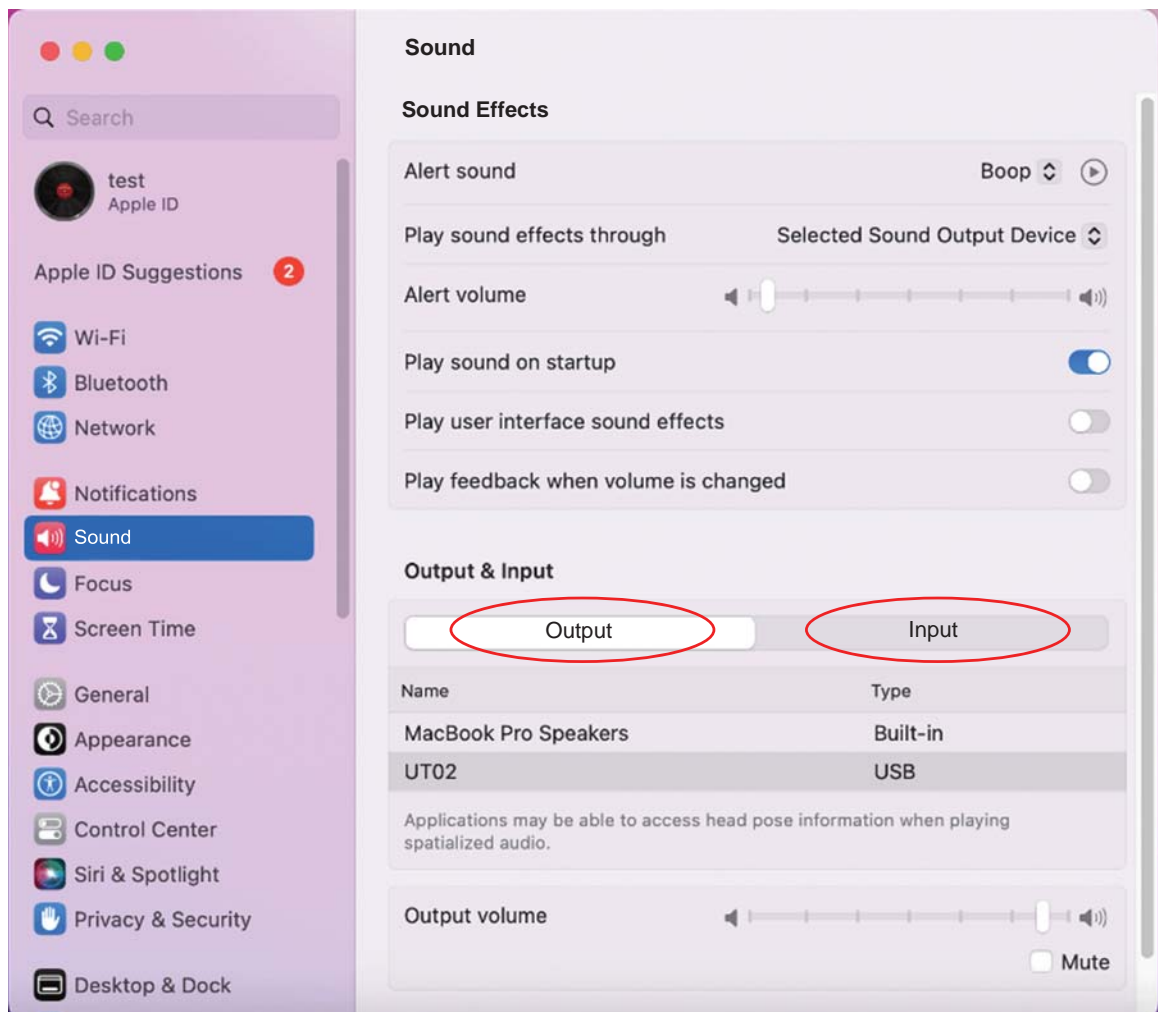



## PS4/PS5:

Settings -> Sound -> Audio Output -> Output Device -> USB Headset (UT02)

Settings -> Sound -> Microphone -> Input Device -> USB Headset (UT02)

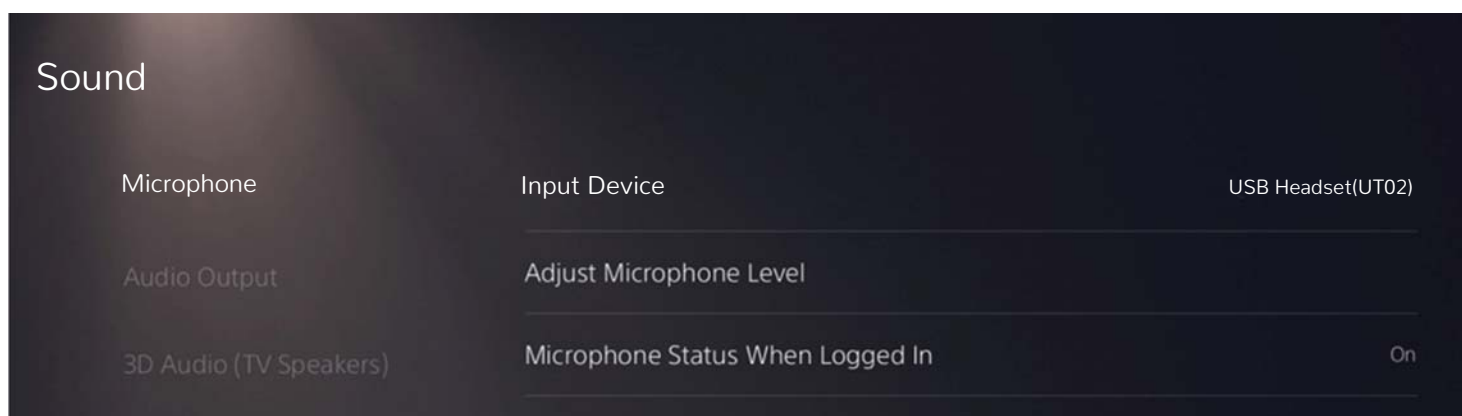

## 3.5mm Microphone Usage



for PS4 controller  
without Microphone



for PS5 controller  
Microphone damaged

① Plug 3.5mm Microphone into the MIC connector of PS4/PS5 gaming controller.



② Then the default audio input device is the 3.5mm Microphone at gaming controller now, chat voice will capture by it, ensure appropriate distance to make a good recording quality.

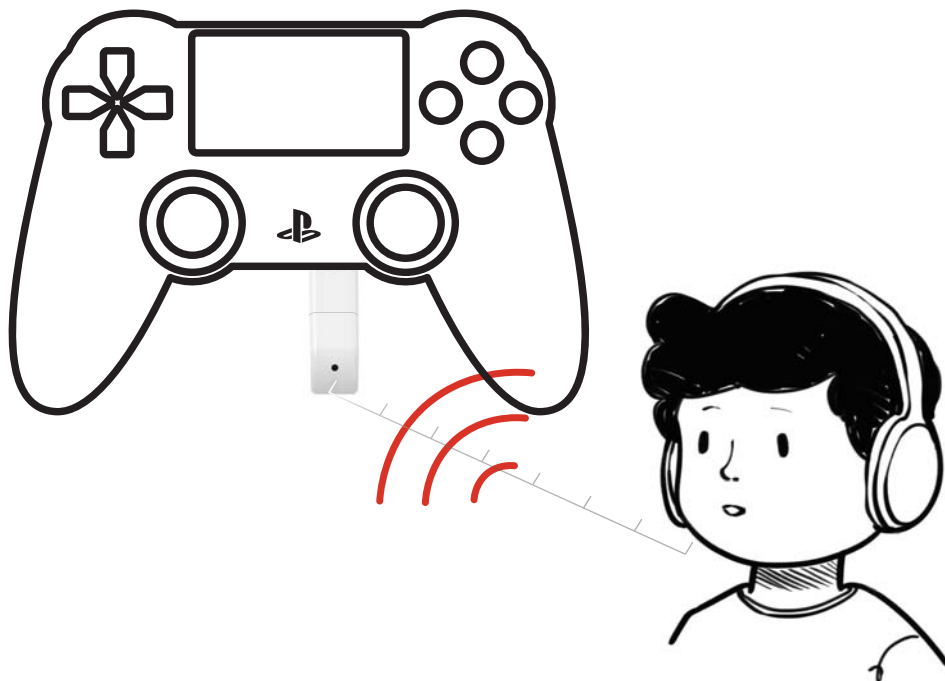

## Specification

Effective Range: 10 meters (33 feet)

Bluetooth Version: 5.2

## **FCC Warning:**

**This equipment has been tested and found to comply with the limits for a Class B digital device, pursuant to part 15 of the FCC Rules. These limits are designed to provide reasonable protection against harmful interference in a residential installation.**

**This equipment generates uses and can radiate radio frequency energy and, if not installed and used in accordance with the instructions, may cause harmful interference to radio communications. However, there is no guarantee that interference will not occur in a particular installation.**

**If this equipment does cause harmful interference to radio or television reception, which can be determined by turning the equipment off and on, the user is encouraged to try to correct the interference by one or more of the following measures:**

- Reorient or relocate the receiving antenna.**
- Increase the separation between the equipment and receiver.**
- Connect the equipment into an outlet on a circuit different from that to which the receiver is connected.**
- Consult the dealer or an experienced radio/TV technician for help.**

**Changes or modifications not expressly approved by the party responsible for compliance could void the user's authority to operate the equipment.**

**This device complies with Part 15 of the FCC Rules. Operation is subject to the following two conditions:**

**(1) this device may not cause harmful interference, and (2) this device must accept any interference received, including interference that may cause undesired operation.**

## Warranty Terms

1. There is a manual and warranty card in the package.  
User fill out the warranty card as the warranty certificate.
2. When adapter quality problems occur in normal use and not more than a year since the date of purchased, users can enjoy free repair services.
3. The following situations don' t belong to the scope of warranty:
  - A. No dealer signature or seal in warranty card.
  - B. Artificial or force majeure cause damage.
  - C. Machine to normal wear and tear.
4. If the failure is caused by human factors, beyond the warranty period or force majeure factors, we will charge maintenance fees.
5. If the product fails and needs to be returned to the factory for warranty, please contact us: **yocowoco@outlook.com**.