

M51

Bluetooth Headset

User Manual

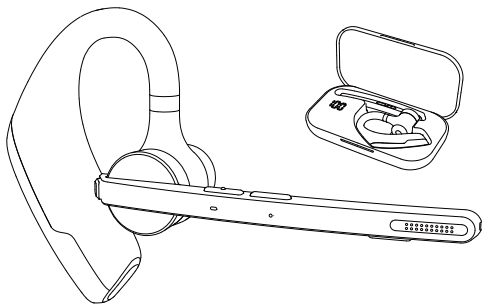

Thank you for choosing our product. Please read this user manual carefully and follow relevant rules before using the product to ensure correct and safe use.

I . Product Overview

This is a stylish Bluetooth headset with a built-in Qualcomm Bluetooth chip, which provides stable connection, HD voice calls and clear music listening. Besides, it features up to 15 hours battery life and 6 months standby time, brings more convenience to your life.

It should be noted that the Bluetooth connection may be blocked by walls, affected by electronic interference, or interrupted due to over-distance.

II . Product Description

1. Headset

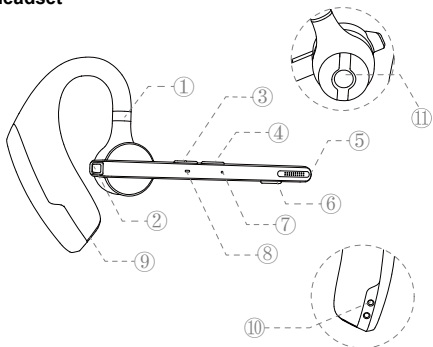

- ① Retractable Ear Hook
- ② Multifunctional Button
- ③ Volume Up Button
- ④ Volume Down Button
- ⑤ Main Microphone
- ⑥ Microphone Mute Button
- ⑦ Secondary Microphone
- ⑧ Headset Indicator
- ⑨ Type-C Charging Port
- ⑩ Headset Charging Contact Point
- ⑪ Speaker

2. Charging Case

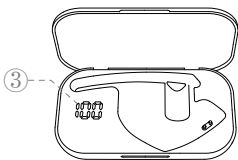
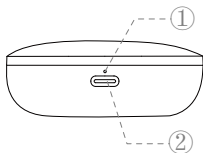

- ① Charging Case Indicator
- ② Type-C Charging Port
- ③ Digital Display Screen

III. Packing List

Headset*1

Charging case * 1

Charging cable * 1

User manual * 1

Ear cap (S) * 1

Ear cap (M) * 1

Ear cap (L) * 1

IV. Wearing Instruction

1.Wearing on the Right Ear

① Take out the headset from the charging case. As the picture shows, adjust the length of the ear hook according to your needs, slide the headset from above the ear to behind the ear, then gently press it toward the ear.

NOTE:

- Please take off your glasses before wearing the headset in order to achieve the most comfortable wearing condition.
- The adjustment range of ear hook length is 0-3.2mm. Do not use excessive force when adjusting the length of the ear hook.

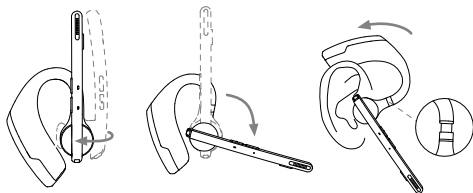

② Rotate the microphone boom to ensure the microphone

is towards your mouth.

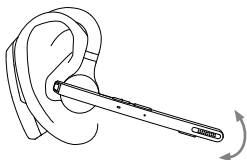

2. Adjustment of Wearing Style (Wearing on the Left Ear)

① Rotate the microphone boom upwards and twist, make the earbud turn to another side, and then rotate the ear hook clockwise.

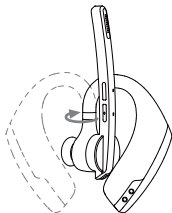
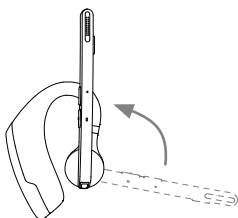

② Slide the headset from above the ear to behind the ear, then gently press it toward the ear. Rotate the microphone boom downwards to ensure the microphone is towards your mouth.

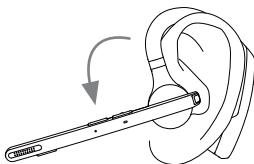

NOTE:

- The maximum rotation Angle of the microphone boom is 270°.
- The maximum rotation Angle of the ear hook is 180°.

V . Usage and Operation

1. Bluetooth Connection

① Take out the headset from the charging case or press and hold the multifunctional button for 3 seconds to turn on the headset. The headset emits the voice prompt of “pairing” immediately after it emits the voice prompt of “power on”, indicating that the headset automatically enters the pairing mode. The headset indicator keeps flashing in red and blue alternately.

② Turn on Bluetooth function of cellphone (or other devices) , and then search for new devices.

For iPhone, “Settings” > “Bluetooth” > “Open”

For Android phones, “Setting” > “Bluetooth” > “Search new device”

Note: The menu contents may vary from different devices.

③ Find "M51" in the list of Bluetooth devices and click to

connect. If the connection is successful, the headset will emit the voice prompt of “connected” and the headset indicator will go out.

NOTE: When using the headset again, it automatically connects to the last two devices. If there is no paired device within 5 minutes, the headset will automatically turn off.

④ **Two Devices Connection**

This headset can connect to two devices at the same time.

After successfully connecting to phone A, turn off the Bluetooth function of phone A and headset. Next, restart the headset and connect to phone B. Keep phone B connected, turn on the Bluetooth function of phone A, find the “M51” in the list of Bluetooth devices and click to connect. (**NOTE:** Although the headset can connect to two phones at the same time, only one of the phones can play music through M51, the headset cannot play music from two phones at the same time.)

2. Button Function Description

① **Multifunctional Button**

- **Power On:** In the power off state, press and hold the multifunctional button for 3 seconds.
- **Power Off:** In the power on state, press and hold the multifunctional button for 5 seconds.
- **Play/Pause:** In the music playing state, click the multifunctional button once.
- **Answer A Call:** click the multifunctional button once when there is an incoming call.

- **Hang Up:** Click the multifunctional button once during a call.
- **Reject A Call:** Press and hold the multifunctional button for 2 seconds when there is an incoming call.
- **Redial Last Phone Number:** Double click the multifunctional button.

② Volume Up Button

- **Volume Up :** Click the volume up button to increase the volume.
- **Next Song:** Press and hold the volume up button for 3 seconds to skip to next song.

③ Volume Down Button

- **Volume Down:** Click the volume down button to decrease the volume.
- **Previous Song:** Press and hold the volume down button for 3 seconds to skip to previous song.

④ Microphone Mute Button

- **Mute On/Mute Off:** Click the button to turn on the mute function during a call, click the button again to turn off the mute function.
- **Voice Assistant:** Press and hold the button for 3 seconds to activate voice assistant.

3. Headset Indicator / Voice Prompt

Definition	Headset Indicator Status	Voice Prompt
Power on	Blue light is on for 1 second	Power on
Power off	Red light is on for 1 second	Power off

Enter pairing mode	Flashing red and blue alternately	Pairing
Connected successfully	/	Connected
Disconnect	Flashing red and blue alternately	Disconnected
Incoming call	Keep flashing in blue	/
Volume up	/	Ding ding (maximum volume)
Volume down	/	Ding ding (minimum volume)
Restore factory settings	Flashing red and blue alternately	Power on, Pairing
Mute on	/	Mute on
Mute off	/	Mute off
Low battery reminder	Keep flashing in red	Battery low

4. Restore Factory Settings

In power-on state, press the multifunctional button and volume up button at the same time for 6 seconds, when hearing the voice prompt of “power on, pairing”, the headset has been restored to factory settings.

5. Charge the Headset

(1) Low Battery Reminder

When the headset emits the voice prompt of “battery low”,

it indicates that the headset is in low battery state. Please charge the headset immediately.

(2) Charging Instructions

① Charge the headset with charging case

Place the headset into the charging case for charging. The digital display screen of the charging case is on for 10 seconds and then goes out.

When charging, the headset indicator is red. When fully charged, the headset indicator stays on in blue for 10 seconds and then goes out.

NOTE: Please place the headset flat and keep the charging contact point clean, otherwise the headset will not be charged.

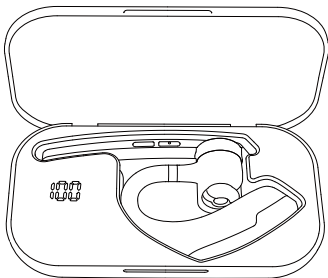

② Charge the headset with Type-C charging cable

When charging, the headset indicator is red. When fully charged, the headset indicator stays on in blue for 10 seconds and then goes out.

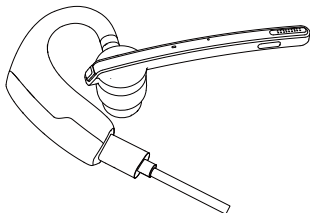

6. Charge the Charging Case

(1) Low Battery Reminder

The digital display screen of the charging case flashes for about 10 seconds, indicating that the charging case is in low battery state. Please charge the charging case immediately.

(2) Charging Instruction

Please charge the charging case with Type-C charging cable.

When charging, the charging case indicator is red. When fully charged, the charging case indicator turns blue.

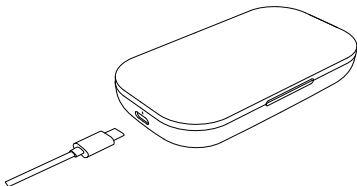

VI. Product Specifications

1. Bluetooth version: V5.2

2. Bluetooth chip: QCC3040
3. Supported protocols: Headset, HFP, A2DP, AVRCP
HSP
4. Speaker unit: $\Phi 13\text{mm}$
5. Transmission distance: 15m
6. Headset battery capacity: 115mAh
7. Charging case battery capacity: 500mAh
8. Standby time: 6 months
9. Music playback time: 15 hours
10. Headset charging time: 1.5 hours
11. Charging time of charging case: 1.5 hours
12. Charging port: Type-C
13. Working temperature: -5°C - 50°C
14. Headset weight: 16.5g
15. Charging case weight: 64.1g

VII. Common Problems

1. Low battery may cause disconnection, in order not to affect normal use, please charge the headset in time.
2. If the headset fails to turn on, please try to charge it up first, and turn it on when the battery is sufficient.
3. No sound can be heard from the headset when in a call.

—— Make sure you choose the M51 for audio input/output when in a call, but not the speaker on your cellphone.

—— Check whether your cellphone has been connected to other Bluetooth devices.

—— Make sure the distance between the headset and the cellphone does not exceed the effective distance of 15 meters.

4. The other end cannot hear your voice when in a call.
——Please keep the microphone hole of headset clean, so as not to affect the call and noise reduction effect, resulting in the other end can not hear your voice.
5. The headset cannot be charged.
——Please wipe the charging contact point of the headset and the charging case with alcohol.

VIII. Safety Notes

1. Disassembling personally may damage the headset and this is not covered by warranty.
2. Please clean the headset with a clean, soft, and dry cloth.
3. Please do not use the headset in a dusty and humid environment.
4. Do not let your children play with the headset. They may be injured or damage the headset.
5. Do not place the headset in an extreme environment, otherwise, it may be temporarily unavailable for use. The normal use temperature is -5°C to 50°C.

FCC Warning Statement

Changes or modifications not expressly approved by the party responsible for compliance could void the user's authority to operate the equipment. This equipment has been tested and found to comply with the limits for a Class B digital device, pursuant to Part 15 of the FCC Rules. These limits are designed to provide reasonable protection against harmful interference in a residential installation.

This equipment generates uses and can radiate radio frequency energy and, if not installed and used in accordance with the instructions, may cause harmful interference to radio communications. However, there is no guarantee that interference will not occur in a particular installation. If this equipment does cause harmful interference to radio or television reception, which can be determined by turning the equipment off and on, the user is encouraged to try to correct the interference by one or more of the following measures:

- - Reorient or relocate the receiving antenna.
- - Increase the separation between the equipment and receiver.
- - Connect the equipment into an outlet on a circuit different from that to which the receiver is connected.
- - Consult the dealer or an experienced radio/TV technician for help.

This device complies with part 15 of the FCC Rules. Operation is subject to the following two conditions: (1) This device may not cause harmful interference, and (2) this device must accept any interference received, including interference that may cause undesired operation.

The device has been evaluated to meet general RF exposure requirement. The device can be used in portable exposure condition without restriction.



Happy?

Thank you for choosing our products! We sincerely hope it will be your new-found happiness.

If you are fully satisfied with your using experience, could you please kindly share to your friends?

We also engage with our fans to learn how we can do better by offering free pre-release products. If you are interested, do not hesitate to follow us on



Not Happy?

If you have any questions, concerns, or just not satisfied with our products, please feel free to contact us through e-mail at:

✉ E-mail: **support@anewbee.com**

☎ Tel: **(USA) 1-626-701-7623 (UK) 07845854035**

📍 Address: 3rd Fl, Bldg E, Guanghao Ind., No. 23,
Dalang St., Longhua Dist., Shenzhen City,
Guangdong Prov., China