

# Wireless Charger WCC-01

## Information for the User Manual

**Model No:** WCC-01

**FCC ID:** 2A6QT-WCC-01

### **Specification:**

Input: DC5V 2A, DC9V 1.67A, DC12V 1.5A

Output: DC5V 1A, DC9V 1.1A, DC12V 1.25A

Charging distance: <8mm

Conversion: >72%

Diameter: 69mm x H14 mm

### **How to use:**

This charger is designed for Qi-compatible devices. If your phone does not have built-in wireless charging capabilities, please use a certified Qi wireless charging case or receiver.

Refer to your phone's user manual for detailed features and functions.

1. We suggest to use QC3.0 adapter or DC12V adapter input for fast charging.
2. Do not place metal objects, magnets, magnetic stripe cards, and hard drive based devices near the wireless charger. It may cause data corruption.
3. Do not attempt to modify, disassemble, or repair this product.
4. Do not expose to water, moisture, or extreme temperatures ( below 40°F or above 90°F )

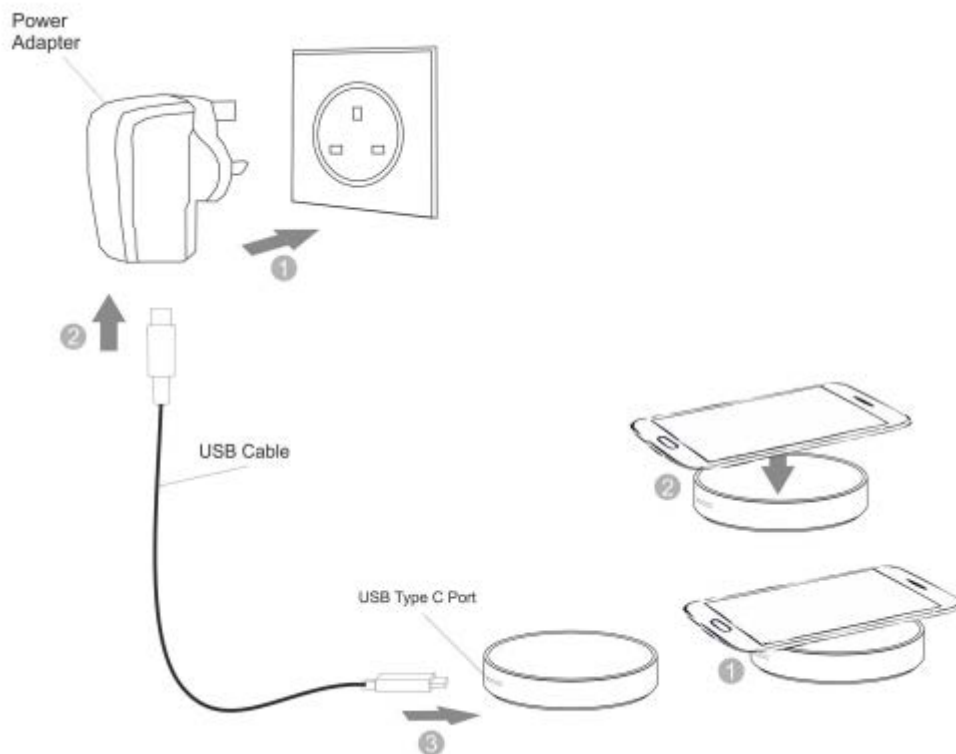

### **Warning!**

#### **Federal Communication Commission Statement (FCC, U.S.)**

This equipment has been tested and found to comply with the limits for a Class B digital device, pursuant to Part 15 of the FCC Rules. These limits are designed to provide reasonable protection against harmful interference in a residential installation. This equipment generates, uses and can radiate radio frequency energy and, if not installed and used in accordance with the instructions, may cause harmful interference to radio communications. However, there is no guarantee that interference will not occur in a particular installation. If this equipment does cause harmful interference to radio or television reception, which can be determined by turning the equipment off and on, the user is encouraged to try to correct the interference by one of the following measures:

- Reorient or relocate the receiving antenna.
- Increase the separation between the equipment and receiver.
- Connect the equipment into an outlet on a circuit different from that to which the receiver is connected.
- Consult the dealer or an experienced radio/TV technician for help.

This device complies with Part 15 of the FCC Rules. Operation is subject to the following two conditions: (1) This device may not cause harmful interference, and (2) this device must accept any interference received, including interference that may cause undesired operation.

FCC Caution:

Any changes or modifications not expressly approved by the party responsible for compliance could void the user's authority to operate this equipment.

FCC RF exposure statement:

To maintain compliance with FCC's RF Exposure guidelines, This equipment should be installed and operated with 20cm distance between the radiator and your body.

## **12 Month Warranty**

CHI warrants your new product to be free from defects in materials and workmanship for the period stated above, from the date of purchase, provided that the product is used in accordance with accompanying recommendations or instructions where provided. This warranty is in addition to your rights under the European Consumer Law.