

Wireless Carplay & Android Auto User Manual

Preface

This smart box is designed for iPhone/Android smartphones to use Apple CarPlay/Android Auto wirelessly on the factory car multimedia system which has built in Apple Car Play function. We have adapted to almost all models with Car Play on the market, but if there are any problems while using the box, please do not hesitate to contact us

Functions	Convert OEM Car Play to Car Play/Android Auto wireless,
Compatibility	All cars built in Car Play&Android Auto
Control	Touch Screen, Steering wheel, Joystick control
Input Power	USB 5V
Connectivity	Wi-Fi & Bluetooth

Connection Diagram

Choose the USB or Type-C port with interconnection function.

1. Connect the USB cable to the USB port of the car.
2. Connect the USB cable to the USB port of the car.
3. Connect the USB cable to the USB port of the car.

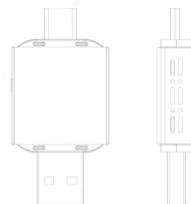

Product connection

How to use wireless Car play:

If the factory car supports Car-play connection via USB cable, please plug the device into the USB port in the car. Usually that USB port marked with Car play or smart-phone icon, select the Carplay function in the original car radio system, it goes to below interface:

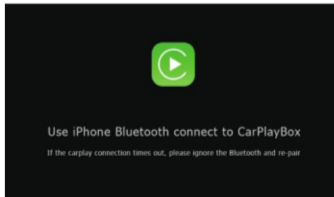

Make sure your iPhone's Bluetooth and Wi-Fi features are turned on and no other in-car devices are connected, On your iPhone, go to "Settings" > "Bluetooth" , in Other Devices list, you will see a Bluetooth device name started with "Autobox-xxxx" , tap to paid, allow permission and tap Use Car-play box to connect wirelessly

Version update description:

After connecting wireless Car play, scan this QR code with your camera or enter 192.168.2.1 in Safari to update the firmware.

Note that some head units cut off the power to the USB adaptor while updating and leaving the process stuck at 1%, if this is the case, please connect the adaptor to a USB port with contact power supply such as a computer's USB port (Don't update the device while the USB adaptor is plugged into the Car play's USB port).



Note:
You need an iPhone and open mobile data function to access the Safari browser

How to use wireless Android Auto

Before using Android Auto, please make sure you have the latest Android Auto application in your Android Smart-phone

●Enable “wireless Android Auto” in Android Auto settings

●Turn on Android phone’s Wi-Fi and Bluetooth and then search Bluetooth name” Autobox-xxxx” , tap to pair

●It will connect to wireless Android Auto automatically after a few seconds

●<- Android Auto

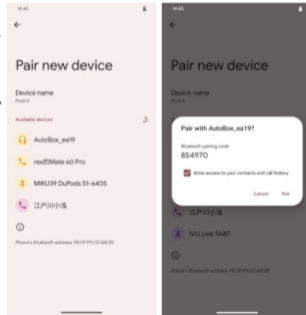

How to update the box:

Before updating Android Auto box: please make sure you have disconnected the wireless Android Auto, and also with stable 5V power supply (USB port for original Android Auto is not recommended)

1. Switch on the Wi-Fi in your Android smart-phone, and connect the Wi-Fi with Autobox-xxxx, password 88888888 (Pictures 1)

2. Wi-Fi is connected with above hot spot (Autobox-xxxx)

3. Open the link 192.168.2.1 with Chrome browser (Pictures 2)

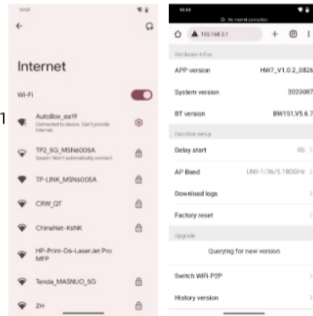

Pictures 1

Pictures 2

4. Choose Switch P2P, below means P2P switched (Pictures 3)

5. Go back to smart-phone’s Setting, choose Wi-Fi, and find Wi-Fi Direct, then connect with Autobox-xxxx hot spot (Pictures 4)

6. Go back to web page of 192.168.2.1, choose “Querying for new update”, then update the box (Pictures 5)

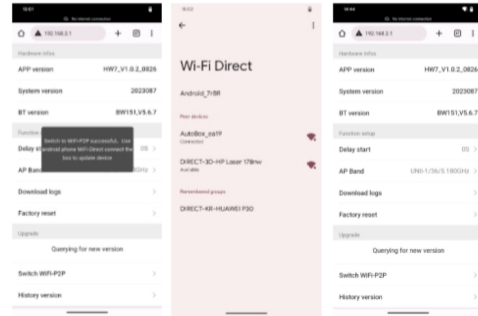

Pictures 3

Pictures 4

Pictures 5

FCC Warning:

This equipment has been tested and found to comply with the limits for a Class B digital device, pursuant to part 15 of the FCC Rules. These limits are designed to provide reasonable protection against harmful interference in a residential installation. This equipment generates, uses and can radiate radio frequency energy and, if not installed and used in accordance with the instructions, may cause harmful interference to radio communications. However, there is no guarantee that interference will not occur in a particular installation. If this equipment does cause harmful interference to radio or television reception, which can be determined by turning the equipment off and on, the user is encouraged to try to correct the interference by one or more of the following measures:

- Reorient or relocate the receiving antenna.
- Increase the separation between the equipment and receiver.
- Connect the equipment into an outlet on a circuit different from that to which the receiver is connected.
- Consult the dealer or an experienced radio/TV technician for help.

Caution: Any changes or modifications to this device not explicitly approved by manufacturer could void your authority to operate this equipment.

This device complies with part 15 of the FCC Rules. Operation is subject to the following two conditions:

(1) This device may not cause harmful interference, and (2) this device must accept any interference received, including interference that may cause undesired operation.

This equipment complies with FCC radiation exposure limits set forth for an uncontrolled environment. This equipment should be installed and operated with minimum distance 20cm between the radiator and your body.