

Azeada

AZ-S04

太空熊系列TWS无线音箱
SPACE BEAR SERIES TWS WIRELESS SPEAKER



无线音箱示意图

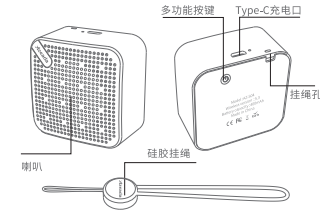

基本按钮操作

开机:按电源按钮3秒,白灯闪烁,直接进入配对状态。
关机:按电源按钮3秒钟,白灯熄灭。
播放/暂停:短按电源按钮

特征

立体浮雕彩绘工艺。
两个音箱可以相互连接使用。
迷你尺寸,惊人的音效。
内置大容量电池。

对音箱进行充电:
用Type-C充电口充电,充满需要两小时。
充电过程中红灯常亮,充满电后自动熄灭。

使用说明

功能	灯光和提示音
开机	白灯闪烁,直接进入配对状态
关机	电源关闭,白灯熄灭并发出提示音
无线连接	白灯闪烁并发出提示音
连接成功	白灯常亮并发出提示音
电量低	红灯闪烁并发出提示音
充电中	红灯常亮
TWS连接	两个音箱配对成功,白灯都常亮并发出提示音

无线连接

1.将AZ-S04 放置距离手机10米范围内,音箱为关机状态。2.按下电源按钮3秒钟,准备配对,在白色交替闪光后,会有语音提示进入配对模式。3.激活手机上的无线功能并搜索AZ-S04从在您的手机无线上找到的设备列表中,选择AZ-S04连接它,然后会有语音提示连接。

TWS互联功能:
(需要两个AZ-S04音箱)两个音箱同时开机,两个音箱都不要连接任何无线设备,稍等几秒两个音箱即可互联,互联成功白灯常亮。再打开手机上的无线功能,选择连接AZ-S04即可(仅显示一个可连接的设备AZ-S04)。

包装内容

- 1.AZ-S04 音箱 3.说明书,合格证,保修卡
2.充电线 4.硅胶挂绳

参数

无线版本	V5.3	电池容量	400mAh
工作频率	2.40~2.48GHz	播放时间	4h
信噪比	85dB	充电时间	约2h
失真度	<3%	产品重量	约82g
扬声器规格	403W	传输距离	10m
输入电压	5V	工作温度	-20℃~60℃

保修条例

本产品有效保修期为自出售之日起一年内,在保修期限内正常使用和维护的情况下,机器本身材料和功能出现问题,发生故障,经鉴定属实的,本公司将提供免费修理及更换零件。

本产品的保修不适用于:

- A.音箱已超出保修期;
B.用户未按说明指南要求,造成音箱损坏;
C.未经本公司授权自行拆装,修理,改动结构;
D.无法提供保修卡及消费凭证;
E.因自然灾害等不可抗力(如地震、火灾)原因造成的产品故障或损害;
注:保修服务不包含产品运输费用及不提供上门服务

本保修条款解释权归睿和鑫科技所有

保修卡

一、产品资料填写
用户名称 _____ 电 话 _____

地 址 _____

产品名称	机身型号		
经销商名称	地 址		经销商盖章
经销商地址	邮 编		
发票编号	购买日期		

一、产品维修记录

故障现象	更换材料	
维修方式	维修日期	
维修单位	是否维修	<input type="checkbox"/> 是 <input type="checkbox"/> 否
备 注		

*在接受服务时必须提供此保修卡, 请妥善保管!

产品合格证
(Product qualification certificate)

品牌 (Brand) Azeada
产品名称 (Product Name) 太空熊系列TWS无线音箱
Space Bear Series TWS Wireless Speaker
产品型号 (Product No.) AZ-S04
产品标准 (Product Standards) GB 4943.1-2011
生产日期 (Production Date) 2023-07
检 验 (Test) 合格 PASSED
检验员 (Inspector) _____



服务热线: 0755-21014523
深圳市睿和鑫科技有限公司版权所有并保留一切权利
制造商: 深圳市睿和鑫科技有限公司
地址: 深圳市福田区大浪街道新石社区源高路2号
明君工业园A1栋301
Designed By Azeada In Hong Kong Made In China.
Service Hotline: 0755-21014523
All rights reserved by Shenzhen Rehosin Tech. Co.,Ltd
Address: Room 301, Building A1, Mingjun Industrial Park, No. 2,Yuangao Road, Xinsi Community, Dalang Street, Longhua District, Shenzhen

Wireless speaker diagram

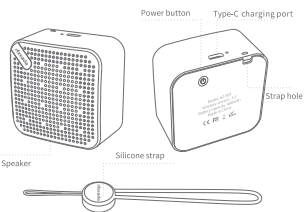

Operation

Power on:press the power button 3 seconds,the white light flashes,then the speaker starts to pair
Power off:press the power button 3 seconds and the white light will be off.
Play/Pause: short press of the power button

Features

3D relief paint
2 speakers can be connected with each other
Mini size, amazing sound
Built-in high capacity battery

Charging: It can be fully charged in 2 hours with Type-C cable, The red light is always on while charging and off once fully charged.

Operation instruction

Function	Light & prompt tone
Power on	The white light flashes,the speaker starts to pair
Power off	White light off with a sound
Wireless connection	The white light flash with a prompt tone
Successful connection	White light always on and there will be a prompt tone
Low power	Red light flashes with a prompt tone
Charging	Red light always on
TWS connection	Two speaker are successfully paired while the white light always on with a prompt tone

Pairing:

- 1.The speaker AZ-S04 & the phone are within 10m ;
2.Press power button 3s,the white light flashes with a prompt tone;
3.Activate wireless on the phone,tap AZ-S04 from the list,successfully connect with a prompt tone.

TWS interconnection function: (Two AZ-S04 speakers)
Power on the two speakers at the same time, they will connected with each other with a few seconds. The white light is always on once successfully connected. Then switch on the wireless function in your phone, select AZ-S04. (only show one AZ-S04)

Packaging list

- 1.AZ-S04 speaker
2.Charging cable
3.Manual,certificate ,warranty card
4.Silicone strap

Specification

Wireless version	V5.3	Battery capacity	400mAh
Frequency	2.40~2.48GHz	Playing time	4h
SNR	85dB	Charge time	About 2h
Degree of distortion	<3%	Product weight	About 82g
Speaker specification	403W	Distance	10m
Input voltage	5V	Working temperature	-20℃ ~60℃

Warranty regulations

The effective warranty period of this product is 1 year. Under the condition of normal use and maintenance within the warranty period, if the materials and functions of the machine itself have problems or failure, the company will provide free repair or replacement of the parts after confirmation.

The warranty for this product does not apply to:

- A.The speaker has exceeded the warranty period;
B.The user did not follow the instructions, resulting in the speaker damage
C. Disassemble, repair and change the structure without the authorization;
D.Unable to provide the warranty card and purchasing receipt;
E.Product failure or damage caused due to force majeure factors(such as earthquake and fire).
Note: Warranty service does not include product transportation costs and does not provide door-to-door maintenance service

All right reserved by Shenzhen Rehosin Technology

Warranty card

Product information

User name _____ Telephone _____

Address _____

Product name	Product model		
Dealer name	Make date		
Dealer address	Zip code		Dealer seal
Invoice number	Date of purchase		

Product maintenance record

Failure phenomenon	Replacement material	
Maintenance mode	Maintenance date	
Maintenance cost	Repair	<input type="checkbox"/> Yes <input type="checkbox"/> No
Remarks		

* Please provide this warranty card when receiving the service. Please keep it properly!

FCC Statement

This device complies with part 15 of the FCC Rules. Operation is subject to the following two conditions:

(1) This device may not cause harmful interference, and

(2) this device must accept any interference received, including interference that may cause undesired operation.

This equipment has been tested and found to comply with the limits for a Class B digital device, pursuant to part 15 of the FCC Rules.

These limits are designed to provide reasonable protection against harmful interference in a residential installation.

This equipment generates, uses and can radiate radio frequency energy and, if not installed and used in accordance with the instructions, may cause harmful interference to radio communications. However, there is no guarantee that interference will not occur in a particular installation.

If this equipment does cause harmful interference to radio or television reception, which can be determined by turning the equipment off and on,

the user is encouraged to try to correct the interference by one or more of the following measures: Reorient or relocate the receiving antenna.

. Increase the separation between the equipment and receiver.

. Connect the equipment into an outlet on a circuit different from that to which the receiver is connected.

. Consult the dealer or an experienced radio/TV technician for help.

Caution: Any changes or modifications to this device not explicitly approved by manufacturer could void your authority to operate this equipment. RF Exposure Information

The device was evaluated to meet general RF exposure requirements. This equipment should be installed and used with a minimum distance of 0 mm between the radiator and your body.