

USER MANUAL

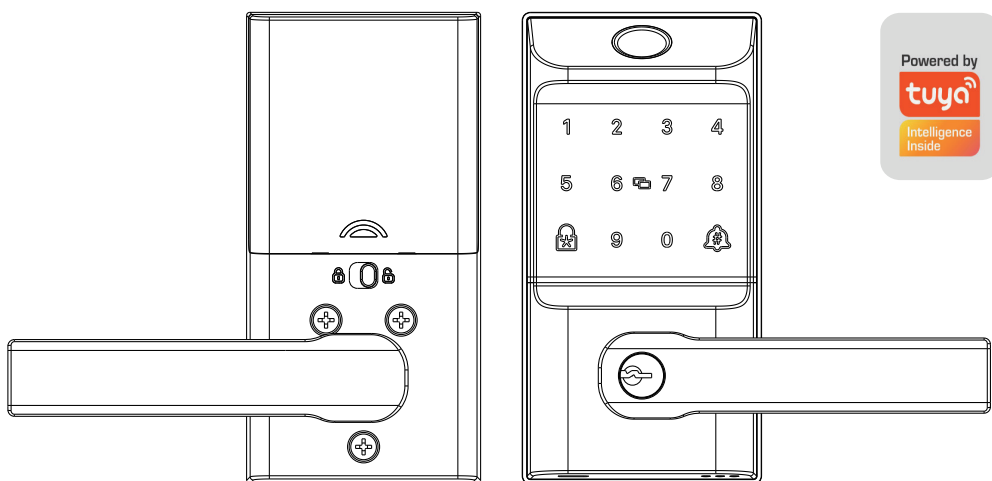





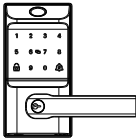
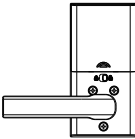
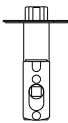
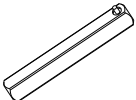
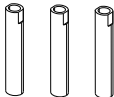

Note:

1. Before using this lock, please pair the lock with App on your mobile phone.
2. This lock is equipped with mechanical keys for manual unlocking. Remove mechanical keys from the package and keep them in a safe place and always have access to them.
3. To power on the lock, 4 x AA alkaline batteries(not included) are required. Non-alkaline and rechargeable batteries ARE NOT RECOMMENDED.
4. This lock is used outdoors and indoors, it is designed to be exposed to direct sunlight or rain. The waterproof rating: IP65.
5. Keep your fingers clean when using this lock.

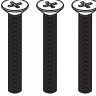
Please read this manual before operating your Smart Lock, and keep it for further reference.

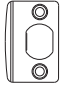
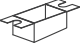
Packing List

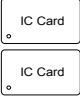
A 	B 	C 	D 	E  35mm		
F  35mm	G  35mm	H  25mm	I 	J  K 	L  Allen key	 IC Card IC Card

Installation Diagram

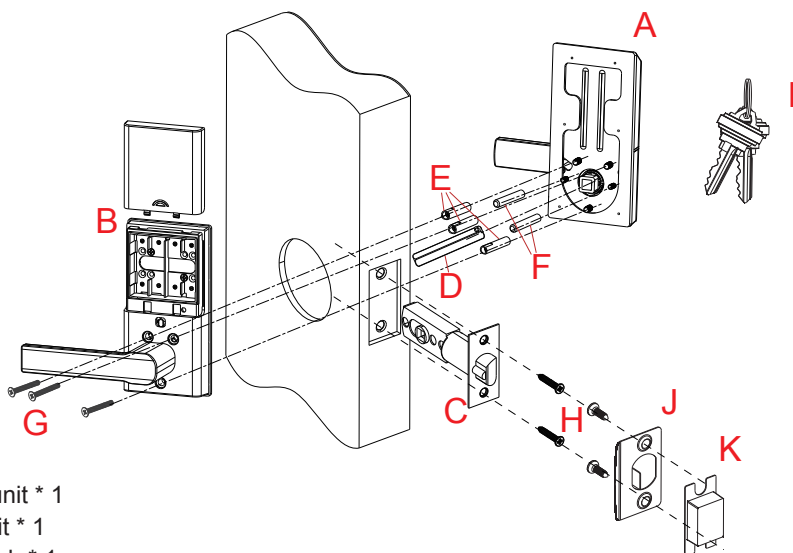

- A) Outdoor unit * 1
- B) Indoor unit * 1
- C) Single latch * 1
- D) Square spindle * 1
- E) M5 x 35 Cylindrical sleeve female bolt * 3
- F) M4 x 35 Cylindrical sleeve female bolt * 2
- G) M5 x 35mm cross flat head screw * 3
- H) M4 x 25mm cross flat head self-tapping screw * 4
- I) Mechanical key * 2
- J) Strike plate * 1
- K) Latch holding plastic box * 1
- L) Allen key * 1 (for changing handle's direction)

Door Preparation

1. Check door thickness and Door Frame.

- Door frame $\geq 110\text{mm}$
- Door thickness: 35-55mm

2. Check door open direction.

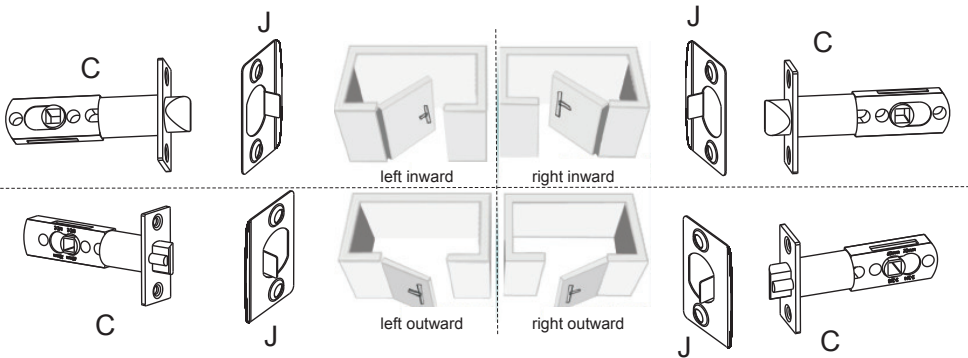

• Note: Please refer the above picture to adjust the direction of strike plate J and latch C.

Door drill hole map

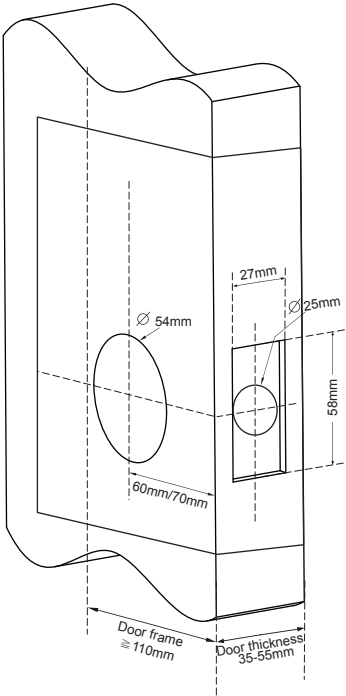
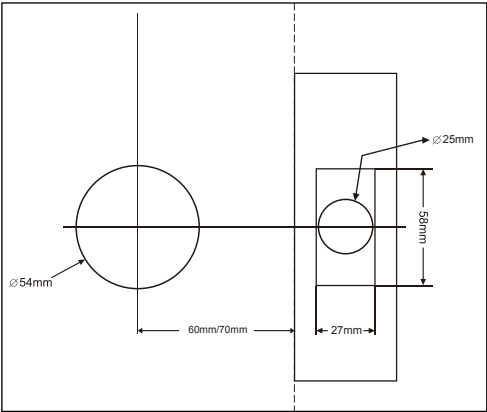

Installation Instructions

Step 1 According to the map drilling holes on the door

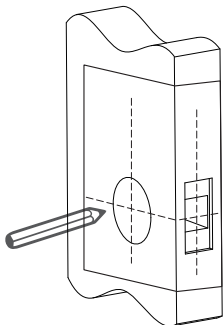

•Note:

- 1) Check the required backset (60mm or 70mm).
- 2) Align the template along the vertical center line of the single latch (C) at the desired height, and tape it to the door.
- 3) Mark the holes first, then start drilling.

Step 2 Install the single latch (C)

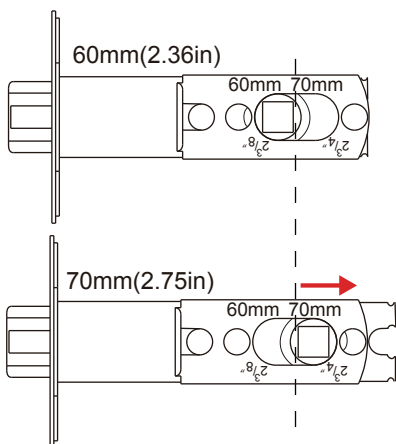
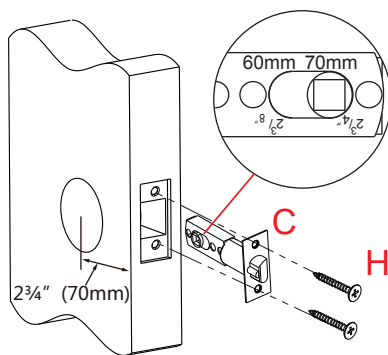
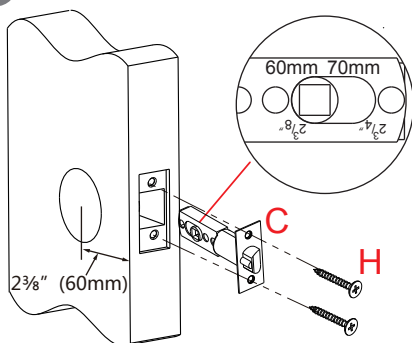

- Note: Adjust 60mm(2.36in) or 70mm(2.75in) according to the door hole.

Step 3 Confirm handle's direction

This handle lock is in right open direction when leaving the factory. Only 3 steps to turn the handle to left open direction.

Step ①. Loosen the screw with the "Allen key".

Step ②. Rotate the handle 180°

Step ③. Tighten the screw

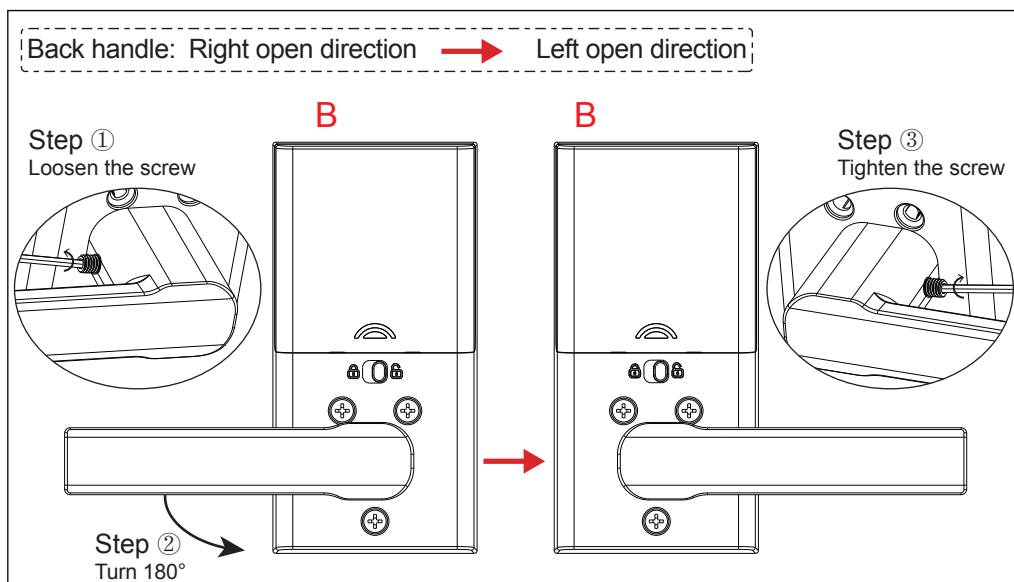
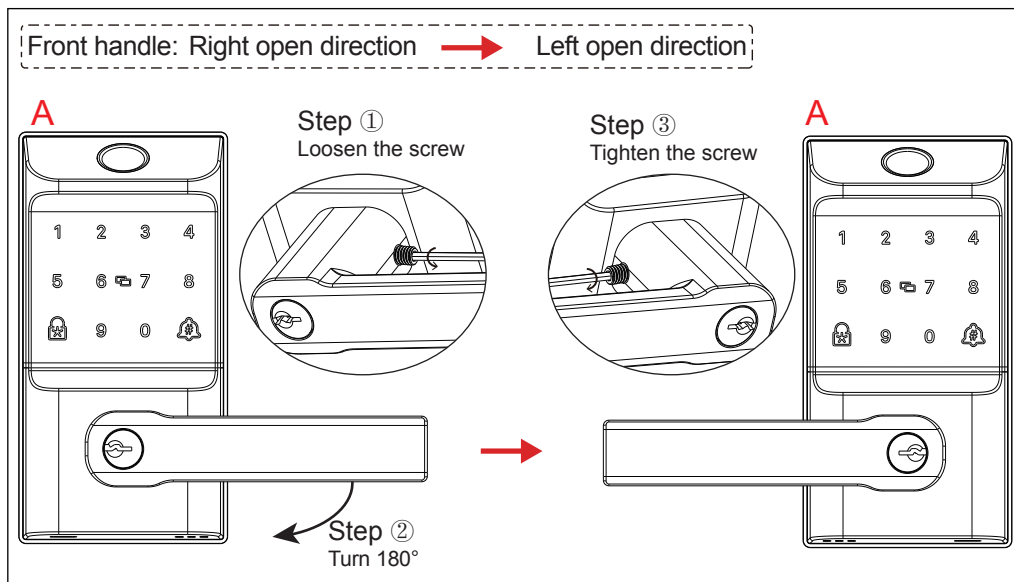

Step 4 Install outdoor unit (A) , part 1

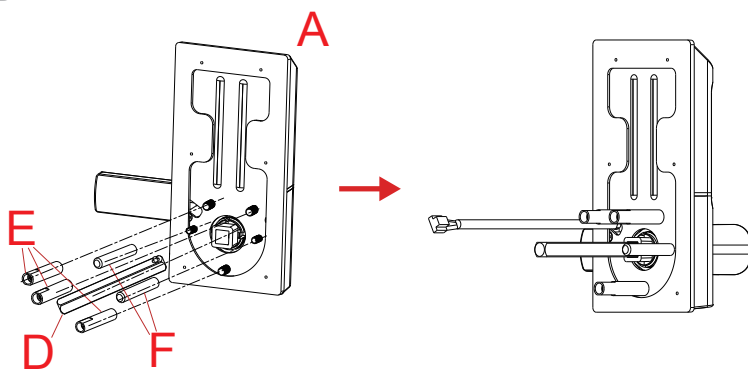

Step 5 Install outdoor unit (A) , part 2

Note: Cable passes over the latch.

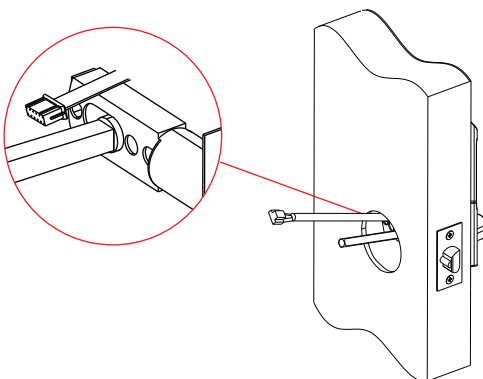

Step 6 Install indoor unit (B).

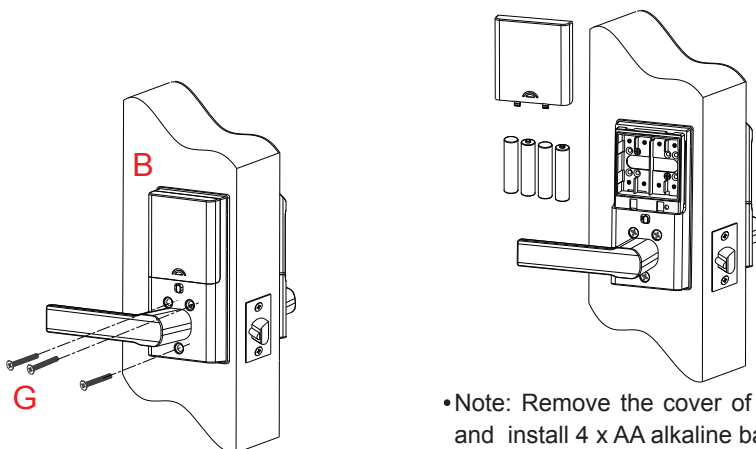

•Note: Remove the cover of batteries box and install 4 x AA alkaline batteries.

Step 7 Testing the lock by rotating back handle and using key (I).

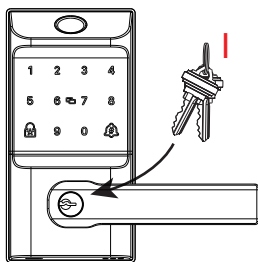

- Note: When the door is locked, the clutch is in idle position, the front handle can be turned. However, the door will remain locked.

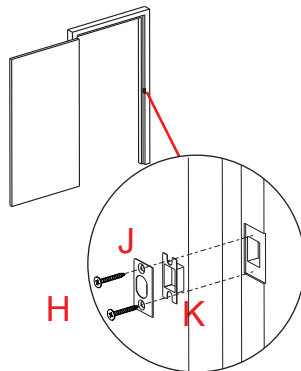

- Note: Mark and drill holes for strike plate.

Product Profile

Specifications

Material	Aluminium Alloy	Model NO.	2406B
Door thickness	35mm-55mm	Code Length	8~10 digits
Working Temperature	-20°C~70°C	Working Humidity	20%~80%RH
Working Power Consumption	<250mA	Static Power Consumption	<100uA
Power Supply	6V (4 x AA alkaline batteries)		
Unlocking Methods	Fingerprint, App, Card, Passcode & Mechanical Key		
User Capacity	1 App Administrator		
	Totally 254 password+card+fingerprintusers (100 fingerprint users at most)		



★ All specifications are subject to change without notice. All rights reserved.

Featureres

- **Safety:** There are multiple safety mechanisms within the lock.
 - a) **Auto Lock:** After an unlocking, this lock can lock automatically after 5 seconds.
 - b) **Keypad Locked:** After 4 failed passcode attempts, the keypad will shut down for 1 minutes before being able to try passcode again. Mechanical key and App unlocking/fingerprint/card can be used to unlock in this state.
- **Randomizer:** Before you enter your password, you can push some random numbers to prevent the password from being inferred based on the fingerprints on the frequently pushed numbers and from being seen by anyone nearby.
- **Battery Dead Alarm:** When batteries power is low, the lock will emit an alarm sound. You can also check the power level on App.
- **Emergency Power Supply:** Emergency power supply interface is on the bottom of outdoor unit: When battery is dead, you can use a backup battery connected by Type-C cable or a mechanical key to temporarily unlock the lock. After unlocking, please replace batteries ASAP.

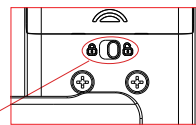
- **Real Time Record:** You can check unlock records on your App.
- **Secure Lock:** There is a secure lock switch on back panel. When secure lock is enabled, all fingerprint/card/password will be invalid. Mechanical key and App can still be used to unlock.



Slide to : Secure lock enable
Slide to : Secure lock disable

Pair the Lock with Tuya App

Important reminder: Pls pair the lock with Tuya App before using the lock.

Under initialization mode, the lock can be unlocked by any fingerprint/card/code.

1. Tuya App Installation and Account Registration

1.1. Scan the QR code to download, or search the "Tuya Smart" App from Google play store or Apple store on your phone.

1.2. Install and register an Tuya account with your phone number or email.



Scan the QR code to download the App

Note: If you have already registered an Tuya account, just log in with this account.

2. Pair the lock

2.1. Turn on the Bluetooth on your phone.

2.2. Open Tuya Smart App, touch the screen of lock to activate the keyboard.

2.3. App will automatically search and display device that can be added within about 20 seconds.

When you see the device(named "2406BTY-F"), click "Add", and then click "Done", the lock will be added successfully. You can rename the lock.

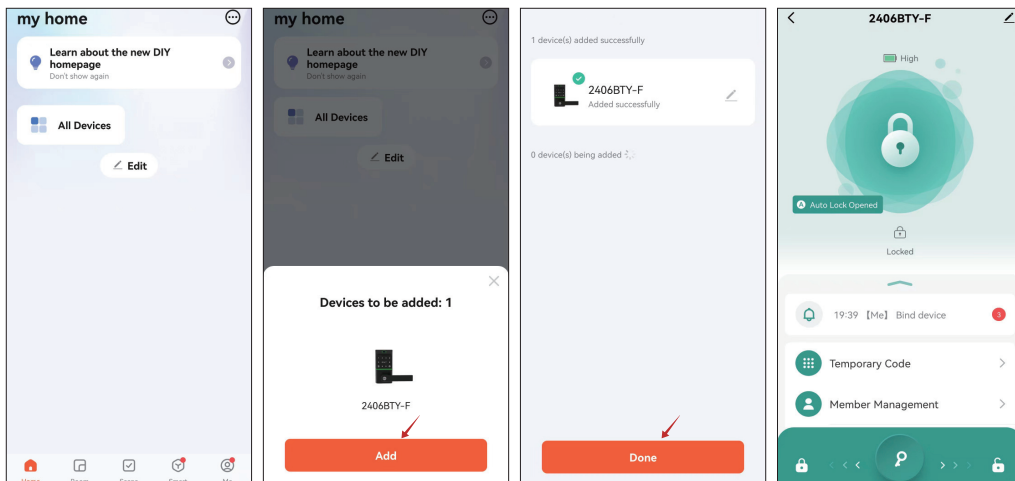

You can also add the lock manually: Open App - click "Add device" – "Camera & Lock" under "Electrical" bar – click the icon "Lock(BLE)" – "Next" – App will search the device that can be add and automatically add it, finally click "Done".



Note:

-After successfully pairing, you can set fingerprint/card/password on Tuya App.

-If you do not find the lock on App when pairing, you can reset the lock first (please see "Reset (System initialization)" method 2 on page 10).

-Once your phone App connects the lock, the lock will not be able to link to other accounts, unless you remove the lock from your App.

Lock's Operation on App

Enter operation page of lock on App, you can hold the icon  and slide to the icon  to unlock the lock. You can also creat “temporary code” on App, and use the temporary code to unlock. (After entering the code, pls press  to unlock.)

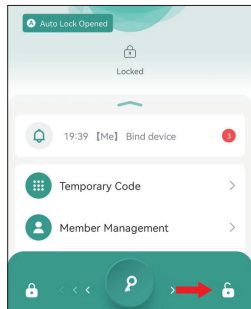

Creat Temporary Code as below:

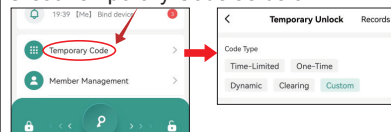

If creating Time-Limited/One-Time/ Dynamic password, you don't need to be near the lock. If creating custom passcode, you should be near the lock and turn on your phone's bluetooth.

1.Member Management

You can set fingerprint/code/card for yourself or new members in Member Management.

If you add new members and set fingerprint/code/card for them, please complete “home information” first (as shown below).

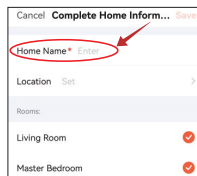
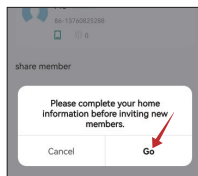
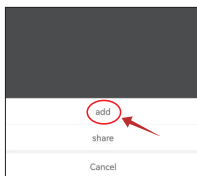
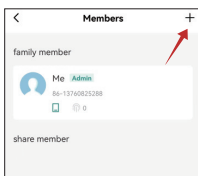
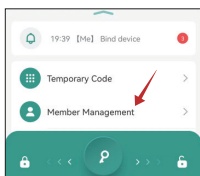

1.1. Set fingerprint/card/passcode for yourself(Admin)

You can set your own fingerprint/card/passcode by following steps:

Member Management - Click “Me” – Add fingerprint/Card/Code.

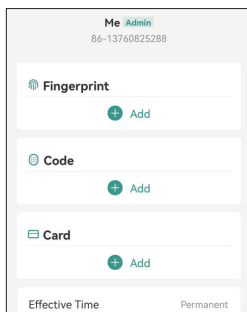
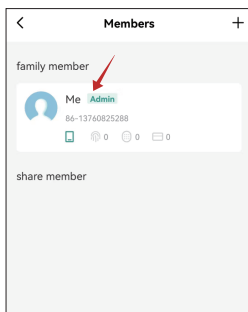
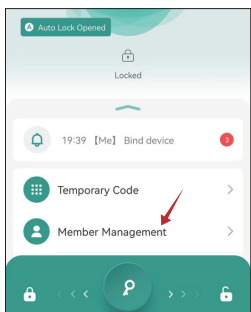

Warm tips:

1. Fingerprint adding: Please record multiple fingerprint angles when setting fingerprint. Keep your fingers clean and not too dry or wet when using fingerprint for unlocking.
2. Card adding: Please place the card on card sensor area which is on the middle of number keyboard of the lock when adding card or using card for unlocking.
3. Code adding: You should be near the lock and turn on your phone's bluetooth when setting passcodes. The length of passcode is 8-10 digits.(After entering the passcode, please press  to unlock.)

1.2. Set fingerprint/card/passcode for new members

1.2.1. Add new member

After completing home information, you can add new member as Administrator or Common Member in Family Role. If adding member as administrator, the member must have a Tuya account. For common member, the member does not need to have a Tuya account.

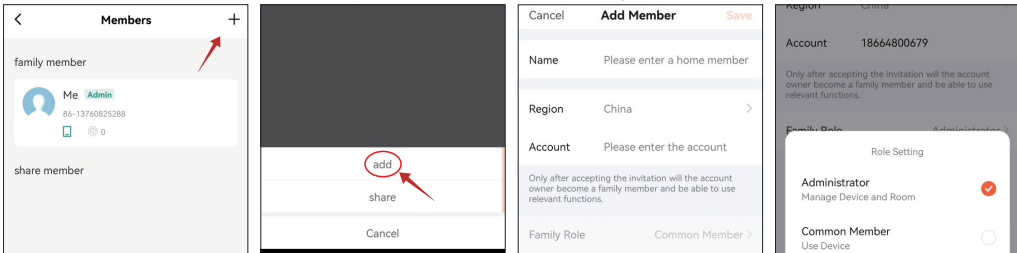

1.2.2. Set fingerprint/card/passcode for new members by following steps:

Member Management - Select the member – Add fingerprint/Card/Code.

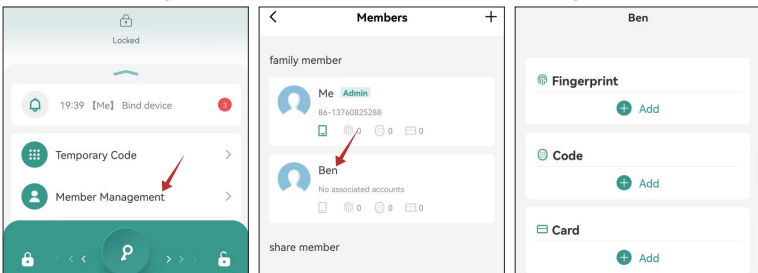

1.3. Share

You can share the permission of App unlock with others who must have a Tuya account. Effectiveness type of the permission can be permanent/single/limit. The person who has obtained this permission can unlock the lock with Tuya App.

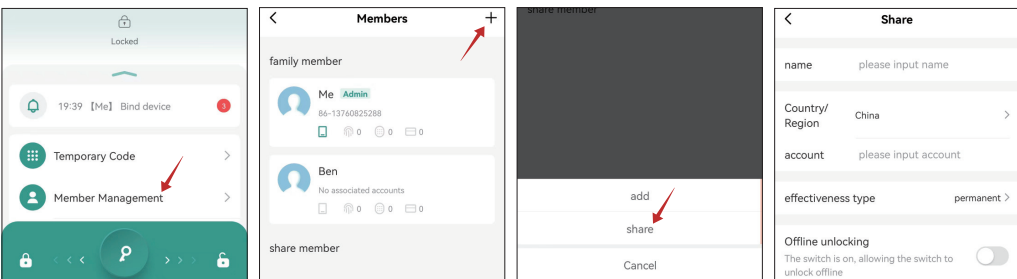

2. More Setting

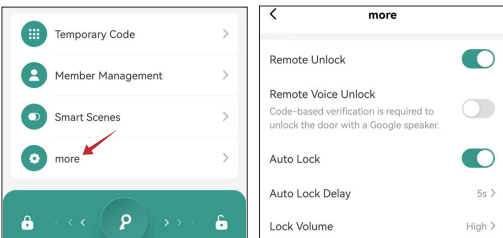



2.1. Remote Unlock: This function requires a Tuya gateway(purchase separately) and 2.4GHz WiFi network for use. You can unlock remotely via Tuya App by this function.

2.2. Remote Voice Unlock: When “Remote Unlock” function is enable with a Tuya gateway and WiFi network, you can voice unlock with a Google speaker(purchase separately) after code-based verification.

2.3. Auto Lock

Auto-lock is on for default. It means the lock will lock automatically 5 seconds after unlocking. You can set auto lock delay time from 1 second to 3 minutes.

If you turn off auto-lock on App, the lock enters passage mode, it won't lock automatically after unlocking. You can temporarily close the lock by following methods under passage mode.

Method 1: Hold the icon  and slide to the icon  on App to temporarily lock.

Method 2: Press  key on lock's keyboard to temporarily lock.

2.4. Lock Volume

There are 4 grades of volume: High(for default) / Normal / Low / Mute.

3. Record

To view the records of unlocking and setting.

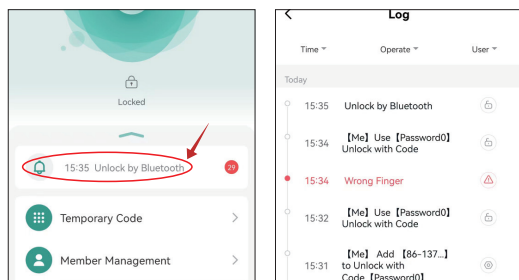

Reset (System initialization)

There are two methods to reset the lock.

Method 1: Remove the lock from App to reset (The phone should be near the lock.)

1. Enter the interface of the lock on App, and Click the icon  on the upper right corner.
2. Click “Remove Device” - Click “Disconnect and wipe data” - Click “Confirm”.

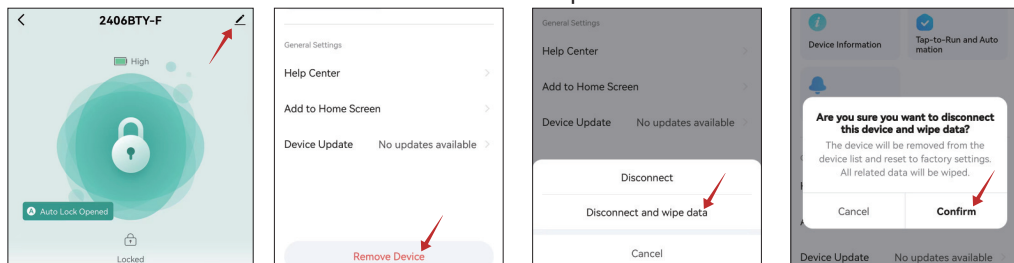

Method 2: Reset by pressing reset button

Use a small pin tool to press the reset button without releasing for about 6 seconds. When keyboard lights up, release the reset button and press  key on lock's keyboard, then voice prompts “Initialize successfully”.

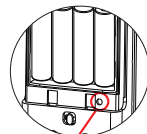

Reset button
(below battery box)

FCC Warning

This device complies with Part 15 of the FCC Rules. Operation is subject to the following two conditions:

(1) This device may not cause harmful interference, and (2) this device must accept any interference received, including interference that may cause undesired operation. NOTE 1: This equipment has been tested and found to comply with the limits for a Class B digital device, pursuant to part 15 of the FCC Rules. These limits are designed to provide reasonable protection against harmful interference in a residential installation. This equipment generates, uses and can radiate radio frequency energy and, if not installed and used in accordance with the instructions, may cause harmful interference to radio communications. However, there is no guarantee that interference will not occur in a particular installation. If this equipment does cause harmful interference to radio or television reception, which can be determined by turning the equipment off and on, the user is encouraged to try to correct the interference by one or more of the following measures:

- Reorient or relocate the receiving antenna.
- Increase the separation between the equipment and receiver.
- Connect the equipment into an outlet on a circuit different from that to which the receiver is connected.
- Consult the dealer or an experienced radio/TV technician for help.

NOTE 2: Any changes or modifications to this unit not expressly approved by the party responsible for compliance could void the user's authority to operate the equipment. The device has been evaluated to meet general RF exposure requirement. The device can be used in portable exposure condition without restriction.