

Bambu Lab **AMS 2 Pro**

Quick Start Guide 快速入门指南

Please review the entire guide before using the product.

* Safety notice: Do not connect to power until the assembly is complete.

使用本产品前，请仔细阅读本指南

* 安全提示：请勿在安装完成前通电

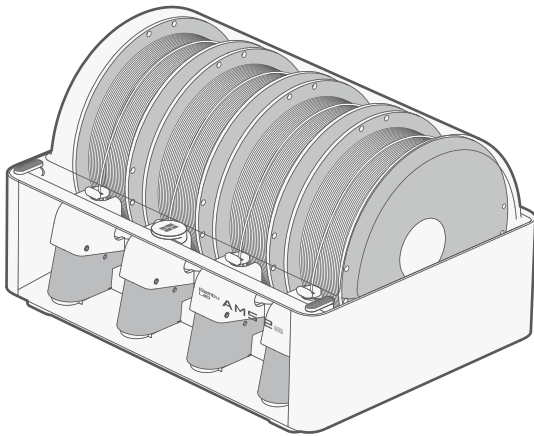

SA007



Unboxing Guide

Scan the QR code to access our online guides for detailed on how to unbox, assemble, set up the printer and start your first print.

bambulab.com/support/unboxing



Download Bambu Studio and Bambu Handy

Scan the QR code to download Bambu Studio and Bambu Handy, which allow you to remotely control your printer and monitor your prints in real time.

bambulab.com/download



Explore more cool models

Scan the QR code to visit MakerWorld, our 3D models community, where you can find a variety of free models, and create top-notch designs using powerful tools like MakerLab and Maker's Supply.

makerworld.com



Get help

Scan the QR code to visit our support center, contact technical support, and access more useful tutorials.

bambulab.com/support

Read before use



- For best results, we recommend using Bambu filaments, which have been rigorously tested for compatibility, safety, and stability with the AMS 2 Pro.
- To prevent the filament getting stuck, do not use flexible filaments such as TPU with a hardness level below 95A or damp PVA in the AMS 2 Pro.
- The AMS 2 Pro supports a spool width between 50 mm to 68 mm and a diameter between 197 mm to 202 mm. We recommend using plastic spools in the AMS 2 Pro. If filaments with cardboard spools are used, it is recommended to pair them with a spool adapter to reduce roll slipping and debris.
- For H2 series printers, the AMS 2 Pro's drying function can be powered directly by the 6-pin cable. X1 and P1 series printers require a Bambu Lab power adapter to power the drying function; otherwise, the drying function will not be available.
- During the filament drying process, the AMS 2 Pro removes moisture through external air circulation via the air inlets. Please ensure the air intake and vent are not blocked, to ensure optimum drying efficiency.

Component introduction

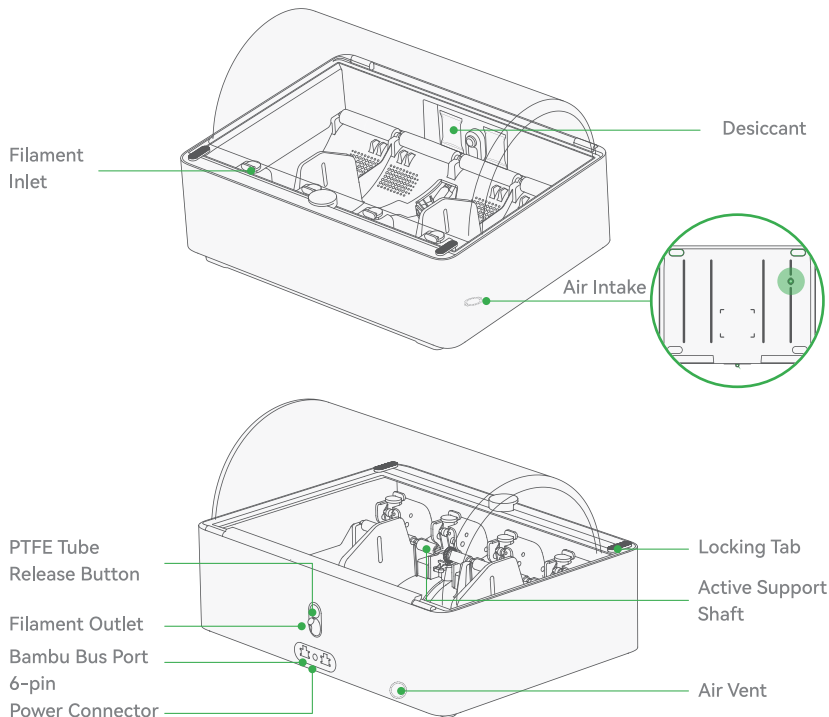

Included accessories

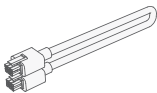

Bambu Bus
Cable 6-pin



Desiccant



PTFE Tube

Connect the AMS 2 Pro to H2 series printers

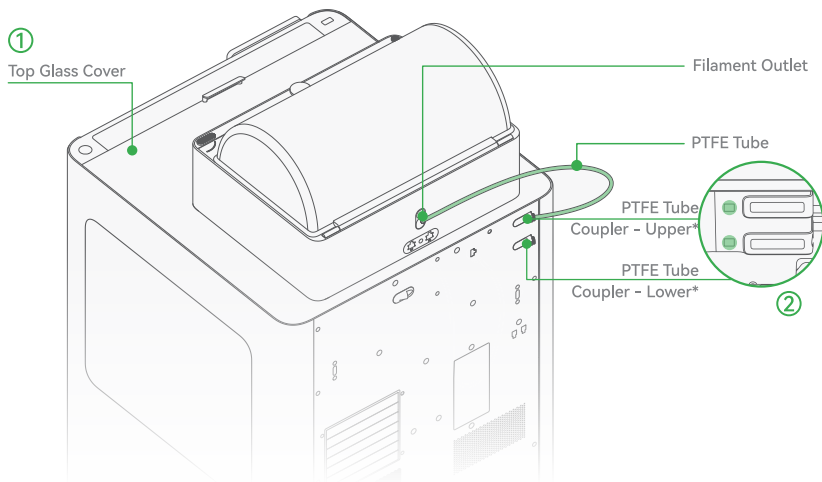

- ① Place the top glass cover on top of the printer.
- ② Insert the PTFE tube on the AMS 2 Pro's filament outlet into any PTFE tube coupler of the printer, and push the tube forward for approximately 10 cm until it stops (if you can see the PTFE tube from the window next to the buffer from the front of the printer, it is correctly inserted).

Connect the AMS 2 Pro to H2 series printers

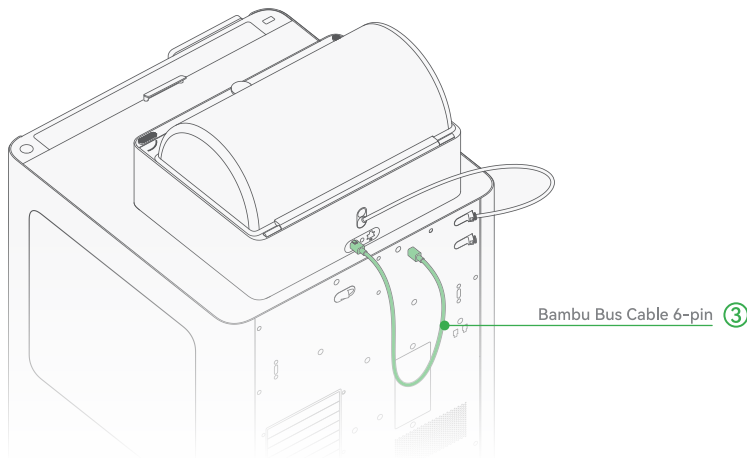

- ③ Take out the Bambu Bus Cable 6-pin from the AMS 2 Pro. Connect it to the printer and either 6-pin port of the AMS 2 Pro.

* The upper and lower PTFE tube couplers correspond to different hotends. Connecting the AMS 2 Pro to the upper coupler allows the right hotend to print in multiple colors, while connecting it to the lower coupler enables multi-color printing with the left hotend. Using two AMS 2 Pro units allows for both hotends to have multi-color capabilities.

Connect the AMS 2 Pro to X1 and P1 series printers

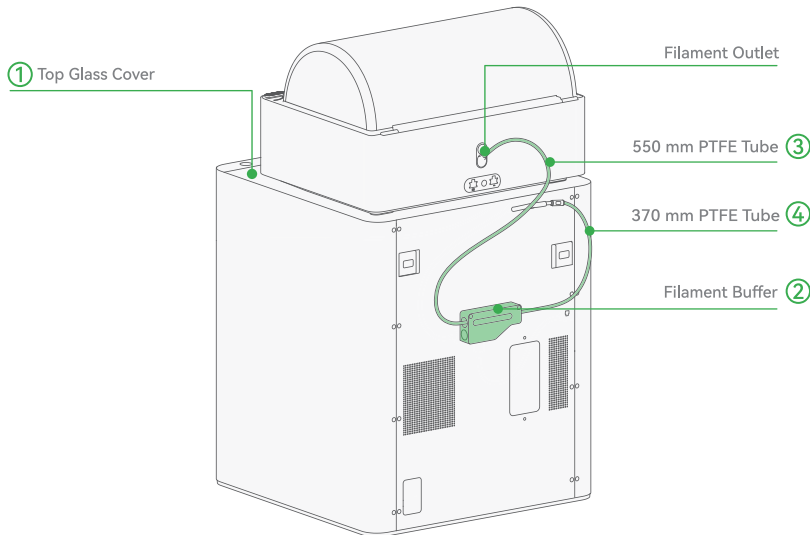

- ① Place the top glass cover on top of the printer.
- ② Use 2 M3*21.5 screws to fix the filament buffer to the printer.
- ③ Insert one end of the 550 mm PTFE tube to the filament outlet of the AMS 2 Pro, and the other end to the left of the filament buffer.
- ④ Insert one end of the 370 mm PTFE tube to the PTFE tube coupler of the printer, and the other end to the right of the filament buffer.

Connect the AMS 2 Pro to X1 and P1 series printers

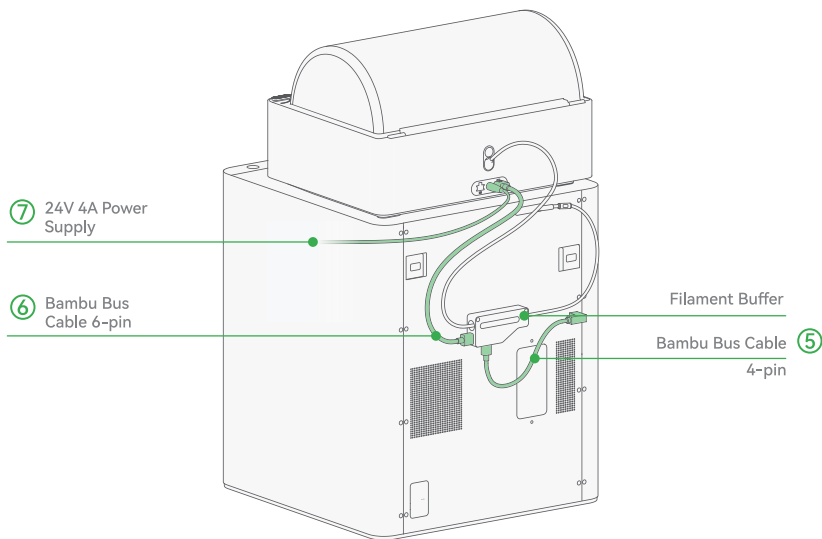

- ⑤ Connect the L-shape end of the Bambu Bus cable 4-pin to the printer, and the other end to the bottom the filament buffer.
- ⑥ Connect the one end of the Bambu Bus cable 6-pin to either 6-pin port of the AMS 2 Pro, and the other end to the left of the filament buffer.
- ⑦ Connect the 24V 4A power supply to the power connector of the AMS 2 Pro.

Remove the desiccant packaging material

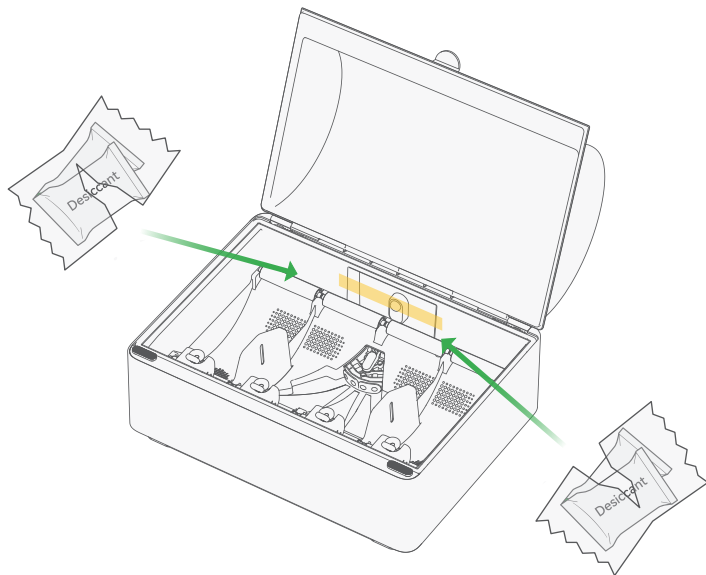

Remove the tape from the back of the AMS 2 Pro and take out the desiccant packs. Remove the outer plastic packaging material and install 2 packs of desiccant on each side of the empty space.

Load the filament in AMS 2 Pro

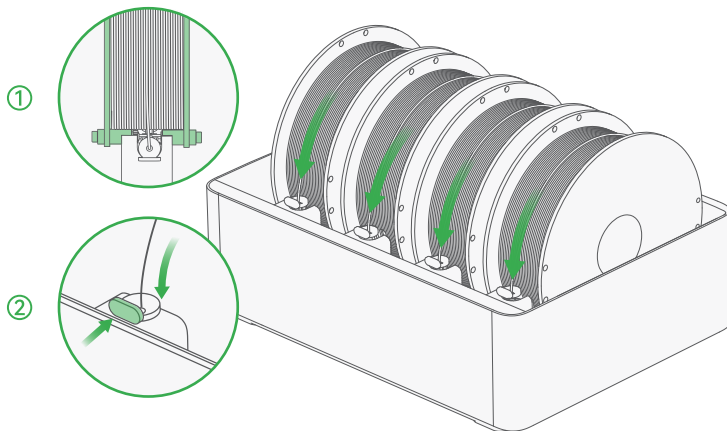

- ① Power on the printer and place a spool of filament in any of the four slots. Make sure the spool is correctly placed on the active support shaft.
- ② Push the feeder tab towards the spool, and insert the filament. The AMS 2 Pro will pre-load it after it is detected. When the feeder LED light is on, the AMS is ready to print.

How to use the AMS 2 Pro drying function

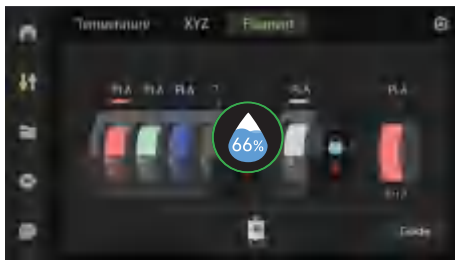

Tap  to go to the drying function screen. Select the type of filament to be dried, and set the drying temperature and duration. Then, tap **Start** to begin the process.

* For guidance on using the drying function of multiple AMS 2 Pro units at the same time, please go to wiki.bambulab.com/drying