

Instructions

- 1 English (1-5)
- 2 Français (6-10)
- 3 Deutsch (11-15)
- 4 Italiano (16-20)
- 5 Español (21-25)
- 6 بالعربية (26-30)
- 7 היברית (31-35)
- 8 한국어 (36-40)
- 9 日本語 (41-45)
- 10 Tiếng Việt (46-50)
- 11 繁體中文 (51-55)
- 12 مشكلة شاشة (56)
- 13 Common problem (57)

Device connection and introduction to the main page

1. Insert the device into the CarPlay interface of the original car, wait to enter the device interface

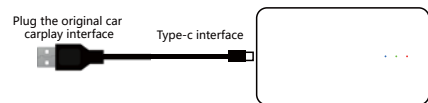

2. Main interface introduction

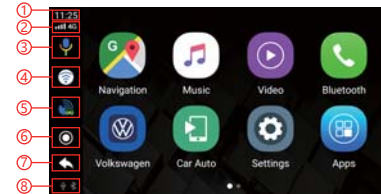

- ① Time ② signal status ③ Voice key ④ WiFi
⑤ GPS status ⑥ Home button ⑦ Return button ⑧ USB/Bluetooth connection status

Additional: Long press the Home button to enter the Android background, click and drag the APK to the left to split the screen

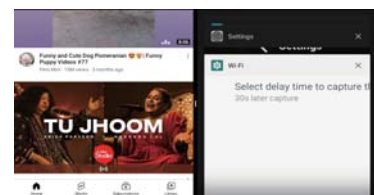

1

Device hardware parameters

CPU:	4-core A53	Storage:	2G/4G
Memory:	32G/64G	System:	Android 10
Working temperature:	-20°C--70°C	Working voltage:	5V

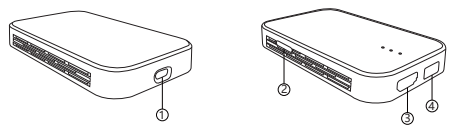

① Connect to the CarPlay port of the original car ② 4G card slot ③ HDMI output ④ USB port
WiFi version device does not have ② or ③ interface

Function settings

Main interface function path: Settings - Navigation path selection



2

Using the touch assistant

Wireless CarPlay interface

Touch assistant	It will be displayed in the third-party APP
Voice key	Click to open voice
Escape key	Click to exit CarPlay
Return key	Click to go back to the previous level

Application interface

Touch assistant	It will be displayed in the third-party APP
Voice key	Click to open voice
Home button	Back to Home page
Return key	Click to go back to the previous level

Wireless CarPlay connection

1. Click the phone icon to enter the CarPlay connection interface, use the Apple mobile phone to match the box Bluetooth, the box Bluetooth device name is: BT-XXXX

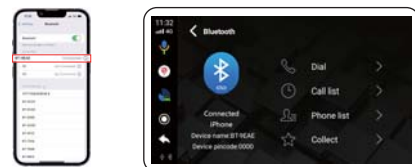

2. After the Bluetooth connection is successful, the mobile phone will pop up a CarPlay car window, click Use to enter the CarPlay interface

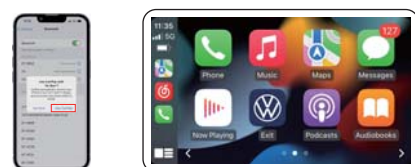

3

How to turn on WIFI in 5G frequency band(the network effect is more stable)

iPhone

Path: Settings - Personal Hotspot
Turn off maximum compatibility to use 5G band WIFI
(Phone can automatically connect to WIFI only in the personal hotspot interface)

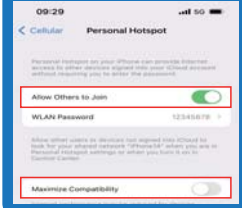

Android phone (for reference only)

Path: Settings - Hotspot and Tethering - WLAN Hotspot - Expand Compatibility

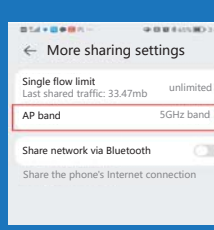

Bluetooth Internet access function (suitable for wireless CarPlay function)

iPhone

Path: Settings - Personal Hotspot - Turn On - Allow Others to Join

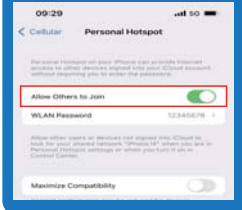

Android phone (for reference only)

Path: Settings - Personal Hotspot - Bluetooth Shared Network - On

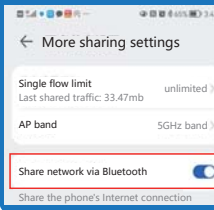

After the icon is displayed, you can use Bluetooth to surf the Internet
Only suitable for navigation, listening to music, not suitable for playing online videos due to Bluetooth bandwidth

4

Status of the lights

Blue: Power light

Green light: upgrade light

Red light: system light

(Slow flash: 4 seconds/time Fast flash: 0.5 seconds/time)

- During the software upgrade, the green light flashes slowly and the red light goes out
- After the software upgrade is completed, the green light and the red light flash rapidly at the same time
- Software upgrade failed Green and red lights are always on
- No software detected Green and red lights are off

System Upgrade

Download it to the U disk, do not decompress it, plug in the device, and remind you to update and then update, the process will return to the original car interface, do not touch it, do not power off, judge whether the upgrade is successful according to the flashing state of the light, and then drop the U disk after success. . Note: Be sure to pull out the U disk to restart!!

- Do not power off during the installation and upgrade process
- After the upgrade is complete, please delete the files in the U disk
- To check if it is new software, click Device: Settings - Version Information

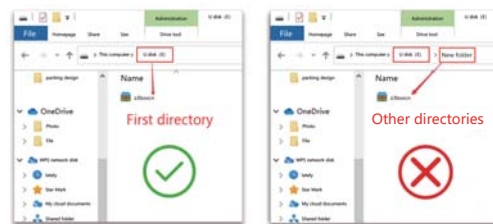

(If the GPS positioning signal is not good, you can purchase a GPS signal amplifier separately)

5

デバイスの接続とメインページの紹介

- デバイスをオリジナルのCarPlayインターフェイスに差し込み、デバイスインターフェイスに入るのを待ちます。

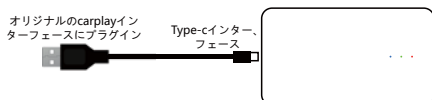

- メインインターフェイスの紹介

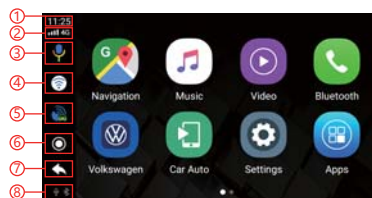

- 時刻
- 4G 信号の状態
- 音声ボタン
- WiFi
- GPS の状態
- Homeボタン
- Backボタン
- USB/Bluetooth接続状態

追加: Androidの背景に入るためにホームボタンを長押し、画面を分割するためにドラッグAPK左をクリックします

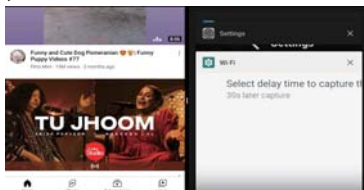

41

デバイスのハードウェアパラメータ

CPU:	4コアのA53	RAM:	2G/4G
メモリ:	32G/64G	システム:	Android 10
動作温度:	-20°C--70°C	動作電圧:	5V

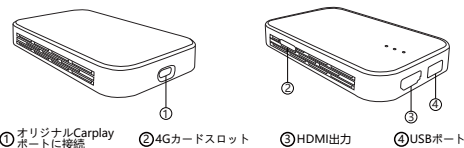

WiFi版デバイスで②または③のポートがないもの

機能設定

メイン画面の機能パス: 設定-ナビゲーションパスの選択

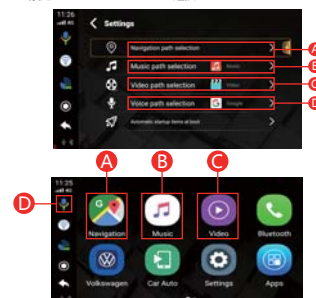

42

タッチアシスタントの使用

ワイヤレスCarPlayインターフェイス

	タッチアシスタント	サードパーティのAPPに表示されます
	音声キー	クリックして音声を聞きます
	エスケープキー	クリックしてCarPlayを終了します
	リターンキー	クリックして前のレベルに戻ります

アプリケーションインターフェイス

	タッチアシスタント	サードパーティのAPPに表示されます
	音声キー	クリックして音声を聞きます
	ホームボタン	ホームページに戻ります
	リターンキー	クリックして前のレベルに戻ります

ワイヤレスCarPlay接続

1. クリックオン電話アイコンをCarPlayの接続インターフェイスを入力するには、ボックスのBluetooth、ボックスのBluetoothデバイス名と一致するようにあなたのAppleの携帯電話を使用します: BT-XXXX

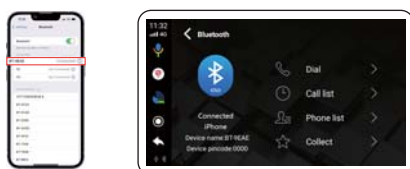

2. Bluetooth接続が成功した後、あなたの携帯電話はCarPlayウィンドウをポップアップし、それをクリックしてCarPlayインターフェイスを入力します。

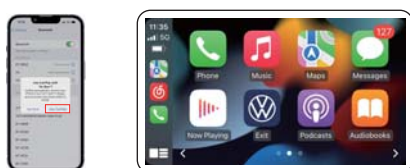

43

5G帯WiFiをオンにする方法 (より安定したネットワーク接続を得るために)

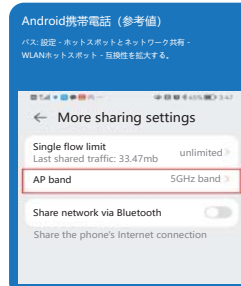
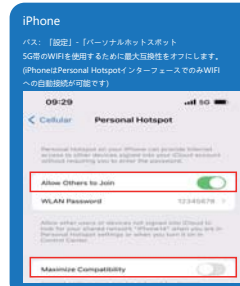

Bluetoothインターネット接続機能 (ワイヤレスCarPlay機能に代)

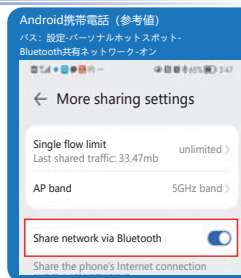
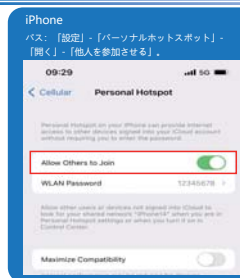

44

表示灯の状態

青: 電源ランプ (短い点滅: 4秒/回 早い点滅: 0.5秒/回)	緑: アップグレードライト	赤: システムランプ
ソフトウェアバージョンアップ中 緑色のランプがゆっくり点滅し、黄色のランプが消えます。 ソフトウェアバージョンアップ完了後 緑ランプと赤ランプが同時に点滅します。 ソフトウェアのアップグレードに失敗した 緑と赤のランプが点灯 ソフトウェアが検出されない 緑と赤のランプが消灯		

システムアップデート

Uディスクにダウンロードし、解凍しない。デバイスに接続し、更新に更新することを思い出させる。プロセスは元の車のインターフェイスに戻り、それに触れないでください。アップグレードが成功したかどうかを判断するために光の点滅状態によると、電源をオフにしない、その上にUディスクをドロップ成功しました。注意: 再起動する前に、Uディスクを抜かなければなりません

- インストールやアップグレードの際に電源を落とさないこと
- アップグレード完了後、Uディスク内のファイルを削除してください。
- 新しいソフトウェアであるかどうかを確認し、デバイスをクリックします: 設定 - バージョン情報

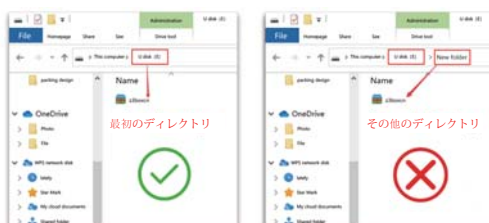

(GPSの測位信号が良くない場合は、別のGPS信号アンテナを購入することも可能です)

45

設備連接及主画面介紹

1. 將設備插入原車CarPlay介面，等待即可進入設備介面

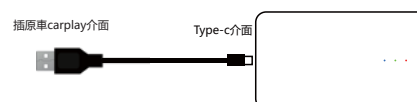

2. 主画面介紹



- ① 時間
- ② 4G信號狀態
- ③ 語音鍵
- ④ WiFi
- ⑤ GPS狀態
- ⑥ Home鍵
- ⑦ 返回鍵
- ⑧ USB/藍牙連接狀態

附加: 長按Home鍵 進入安卓後台，點擊APK左拖動即可分屏

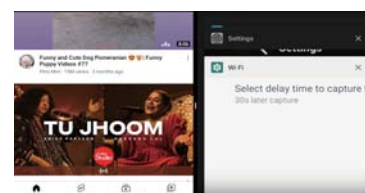

51

設備硬體參數

CPU:	4核 A53	運存:	2G/4G
記憶體:	32G/64G	系統:	Android 10
工作溫度:	-20°C--70°C	工作電壓:	5V

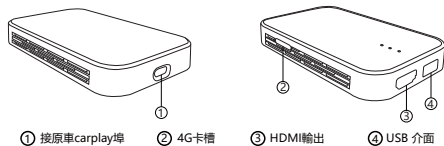

① 接原車carplay埠 ② 4G卡槽 ③ HDMI輸出 ④ USB 介面
WiFi版本設備不帶 (2) 或者 (3) 介面

功能設置

主介面功能路徑：設置-導航路徑選擇



52

觸摸助手使用

無線CarPlay介面

觸摸助手	在第三方APP會顯示
語音鍵	點擊打開語音
退出鍵	點擊退出CarPlay
返回鍵	點擊返回上一層

應用介面

觸摸助手	在第三方APP會顯示
語音鍵	點擊打開語音
Home鍵	返回主介面
返回鍵	點擊返回上一層

無線CarPlay連接

點擊電話圖示進入CarPlay連接介面，使用蘋果手機匹配盒子藍牙，盒子藍牙設備名稱：BT-XXXX



藍牙連接成功後手機會彈出一個使用CarPlay車載視窗，點擊使用即可進入CarPlay介面



53

如何打開5G頻段 WIFI (關閉效果更穩定)

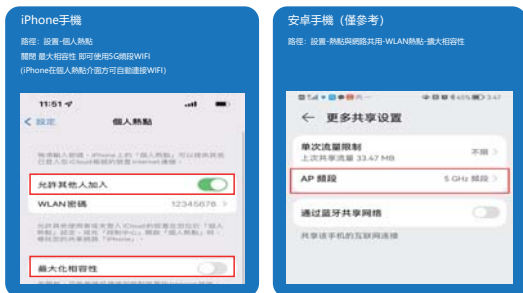

藍牙上網功能 (適合用無線CarPlay位置)

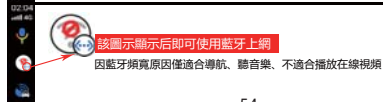

54

指示燈的狀態

- 藍色：電源燈 綠燈：升級燈 紅燈：系統燈 (慢閃：4秒/次 快閃：0.5秒/次)
- 軟體升級過程中 綠燈慢閃，紅燈常亮
- 軟體升級完成後 綠燈和紅燈同時快閃
- 沒有檢測到軟體 綠燈和紅燈常亮

系統升級

- 下載到U盤，不要解壓，插上設備，提醒你更新就更新，過程會返回原車介面，不要碰它，不要斷電，根據燈的閃爍狀態，判斷是否升級成功，成功後掉U盤就行。注意：一定要拔出來U盤才會重啟的!!!
- 安裝升級過程中請勿斷電
- 升級完成後請把U盤中的檔刪除
- 查看是不是新軟體，點擊設置：設置-版本資訊



(如GPS定位信號不好，可另選購GPS信號放大器)

55

Common problem

Why is it disconnected

1. Cancel the Bluetooth pairing between the mobile phone and the original car host
2. Whether the wire interface type/cable is in poor contact
3. Consider whether the original car host usb power supply is not enough, use the Y-shaped cable provided by our company
4. Device and car compatibility issues

How to use the Y-type wire?

TYPE-C is connected to the device. To Carplay is connected to the carplay interface of the original car; To 5V can be connected to the USB interface of the original car (the wrong plug will not enter the device)

U disk supported format and capacity

Supported formats: FAT32/NTFS
Support capacity: 8G/16G/32G/64G

What if the GPS signal is poor?

- GPS signal will be affected by the environment, check the signal value in Settings - Positioning
1. Take the box out of the antenra box and place the LOGO side up. View signal values in settings - positioning
 2. Purchase a GPS amplifier online and pick it up in the car
 3. Cars with sunroofs are easier to obtain signals

The product is stuck, what should I do?

Factory settings can be restored. Steps: Settings - More Settings - System-Advanced-Reset options-Erase all data (factory reset)

What should I do if the product becomes hot?

This product is an Android product, the working process is a lot of decoding, there will be a certain temperature, but please rest assured, this product does not have any flammable and explosive raw materials, please use it with confidence

Why does carplay sometimes not connect

1. Manually set up WiFi to connect carplay wifi
2. The phone does not click on "Use carplay"
3. Restart the phone

Why is there no signal when carplay WiFi is turned on?

Carplay works by reverse data transmission over WiFi, so it cannot use WiFi networks. But you can use 4G network or Bluetooth network sharing (4G network requires device support)

Carplay/android auto use Caton?

Settings - More Settings - Network and Internet - Hotspot and Tethering - WLAN Hotspot - Advanced - AP Band - 5.0GHz

Play music sound right?

Settings-factory settings (password: 0789)-sound mode-select mode 1, remember to restart after selecting. mode 1, mode 2, mode 3, you can try all, choose the best one.

Time not updating?

1. After the product is connected to satellite positioning, obtain the satellite time
2. Get network time from the Internet
3. More Settings - System - Date and Time - Automatically Determine Date and Time - On

2

FCC WARNING

This device complies with part 15 of the FCC Rules. Operation is subject to the following two conditions: (1) this device may not cause harmful interference, and (2) this device must accept any interference received, including interference that may cause undesired operation.

Any changes or modifications not expressly approved by the party responsible for compliance could void the user's authority to operate the equipment.

NOTE: This equipment has been tested and found to comply with the limits for a Class B digital device, pursuant to Part 15 of the FCC Rules. These limits are designed to provide reasonable protection against harmful interference in a residential installation. This equipment generates, uses and can radiate radio frequency energy and, if not installed and used in accordance with the instructions, may cause harmful interference to radio communications.

However, there is no guarantee that interference will not occur in a particular installation.

If this equipment does cause harmful interference to radio or television reception, which can be determined by turning the equipment off and on, the user is encouraged to try to correct the interference by one or more of the following measures:

-- Reorient or relocate the receiving antenna.

-- Increase the separation between the equipment and receiver.

-- Connect the equipment into an outlet on a circuit different from that to which the receiver is connected.

-- Consult the dealer or an experienced radio/TV technician for help.

To maintain compliance with FCC's RF Exposure guidelines, This equipment should be installed and operated with minimum 20cm distance between the radiator and your body: Use only the supplied antenna.