

User Guide

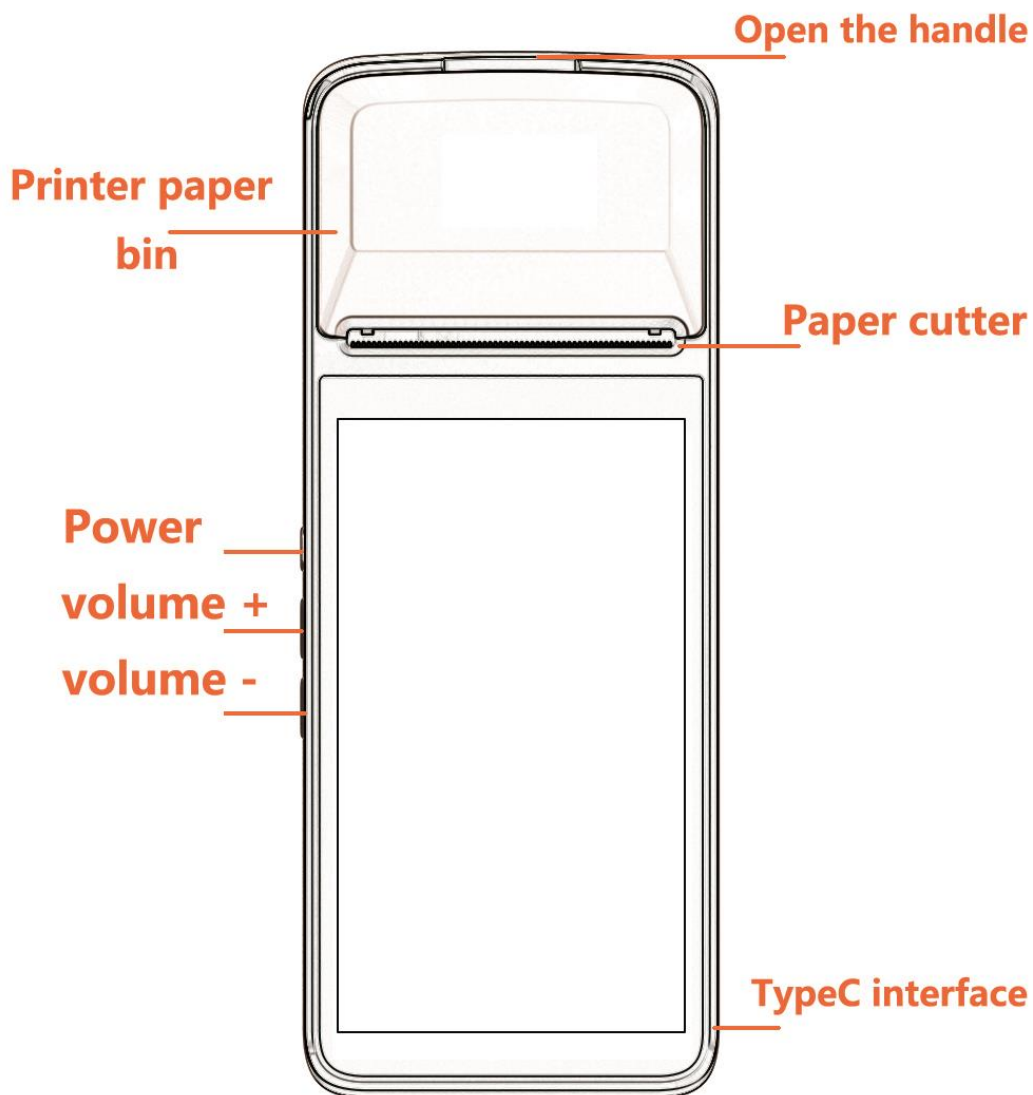

Power button

Press in a second : Light up the screen and lock the screen.

Press in seconds : In the Power off state, boot with long press 2-3 seconds ;

In the use state, press and hold for 2-3 seconds to select shutdown or restart.

In the dead state, press and hold down the side key - key + key power button one by one, and the device will restart for 10 seconds.

Volume

Volume up and down (this button can be set as a quick scan button, need application support).

Printer

Used to print receipts in the power on state.

return key

Click to return to the previous screen.

Home screen key

Tap to quickly return to the home screen.

Menu key

Click to quickly view the program running in the background; select the application and swipe to close the app.

TYPEC interface

Can be used to charge the device and debug the developer.

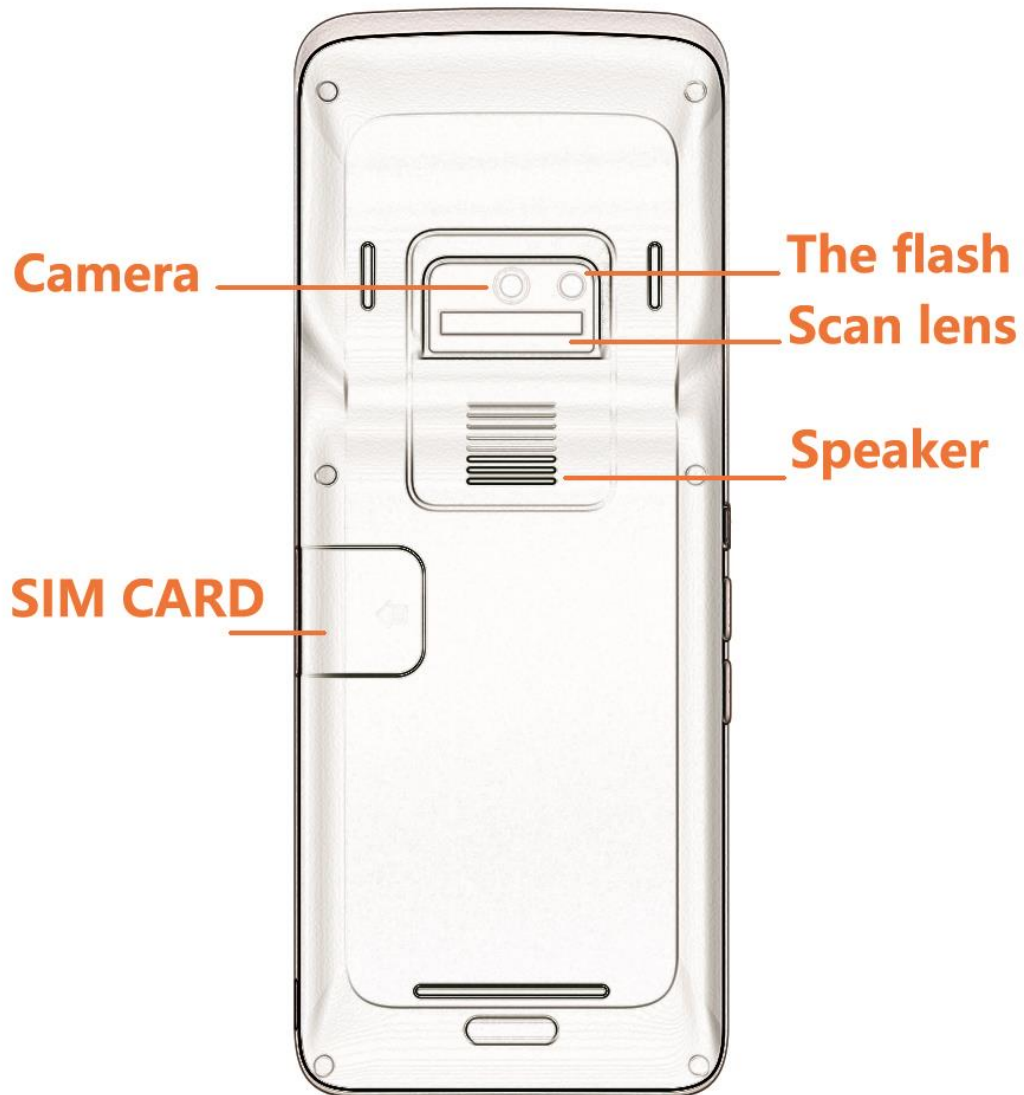

Camera

Can be used for QR code scanning and photographing.

Flash Light

Illuminate the surroundings while assisting in taking pictures.

Scanner

Support 1D code scan(optional), 2D (QR) code scan(optional), software support is required.

SIM card slot

Note: When inserting or removing the SIM card, be sure to make the machine in the off state. If it is plugged in or unplugged, it may cause the machine to malfunction.

- Pan open the SIM card cover;
- Insert/remove the SIM card in the direction shown;
- Close the back cover in the translation direction and tighten the back cover screws.

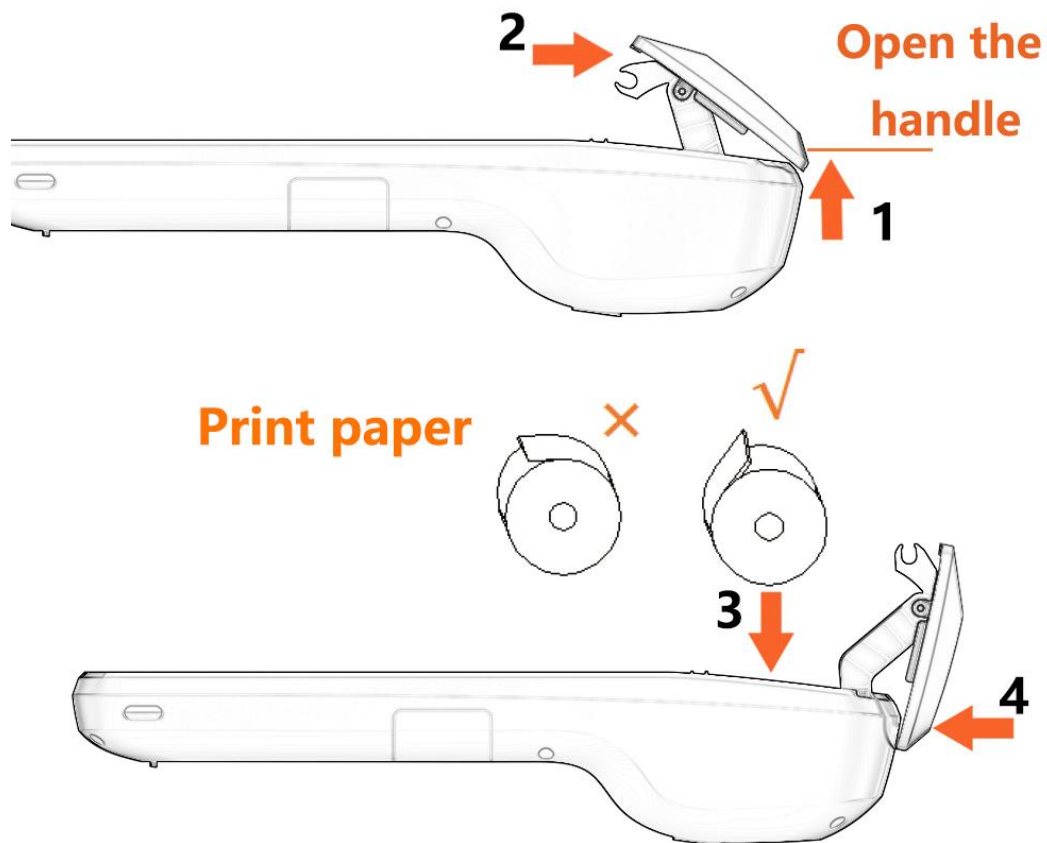

Print instructions

This machine supports 58mm thermal printing paper with the specification of $57 \pm 0.5\text{mm} \times \varnothing 40\text{mm}$

- Please open the paper tray by opening the lid (the top of the machine, as shown in Figure ①②). Do not open the paper bin forcibly to prevent the gear head gear from being worn.
- According to the direction shown, put the paper into the paper bin correctly, and pull out some paper to the outside of the paper cutter (as shown in Figure ③);
- Press firmly on the middle of the flip cover, cover the paper compartment cover, and the paper is installed (Figure ④).

note:

1. If the print content is blank, check if the direction of the paper roll is reversed;
2. For the selection of thermal paper, please refer to the certified manufacturer of the company;
3. The flip cover is not fastened, which may result in failure to print properly;

Charging and battery description

This unit only supports TypeC cable charging.

- Plug the 5V adapter into the mains outlet;
- Connect the USB cable to the machine's USB interface to charge the machine;
- Charging while the power is on, the battery icon at the top of the screen will change to the charging icon;
- Charging is in the off state, it will enter the charging mode, and the charging icon will be displayed in the middle of the screen;

·If the charging icon does not appear, check if the USB interface is plugged in.

Battery Description / Precautions

·This machine is equipped with a 8.4V large capacity lithium battery. Do not disassemble by yourself.

·To protect the battery life, it is recommended to charge it regularly. Do not wait until the used up.

Minimalist setting

Turn on smart business equipment in few steps

①3G/4G Set, in the off state, insert the corresponding 3G/4G card, and then turn it on. (Please read the technical specification sheet for card support details)

②Press and hold the power button for 2-3 seconds, the screen will light up, enter the first boot interface, and follow the prompts.

This machine can choose 2 internet modes.

①WIFI setting

Click the [Settings] button, then turn on the WLAN, enter the WALN search interface and wait for it to search and list the available WALN hotspots;

Click on the WLAN you want to connect to. If you choose an encrypted network, you need to enter the access code to connect.

②Mobile data settings

Pull down the system drop-down menu, click the [Mobile Data] icon, enter the mobile data settings page, and click the Open button. You can connect to the internet at this time.

How to download/use the app

Related applications can be in the networked mode, application installation needs to contact the company's after-sales support.

Common troubleshooting

The printer is not working

Confirm that the paper compartment cover is properly closed;

- Confirm that the appropriate paper is used and installed correctly;
- Please check if there is a 58mm*40mm thermal paper roll in the paper bin;
- When printing blank content, check if the paper roll is reversed.

Can't open the machine (eg: the electric quantity is too low)

Make sure the power button is pressed correctly for 2-3 seconds;

- Charge the machine correctly into the TYPEC cable for 30 minutes;
- Check if the screen shows the charging status normally.

What to do when it comes to the crash

Press and hold down the side key - key + key power button one by one, and the device will restart for 10 seconds.

Precautions

safety warning

Insert the AC plug into the AC outlet corresponding to the identification input on the accessory power adapter;

- It is strictly forbidden to use in places where there is any potentially explosive gas;
- Non-professionals should not open the power adapter at will to avoid danger;
- This is a Class A product. This product may cause radio interference in a living environment. In this case, the user may be required to take practical measures for interference;

- Do not disassemble, bump, squeeze or throw fire; If there is serious swelling, do not continue to use; Do not place the battery in a high temperature environment. Do not use the battery if it is soaked in water. There is a risk of explosion if the battery of the wrong model is replaced. Dispose of the used battery according to the instructions.

Practical application environment

- This product can print receipts and scan payment in the shopping mall scene
- This product can be used in indoor and outdoor scenarios through GPRS network
- This product can be used in indoor scenarios through WIFI network

Important safety instructions

The terminal is a handheld personal device like phone. The user should use the body to block the password for safety during the process of entering the personal password.

- When closing the paper compartment cover, be sure to press the paper compartment cover from the middle, do not press it off from both sides to avoid paper jam;
- Avoid installation or use during lightning, otherwise there is a danger of electric shock from lightning;
- When you notice an unusual smell, overheating or smog, please turn off the power immediately;
- The tearing knife is sharper, please don't touch it!

Suggest

Do not use it near water or in a humid environment to prevent liquid from falling into the terminal;

- Do not use in extremely cold or hot environments, such as near fire or lit cigarettes;
- Do not drop, throw or bend;
- Try to use it in a clean and dust-free environment to prevent small items from falling into the terminal;
- Do not use near medical equipment without permission.

Statement

The company is not responsible for the following actions:

- damage caused by use and maintenance without the conditions described in this guide;
- The company will not be responsible for any damage or problems caused by the option or consumables (original or approved products not provided by the company). No modification or change of product without the consent of the company;
- The operating system of this product supports the official system update. If the user sms a third-party OM system or modifies the system files by using a crack, it may cause system instability, as well as security risks and security threats.

Disclaimer

1. Due to product updates, some details of this document may not match the product, please refer to the actual product, the right to interpret this document belongs to the company. The right to modify this manual is subject to change without prior notice.

2. The operating system only supports the official upgrade. If the user swipes the non-official system by himself, resulting in security risks and losses, the user is responsible. (There may be risks: user information is stolen, text messages are automatically sent, your location is located, etc.

NOTE:

This equipment has been tested and found to comply with the limits for a Class B digital device, pursuant to part 15 of the FCC Rules. These limits are

designed to provide reasonable protection against harmful interference in a residential installation. This equipment generates uses and can radiate radio

frequency energy and, if not installed and used in accordance with the instructions, may cause harmful interference to radio communications. However, there is no guarantee that interference will not occur in a particular installation. If this equipment does cause harmful interference to radio or television reception, which can be determined by turning the equipment off and on, the user is encouraged to try to correct the interference by one or more of the following measures:

- Reorient or relocate the receiving antenna.
- Increase the separation between the equipment and receiver.
- Connect the equipment into an outlet on a circuit different from that to which the receiver is connected.
- Consult the dealer or an experienced radio/TV technician for help

Changes or modifications not expressly approved by the party responsible for compliance could void the user's authority to operate the equipment.

This device complies with Part 15 of the FCC Rules. Operation is subject to the following two conditions:

(1) this device may not cause harmful interference, and (2) this device must accept any interference received, including interference that may cause undesired operation.

RF Exposure Information:

FCC RF Exposure requirements: The highest SAR value reported under this standard during product certification for use next to the Body with the minimum separation distance of 0mm. This transmitter must not be collocated or operating in conjunction with any other antenna or transmitter.

This product is compliance to FCC RF Exposure requirements and refers to FCC website

<https://apps.fcc.gov/oetcf/eas/reports/GenericSearch.cfm> search for FCC ID: 2A6IY-5918

Product technical Configurations

mobile POS machine	
CPU	Spreadtrum A55 , 8-Core 1.6GHz
OS	Android 11
Memory	16GB+2GB , 32GB+3GB(optional)
Display	5.0 " HD , 1280x720 , IPS , G+FF features
NFC card reader	ISO/ICE 14443 Type A&B Standard card or Mifare card (optional)
Printer	High-speed 58 thermal printer with print speeds over 75mm/s Paper roll specifications: 58mm / 40mm
Wireless communication	GSM+WCDMA+TDD_LTE+FDD_LTE
WIFI	2.4G/, support IEEE 802.11 a/b/g/n
Bluetooth	Support BT3.0/4.2 BLE
Rear camera	Rear Camera: 5M, AF(Auto Focus), LED Fake flash, Current 150mA, 70 lumen
Barcode Scanner	Support 1D barcode scanning.
Battery	8.8V, 2550mAh Lithium ion polymer Battery Certification: CCC、 UN38.3、CB . Protection for over charging discharging
SIM card slot	Standard SIM card holder , Provide with multi band
Communication interface	Support Type - C
Charger	Input: AC: 100-240V, Output: 5V,2A
Size	Color box size : 210mm*91mm*78mm , 0.58kg Cartoon Box Size: 340mm*215mm*200mm , 6.25kg

Package

☒ R330P 1PC

☒ 1 charging adapter

☒ 1 TypeC connection cable

Warranty & Product certification

Product : _____

Name : _____

Product : _____

Model : _____

Product : _____

Code : _____

Purchase : _____

Date : _____

Warranty period : since the date of purchase,our company provides 12 months warranty service.

The free warranty is not available in the following cases;

Disassembled and repaired products without permission.

Product bar-code,fragile sticker damage and warranty card altered or defective.

Failure to operate the equipment in accordance with the instructions.

Man-made damage due to malfunction,scratches or breakage caused by irresistible factors.

Outside the warranty period.

Contact:

Company Address:

Contact Number: