

尺寸: 75X120MM

材质: 80G书写纸正反印 (风琴折后再对折)

wireless charger
QUICK START GUIDE
TX18

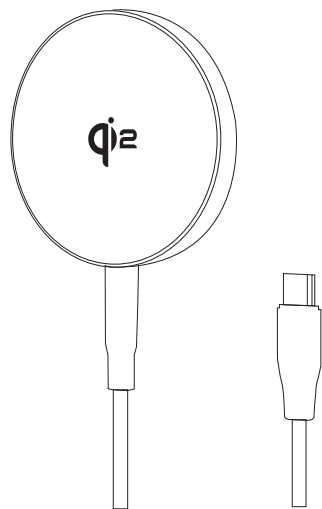

Product Specification:

- Input: 5V=3A, 9V=2.22A
- Output: iPhone12-15 15W, iPhone8-11 7.5W
- At 9V, No-Load Input Power Dissipation/9V: 0.5W MAX
- At 9V, No-Load Current/9V: 0.06A MAX
- Full-Load Charging Input Power Dissipation: 15W MAX

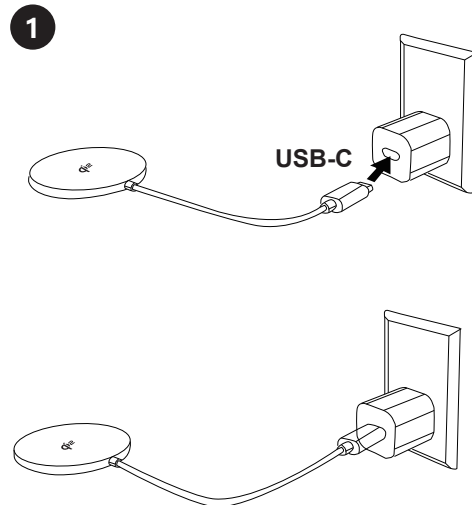

2 Work MagSafe® Compatible Devices

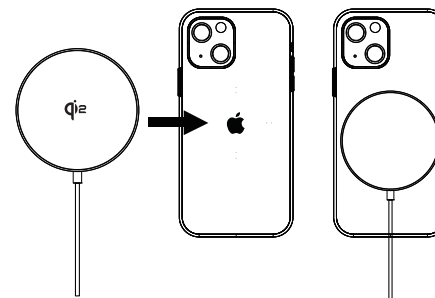

2 With Snap Adapter Applied to any Device

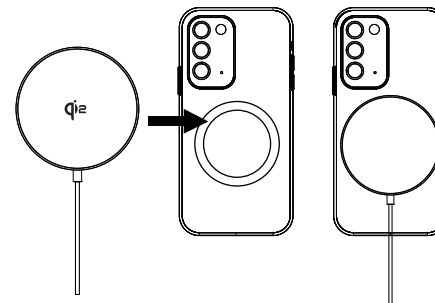

Please Note:

1. Please remove your phone case before charging if the thickness>5 mm
2. Only use certified PD 30W Charging Wall Adapter to charge the device
3. If your device can not be fully charged, this may due to high environmental temperature, please recharge after the temperature is lowered, Our charger has temperature control to safeguard your device when charging
4. Do not over squeeze or collide with the equipment.
5. Please do not place it too close to the magnetic card (ID cardbank card, etc.) with magnetic stripe or chip to avoid magneticcard failure.

Important Safety Instructions

- Do not store device in high-temperature environment, including heat caused by intense sunlight or other forms of heat.
- Do not place device in fire or other excessively hot environments. Exposure to fire or temperature above 212°F(100C) may cause explosion.
- Do not use the wireless charger in excess of its output rating. Over loading outputs above rating may result in a risk of fire or injury to persons.
- Do not expose the wireless charger to rain or snow.
- Do not modify, repair or disassemble the unity, if so, please contact the manufacturer, Switch off the wireless charger when not in use. The wireless charger will automatically switch off when disconnected from its wall charger.



Made In China