

TELESIN

2 in 1 Wireless Lavalier Microphone

二合一无线领夹麦克风

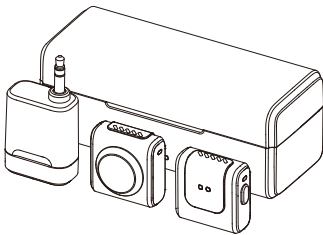

USER MANUAL/用户手册

Contents

目录

中文	1
EN	12

一、产品概述

感谢您购买本产品；

本产品为无线麦克风，可提供专业级别的录音输出，无需APP，即插即用，可应用在网络直播、视频Vlog拍摄、采访录音、视频教学等多种使用场景。

二、产品图示

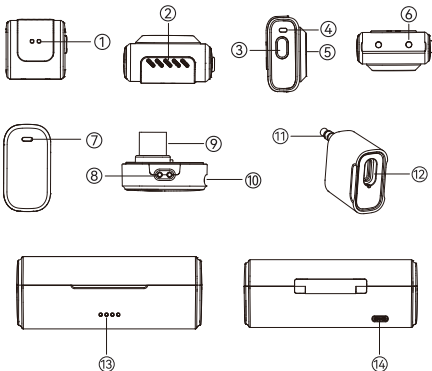

发射器

- ① 指示灯
- ② 收音口
- ③ ON/OFF开关
- ④ 防风套卡槽
- ⑤ 磁扣
- ⑥ 充电触点

充电仓

- ⑬ 电量指示灯
- ⑭ 充电接口

接收器

- ⑦ 指示灯
- ⑧ 充电触点
- ⑨ TYPE-C插头
- ⑩ 充电接口（支持为手机等设备充电）
- ⑪ TRS转接头（兼容相机等3.5mm接口设备）
- ⑫ TYPE-C接口

三、手机收音操作步骤

1.连接手机

- 将接收器（TYPE-C接口）插入手机。

注：OPPO/VIVO/IQOO/Realme等品牌手机需在设置中搜索"OTG" 并开启供电功能。

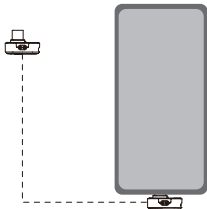

2. 开机配对

- 取出发射器，长按ON/OFF键3秒至指示灯闪烁，表示开机成功。

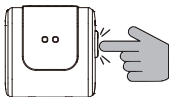

3. 开始收音

- 发射器与接收器指示灯常亮时，打开手机直播/视频APP即可收音。

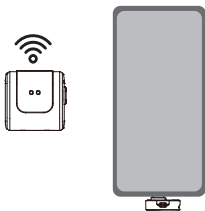

4.边充边用

- 手机电量不足时，可插入接收器的充电接口为手机充电

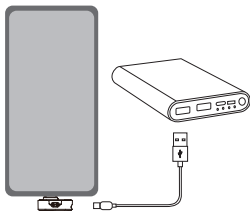

四、相机收音操作步骤

1.连接相机

- 将接收器的TYPE-C头插入TRS转接头，组成完整的TRS接收器。
- 将组装好的TRS接收器插入相机的3.5mm接口，此时接收器指示灯闪烁。

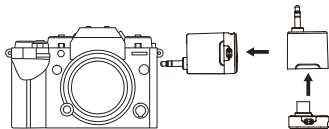

2. 开机配对

- 取出发射器，长按ON_OFF键3秒至指示灯闪烁，表示开机成功。

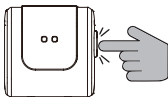

3. 开始收音

- 当发射器与接收器的指示灯均保持常亮时，表示设备已成功连接，相机可正常收音。

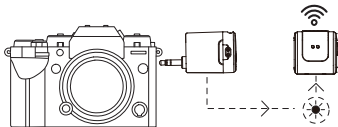

五、产品功能和操作说明

功能/状态	按键操作	指示灯状态
发射器		
开机	长按ON_OFF键3秒/出仓自动开机	蓝绿灯交替闪烁
关机	长按ON_OFF键3秒/入仓自动关机	所有灯灭
静音	双击ON_OFF键开启/关闭	开启：绿灯呼吸， 蓝灯常灭 关闭：绿灯常亮， 蓝灯常灭
降噪	单击ON_OFF键开启/关闭	开启：蓝灯常亮， 绿灯常亮 关闭：蓝灯常灭， 绿灯常亮
恢复出厂设置	长按ON_OFF键8秒恢复出厂设置	蓝绿灯交替闪烁
超时机	等待连接，3分钟未连接自动关机	蓝绿灯交替闪烁
充电	入仓自动充电	充电中：蓝灯呼吸 充满后：蓝灯灭
低电量	/	蓝灯每间隔10秒闪一次

接收器

开机	插入手机/相机端口自动开机 或出仓自动开机	蓝绿灯交替闪烁
关机	拔出手机/相机端口自动关机 或入仓自动关机	指示灯熄灭
配对	开机自动进入配对状态	蓝绿灯交替闪烁
未连接	持续工作，无自动待机	蓝绿灯交替闪烁
已连接	/	绿灯常亮
充电	入仓自动充电	充电中：蓝灯闪烁 充满后：蓝灯熄灭
低电量	/	蓝灯每间隔10秒闪一次

充电仓

充电	插入充电线	指示灯依次闪烁， 充满后常亮
电量指示	发射器和接收器放入充电仓	每颗灯代表25% 电量

六、规格参数

参数类别	技术规格
频率响应	20Hz~20kHz
采样率	32KHz/24bit
声音延时	≤30ms
信噪比	58dB
MIC灵敏度	-36±2dB
传输距离	≥30米
MIC指向性	全指向性
传输方式	蓝牙
降噪支持	支持
输入参数	5V --- 1A

充电温度	0~45℃
工作温度	-10~45℃
尺寸/重量	接收器 48.5×25.8×14mm / 10.5g
	接收器 25.9×16.4×14mm / 3.25g
	发射器 26.7×26.4×14.1mm / 9.8g
	充电仓 95.5×38mm / 64.17g
电池容量	接收器 3.7V / 70mAh (≥5.5小时)
	发射器 3.7V / 90mAh (≥7.5小时)
	充电仓 3.7V / 800mAh (充电仓可充电3次)
充电时间	TRS接收器 ≤1.5小时
	发射器 ≤1.5小时
	充电仓 ≤3小时

七、包装清单



①



②



③



④



⑤



⑥



⑦



⑧

- ① 相机TRS转接头*1
- ② Type-C接收器*1
- ③ 发射器*2
- ④ 防风套*2
- ⑤ 磁扣*2
- ⑥ 磁夹*2
- ⑦ 充电线*1
- ⑧ 充电仓*1

八、安全提示

- 本产品属于精密仪器，请避免使用时掉落，碰撞或者承受重击
- 请勿将本产品放置在有腐蚀性化学物品的地方，避免产品受到腐蚀，被腐蚀可能引起产品故障
- 请使用软布，干布清洁本产品
- 请勿将本产品放置在温度过高的地方，高温可能导致产品内部电池受损或爆炸
- 请勿自行拆解和维修机器
- 此说明书依据本公司严格测试后制定，设计和规格如有变更，恕不另行通知

九、免责声明

请仔细阅读本声明，一旦使用本产品，即视为对本声明的全部认可和接受。每次使用前，请仔细检查产品，若出现破损、变形，请勿使用。使用本产品，就意味着您认可并同意，您将对使用本产品的行为和可能产生的后果负全部责任。您承诺仅会出于正当合法的目的使用本产品。您理解并同意，对于直接或间接因使用本产品而造成的滥用、不利影响、损害、伤害、惩罚或者其他法律后果，泰迅数码有限公司（以下简称“Telesin”）将不承担任何责任。用户应遵循包括但不限于本文提及的使用注意事项。在国家法律法规范围内，本承诺解释权、修改权归 Telesin 所有。

泰迅保修期从您收到货物后的当日起计算，享有 6 个月保修服务。

1.Product Overview

Thank you for purchasing this product.

This wireless microphone delivers professional-grade audio output, requiring no app—simply plug and play. It is suitable for various scenarios, including live streaming, vlog recording, interviews, lectures, and more.

2.Product Diagram

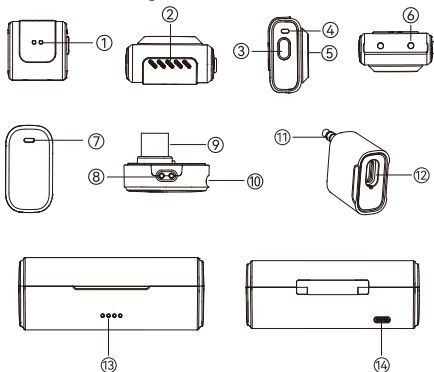

Transmitter

- ① Indicator light
- ② Microphone
- ③ ON/OFF switch
- ④ Windshield slot
- ⑤ Magnetic clasp
- ⑥ Charging contacts

Charging Case

- ⑬ Power indicator
- ⑭ Charging port

Receiver

- ⑦ Indicator light
- ⑧ Charging contacts
- ⑨ Type-C plug
- ⑩ Charging port (supports charging mobile devices)
- ⑪ TRS adapter (compatible with cameras and other 3.5mm interface devices)
- ⑫ Type-C port

3.Mobile Device Setup

1. Connect to Mobile Device

- Insert the receiver (Type-C port) into your phone.

Note: For OPPO/VIVO/IQOO/Realme phones, enable "OTG power supply" in settings.

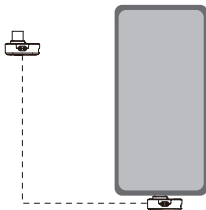

2. Power On & Pairing

- Remove the transmitter, press and hold the ON/OFF button for 3 seconds until the indicator flashes.

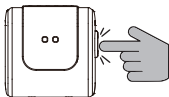

3. Start Recording

- When both transmitter and receiver indicators stay solid, open your streaming/video app to begin recording.

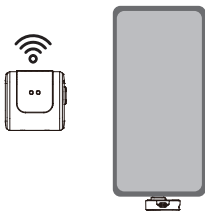

4. Charge While Using

- Use the receiver's charging port to charge your phone if needed.

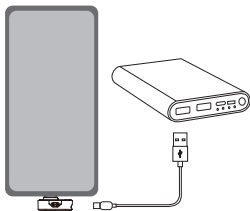

4.Camera Setup

1. Connect to Camera

- Insert the receiver's Type-C plug into the TRS adapter to form a complete TRS receiver.
- Plug the TRS receiver into the camera's 3.5mm port. The receiver's indicator will flash.

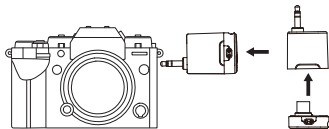

2. Power On & Pairing

- Remove the transmitter, press and hold the ON/OFF button for 3 seconds until the indicator flashes.

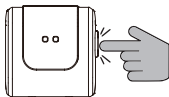

3. Start Recording

- When both indicators stay solid, the devices are connected and ready for recording.

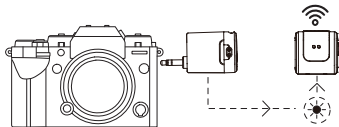

5.Functions & Operations

Function/Status	Operation	Indicator Status
Transmitter		
Power ON	Long press ON/OFF key for 3s / Auto-activate when removed from case	Blue-green alternate blinking
Power OFF	Long press ON/OFF key for 3s / Auto-shutdown when stored in case	All lights off
Mute	Double-click ON/OFF key (toggle)	Active: Green breathing light, Blue off Inactive: Green solid, Blue off
Noise Canceling	Single-click ON/OFF key (toggle)	Active: Blue solid + Green solid Inactive: Blue off + Green solid
Factory Reset	Long press ON/OFF key for 8s	Blue-green alternate blinking
Auto Shutdown (Timeout)	No connection for 3 minutes	Blue-green alternate blinking
Charging	Auto-charge when stored in case	Charging: Blue breathing light Full: Blue off
Low Battery Warning	/	Blue flashes every 10s

Receiver

Power ON	Auto-activate when connected to phone/camera or removed from case	Blue-green alternate blinking
Power OFF	Auto-shutdown when disconnected or stored in case	All lights off
Pairing Mode	Auto-enters pairing mode on startup	Blue-green alternate blinking
Unconnected	Waiting for connection (no auto-sleep)	Blue-green alternate blinking
Connected	/	Green solid light
Charging	Auto-charge when stored in case	Charging: Blue blinking Full: Blue off
Low Battery Warning	/	Blue flashes every 10s

Charging Case

Charging	Connect charging cable	Sequential blinking → Solid when full
Battery Level Display	With devices stored inside	Each LED = 25% capacity (e.g., 4 LEDs = 100%)

6.Specifications

Parameter	Details
Frequency Response	20Hz~20kHz
Sample Rate	32KHz/24bit
Audio Latency	≤30ms
Signal-to-Noise Ratio	58dB
MIC Sensitivity	-36±2dB
Transmission Range	≥30m
MIC Directivity	Omnidirectional
Connectivity	Bluetooth
Noise Reduction	Supported
Input Parameter	5V = 1A

Operating Temperature	0~45°C
Working Temperature	-10~45°C
Dimensions/- Weight	Receiver: 48.5×25.8×14mm / 10.5g
	Receiver: 25.9×16.4×14mm / 3.25g
	Transmitter: 26.7×26.4×14.1mm / 9.8g
	Charging Case: 95.5×38mm / 64.17g
Battery	Receiver: 3.7V / 70mAh (≥5.5h)
	Transmitter: 3.7V / 90mAh (≥7.5h)
	Charging Case: 3.7V / 800mAh (2x transmitter + 3x receiver charges)
Charging Time	TRS Receiver/Transmitter: ≤1.5h
	Charging Case: ≤3h

7.Package Contents



①



②



③



④



⑤



⑥



⑦



⑧

① Camera TRS Adapter*1

② Type-C Receiver*1

③ Transmitter*2

④ Windshield*2

⑤ Magnetic Clasp*2

⑥ Magnetic Clip*2

⑦ Charging Cable*1

⑧ Charging Case*1

8.Safety Tips

- This product is a precision instrument. Please avoid dropping, colliding or heavy impact during use.
- Do not place the product in areas with corrosive chemicals to prevent corrosion, which may cause the product to malfunction.
- Please clean the product with a soft, dry cloth.
- Do not place the product in excessively high temperatures, as this may damage or cause the internal battery to explode.
- Do not disassemble or repair the machine by yourself
- This manual has been prepared based on rigorous testing by our company. Design and specifications are subject to change without prior notice.

9.Disclaimer

Please read this statement carefully and by using this product you will be deemed to have acknowledged and accepted it in full. Please check the product carefully before each use and do not use it if damaged or deformed. By using this product, you acknowledge and agree that you are fully responsible for your actions and the possible consequences of using this product. You undertake to use this product only for legitimate and lawful purposes. You understand and agree that ("Telesin") shall not be liable for any misuse, adverse effects, damages, injuries, penalties or other legal consequences arising directly or indirectly from the use of this product. The user should follow the precautions including but not limited to those mentioned herein. To the extent Telesin reserves the right to interpret and modify this commitment within the limits of national laws and regulations.

The warranty period for TELESIN products begins 6 months on the day you receive the product.



Declaration of Conformity

FCC Caution

15.19 Labelling requirements.

This device complies with part 15 of the FCC Rules. Operation is subject to the following two conditions: (1) This device may not cause harmful interference, and (2) this device must accept any interference received, including interference that may cause undesired operation.

15.21 Information to user.

Any changes or modifications not expressly approved by the party responsible for compliance could void the user's authority to operate the equipment.

15.105 Information to the user.

Note: This equipment has been tested and found to comply with the limits for a Class B digital device, pursuant to part 15 of the FCC Rules. These limits are designed to provide reasonable protection against harmful interference in a residential installation. This equipment generates uses and can radiate radio frequency energy and, if not installed and used in accordance with the instructions, may cause harmful interference to radio communications. However, there is no guarantee that interference will not occur in a particular installation. If this equipment does cause harmful interference to radio or television reception, which can be determined by turning the equipment off and on, the user is encouraged to try to correct the interference by one or more of the following measures:

- Reorient or relocate the receiving antenna.
- Increase the separation between the equipment and receiver.
- Connect the equipment into an outlet on a circuit different from that to which the receiver is connected.
- Consult the dealer or an experienced radio/TV technician for help.

*RF warning for Portable device:

The device has been evaluated to meet general RF exposure requirement.
The device can be used in portable exposure conditions without restriction.

IC Statement

This device contains licence-exempt transmitter(s)/receiver(s) that comply with Innovation, Science and Economic Development Canada's licence-exempt RSS(s). Operation is subject to the following two conditions:

- (1) This device may not cause interference.
- (2) This device must accept any interference, including interference that may cause undesired operation of the device.

Any changes or modifications not expressly approved by the party responsible for compliance could void the user's authority to operate the equipment.

RF exposure statement:

The device was evaluated to meet general RF exposure requirements. The device can be used in portable exposure condition without restriction.

– French:

Cet appareil contient des émetteurs / récepteurs exemptés de licence conformes aux RSS (RSS) d'Innovation, Sciences et Développement économique Canada. Le fonctionnement est soumis aux deux conditions suivantes:

- (1) Cet appareil ne doit pas causer d'interférences.
 - (2) Cet appareil doit accepter toutes les interférences, y compris celles susceptibles de provoquer un fonctionnement indésirable de l'appareil.
- Tout changement ou modification non expressément approuvé par la partie responsable de la conformité pourrait annuler l'autorité de l'utilisateur à utiliser l'équipement.

Déclaration d'exposition RF:

L'appareil a été évalué pour répondre aux exigences générales en matière d'exposition aux RF. L'appareil peut être utilisé en condition d'exposition portable sans restriction.

www.telesin.com