

TELESIN

Diving Phone Remote Case

潜水摄影手柄

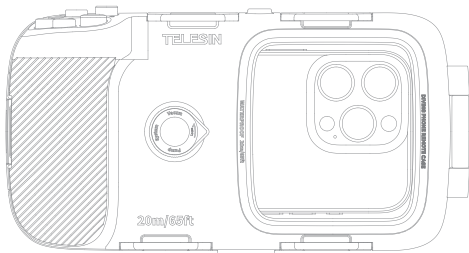

型号: P4-WTP-06

Product User Manual

产品使用说明书

Contents

目录

中文	-----	1
EN	-----	10

前言

感谢您购买Telesin产品。

重要提示

1. 在使用本产品前，请仔细阅读本手册。
2. 请妥善保管用户手册。将产品交给他人使用时，请务必附带本用户手册。
3. 请注意所有警告提示并遵循用户手册内的所有指令。
4. 在海水环境中使用产品后：
 - a. 取出手机并锁紧好产品后，将其放入清水(淡水)中浸泡10分钟；
 - b. 从淡水中取出产品后，在柔和流动的自来水中进行冲洗5分钟；
 - c. 清洗产品后，用干毛巾擦去产品表面上残留的水滴。请勿使用烘干机或炉子进行烘干；
 - d. 内壳不防水，请勿冲洗内壳，可能损坏电路！
5. 请将产品存放在干燥、通风良好的场所。
6. 请勿拆卸或损伤本产品，若变形或被破坏，请立即停止使用。
7. 在充电过程中，请勿用如毛巾、衣服之类的物品将产品掩盖，避免导致火警。
8. 请勿跌落或在高温、短路情况下使用本产品。
9. 请将本产品放置在儿童不能接触的地方。
10. 产品均通过了GB/T4208-2017和IEC60529-2013外壳防护等级标准IP68防水测试。极端水环境、不明液体环境中不建议使用本产品，在温泉、腐蚀性液体中请勿使用。
11. 产品仅适配7英寸以内的直板智能手机，蓝牙适配机型请参考功能规格列表。
12. 禁止带手机壳安装。
13. 本产品的防水深度为20米。

防水测试

1. 强烈建议第一次使用前，按照步骤检查防水壳的完整性！
2. 打开手机壳，放入一张纸巾，扣合好手机壳以及真空盖之后。
3. 放入水中完全浸泡30分钟。

4. 拿出来后请勿打开手机壳，先观察内部纸巾是否有被水浸湿。
5. 如纸巾干燥，则证明手机壳防水性能完好，如纸巾被浸湿，请联售后客服。

产品介绍

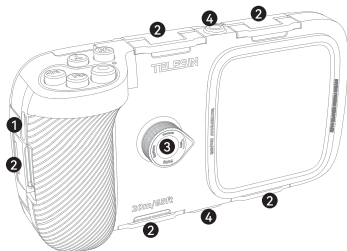

- ① 磁吸充电口
- ② 密封卡扣
- ③ 抽真空孔
- ④ 1/4螺孔



- ⑤ 拍摄键: 1. 长按: 2秒进行开关机
2. 单击: 开始/停止摄像
- ⑥ 调焦键1: 缩小 (广角)
- ⑦ 调焦键2: 放大 (长焦)
- ⑧ 模式键1: 1. 单击: 进行拍摄模式切换。
2. 长按2秒: 在息屏状态下快速进入相机
- ⑨ 模式键2: 1. 单击: 进行拍摄模式切换。
2. 长按2秒: 切换前后摄像头。

长按拍摄键2秒开机，点击蓝牙名称(TELESIN_SDC)进行蓝牙连接；如2分钟未连接则设备关机。苹果手机连接蓝牙后仅可使用拍摄键。首次使用其他按键功能，请进行如下操作：

进入设置-->辅助功能-->缩放-->缩放区域(全屏幕缩放)-->打开缩放。



* 打开“缩放”时，画面会放大，三指轻点两下恢复。其它设置不变。

如何安装

1. 手机放入潜水壳之前，请使用擦拭布清洁镜头，防水壳镜头玻璃内壁以及透明内壁。
2. 进入手机设置->显示与亮度->自动锁定->永不。
3. 请设置勿扰模式，避免消息触发跳转。
4. 点击进入系统相机。

5. 按图示打开5个密封卡扣。

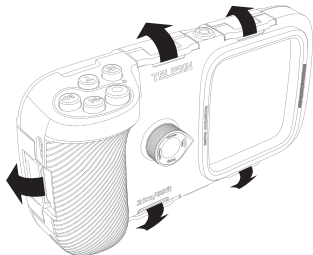

6. 打开透明盖板。装机时，需确保手机与手部干燥，避免水渍进入壳内，否则下水后会起水雾。

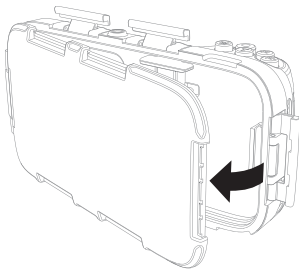

7. 手机镜头对准视窗后, 将卡进手机夹内。所有手机, 请贴紧图示边缘安装 (靠左), 若遮挡, 则根据实际情况向右适当微调手机位置。

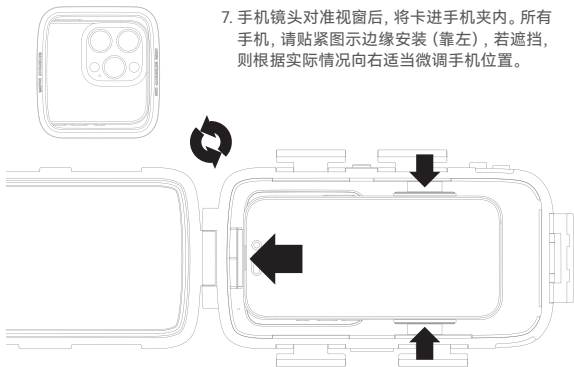

8. 锁紧5个密封卡扣。

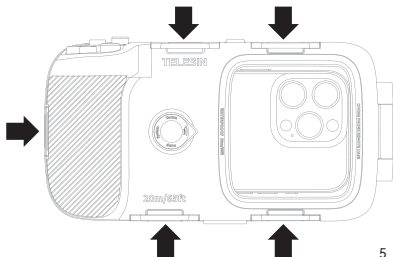

9. 按图示安装手绳。

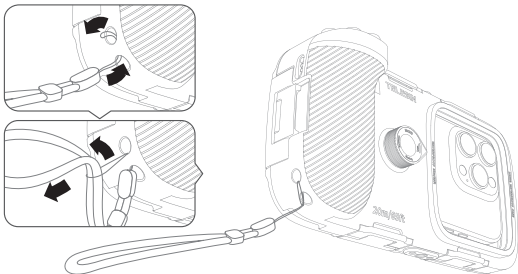

10. 旋开真空盖，将真空泵的橡胶头按压在打开的真空口上，然后进行抽气操作，需要抽气3到4次。最后拧上真空盖。



11. 使用结束后取出手机，请旋出真空盖，抠动黑色垫片泄压，放气后再解锁密封卡扣，否则将因负压吸附过紧而无法打开。

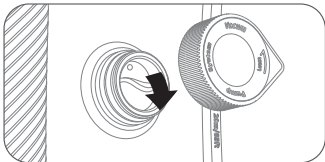
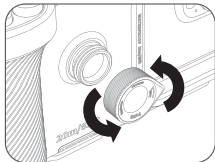

开关机

开机：长按遥控器2秒开机，指示灯闪烁，进入蓝牙配对状态。

关机：

1. 开机或休眠状态下，长按拍摄键2秒，指示灯快闪3下后熄灭，遥控器关机。
2. 休眠状态持续30分钟后，遥控器自动关机节电。
3. 开机后，2分钟内无配对则自动关机。

快速唤醒

屏幕状态	黑屏 所有状态
iOS& 部分安卓系统	长按模式键1
vivo	长按模式键1-先亮屏 再次长按模式键1
*三星及鸿蒙5.0系统暂不支持快速唤醒功能	

进入休眠状态

1. 开机配对后60分钟内无操作，自动进入休眠。
2. 助拍器与手机处于连接状态时，在手机里面手动取消配对、远距离断开、关闭手机的蓝牙，助拍器进入休眠状态，休眠状态持续30分钟后，遥控器自动关机节电。

休眠唤醒

休眠状态下，单击任意按键即可唤醒。

1. 休眠唤醒后，如上一次已配对手机蓝牙是打开状态，直接自动连接。
2. 如果上一次已配对的手机蓝牙关闭，指示灯开始闪烁2分钟后无配对，进入休眠状态，30分钟后关机。

充电

使用配套充电线进行充电，触点端连接潜水壳右侧充电口，将充电线的另一端连接到USB电源。



产品参数

产品型号:	P4-WTP-06
材质:	ABS+PC+铝合金
产品尺寸:	203.66mm*109.18mm*52mm
产品重量:	397g

充电时间:	2h
电池容量:	80 mAh
输入:	触点充电, 5V \approx 0.5A
电池容量:	80 mAh
电池标称电压:	3.7V
蓝牙适配机型:	苹果、安卓、鸿蒙机型等7英寸以内的智能手机

* 数据由Telesin实验室测定值, 但因客观环境改变, 数据略有偏差。

免责声明

请仔细阅读本声明, 一旦使用本产品, 即视为对本声明的全部认可和接受。每次使用前, 请仔细检查产品, 若出现破损、变形, 请勿使用。使用本产品, 就意味着您认可并同意, 您将对使用本产品的行为和可能产生的后果负全部责任。您承诺仅会出于正当合法的目的使用本产品。您理解并同意, 对于直接或间接因使用本产品而造成的滥用、不利影响、损害、伤害、惩罚或者其他法律后果, 泰迅数码有限公司(以下简称"Telesin")将不承担任何责任。用户应遵循包括但不限于本文提及的使用注意事项。在国家法律法规范围内, 本承诺解释权、修改权归Telesin所有。本产品保修期为6个月。

Preface

Thank you for purchasing Telesin products.

Notes

1. Read this manual carefully before using the product.
2. Keep the user manual in a safe place. Always include it when lending the product to others.
3. Follow all warnings and instructions in this manual.
4. After using the product in seawater:
 - a. Remove the phone, ensure the product is securely closed, and submerge it in clean water (freshwater) for 10 minutes.
 - b. Remove the product from the freshwater and rinse it under gentle running tap water for 5 minutes.
 - c. Dry the product with a towel after rinsing. Do not use a hairdryer or heater for drying.
 - d. The interior of the product is not waterproof. Do not rinse the interior; otherwise, the circuit will be damaged
5. Store the product in a dry, well-ventilated area.
6. Do not disassemble or damage the product. Stop using it immediately if it is deformed or damaged.
7. Do not cover the product with towels, clothing, or similar items during charging to prevent fire hazards.
8. Avoid dropping the product or using it in high-temperature or short-circuit conditions.
9. Keep the product out of reach of children.
10. The product has passed IP68 ingress protection testing per GB/T4208-2017 and IEC60529-2013 standards. Do not use it in extreme water environments, unknown liquids, hot springs, or corrosive fluids.
11. Compatible only with 7-inch or smaller straight smartphones. Refer to the feature specifications list for Bluetooth-compatible models.
12. Do not install the product over a phone case.
13. Waterproof depth rating: 20 meters.

Waterproof Test

Before first use, inspect the integrity of the diving house as follows:

1. After retrieval from water, do not open the diving house.
2. Visually inspect the internal test tissue for water ingress through the case seals.

Result validation:

1. If tissue remains dry, waterproof integrity confirmed.
2. If tissue shows moisture, immediate contact with customer service is required.

Operation Instructions



- ① Pogo Pin Charging Port
- ② Sealing Buckle
- ③ Vacuum Valve
- ④ 1/4" Inch Thread Hole



- ⑤ Capture Button Functions:
 1. Long Press (2 seconds): Power on/off the device.
 2. Single Press: Start/stop recording.
- Zoom Controls:
 - ⑥ Zoom Button1: Zoom out (wide-angle).
 - ⑦ Zoom Button2: Zoom in (telephoto).

- 8 Mode Button 1: 1. Single Press: Switch between shooting modes.
2. Long Press: Quick Camera Access from Lock Screen.
- 9 Mode Button 2: 1. Single Press: Switch between shooting modes.
2. Long Press: Switch between front and rear cameras.

Long press for 2 seconds to power on. Select 'TELESIN_SDC' in Bluetooth settings to pair with your device. iPhone: Bluetooth enables shutter only. First use of other functions requires enabling Zoom in Settings > Accessibility

Go to Settings–Accessibility–Zoom–ZoomRegion(FullScreen Zoom)–Turn on Zoom

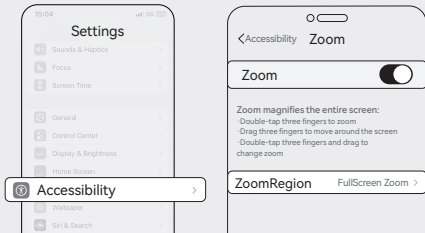

*** (Double-tap with 3 fingers to restore).**

How to Install the Diving House

1. Clean the Lens and Interior

Before inserting the phone into the diving house, use a cleaning cloth to wipe the lens, the inner glass surface of the Diving House, and the transparent interior.

2. Disable Auto-Lock

After connecting via Bluetooth, go to Settings → Display & Brightness → Auto-Lock (or Screen Timeout) → Set to "Never".

3. Enable Do Not Disturb Mode

Activate Do Not Disturb mode to prevent notifications from interrupting the camera operation.

4. Launch the Default Camera App

Open the system camera app directly to start capturing photos/videos.

5. Loosen the 5 sealing buckles as shown in Figure 1.

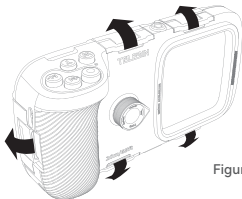

Figure 1

6. Open the transparent cover as shown in Figure 2. When installing the case, ensure the phone and your hands are dry to avoid water entering the case; otherwise, water exposure may cause fogging

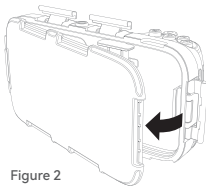
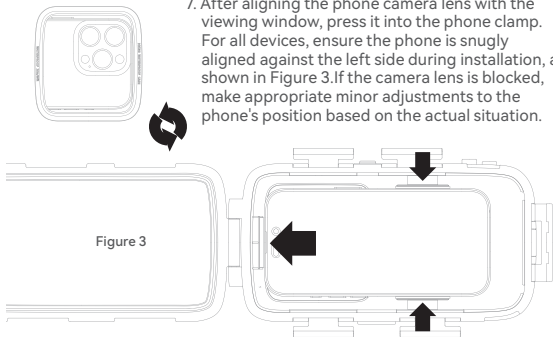

Figure 2

7. After aligning the phone camera lens with the viewing window, press it into the phone clamp. For all devices, ensure the phone is snugly aligned against the left side during installation, as shown in Figure 3. If the camera lens is blocked, make appropriate minor adjustments to the phone's position based on the actual situation.



8. Lock the five sealing buckles securely as shown in Figure 4.

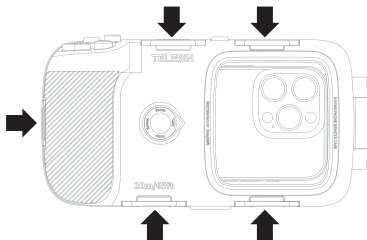

Figure 4

9. Attach the wrist strap according to Figure 5.

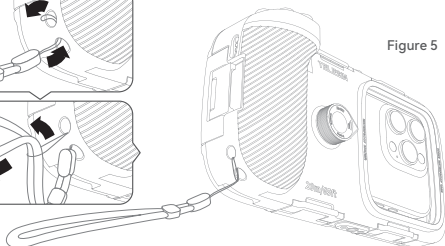
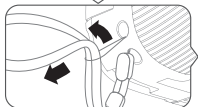
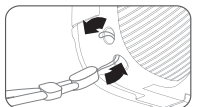

Figure 5

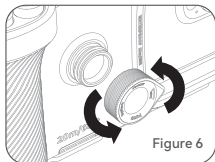

Figure 6

10. Unscrew the vacuum valve cover according to Figure 6.

11. Press the rubber sealing head of the vacuum pump onto the open vacuum port.

12. Activate the vacuum pump and perform 3-4 cycles of vacuum extraction.

13. Screw the vacuum valve cover back on securely.

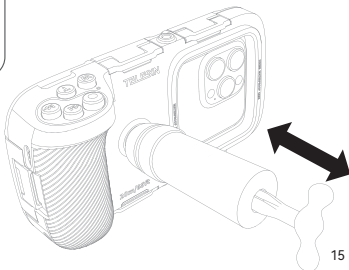

14. After use, to remove the phone: first unscrew the vacuum cover, press the black gasket to release pressure, and then unlock the sealing buckle after deflating. Otherwise, it will be unable to open due to excessive adsorption from negative pressure.

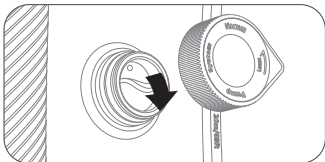
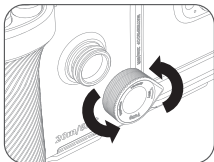

Power On/Off

Power On: Press and hold the capture button for 2 seconds to turn it on. The indicator light will flash, entering Bluetooth pairing mode.

Power Off:

1. In the on or sleep mode, press and hold the shooting button for 2 seconds. The indicator light will flash quickly three times and then go out, turning off the remote control.
2. If left in sleep mode for 30 minutes, the remote control will automatically turn off to save power.
3. If not paired within 2 minutes after powering on, it will automatically power off.

Quick Wake-up

Screen Status	Black Screen All States
iOS & Some Android Systems	Long Press Mode Button 1
vivo	Long Press Mode Button 1-First Light Up Screen. Long Press Mode Button 1 Again
*Quick wake-up function is currently not supported on Samsung and HarmonyOS 5.0.	

Entering Sleep Mode

1. Auto-sleep after 60 min inactivity post-pairing.
2. Disconnects via phone settings, distance, or Bluetooth off, put it to sleep.
Auto-off after 30min.

Waking from Sleep Mode

Press any button to wake up.

1. Auto-reconnects if last paired phone's Bluetooth is on.
2. If the previously paired phone's Bluetooth is off and there's no pairing within 2 minutes, the device will enter sleep mode and shut down after 30 minutes.

Charging

Use the included charging cable for charging, connect the contact point end to the charging port on the left side of the diving house, and connect the other end of the charging cable to a USB power source.

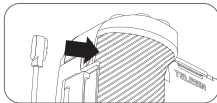

Product Parameters

Product Model:	P4-WTP-06
Material:	ABS+PC+Aluminum Alloy
Product Size:	203.66mm*109.18mm*52mm
Product Weight:	397g
Charging time:	2 hour
Battery Capacity:	80 mAh
Input:	Pogo Pin Connector, 5V  0.5A
Battery nominal voltage:	3.7V
Bluetooth Compatible Devices:	Apple (iOS), Android, and HarmonyOS smartphones (7-inch or smaller screens)

*Data measured by Telesin laboratory, slight deviations may occur due to changes in objective conditions.

FCC Caution

15.19 Labelling requirements.

This device complies with part 15 of the FCC Rules. Operation is subject to the following two conditions: (1) This device may not cause harmful interference, and (2) this device must accept any interference received, including interference that may cause undesired operation.

15.21 Information to user.

Any changes or modifications not expressly approved by the party responsible for compliance could void the user's authority to operate the equipment.

15.105 Information to the user.

Note: This equipment has been tested and found to comply with the limits for a Class B digital device, pursuant to part 15 of the FCC Rules. These limits are designed to provide reasonable protection against harmful interference in a residential installation. This equipment generates uses and can radiate radio frequency energy and, if not installed and used in accordance with the instructions, may cause harmful interference to radio communications. However, there is no guarantee that interference will not occur in a particular installation. If this equipment does cause harmful interference to radio or television reception, which can be determined by turning the equipment off and on, the user is encouraged to try to correct the interference by one or more of the following measures:

- Reorient or relocate the receiving antenna.
- Increase the separation between the equipment and receiver.
- Connect the equipment into an outlet on a circuit different from that to which the receiver is connected.
- Consult the dealer or an experienced radio/TV technician for help.

*RF warning for Portable device:

The device has been evaluated to meet general RF exposure requirement. The device can be used in portable exposure conditions without restriction.

IC Statement

-English:

This device contains licence-exempt transmitter(s)/receiver(s) that comply with Innovation, Science and Economic Development Canada's licence-exempt RSS(s). Operation is subject to the following two conditions:

(1) This device may not cause interference.

(2) This device must accept any interference, including interference that may cause undesired operation of the device.

Any changes or modifications not expressly approved by the party responsible for compliance could void the user's authority to operate the equipment.

RF exposure statement:

The device was evaluated to meet general RF exposure requirements. The device can be used in portable exposure condition without restriction.

- French:

Cet appareil contient des émetteurs / récepteurs exemptés de licence conformes aux RSS (RSS) d'Innovation, Sciences et Développement économique Canada. Le fonctionnement est soumis aux deux conditions suivantes:

(1) Cet appareil ne doit pas causer d'interférences.

(2) Cet appareil doit accepter toutes les interférences, y compris celles susceptibles de provoquer un fonctionnement indésirable de l'appareil.

Tout changement ou modification non expressément approuvé par la partie responsable de la conformité pourrait annuler l'autorité de l'utilisateur à utiliser l'équipement.

Déclaration d'exposition RF:

L'appareil a été évalué pour répondre aux exigences générales en matière d'exposition aux RF. L'appareil peut être utilisé en condition d'exposition portable sans restriction.

Declaration of Conformity



Disclaimer

Please read this statement carefully and by using this product you will be deemed to have acknowledged and accepted it in full. Please check the product carefully before each use and do not use it if damaged or deformed. By using this product, you acknowledge and agree that you are fully responsible for your actions and the possible consequences of using this product. You undertake to use this product only for legitimate and lawful purposes. You understand and agree that ("Telesin") shall not be liable for any misuse, adverse effects, damages, injuries, penalties or other legal consequences arising directly or indirectly from the use of this product. The user should follow the precautions including but not limited to those mentioned herein. To the extent, Telesin reserves the right to interpret and modify this commitment within the limits of national laws and regulations. The warranty period for TELESIN products begins 6 months on the day you receive the product.

www.telesin.com