

TWS真无线蓝牙耳机使用说明书

TWS-P30

(在使用本产品前请仔细阅读本说明书)

包装清单

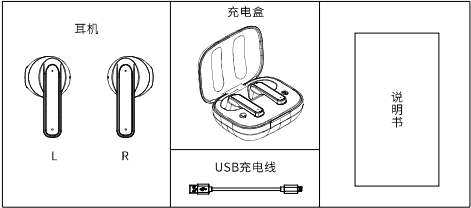

按键与接口

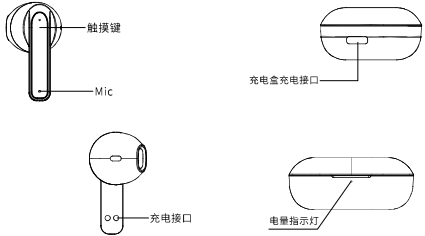

产品参数

蓝牙版本：V5.1
支持协议：HFP, HSP, A2DP, AVRCP
传输距离：10M
通话时间：8H
播放时间：8H
耳机电池容量：40MAH
充电盒电池容量：350MAH
耳机充电时长：1.5H
充电盒充电时长：1.5H
支持系统：所有蓝牙功能设备与手机
包装清单：耳机*1对，充电盒*1个，充电线1条

使用说明

充电盒上有“L”和“R”标识，请将标有“L”上的耳机佩戴在左耳，标有“R”上的耳机戴在右耳。

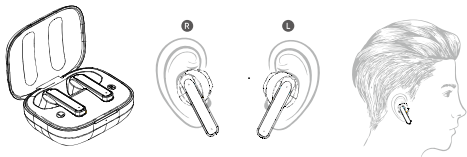

操作说明

【开机】

从充电盒内把左右耳机拿起来后左右耳机会自动开机。（如果未带充电盒或者充电盒没电，触摸左右耳机功能键三秒后开机。）

【蓝牙配对】

左右耳机从充电盒拿起来后，自动开机，左右耳机相互连接成功后，主耳机会自动进入配对状态（红绿灯交替闪烁），副耳机进入待机状态（绿灯5秒闪一下）；此时打开手机蓝牙搜索设备“TWS-P30”，连接成功即可。

【关机（三种方式）】

1. 将耳机放在充电盒会自动关机充电。
2. 手机断开蓝牙连接，5分钟后自动关机。
3. 长按任一耳机功能键10秒关机。

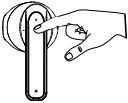

【功能操作】



双击左耳



双击右耳



长按2秒左/右耳



单击左/右耳



三击左/右耳



长按2秒右耳



长按2秒左耳



单击左/右耳

【耳机指示灯说明】

- A. 绿灯慢闪，无连接。
- B. 绿灯每隔5秒闪一下，已正常连接。
- C. 红灯60秒闪一次，低电量报警。
- D. 充电完成，指示灯熄灭。

【耳机充电】

1. 将TWS-P30左右耳机充电接触点对准充电盒弹针触点放入；
2. 充电状态时，耳机指示灯红色长亮；
3. 充电完成，耳机指示灯灭。

【充电盒充电】

1. 请使用输入电压为DC5V/1A的充电器对充电盒充电，可使用电脑USB接口或其他USB接口的充电器（必须选择正规厂家认证通过的充电器）；
2. 充电盒充电期间，指示灯绿灯闪烁；
3. 充电盒充满电时，指示灯绿灯长亮，请断开充电。

【注意事项】

1. 请勿以任何理由拆除或者改装耳机，否则可能导致耳机故障及烧毁，由此造成的损坏厂家不予保修。
2. 请勿将设备接触腐蚀性液体，否则会造成设备的严重损坏，由此造成的损坏厂家不予保修。
3. 请勿将设备置于温度过高或过低的环境下（0度以下或45度以上）。
4. 请避免靠近儿童或者动物的眼镜使用设备。
5. 请勿在雷暴天气下使用设备，雷暴可能会导致设备工作不正常，并增加触电危险。

警告！

产品有内置电池，请勿将此产品暴露在强烈的日照下，火烤或者扔入火中，以免爆炸。按照当地法规处理电池，不要当做家庭垃圾处理。用户不得自行去除或者更换产品的电池，进行此类操作存在危险并可能损坏产品。

【常见问题】

1. 充电盒无法充电？
请检查接口是否插好，或者更换充电线尝试。
2. 耳机无法充电？
请检查充电盒是否有点，然后擦拭耳机盒充电盒充电接触点，以防灰尘导致充电接触不良
3. 耳机无法开机？
请检查耳机是否有电，再尝试开机。
4. 手机搜索蓝牙出现两个“TWS-P30”设备号？
将两个蓝牙名称删除，耳机关机再重新开机。
5. 接电话声音太小或不清晰？
请尝试把手机声音调大。
6. 左右耳机之间互联距离多远？
无障碍3米以内。

为了更好的音乐体验，建议使用IOS8.0&Android4.3以上操作系统。



注意！

为保证耳机出厂后电池续航时间更长久，耳机出厂时贴有绝缘膜。首次使用请撕掉耳机绝缘膜，再双耳放入充电仓，最后同时将双耳从充电仓拿出即可自动开机配对。

TWS TRUE WIRELESS STEREO EARPHONE MANUEL

TWS-P30

(PLEASE READ BEFORE USE)

PACKING LIST

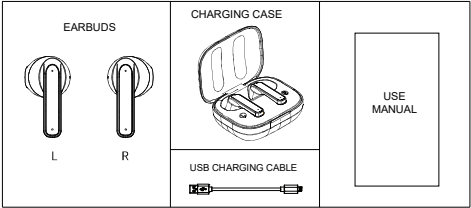

CONTROLLERS AND CONNECTORS

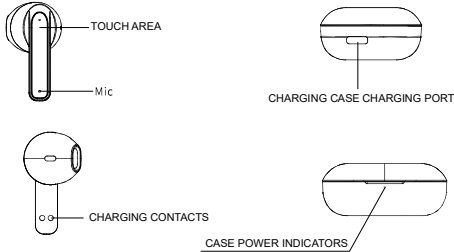

SPECIFICATION

Bluetooth version : V5.1
support : HFP,HSP,A2DP,AVRCP
wireless range : 10M
talking time : 8H
play time : 8H
earbud battery capacity : 40MAH
charging case battery capacity : 350MAH
earbuds charging time : 1.5H
charging case charging time : 1.5H
Support system: all Bluetooth devices and mobile phone
package list : Earbud* 2pcs, charging case *1pcs,cable*1pcs

USE INSTRUCTION

Earbuds have L and R, L for left ear,R for right ear.

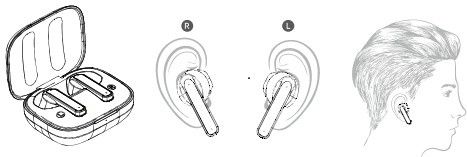

OPERATION INSTRUCTIONS

【POWER ON】

Earbuds will power on when be picked up from case.(touching touch are for 3 seconds when power off state)

【BLUETOOTH PAIR】

Earbuds will auto pair when be picked up from case, master earbud (Red & green lights flashing alternately),other earbud will be standby time(green light flash 1time/per 5 seconds), then open mobile phone Bluetooth function and click TWS-P30, devices will connect.

【SHUT DOWN(3 WAYS)】

- 1.Put earbuds into charging case
- 2.Earbuds' disconnecting state lasts for 5 minutes
- 3.Touching touch area for 10 seconds

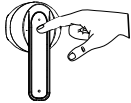

【FUNCTION OPERATION】



Double tap L



Double tap R



Touching L/R 2S



Single tap L/R



3 tap L/R



touching R 2S



touching L 2S



Single tap L/R

【EARBUDS INDICATOR DESCRIPTION】

- A. Green light flashes slowly: no connection.
- B. Green light flashes per 5 seconds: connection is normal.
- C. Red light flashes once per 60 seconds: battery low.
- D. When power full, indicator light goes out.

【EARBUDS CHARGING】

1. Put earbuds into charging case .Left earbud at L position, right earbud at R position;
2. Indicator light will be steady red when being charged;
3. When power full, indicator light goes out.

【CHARGING THE CASE】

1. Charger specifications: 5V 1A/2A,or computer USB connector.(charger certified by a regular manufacturer);
2. Green light flashes when being charged;
3. When power full, green indicator light is on, please disconnect the charging.

【ATTENTION】

1. Do not remove or modify the headset for any reason, otherwise it may cause the headset to malfunction and burn, and the damage caused by this may not be guaranteed by the manufacturer.
2. Do not expose the equipment to corrosive liquids, otherwise it will cause serious damage to the equipment, and the damage caused by this will not be guaranteed by the manufacturer.
3. Do not place the device in anenvironment where the temperature is too high or too low (below 0 degrees or above 45 degrees).
4. Please avoid using equipment lights near the glasses of children or animals.
5. Do not use the equipment under thunderstorms. Thunderstorms may cause the equipment to work abnormally and increase the risk of electric shock.

WARN!

The product has a built-in lithium battery. Please do not expose this product to strong sunlight, bake it or throw it into the fire to avoid explosion. Dispose of batteries in accordance with local regulations and do not treat them as household waste. Users are not allowed to remove or replace the battery of the product by themselves. Such operations are dangerous and may damage the product.

【COMMON PROBLEM】

Q: Charging case can not charge?

A: Please check the interface is plugged tight or not, and try to change a new charging cable.

Q: Earbuds can not charge?

A: Please check if the charging case have power or not. And clean the charging contacts.

Q: Earbuds can not power on?

A: Check if the earbuds have power or not, and try again.

Q: Why the mobile search out two bluetooth names of "TWS-P30"?

A: Cancel the two "TWS-P30", power off the earbuds and power on to search again.

Q: The sound volume is too small on the phone

A: try to rise the mobile phone sound volume.

Q: How long of the interconnection distance between the left and right earphone?

A: Within 3 meters without any obstruction.

FOR BETTER MUSIC EXPERIENCE SUGGEST TO USE IOS8.0 AND ANDROID 4.3 OR ABOVE OPERATION SYSTEM.



注意!

To ensure the earbuds have more longer standby time, factory stick protection films on the earbuds charging contacts. For first use, please remove the protection films first, then put the two earbuds into the charging case, take out the two earbuds again at last. The two earbuds will power on and pair automatically.

FCC Caution:

This device complies with part 15 of the FCC Rules. Operation is subject to the following two conditions: (1) This device may not cause harmful interference, and (2) this device must accept any interference received, including interference that may cause undesired operation.

Any Changes or modifications not expressly approved by the party responsible for compliance could void the user's authority to operate the equipment.

Note: This equipment has been tested and found to comply with the limits for a Class B digital device, pursuant to part 15 of the FCC Rules. These limits are designed to provide reasonable protection against harmful interference in a residential installation. This equipment generates uses and can radiate radio frequency energy and, if not installed and used in accordance with the instructions, may cause harmful interference to radio communications. However, there is no guarantee that interference will not occur in a particular installation. If this equipment does cause harmful interference to radio or television reception, which can be determined by turning the equipment off and on, the user is encouraged to try to correct the interference by one or more of the following measures:

- Reorient or relocate the receiving antenna.
- Increase the separation between the equipment and receiver.
- Connect the equipment into an outlet on a circuit different from that to which the receiver is connected.
- Consult the dealer or an experienced radio/TV technician for help.

The device has been evaluated to meet general RF exposure requirement. The device can be used in portable exposure condition without restriction.