

User manual

HX433RF REMOTE CONTROL

M/N:HX433RF

Instructions for remote control

Please read the following carefully to ensure the satisfactory and safe operation of this remote control.

CAUTION:

Replace only with "CR2025" type cell battery

Non-rechargeable batteries are not to be recharged.

Ensure the batteries are installed correctly with regard to polarity(+ and -)

Do not dispose of batteries in fire, batteries may leak or explode.

Please remove batteries if consumed or if product is to be left unused for a long time.

Please clean the battery contacts and those of the device prior to the battery installation.

Replace batteries insuring proper polarity.

Batteries should be recycled or disposed according to the manufacturer's instructions and following state and local guidelines.

Remote Control Trouble Shooting

1. If the remote control doesn't work, please make sure that the plastic sheet which used for battery isolation purpose is pulled out.

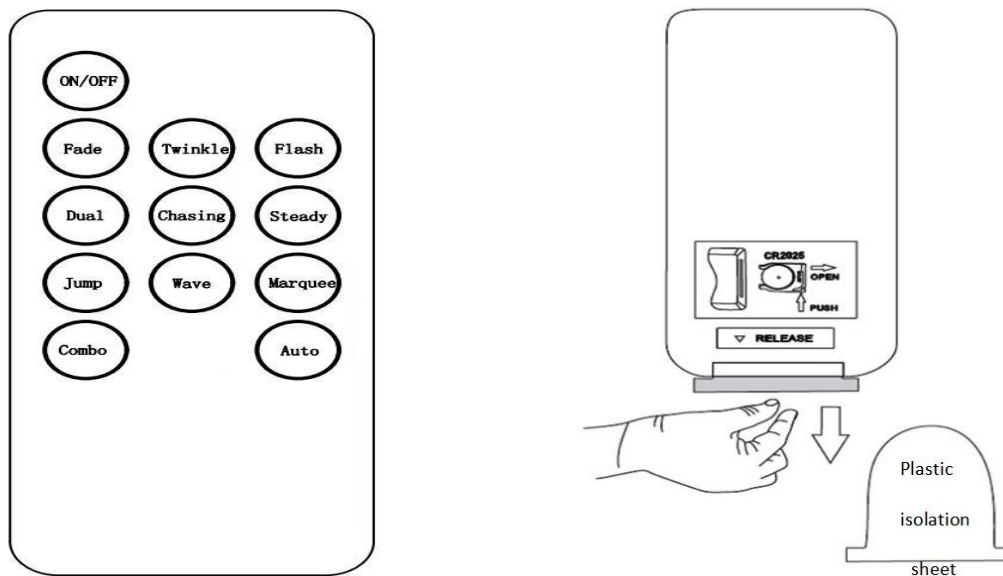

2. The remote needs a direct line of site with the receiver and has to be in close range. It's better to operate remotely from a distance less than 10 M.

3. If it's still no functions, please replace the button battery "CR2025" with a new one.

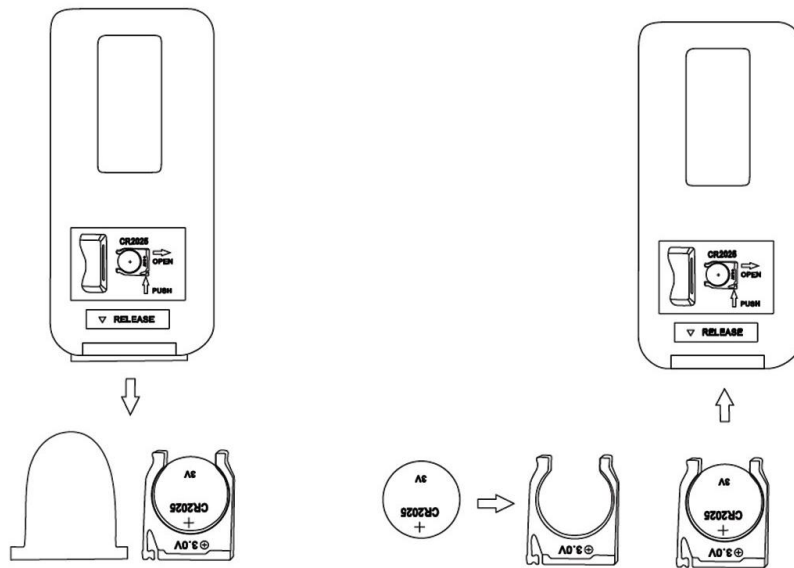

4. DETAILS OF PRODUCTS&REMOTE CONTROL FUNCTIONS

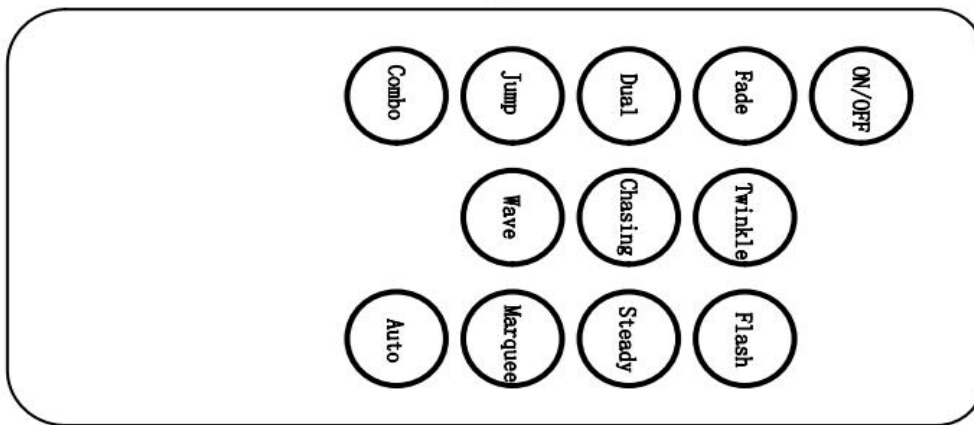

| DETAILS OF PRODUCTS&REMOTE CONTROL FUNCTIONS | | |
|--|----------------|---------------------------------|
| FADE | RED | PRESS THE FADE TO SWITCH COLORS |
| | GREEN | |
| | PURPLE | |
| | BLUE | |
| | YELLOW | |
| | WHITE | |
| | WARM WHITE | |
| | MULTI | |
| | RED BLUE WHITE | |

| | | |
|----------------|---|---------------------------------------|
| TWINKLE | STEADY RED WITH COOL WHITE LED FLICKERING | PRESS THE TWINKLE TO SWITCH COLORS |
| | STEADY GREEN WITH COOL WHITE LED FLICKERING | |
| | STEADY PURPLE WITH COOL WHITE LED FLICKERING | |
| | STEADY BLUE WITH COOL WHITE LED FLICKERING | |
| | STEADY YELLOW WITH COOL WHITE LED FLICKERING | |
| | STEADY COOL WHITE WITH COOL WHITE LED FLICKERING | |
| | STEADY WARM WHITE WITH COOL WHITE LED FLICKERING | |
| | STEADY MULTI COLOR WITH COOL WHITE LED FLICKERING | |
| | STEADY RED/BLUE/COOL WHITE WITH COOL WHITE LED FLICKERING | |
| FLASH | STEADY RED WITH RED LED FLICKERING | PRESS THE FLASH TO SWITCH COLORS |
| | STEADY GREEN WITH GREEN LED FLICKERING | |
| | STEADY PURPLE WITH PURPLE LED FLICKERING | |
| | STEADY BLUE WITH BLUE LED FLICKERING | |
| | STEADY YELLOW WITH YELLOW LED FLICKERING | |
| | STEADY COOL WHITE WITH COOL WHITE LED FLICKERING | |
| | STEADY WARM WHITE WITH WARM WHITE LED FLICKERING | |
| | STEADY MULTI WITH MULTI LED FLICKERING | |
| | STEADY RED/BLUE/COOL WHITE WITH RED/BLUE/COOL WHITE LED FLICKERING | |
| DUAL | STEADY GREEN WITH RED LED FLICKERING | PRESS THE DUAL TO SWITCH COLORS |
| | STEADY COOL WHITE WITH BLUE LED FLICKERING | |
| | STEADY COOL WHITE WITH RED LED FLICKERING | |
| | STEADY GREEN WITH BLUE LED FLICKERING | |

| | | | |
|---------|--|--|--|
| | STEADY RED WITH YELLOW LED FLICKERING | | |
| | STEADY PURPLE WITH BLUE LED FLICKERING | | |
| | STEADY COOL WHITE WITH MULTI LED FLICKERING | | |
| CHASING | COLOR GRADIENT | RED - ORANGE - YELLOW - GREEN - TURQUOISE- BLUE- PURPLE - WHITE THEN FADE BACK TO RED | FROM SLOW TO FAST PRESS THE CHASING TO SWITCH FUNCTIONS |
| | | MULTI COLORED FLASH | |
| | RED, GREEN AND WHITE FLASHING | | |
| | RED, BLUE AND WHITE FLASHING | | |
| | | | |
| STEADY | STEADY RED | | PRESS THE STEADY TO SWITCH COLORS |
| | STEADY GREEN | | |
| | STEADY PURPLE | | |
| | STEADY BLUE | | |
| | STEADY YELLOW | | |
| | STEADY COOL WHITE | | |
| | STEADY WARM WHITE | | |
| | STEADY MULTI | | |
| | STEADY RED/BLUE/COOL WHITE | | |
| JUMP | RED FLICKERING | | PRESS THE JUMP TO SWITCH COLORS |
| | GREEN FLICKERING | | |
| | PURPLE FLICKERING | | |
| | BLUE FLICKERING | | |
| | YELLOW FLICKERING | | |
| | COOL WHITE FLICKERING | | |
| | WARM WHITE FLICKERING | | |
| | MULTI FLICKERING | | |
| | RED/BLUE/COOL WHITE FLICKERING | | |
| WAVE | RED SHIMMERING | | PRESS THE WAVE TO SWITCH COLORS |
| | GREEN SHIMMERING | | |
| | PURPLE SHIMMERING | | |
| | BLUE SHIMMERING | | |
| | YELLOW SHIMMERING | | |
| | COOL WHITE SHIMMERING | | |
| | WARM WHITE SHIMMERING | | |
| | MULTI SHIMMERING | | |
| | RED/BLUE/COOL WHITE SHIMMERING | | |

| | | | | |
|---------|---|---------------------------|------------------------------------|-----------------------------------|
| MARQUEE | RED FLICKERING | | PRESS THE MARQUEE TO SWITCH COLORS | |
| | GREEN FLICKERING | | | |
| | PURPLE FLICKERING | | | |
| | BLUE FLICKERING | | | |
| | YELLOW FLICKERING | | | |
| | COOL WHITE FLICKERING | | | |
| | WARM WHITE FLICKERING | | | |
| | MULTI FLICKERING | | | |
| | RED/BLUE/COOL WHITE FLICKERING | | | |
| COMBE | FADE | | FUNCTION CYCLE IN FADE | PRESS THE COMBE TO SWITCH FUNTONS |
| | TWINKLE | FUNCTION CYCLE IN TWINKLE | | |
| | FLASH | FUNCTION CYCLE IN FLASH | | |
| | DUAL | FUNCTION CYCLE IN DUAL | | |
| | CHASING | FUNCTION CYCLE IN CHASING | | |
| | JUMP | FUNCTION CYCLE IN JUMP | | |
| | WAVE | FUNCTION CYCLE IN WAVE | | |
| | MARQUEE | FUNCTION CYCLE IN MARQUEE | | |
| AUTO | PRESS AUTO TO AUTOMATICALLY CYCLE ALL FADE TWINKLE FLASH DUAL CHASING FUNCTIONS | | | |
| ON/OFF | TAP TO SWITCH ON/OFF | | | |

5.Specification

Areas of application

The remote control LED light.

Technical parameters:

Use 3.0V button battery to load the remote.

Working frequency: 434.0595MHz

Standby current: 0MA

Working current: > 20MA

Transfer rate: < 10 KBPS

Modulation mode: ASK (amplitude modulation)

Working temperature: - 10 ℃ ~ +40 ℃

Tips: 1. With the power switch, remote control can turn off the power save electricity when not in use.



FCC Statement

This device complies with Part 15 of the FCC rules. Operation is subject to the following two conditions: 1) this device may not cause harmful interference, and 2) this device must accept any interference received, including interference that may cause undesired operation.

Note: This equipment has been tested and found to comply with the limits for a Class B digital device, pursuant to part 15 of the FCC Rules. These limits are designed to provide reasonable protection against harmful interference in a residential installation.

This equipment generates uses and can radiate radio frequency energy and, if not installed and used in accordance with the instructions, may cause harmful interference to radio communications. However, there is no guarantee that interference will not occur in particular installation. If this equipment does cause harmful interference to radio or television reception, which can be determined by turning the equipment off and on, the user is encouraged to try to correct the interference by one or more of the following measures:

- Reorient or relocate the receiving antenna.
- Increase the separation between the equipment and receiver.
- Connect the equipment into an outlet on a circuit different from that to which the receiver is connected.
- Consult the dealer or an experienced radio/TV technician for help.

Changes or modifications not expressly approved by the party responsible for compliance could void the user's authority to operate the equipment.

FCC RF Radiation Exposure Statement

The device has been evaluated to meet general RF exposure requirement. The device can be used in portable exposure condition without restriction.