

Magnetic Door Switch

The Zigbee door sensor switch, also named door sensor detector, senses the switch status of doors and windows by detecting the proximity and separation of the magnet, and sends an alarm signal to the Zigbee gateway through the Zigbee communication protocol. This product is suitable for household residences, buildings and villas, factories, shopping malls, office buildings, etc. An example of product appearance is shown in Figure 1.

● Features

- Real-time monitoring of door and window switching conditions, and an alarm will be generated immediately when the opening and closing conditions are met.
- Two-way communication with Zigbee gateway via Zigbee 2.4GHz.
- With low voltage alarm function, synchronously upload battery power status.
- Support bottom tamper alarm function.
- With status display LED lights.
- Low power consumption design, long standby time, stable and reliable.
- Support the function of battery icon prompt when the battery power is low.

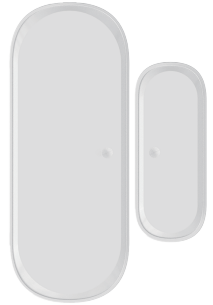

figure 1

● Technical parameters

Product Model: EC92

Product number: PB0092BZ00/01/02/03/XX

Product Size: 60*23*13mm & 36*14*13mm

Operating Voltage: DC 3V

Working current: Standby current $\leq 5\mu\text{A}$; alarm current $\leq 25\text{mA}$

Communication Protocol: Zigbee 2.4G

Transmission distance: $\leq 130\text{m}$ (open visual distance)

Action distance: $>17\text{mm}$ (open)/ $<17\text{mm}$ (close)

Alarm Output: Report to Zigbee gateway

Installation method: 3M Wall Mount Wall Sticker

Battery Type: Button battery CR1632*2

Working temperature: $-10\text{ }^{\circ}\text{C} \sim 55\text{ }^{\circ}\text{C}$

Working humidity: $\leq 95\%$ (no condensation)

● Installation Notes

1. Select a suitable installation location and fix it with 3M adhesive tape. The product can be installed on doors, windows, etc., as shown in Figure 2.

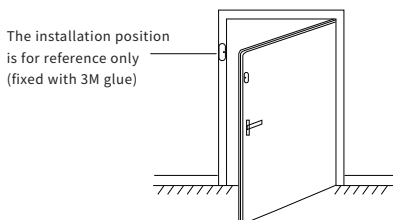

Door installation instructions

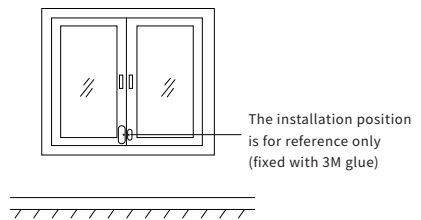

Window installation instructions

figure 2

● Operation and adjustment

1. Initialization state:

After the battery is installed and powered on, the blue indicator light is always on, and the product enters the initialization state; if the Zigbee module is successfully initialized, the blue indicator light is off, and the product enters the normal working state.

2. pairing with ZigBee gateway:

Open Tuya APP, select Zigbee gateway, click add sub-device, then press and hold the device pairing key for 5 seconds, the blue LED indicator flashes continuously, the device resets, and automatically sends a network access request to the Zigbee gateway. After the Zigbee gateway confirms, you can Complete the network access, and prompt the device to add successfully on the APP.

The longest configuration time is 2 minutes. If it times out, it will automatically exit the pairing mode.

3. Restore factory settings:

Long press the pair code button until the blue light flashes quickly, release the button, and the Recovery is successful.

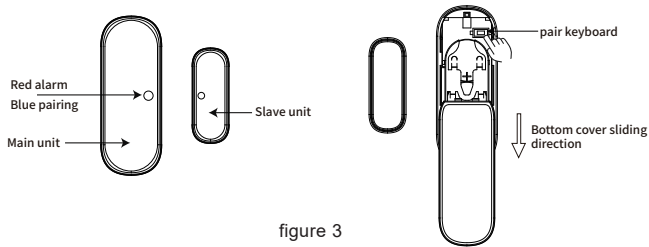

figure 3

4. Test mode:

Short press the pairing button, the blue light flashes once, and the battery level information is actively reported.

5. Anti-demolition alarm:

When the device host is removed, the tamper switch will be triggered, the red LED indicator flashes once, and the detector will send a tamper alarm signal to the Zigbee gateway; when the device host is restored, the detector will send a tamper alarm to the Zigbee gateway Release the signal.

● Notice

1. The door sensor should not be installed in an outdoor location that is easily damaged.
2. Do not install the door magnetic detector in a place with a weak foundation to avoid false alarms due to loosening.
3. Do not install the door magnetic detector near magnetic objects.

FCC Warning Statement

Changes or modifications not expressly approved by the party responsible for compliance could void the user's authority to operate the equipment. This equipment has been tested and found to comply with the limits for a Class B digital device, pursuant to Part 15 of the FCC Rules. These limits are designed to provide reasonable protection against harmful interference in a residential installation. This equipment generates uses and can radiate radio frequency energy and, if not installed and used in accordance with the instructions, may cause harmful interference to radio communications. However, there is no guarantee that interference will not occur in a particular installation. If this equipment does cause harmful interference to radio or television reception, which can be determined by turning the equipment off and on, the user is encouraged to try to correct the interference by one or more of the following measures:

- - Reorient or relocate the receiving antenna.
- - Increase the separation between the equipment and receiver.
- - Connect the equipment into an outlet on a circuit different from that to which the receiver is connected.
- - Consult the dealer or an experienced radio/TV technician for help.

This device complies with part 15 of the FCC Rules. Operation is subject to the following two conditions: (1) This device may not cause harmful interference, and (2) this device must accept any interference received, including interference that may cause undesired operation.

RF Exposure Statement

To maintain compliance with FCC's RF Exposure guidelines, This equipment should be installed and operated with minimum distance of 20cm the radiator your body. This device and its antenna(s) must not be co-located or operation in conjunction with any other antenna or transmitter.