

Smart Button

This product is a smart button. When an emergency occurs, pressing the emergency button can send the emergency signal to the cloud platform through the Zigbee network, allowing users to receive an alarm notification on the Tuya APP at the first time, and make timely processing to reduce event happens. This product is widely used in households, hotels, office buildings, nursing homes and other places. An example of product appearance is shown in Figure 1.

● Features

- Press the button actively when emergency help is needed to send out a signal for help.
- Provides a button-type help way, and the alarm is automatically reset.
- Two-way communication with Zigbee gateway via Zigbee 2.4GHz.
- With low voltage alarm function, synchronously upload battery power status
- With the function of LED light to display the status.
- Low power consumption design, long standby time, stable and reliable.
- Support the function of battery icon prompt when the battery power is low.



figure 1

● Technical parameters

Product Model: EB15

Product Number: PB0015BZ00/01/02/03/0X

Product Size: 58mm*58mm*17mm

Working Voltage: DC 3V

Working current: Standby current $\leq 5\mu\text{A}$; Alarm current $\leq 25\text{mA}$

Transmission Protocol : Zigbee 2.4G

Transmission distance : $\leq 130\text{m}$ (open visual distance)

Reset method : Automatic reset

Installation : 3M Wall Mount Wall Sticker

Battery Type: Button battery CR2450

Working temperature: $-10^{\circ}\text{C} \sim 55^{\circ}\text{C}$

Working humidity: $\leq 95\%$ (no condensation)

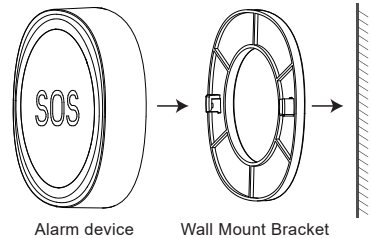

figure 2

● Installation Notes

1. Select a suitable area to install it with 3M adhesive wall stickers, and use it immediately after sticking (as shown in Figure 2).
2. Power on: Open the battery cover of the product by turning it counterclockwise by hand, put in the CR2450 button battery, and replace the battery cover, and the product can be powered on and used (as shown in Figure 3).

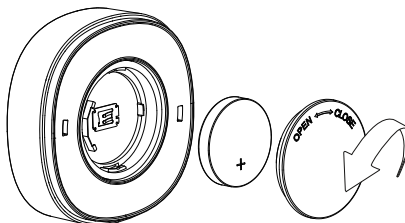

figure 3

● Operation and adjustment

1. Initialization state:

After the battery is installed and powered on, the blue indicator light is always on, and the product enters the initialization state; if the Zigbee module is successfully initialized, the blue indicator light is off, and the product enters the normal working state.

2. Pair Zigbee gateway:

Open the Tuya APP, select the Zigbee gateway, click to add a sub-device, and then press and hold the device pairing key for 5 seconds (as shown in Figure 4), the blue LED indicator flashes continuously, the device is reset, and the network access request is automatically sent to the Zigbee gateway, and the Zigbee gateway confirms After that, you can complete the network access, and the APP will prompt the device to add successfully. The longest configuration time is 2 minutes. If it times out, it will automatically exit the pa pairing mode.

3. Normal work:

When the product is working normally, the blue indicator light is off; press the emergency button, an alarm for help is issued and the blue indicator light flashes, and the alarm information is uploaded. Each time the button is pressed, an alarm will be generated and automatically reset immediately. The number of times the button is pressed is the number of times of calling for help.

4. Low pressure alarm:

When the battery voltage is lower than the set value, the detector will send a low voltage alarm signal to the Zigbee gateway, reminding to replace the battery in time.

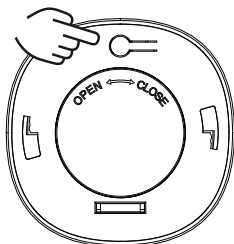

figure 4

● Notice

1. Do not install the product in a location that is easily damaged outdoors.
2. The product should not be installed in a position where it is easy to be exposed to water, and it is not waterproof.
3. Do not install the product in a place where the foundation is not firm.
4. When the low voltage alarm occurs in the battery, please replace the button battery of the same type in time.

FCC Warning Statement

Changes or modifications not expressly approved by the party responsible for compliance could void the user's authority to operate the equipment. This equipment has been tested and found to comply with the limits for a Class B digital device, pursuant to Part 15 of the FCC Rules. These limits are designed to provide reasonable protection against harmful interference in a residential installation. This equipment generates uses and can radiate radio frequency energy and, if not installed and used in accordance with the instructions, may cause harmful interference to radio communications. However, there is no guarantee that interference will not occur in a particular installation. If this equipment does cause harmful interference to radio or television reception, which can be determined by turning the equipment off and on, the user is encouraged to try to correct the interference by one or more of the following measures:

- - Reorient or relocate the receiving antenna.
- - Increase the separation between the equipment and receiver.
- - Connect the equipment into an outlet on a circuit different from that to which the receiver is connected.
- - Consult the dealer or an experienced radio/TV technician for help.

This device complies with part 15 of the FCC Rules. Operation is subject to the following two conditions: (1) This device may not cause harmful interference, and (2) this device must accept any interference received, including interference that may cause undesired operation.