

OUTDOOR POWER PACK
USER'S MANUAL

Thanks for choosing our product, Please read the manual carefully before use

Technical Specifications

Name: Battery Pack
Capacity: 3.2V/96000mAh/307.2Wh
Battery pack capacity: 12.8V /24000mAh/307.2Wh
INPUT:
DC Input: 18-24V/4A(Max) Max Solar charging: 80W
USB-C Input: DC5V/3A 9V/3A 12V/3A 15V/3A 20V/3A
OUTPUT:
Cigare Lighter Socket output: 12V / 15A(max)
USB 1&2 Output: 5V/3A 9V/2A 12V/1.5A
USB-C Output: DC5V/3A 9V/3A 12V/3A 15V/3A 20V/3A
DC Output: 12V/5A 16.5V/4A 20V/3.5A 24V/3.5A
Wireless: 10W
Measure: 225.8*165*76mm
N.W: 3043.4g

Package Contents

1x Power Pack	1x 8*1 DC Laptop Connector
1x 20V/2A Adapter	1x Handy bag (Option)
1x C-C Cable	1x CPAP Cable (4PCS) Option
1x Manual	

Identification of parts

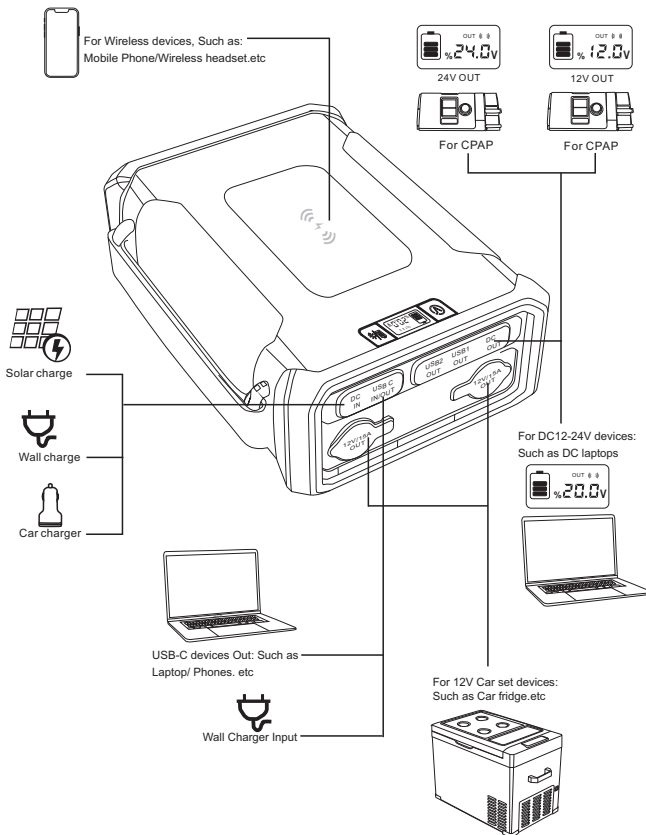
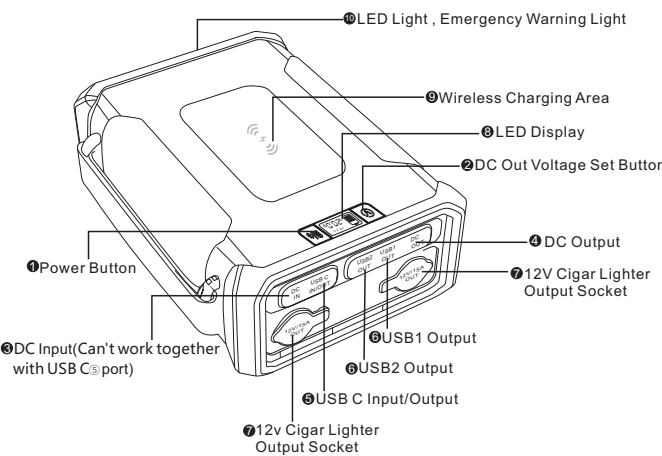

Recharge Power Bank

Use the DC or USB input port to charge, but can't work together to recharge
1. Plug the adapter's cable into the DC/USB input port of the battery pack. Please use supplied adapter or PD charger (Power Above 60W is recommended).
2. Connect the adapter to AC 100V-240V
3. Charging will begin automatically
4. Recharging time: It will take about 10 hours to fully charge the battery pack with supplied adapter, about 6 hours with branded PD charger (60W or above).
Solar panel charging time will vary from the power of solar panel and light intensity, it will support up to 80W recharging.

LED Display

Click the power button to turn on the wireless charging function.
The digital display screen shows the power bank battery level:
One grid means 25% battery Power,
two grid means 50% battery power level,
three grid means 75%,
and four grid means 100% battery power level (as shown in the picture).

Charge your digital devices

1. USB1 and USB2 are suitable for charging mobile phones, tablet and other digital devices.
2. USB C is suitable for charging most laptops and devices with USB C charging function.
3. The Power Bank can automatically charge the device. If it cannot be charged, please check the connection cable and press the power button.

Power to other DC input devices

1. When charging your DC devices, you need select the correct voltage and connector first.
2. Long press the voltage set button for 3 seconds, the select-able voltage value(12V, 16.5V, 20V, 24V) on the LED Display will flash and stay on each voltage for 5 seconds. Short press the voltage set button to jump among all select-able values till you find the right one for your devices. After the voltage value on the LED Display stops flashing, the DC port can output the voltage.
3. Connect the DC connector to the device and start charging the devices
4. If unplug the DC port devices, The power bank will continue to work (light on) for 2 hours, after 2 hours the power bank will automatically turn off. Or after removing the device from the DC port, manually long press 5 seconds the Power button to turn off the DC output function

12V Cigar lighter socket output

1. 12V devices Supported: Car refrigerator/inflator pump, UAC battery/outdoor tent light/ Camp light/fishing light/hunting light/fan and other devices under 150W.
2. Plug the devices into 12V cigar lighter socket.
3. The Socket will automatically power the connected device.
4. To Turn off the device & unplug it from the power pack.

Wireless charging

Click the power button to turn on the wireless function, Max 10W wireless charging.

Emergency warning light, LED Light

Warning light: Long press the power button to turn on the orange warning light, and long press again to turn off the orange warning light.
LED light: Double click the power button to turn on the white LED light, Then double click to turn off the LED light

Usage Notes

1. Pass-Through charging: DC input and DC output can be used at the same time
2. USB-C port and DC port. These two ports will not automatically turn off after charging. The powerbank will turn off automatically after unplugging the device for two hours. Or you can manually turn off the power by holding the switch button for more than 5 seconds
3. If using a power inverter with your power pack, ensure it is no more than a maximum 150w.
4. To protect the battery cycle life, Please unplug the charging cable after it is fully charged when using the AC adapter or a USB-C charger
5. Do not store in extreme heat or coldness, near anything flammable or explosive and keep it away from damp areas.
6. Run a full charge / discharge cycle at least once every four months to avoid shortening the life span of the internal battery.
7. If long term storage is likely to occur between uses, we recommend storing power at approximately 50% full
8. Although the 12V socket is capable of pass through charging, avoid charging and discharging the Power pack at the same time as this may reduce the battery's life span.
9. Please note the cigarette lighter output voltage range is 12V-14V.
10. When supply power for different devices. A further 10% - 20% is lost by the device being charged and the charging cable used. Always use the original cable supplied with the device being charged for optimum results.
11. Using your Power pack in temperatures below 0C or above 40C is highly unadvisable and will likely cause irreparable damage to the internal battery.

FAQ

Q1. Can I charge four devices at the same time?
A1. Yes, but the total power does not exceed 300W. It is recommended not to connect USB-C or DC when the 12V cigarette lighter port is working at full load.

Q2. What should we do if the power bank can't recharge?
A2. Please check the charging adapter is connected correctly and the 100v-240v AC charging is enabled, if the problem still exists, please contact the supplier for more professional advices.

Q3. What should we do if the power supply cannot charge other devices?
A3. Please Check the charging line is inserted in the correct port, or check whether the output of this power supply is compatible with the voltage of electronic devices. Refer to your device's manual, product label, or adapter

Warranty

We provide customer with a comprehensive warranty of 12 months from the date of purchase.



FCC STATEMENT :

This device complies with Part 15 of the FCC Rules. Operation is subject to the following two conditions:
(1) This device may not cause harmful interference, and
(2) This device must accept any interference received, including interference that may cause undesired operation.
Warning: Changes or modifications not expressly approved by the party responsible for compliance could void the user's authority to operate the equipment.
NOTE: This equipment has been tested and found to comply with the limits for a Class B digital device, pursuant to Part 15 of the FCC Rules. These limits are designed to provide reasonable protection against harmful interference in a residential installation. This equipment generates uses and can radiate radio frequency energy and, if not installed and used in accordance with the instructions, may cause harmful interference to radio communications. However, there is no guarantee that interference will not occur in a particular installation. If this equipment does cause harmful interference to radio or television reception, which can be determined by turning the equipment off and on, the user is encouraged to try to correct the interference by one or more of the following measures:
Reorient or relocate the receiving antenna.
Increase the separation between the equipment and receiver.
Connect the equipment into an outlet on a circuit different from that to which the receiver is connected.
Consult the dealer or an experienced radio/TV technician for help.

FCC Radiation Exposure Statement

This equipment complies with FCC radiation exposure limits set forth for an uncontrolled environment.
This equipment should be installed and operated with minimum distance 20cm between the radiator & your body.