



# BYOT

## BUILD YOUR OWN TRUCK

### 3-IN-ONE CONSTRUCTION TRUCK

## SETTING UP THE BUILD YOUR OWN TRUCK

To build one of the three trucks you need to setup the multifunction electric screwdriver/truck motor & the remote control.

### Setting up the screwdriver / truck motor.

- Step 1 - Locate the white motor assembly and remove the screw holding the battery cover.
- Step 2 - Insert 2xAA batteries taking care to match the correct polarity.
- Step 3 - Replace the cover and re-tighten the screw.

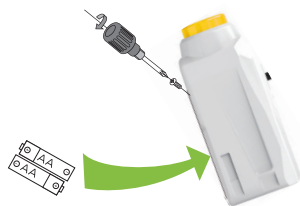

### Setting up the remote control.

- Step 1 - Locate the remote control and remove the screw holding the battery cover on the base.
- Step 2 - Insert 2xAAA batteries taking care to match the correct polarity.
- Step 3 - Replace the cover and re-tighten the screw.



#### ★ Tip

You can also use the included manual screwdriver to setup the truck instead of the electric screwdriver.



## USING THE SCREWDRIVER

- Step 1 - Insert a grey driver bit into the screwdriver / truck motor unit. Then slide the whole unit into the slot on the top of the remote control.
- Step 2 - Set the switch on the top of the screwdriver / motor unit to "RC" mode.
- Step 3 - Turn the red switch on the remote control to "On".
- Step 4 - Use the Forward / Back trigger buttons to activate the screwdriver in forward or backward mode.
- Step 5 - Use the included parts to assemble one of the 3 trucks.
- Step 6 - When finished with the screwdriver turn the red switch on the remote control to "Off" and set the switch on the screwdriver / truck motor to the off position. ●



## USING THE REMOTE CONTROL WITH THE TRUCK

Once you have assembled your chosen truck design, you can use the truck motor with the remote to take it for a spin!

- Step 1 - Remove the screwdriver / truck motor unit from the remote control, and remove the grey driver bit from the motor,
- Step 2 - Turn your newly assembled truck over to locate the motor compartment in the black wheel assembly.
- Step 3 - Slide the motor unit into the motor compartment making sure the switch still is accessible, and the motor shaft is correctly aligned with the drive gear inside of the motor compartment.
- Step 4 - Set the switch on the motor unit to "RC" mode.
- Step 5 - Turn the remote control on and use the Forward / Back trigger buttons on the remote control to move the truck forwards or backwards.

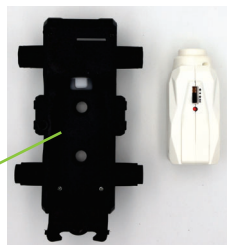

**Note:** *If you hear the motor run but the truck does not move, check the motor for correct alignment inside the motor compartment.*

### ★ Tip.

To set the truck continuously moving forward or backwards you can set the motor switch to either ◀ or ▶ .

Setting the motor to ● turns it off.



# CRANE TRUCK ASSEMBLY

## Step 1 - Assemble the Motor Base

- Parts Required:
- 4x Round Hex Screws
  - 4x Wheels
  - 1x Black Motor Base
  - 2x Flat Head Screws

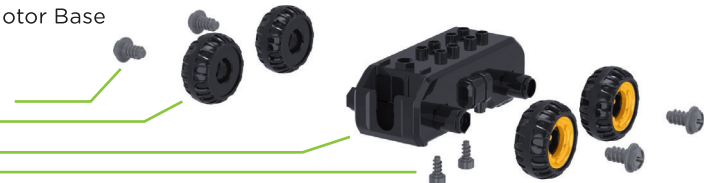

## Step 2 - Assemble Cab, Seats, Bed & Fender

- Parts Required:
- 1x Truck Cab
  - 1x Truck Bed
  - 1x Truck Seats
  - 1x Gearbox
  - 1x Fender
  - 2x Round Hex Screws

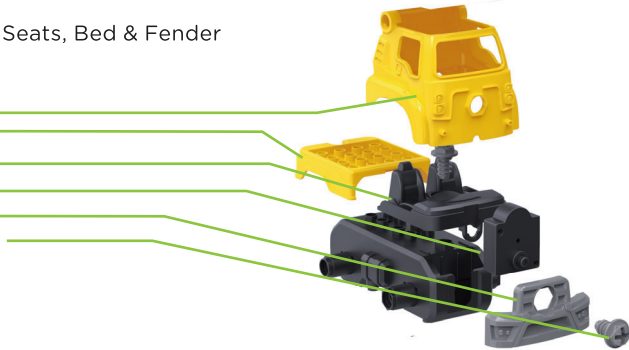

## Step 3 - Assemble Cab Top

- Parts Required:
- 2x Round Hex Screws
  - 1x Cab Top
  - 1x Truck Horns

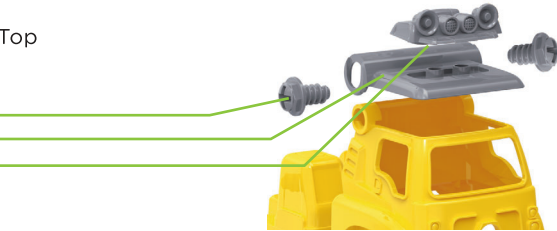

## Step 4 - Install Crane Body

- Parts Required:
- 1x Crane Body Base
  - 1x Crane Arm
  - 2x Round Hex Screws

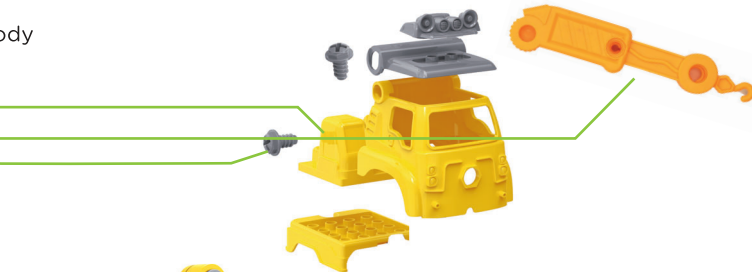

## DUMP TRUCK ASSEMBLY

Follow Steps 1 thru 3 of “Crane Truck Assembly” Instructions to build the Truck Base.

### Step 4 - Install Dump Truck Body

Parts Required:

- 1x Dump Truck Body
- 1x Dump Truck Bucket
- 2x Flat Head Screws
- 2x Round Hex Screws

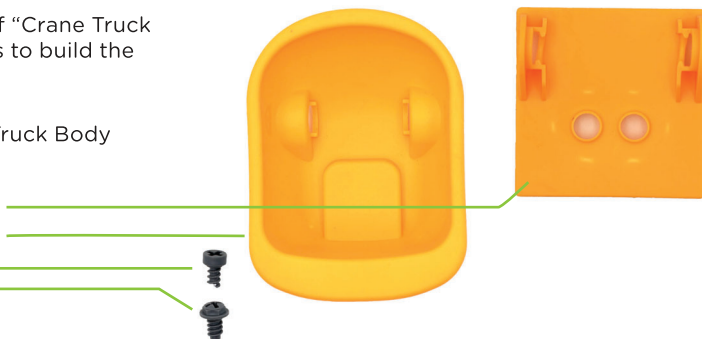

## CEMENT TRUCK ASSEMBLY

Follow Steps 1 thru 3 of “Crane Truck Assembly” Instructions to build the Truck Base.

### Step 4 - Install Dump Truck Body

Parts Required:

- 1x Cement Truck Body
- 1x Cement Truck Drum
- 2x Flat Head Screws
- 1x Round Hex Screws

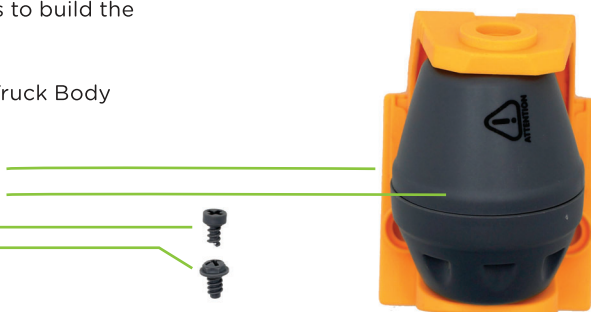

## CAUTIONS & WARNINGS

- Suitable for ages 3 and up. Adult supervision is always recommended.
- This product contains small parts which are a choking hazard. Keep away from small children.
- Manufacturers and dealers disclaim all responsibility for damage caused by misuse.
- Keep hair and loose clothing away from the toy when powered on.
- If the toy will be stored and unused for an extended period of time, please remove the batteries.
- Check the batteries regularly for potential leakage or corrosion that may occur.
- When installing the batteries carefully follow the polarity marking +/-.
- Do not mix different battery types.
- Remove exhausted or drained batteries.

## CARE & MAINTENANCE

- Do not submerge the unit in any liquids.
- Keep the unit dry.
- Do not place the unit near powerful, un-shielded magnets.
- Do not expose the unit to extreme hot or cold temperatures.
- Do not hit, drop, or smash the unit with extreme force.
- Do not disassemble the unit for any reason.

NOT FOLLOWING THESE PRECAUTIONS WILL VOID YOUR WARRANTY.



*Note: Diagram shows the complete assembly for the Crane Truck. The "Build Your Own Truck" is supplied partially assembled right out of the box for your convenience.*



For Customer Service please email:  
Care@OdysseyToys.com

Please note the units model number and name in your email:  
Model no. ODY-8600 • Build Your Own Truck



Please do not return this product to the store.

For questions or assistance on installation, parts or  
operation contact: Odyssey Toys at 1-(305)-933-4480.

Hours of operation: 10:00am - 5:00pm EST

Email: Care@OdysseyToys.com

or visit us online at: [www.odysseytoys.com/support](http://www.odysseytoys.com/support)  
20855 NE 16 AVE C-4, Miami FL, 33179

#### 60 DAY LIMITED WARRANTY

Odyssey Marketing/ Odyssey Toys warrants to the original purchaser when used in the United States only, that this product shall be free of defects in material and workmanship. This warranty applies within 60 days of the original purchase date with normal home use. This warranty does not apply for commercial use of this product. Use outside of United States is not covered by this warranty. During the warranty period, we will at our discretion, repair or replace this product without charge, as long as the product has not been abused or mishandled as by our determination. Our determination shall be final and be the consumer's sole remedy. ALL RETURNS must be accompanied by a Return Authorization Number which is issued by Odyssey Marketing's Customer Service Department.

Please contact Customer Service BEFORE returning any products or parts thereof. Once you have obtained a Return Authorization Number you will be provided a return address within the Customer Service email.

This warranty does not cover installation, adjustments in the home, nor damage due to accidents, misuse, abuse, fire, or any acts of God, incorrect line voltage, damage to other equipment caused by improper installation, unauthorized or improper modifications. This warranty gives you specific legal rights and you may also have other rights that vary from state to state.

**\*\* THIS WARRANTY IS EXPRESSLY IN LIEU OF ALL OTHER WARRANTIES. EXPRESSED OR IMPLIED INCLUDING THE WARRANTIES OF MERCHANTABILITY AND FITNESS.\*\* ©2022 Odyssey Marketing Corp.**

FCC STATEMENT: This product complies with Part 15 of the FCC Rules. Operation is subject to the following two conditions: (1) This device may not cause harmful interference and (2) this device must accept any interference receiver, including interference that may cause undesirable operation.

**MADE IN CHINA**



Changes or modifications not expressly approved by the party responsible for compliance could void the user's authority to operate the equipment.

NOTE: This equipment has been tested and found to comply with the limits for a Class B digital device, pursuant to part 15 of the FCC Rules. These limits are designed to provide reasonable protection against harmful interference in a residential installation. This equipment generates uses and can radiate radio frequency energy and, if not installed and used in accordance with the instructions, may cause harmful interference to radio communications. However, there is no guarantee that interference will not occur in a particular installation. If this equipment does cause harmful interference to radio or television reception, which can be determined by turning the equipment off and on, the user is encouraged to try to correct the interference by one or more of the following measures:

- Reorient or relocate the receiving antenna.
- Increase the separation between the equipment and receiver.
- Connect the equipment into an outlet on a circuit different from that to which the receiver is connected.
- Consult the dealer or an experienced radio/TV technician for help.

The device has been evaluated to meet general RF exposure requirement. The device can be used in portable exposure condition without restriction.