

DRONE

6-AXIS GYRO

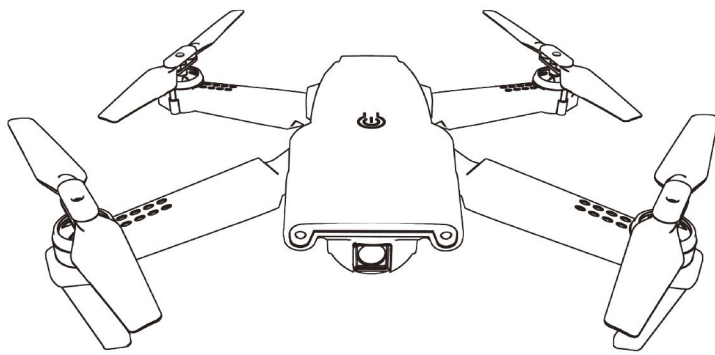

FORBIDDEN: Special despecial design for indoor & outdoor, please keep it away from obstacle. This product is suitable for indoor (the wind grade should be no more than 4), please choose a place without obstacle, and keep distance from crowd and pets, don't play it under unsafe, for instance, heat source, heat source, wire or electronic power source in order not to be damaged by collision landing, entanglement and lead to a fire, electric shock and cause losses of lives and property.

WARNING: Obtain the assistance of an experienced pilot. The products are suitable for more than 14 years old age, at the beginning it will have some certain difficulty in learning, suggestion guidance by experienced when playing.

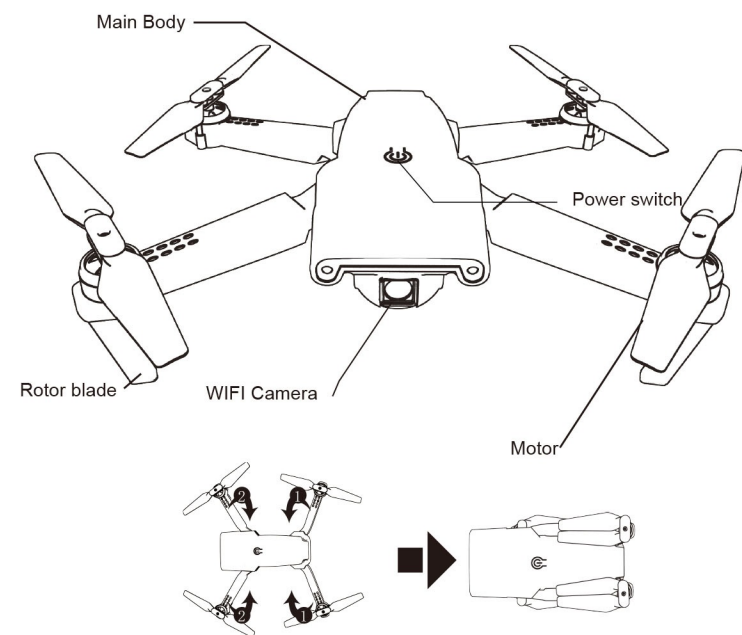

LEAF CHANGE

1. The leaf to be replaced must be replaced with the relative position on the machine. The blades A need to be installed in the position of A, the wind blade B must be installed in the position of B, such as the replacement of the wind blade error will not be able to control.
2. When the flight leaves a clockwise rotation, the fan B to counterclockwise rotation.

1. IMPORTANT NOTES

This product is NOT A TOY. It may cause damage by use it wrongly. Please use this product follow by this instruction. And please do not disassemble this product by yourself. This flying model requires practice before you use it. Please use the product follow by this instruction and please do not disassembly the product. Otherwise, manufacturer shall not be responsible to any damage of the product or injury to any person.

2. SAFETY NOTES

CAUTION: Fly only in safe areas away from other people. Do not operate R/C aircraft within the vicinity of crowds or people. R/C aircraft are prone to accidents, failures for their actions and damage or injury occurred during Pilot error, and radio interference, pilots are responsible for their actions and damage or injury occurred during the operation or as a result of R/C aircraft models.

Introduction of transmitter

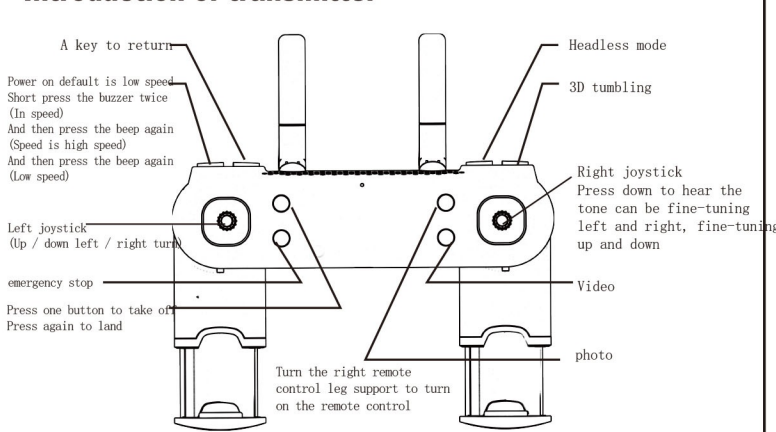

Assembled remote controller

Open the battery cover on the back of remote controller. Insert two #7 alkaline batteries in accordance with the instructions on battery box. (Battery should be purchased separately, old and new or different types of batteries shouldn't be mixed.)

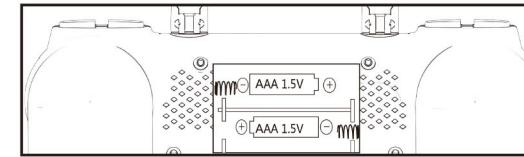

Recharge the quadcopter battery

Insert the factory equipped charger plug into the power, the recharger indicator is green, then connect the product battery, the indicator will turn to red, it indicates the battery is under recharging, when the indicator turns to green again under the recharge status, that means recharge finish and the battery is full. Whole recharge time will be around 30 minutes. Press 3D mode key, the transmitter indicator turns on, fly the quadcopter to 2 meters high and press the right control stick to any direction quickly to its bottom and release it, the quadcopter will roll to the direction corresponding to the right control stick. If need to quit then press the key again.

Battery safety instructions:

- Different types of batteries or old and new batteries should not mix;
- Non-rechargeable batteries cannot be charged;
- Only use the provided charger line to charge.
- Follow the polarity correctly installed batteries power supplies. Terminals shall not be short-circuited.
- Non-rechargeable batteries cannot be charged; rechargeable batteries can only be used under the supervision of adult charge.
- Do not use rechargeable battery overcharging when charging.
- People do not leave.
- Exhausted batteries to be taken from the remote control.
- Used batteries according to the environmental protection agency.



READY TO FLY

Make sure the propeller is installed correctly and fastened

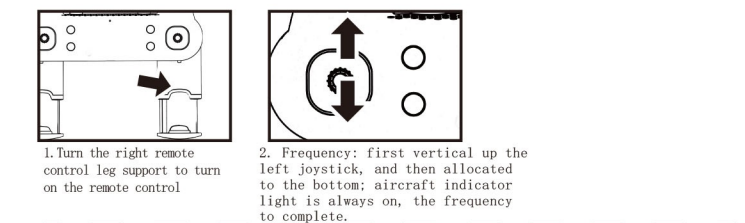

TAKEOFF METHOD 1:

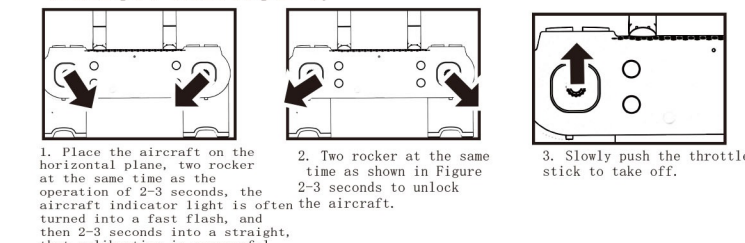

TAKEOFF METHOD 2:

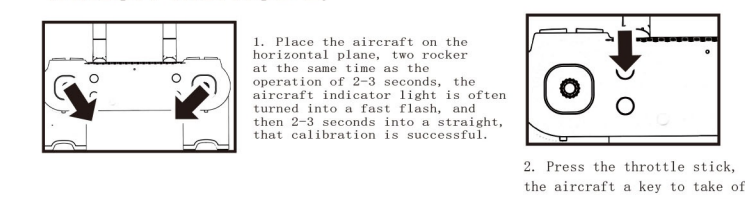

LANDING METHOD 1



Slowly push down the throttle if the take-off method is a stick until the aircraft landed. Take-off method 2 a key to keep the throttle stick in the take-off, you can press the lowest position 2 seconds throttle stick again a key the motor stops, the aircraft landing.

LANDING METHOD 2

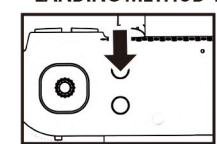

EMERGENCY LANDING

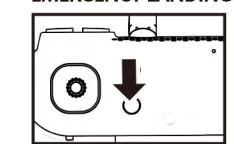

When the aircraft encountered obstacles or emergency is the throttle bar quickly pulled to the bottom, the aircraft can be an emergency landing.

FCC Compliance Statements

This device complies with Part 15 of the FCC Rules. Operation is subject to the following two conditions: (1) this device may not cause harmful interference, and (2) this device must accept any interference received, including interference that may cause undesired operation.

Note: This equipment has been tested and found to comply with the limits for a Class B digital device, pursuant to Part 15 of the FCC Rules. These limits are designed to provide reasonable protection against harmful interference in a residential installation. This equipment generates, uses and can radiate radio frequency energy and, if not installed and used in accordance with the instructions, may cause harmful interference to radio communications. However, there is no guarantee that interference will not occur in a particular installation. If this equipment does cause harmful interference to radio or television reception, which can be determined by turning the equipment off and on, the user is encouraged to try to correct the interference by one or more of the following measures:

- Reorient or relocate the receiving antenna.
- Increase the separation between the equipment and receiver.
- Connect the equipment into an outlet on a circuit different from that to which the receiver is connected.
- Consult the dealer or an experienced radio/TV technician for help.

Caution: Changes or modifications not expressly approved by the party responsible for compliance could void the user's authority to operate the equipment.

This equipment complies with FCC radiation exposure limits set forth for an uncontrolled environment. This transmitter must not be co-located or operating in conjunction with any other antenna or transmitter.

Flying controlled and fine tuning

Ascend/descend	When the left operating lever push up or pull down, the quadcopter is ascending or descending.	
Turning	Turning. When the left operating lever push left or right, the quadcopter turns left or right, the quadcopter turns left or right.	
Forward/backward	When the right operating lever push up/down, the quadcopter goes forth/back.	
Side Fly	When the right operating lever push left or right, the quadcopter goes to the left or right.	
Side-fly fine tuning	When the quadcopter is hovering, and the quadcopter is deviate to left or right, then turn the side-fly fine tuning to right or left until the quadcopter keeps balance.	
Forward backward fine tuning	When the quadcopter is hovering, and the quadcopter is deviate to forward or backward, turn the forward/backward fine tuning up or down until it keeps balance.	

Headless mode: In no open mode, the aircraft took off in the direction of East and West position, if the rear of the aircraft to take off this south, a tube aircraft flying far, what direction to go, then pull back forward, backward / left and right side joystick to fly the aircraft will fly back to retreat south. (Vehicle chassis have ON-OFF of the back)
A return key: Press a button to return the vehicle will automatically fly back to the starting position at takeoff.

Flying practice

1. Accelerating operation: Slowly push the acceleration lever until the quadcopter take off from the ground and hovers in the air, then pull the acceleration lever back until the quadcopter slowly descends. Practice this repeatedly until you could control the acceleration lever smoothly.

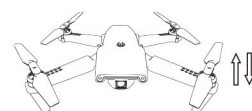

2. Vice-blade operation: When the quadcopter hovers in the air, push the right lever slowly to make the quadcopter fly forward/backward/to left/to right.
3. Turning operation: When the quadcopter hovers in the air, push the turning rudder slowly to make the quadcopter turns left or right.

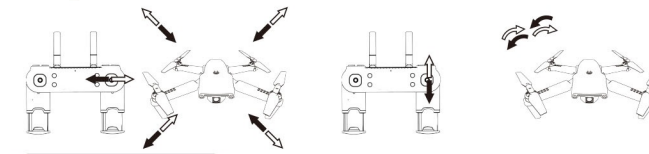

Camera / Video

Camera led status description:

1. When the bottom camera kit blue indicator light , red LED flashes, then the vehicle has power but no SD card or the SD card is not inserted.
2. Photo button the remote control aircraft camera box red blinking lights on the bottom, then the aircraft take a photo and automatically stored in SD card photo.
3. Video button the remote control aircraft camera boxes on the bottom red light stay lit. It means that aircraft are video, photo/video button then press the remote control aircraft camera boxes on the bottom red led is not lit, it means that the fly exit the camera status, and automatically stored in SD card video.
4. Power off the aircraft, take out SD card through the card reader connected to the computer or SD card directly your mobile phone, using the corresponding format player to play videos and view photos.

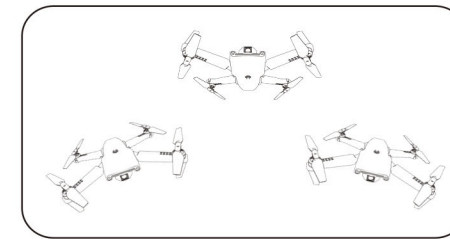

4.3Daction operation

- TIPS:**
1. When matching signal, keep the quadcopter on horizontal position for faster matching and starting a stable flight.
 2. Indoor's flight: please select spacious place without obstacle, pets and people for flight.
 3. Outdoor's flight: please select a warm sunny and no wind or breeze for flight.

Note:

1. Don't fly in the extreme weather and the model maybe damaged in extreme heat or cold weather which will affect flight effect.
2. Don't fly in the strong wind weather which will cause limitations to the flight or hinder your flight control. In the case of strong wind, your aircraft will vanish or damage.

Common problem and solution instruction

Problem	Cause	Solution
Can not take off	Battery of quadcopter is not charged completely	Recharge the drone battery
	Main blades rotate too slow	Push up the throttle stick
Main blade do not rotation	Main blade and motor are assembled cohesively	Pull the main blade up to keep in an appropriate state with motor
	Quadcopter battery depleted	Charge or Replace with fully charged battery
	Deformed main blades	Replace main blades
Motor do not respond to throttle stick, receiver LED flashed	AB blade mistake install	Install AB blade correctly
	Drone battery depleted	Fully charge the battery or replace with a fully charged battery
Motor not working	Stuck foreign matter	Take out the foreign matter
	Transmitter fail to connect Drone	Refresh the Drone
Out of control	Motor damage or motor line break	Change motor or check the line inside
	Exceed the effective control distance	Control distance beyond 80meters
	The throttle stick isn't pulled to the end to complete revising frequency and the Drone automatically rise	Throttle stick should be pulled to the end during revising frequency
The Drone was violently shaking or lurching sideways	Main blade be out of shape	Replace the blade
	Mix the Trimmer of transmitter or Drone	Manual the trimmer of transmitter or Refresh Drone
Drone rotate after trim adjustment speed during left/right pirouette	Damaged main blade	Reolace main blade
	Damaged motor	Replace the motor
	Throttle trimmer accidentally increased during flight.	Confirm the throttle trimmer in place of middle or slightly below.
Main blade continue to spin after landing	The gyroscope is not under the state of level	After turn on the Drone the fine-tuning to return-to-Zero/Refresh Drone)

PRECAUTIONS:

1. The remote controlled distance will be shorten when the power (aircraft or transmitter) is insufficient.
2. It is difficult to take off or fly too high when aircraft's power is insufficient.
3. When the aircraft is damaged, please repair it in time and stop operating, or it may lead to injury.
4. If you do not use the transmitter for along time, please remove the batteries to avoid the battery's leakage.
5. Do not drop the transmitter from the high altitude or crash it badly, otherwise, it will shorten the transmitter's using life.

Accessories

