

MagFree® Transform

3-in-1 Fast Wireless Charger

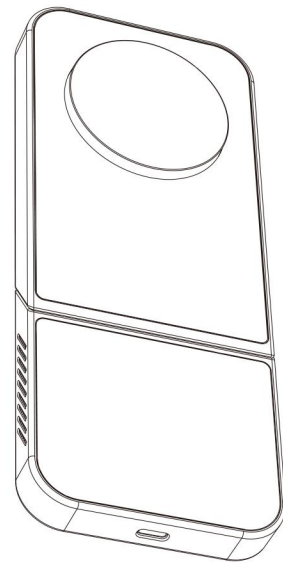

User Manual

How to Use

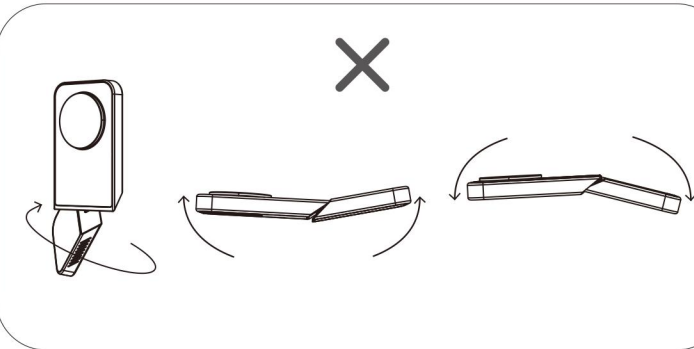
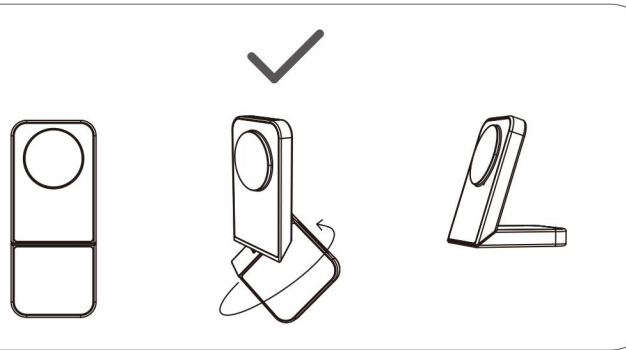

Introduction

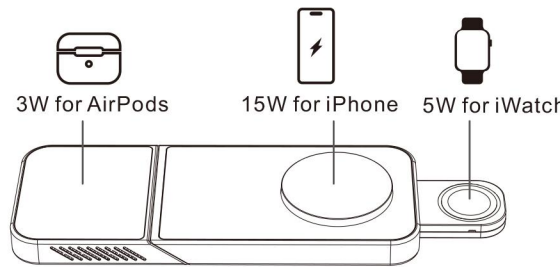

Stand Charging Mode

Flat Charging Mode

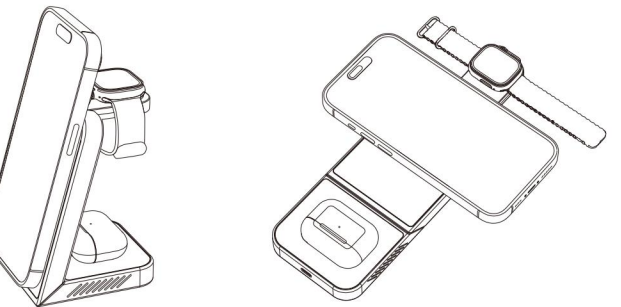

Technical Specifications

Product Name	MagFree Transform 3-in-1 Fast Wireless Charger
Model	MGF7
Input	30W
Output	30W
For iPhone	15W Max
For iWatch	5W Max
For AirPods	3W Max

- Smartphone: iPhone 15, iPhone 15 Pro, iPhone 15 Pro Max, iPhone 15 Plus, iPhone 14, iPhone 14 Pro, iPhone 14 Pro Max, iPhone 14 Plus, iPhone 13, iPhone 13 Pro, iPhone 13 Pro Max, iPhone 13 Mini, iPhone 12, iPhone 12 Pro, iPhone 12 Pro Max, iPhone 12 Mini.
- Smart Watch: iWatch 1/2/3/4/5/6/SE/7/8/9/Ultra 1/Ultra 2.
- Earbuds: AirPods 2/3/Pro 1/Pro 2.

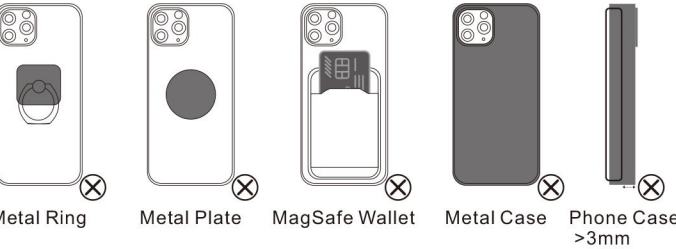

Attention

The product is designed for use with IT equipment only. Naked flame sources, such as candles, must not be placed on the product.
The disconnection from line voltage is made by AC plug. In case of broken plugs, the product must be disposed of.
If you want to clean the product, only use a dry cloth or brush.
The socket-outlet shall be installed near the equipment and easily accessible.
The power supply is not intended to be repaired by user.

Please pay attention to the following issues, otherwise it may cause abnormal charging, high charging temperature, intermittent charging, or not charging.

Not compatible with devices other than Apple, such as Samsung.

- Please put the iPhone and iWatch at the center of charge area.
- We recommend fast charger adapter higher than 30W, which can charge three devices at the same time while maintaining the fastest speed.
The other charger can only provide a normal charging speed, which will be slower than that of the fast charger.
- The wireless charging distance is 2-8 mm, please don't use iPhone case which is over 3mm thick.
- The iWatch has temperature control. When the temperature reaches 104 °F, it will stop charging automatically. If the temperature is normal, it will continue to charge.
- No metal or magnetic objects around 6cm of the back center of the phone during charging,
- The lower temperature, the faster charging speed. The charging speed is faster in winter than in summer.
- Please don't charge in high temperature and humid environments to avoid damage of circuit.
- Put it at the place that children can't reach to avoid unnecessary accidents.

Troubleshooting

- Ensure that your device is running the latest system software.
- Confirm that your device supports wireless charging functionality.
- Make sure to use the original charging cable and adapter.
- Avoid using thick device covers as they may interfere with wireless charging.
- Maintain an ambient temperature between 82-86°F for optimal charging.
- If your iPhone or iWatch fails to reach a full charge, troubleshoot by navigating the following steps in your iPhone Setting:
Open [Setting]-[Battery Health]-[Turn off battery optimization]
- If your earphones are depleted and unable to charge, remove them from the case and charge the storage compartment separately.

FCC Statement

(1) changes or modifications not expressly approved by the party responsible for compliance could void the user's authority to operate the equipment.
This device complies with Part 15 of the FCC Rules. Operation is subject to the following two conditions:
a. this device may not cause harmful interference, and
b. this device must accept any interference received, including interference that may cause undesired operation.

(2) Note: This equipment has been tested and found to comply with the limits for a Class B digital device, pursuant to Part 15 of the FCC Rules. These limits are designed to provide reasonable protection against harmful interference in a residential installation. This equipment generates, uses, and can radiate radio frequency energy, and if not installed and used in accordance with the instructions, may cause harmful interference to radio communications. However, there is no guarantee that interference will not occur in a particular installation. If this equipment does cause harmful interference to radio or television reception, which can be determined by turning the equipment off and on, the user is encouraged to try to correct the interference by one or more of the following measures:

- Reorient or relocate the receiving antenna.
- Increase the separation between the equipment and receiver.
- Connect the equipment into an outlet on a circuit different from that to which the receiver is connected.
- Consult the dealer or an experienced radio/TV technician for help.

Customer Service

- 12-month limited warranty*
- Garantie limitée de 24 mois
- 12ヶ月限定保証
- 有限保修 12 个月

* Please note that your rights under applicable law governing the sale of consumer goods remain unaffected by the warranties given in this Limited Warranty.

Lifetime Technical Support
Email: support@invzi.com
Website: www.invzi.com

iPhone®, Apple Watch®, and AirPods® are trademarks of Apple Inc., registered in the U.S. and other countries.