



# U.S. Solid WiFi Switch Module

## User Manual

(Version 1.0)



## **Note**

1. To avoid product damage and personal injury, please read this User Manual carefully, and keep it for further use.
2. Keep the product out of reach of children.

## **Product Features**

- It can be installed easily and conveniently with quick connector.
- The perfect combination of WiFi switch module and traditional device makes your life easier. With “Smart life” APP, you can control the device anytime and anywhere.
- Amazon Alexa & Google home audio controls supportable.
- Countdown & timing functions supportable.
- Share your settings with family members.

## **Product Parameters**

Name: WiFi switch module

Input voltage: DC 5-12V 50/60Hz

Output voltage: DC 5-12V 50/60Hz

Maximum Current: 10A

Maximum Power: DC 12V --- 120W

DC 5V --- 50W

# How to use

## ● Warning

1. For your safety, be sure to connect under the state of power off.
2. Do not confuse the input end with the output end of the WiFi switch module, and pay attention to the prompt on the panel.

## 1. Connect Circuit

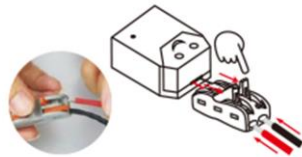
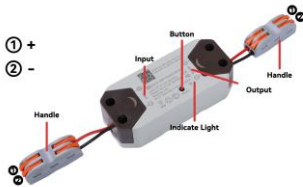

1. Connect the input into the DC power supply and then the output into the device.
2. Open the handle to 90°, insert the positive pole and the negative pole. Then pull the handle down.

## 2. Download & Sign Up



1. Scan QR code above or download App "Smart Life" from App store or Google play.
2. Sign up and log in using email.  
Tip: Only 2.4GHz is supported.

### 3. Use WiFi Switch Module to Pair App

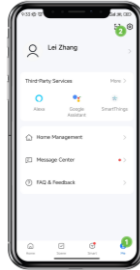
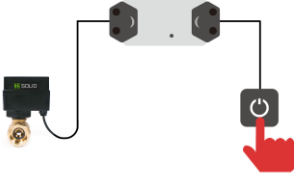

1. Turn on the DC power. The device is turned on.

2. Scan the QR code on the product shell with “Smart Life” App.

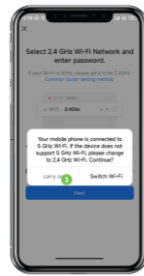
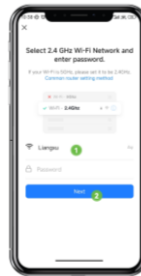
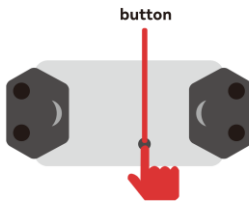

3. Long press the RESET button and release button until the indicator light blinks rapidly.

4. Enter password, click next, and click carry on.

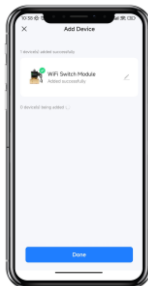

5. Connect device and Add device.

6. Welcome to the user interface.

More personalized features await your exploration. If there is any problem in this process, contact us for help.

## CONTACT US

Email: [service@ussolid.com](mailto:service@ussolid.com)

Website: <https://ussolid.com>

## **FCC WARNING**

This device complies with part 15 of the FCC Rules. Operation is subject to the following two conditions: (1) this device may not cause harmful interference, and (2) this device must accept any interference received, including interference that may cause undesired operation.

Any changes or modifications not expressly approved by the party responsible for compliance could void the user's authority to operate the equipment.

NOTE: This equipment has been tested and found to comply with the limits for a Class B digital device, pursuant to Part 15 of the FCC Rules. These limits are designed to provide reasonable protection against harmful interference in a residential installation. This equipment generates, uses and can radiate radio frequency energy and, if not installed and used in accordance with the instructions, may cause harmful interference to radio communications.

However, there is no guarantee that interference will not occur in a particular installation. If this equipment does cause harmful interference to radio or television reception,

which can be determined by turning the equipment off and on, the user is encouraged to try to correct the interference by one or more of the following measures:

- Reorient or relocate the receiving antenna.
- Increase the separation between the equipment and receiver.
- Connect the equipment into an

outlet on a circuit different  
from that to which the receiver  
is connected.

-- Consult the dealer or an experienced radio/TV technician for help.

To maintain compliance with FCC's RF Exposure guidelines, This equipment should be installed and operated with minimum 20cm distance between the radiator and your body: Use only the supplied antenna.