

Smart Scene Music Lamps Instruction

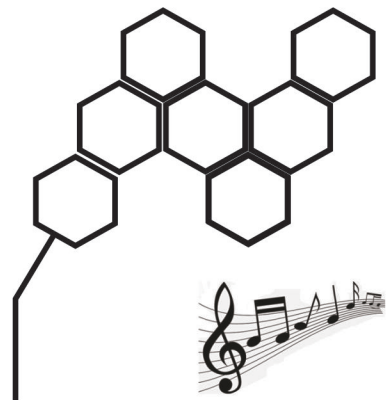

installation instructions

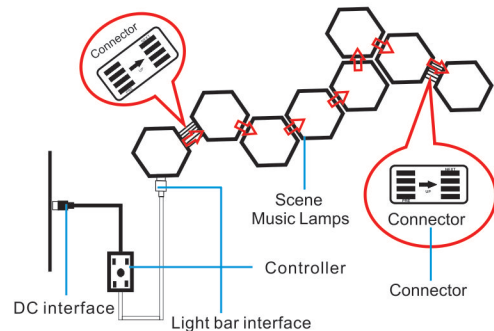

Basic parameters:

Control method: mobile APP/Controller
Working temperature: -20 degrees-+60 degrees
Power: 2.2W/PC
Power supply voltage: 5V (USB)

Cautions:

1. The maximum load of a single USB power cable is 10PCS hexagonal lights. Hexagonal lights exceeding the number will not work. If you need to connect more hexagonal lights, you have to add more USB power cables.
2. The hexagonal lights are cascaded in the direction of the arrow through the connector.

Applicable places: study rooms, living rooms, bedrooms, gyms, music bars, coffee shops and other home and commercial places.

Product Description

Bluetooth Symphony Controller

Support system : Android 4.4 and above / iOS 11.0 and above
Connection mode : Bluetooth 4.0

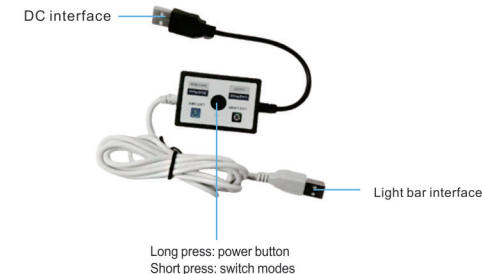

product characteristics



Download App Software

Please search LED LAMP in major Appcenters, or scan below QR code.



1. Download the "LED LAMP" APP with your mobile phones by scanning the QR code on user manual or search the "LED LAMP" APP in iPhone APP store or Google play store.
2. After the APP are downloaded successfully, you need to turn on Bluetooth function on your phone firstly, then plug in the strip light, then open the APP, your APP will pair with the strip light automatically and you can control it.

☆Android phones need to open the location function and allow permission

Unable to Connect Troubleshooting

- (1) Check if the power supply of the light strip is normal.
- (2) Check if the Bluetooth is turn on.
- (3) Check if there are other mobile phone are connected, Bluetooth 4.0 only support connections one to many, dose not support many to many.
- (4) Check APP Bluetooth setting if the phone is connected to the device, if connect, exit the APP and reopen, the APP will go to connect automatically.
- (5) Normal operations and can not connect, please exit the APP and reopen.
- (6) Exit APP, restart mobile phone, power on the strip light, reopen the APP, then them will connect automatically.

Instructions

Open the app, click the icon: LED DMX, and then enter the Bluetooth control interface.



1. Settings: You can set rhythm, RGB sort, Adjust pixels code, timing, shake, change skin, rhythm can design your own color.

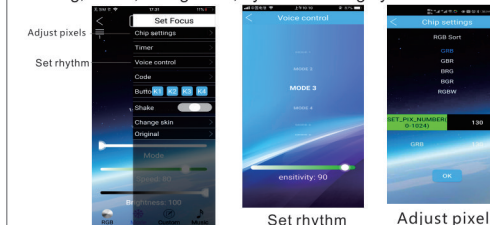

Adjust pixels

The default factory pixel count of the APP is 130, i.e. 10PCS hexagon lights, the part beyond that will not work. When the number of pixels does not match the number of hexagon lights you have connected, you need to change the number of pixels, and the number of pixels should be increased by 13 for each additional PCS hexagon light.

2. Color interface: The color interface has three parts: color ring, aisle and monochrome.



3. Mode interface: you can choose the mode, adjust the speed, adjust the brightness what you want;



5. Music interface has two modes, music and microphone, in music mode, the color changes by your mobile phone music; in microphone mode, the color changes by exterior sound.

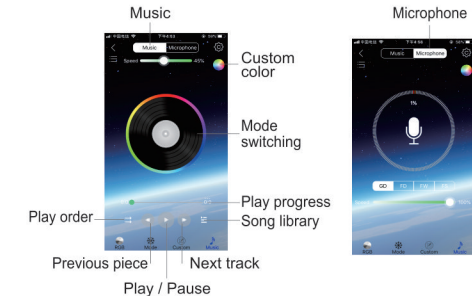

6. Timer: You can set the specified time period to open or close the mode. After adding the timing, click the "Send Timing" button

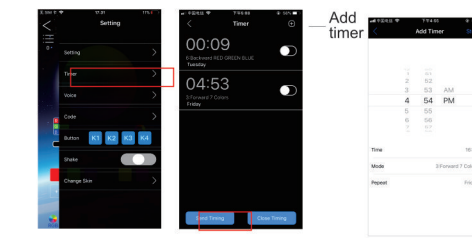

FCC Warning Statement

Changes or modifications not expressly approved by the party responsible for compliance could void the user's authority to operate the equipment. This equipment has been tested and found to comply with the limits for a Class B digital device, pursuant to Part 15 of the FCC Rules. These

limits are designed to provide reasonable protection against harmful interference in a residential installation. This equipment generates uses and can radiate radio frequency energy and, if not installed and used in accordance with the instructions, may cause harmful interference to radio communications. However, there is no guarantee that interference will not occur in a particular installation. If this equipment does cause harmful interference to radio or television reception, which can be determined by turning the equipment off and on, the user is encouraged to try to correct the interference by one or more of the following measures:

- - Reorient or relocate the receiving antenna.
- - Increase the separation between the equipment and receiver.
- - Connect the equipment into an outlet on a circuit different from that to which the receiver is connected.
- - Consult the dealer or an experienced radio/TV technician for help.

This device complies with part 15 of the FCC Rules. Operation is subject to the following two conditions: (1) This device may not cause harmful interference, and (2) this device must accept any interference received, including interference that may cause undesired operation.

RF Exposure Statement

To maintain compliance with FCC's RF Exposure guidelines, This equipment should be installed and operated with minimum distance of 20cm the radiator your body. This device and its antenna(s) must not be co-located or operation in conjunction with any other antenna or transmitter.