

CIEVIE

C200

USER MANUAL **V2.02**

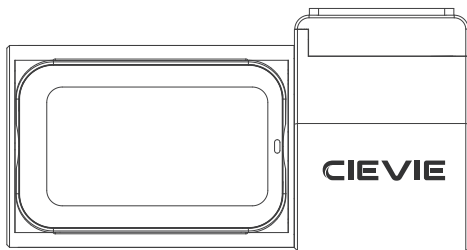

Email: support@cievie.co

For customer support or technical assistance, please contact us.



SIGN UP NOW!

Simply contact us via email or WhatsApp



Email



WhatsApp

Menu

Safety Precautions and Usage Guidelines	01
Specifications	02
Tips Before Using	03
Package List	04
Unit Structure Appearance & Buttons	05
Dash Camera Installation	06
Power Supply Instructions	10
Wi-Fi Configuration	12
App Intro & Camera Settings	14
Micro SD Card & Playback Videos	18
FAQ	20
Contact Us	22
Warning Statement	23

Safety Precautions and Usage Guidelines

Please read this manual thoroughly before use. Keep it for future reference, as it can help with troubleshooting and resolving any operational issues. Failure to follow these safety guidelines may result in damage, serious injury, or even death.

- **Exposure:** Avoid water, rain, moisture, or high humidity. Use only in dry environments.
- **Installation:** Mount securely, ensuring no obstruction to airbags or driver's view.
- **Powering the Device:** Only use the provided car charger or a CIEVIE hardwire kit (sold separately). Do not connect it directly to the car's 12V/24V battery.
- **Maintenance:** Clean the lens with a soft, damp cloth. Avoid abrasive chemicals or solvents that may scratch the lens and reduce video clarity. Inspect power cables regularly for damage.
- **Environmental:** Keep the device away from extreme heat, dust, or flames.
- **Repairs:** Never attempt to open, disassemble, or repair the device yourself. For assistance, contact support@cievie.co
- **Adjustments:** Do not install or adjust the camera while driving. Always pull over to a safe location before making any changes.

General Safety Notes

- **Car Use:** This product is designed for use inside cars only and is not intended for outdoor use.
- **Children's Safety:** Keep the dash cam out of children's reach, as it is not a toy.
- **Compliance:** Ensure installation complies with local laws, as some areas restrict mounting devices on windshields.

Specifications

Name	Dash Cam
Model	C200
Resolution	4K
Wide Angle	170°
Lens Aperture	F2.0
Working Temperature	-20°C ~70°C
Micro SD Card	64-256GB
Power Supply	5V/2A
Power Interface	Type C
Anti-Flicker	50/60HZ
WiFi	Supported
Microphone & Speaker	Supported
Loop Recording	Supported
G-Sensor	Supported
24H Parking Monitoring	Supported (Hardwire Kit Required)
Time-Lapse	Supported (Hardwire Kit Required)

Tips Before Using

Thank you for choosing CIEVIE! If you experience any issues with your camera, don't hesitate to contact us—we're always here to assist you.

Please read before use

1. What to Do If You Encounter a Memory Card Error Message:

- Ensure you are using the included CIEVIE micro SD card. If you prefer to upgrade to a higher capacity, we recommend using a Class 10 U3 or higher-speed micro SD card (64GB-256GB).
- Make sure to format the SD card using the **GPU GO** app before the first use.
- If the error persists, please contact support@cievie.co for assistance.

2. Parking Monitoring Mode

The 24-Hour Parking Monitoring feature is available only when the dash cam is connected to a Type-C hardwire kit. If you need help, simply scan the QR code below to reach our customer support team.



To watch **tutorial videos** or discover more about CIEVIE, please visit:



Youtube: @Cievie-dashcam



Facebook: cieviedashcam



Instagram: cieviedashcam



Package List

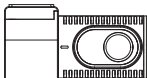

① Dash Cam

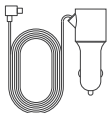

② Car Charger Adapter

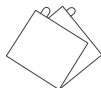

③ Electrostatic Stickers *2



④ 3M Adhesive Tape *2



⑤ User Manual



⑥ Cable Clips *5



⑦ Pry Tool



⑧ 64G SD Card

Unit Structure Appearance & Buttons

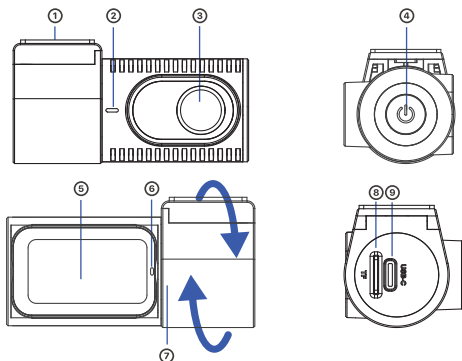

- | | | |
|--------------------|------------------------|----------------------|
| ① 3M Adhesive Tape | ④ Function Button | ⑦ Adjustable Mount |
| ② Microphone | ⑤ 1.47" Display | ⑧ Micro SD Card Slot |
| ③ F2.0 Lens | ⑥ LED Status Indicator | ⑨ Type-C Port |

Function Button:

- **Press Once:** Start recording locked videos.
- **Long Press for 3 Seconds:** Restore the camera to factory settings (One Beep).

Dash Camera Installation

1. Inserting the Micro SD Card

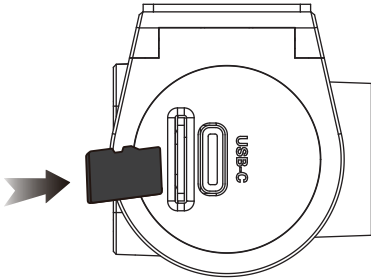

- A 64GB SD card is included. If replacing, use a Class 10 U3 or higher-speed micro SD card (64GB-256GB).
- Format the SD card using the **GPU GO** app before first use.
- To maintain optimal performance, it is recommended to format the SD card monthly to ensure the camera functions properly.

2. Installing the Dash Camera

Choose a location with clear visibility and easy access. Clean and dry the surface for proper adhesion.

a: Peel and attach the electrostatic sticker to the selected location.

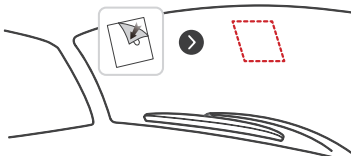

b: Remove the protective film from the 3M adhesive tape on the Dash Cam.

Tear off

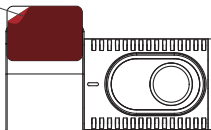

c: Firmly press the Dash Cam onto the electrostatic sticker to secure it in place.

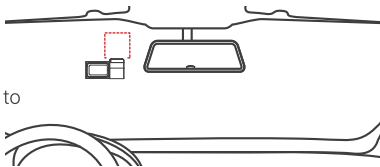

3. Connection of Power Supply

Use the original car charger adapter to connect the dash cam to your car's cigarette lighter socket for power.

NOTE

- The package includes only a cigarette lighter car charger. If your car does not have a cigarette lighter socket, you can use a Type-C cable or a hardwire kit (neither included). Please contact **support@cievie.co** for a Type-C cable or a hardwire kit.
- Ensure the camera's view is clear and unobstructed by window tint, decals, or any other objects.

Warning

For cars equipped with side curtain airbags, carefully route cables to avoid interfering with the airbags. Do not run cables through areas that could obstruct airbag deployment.

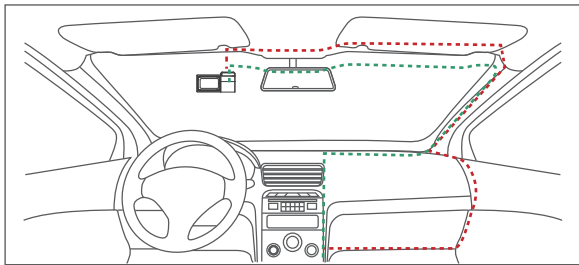

4. Adjust the Lens Angle of The Camera

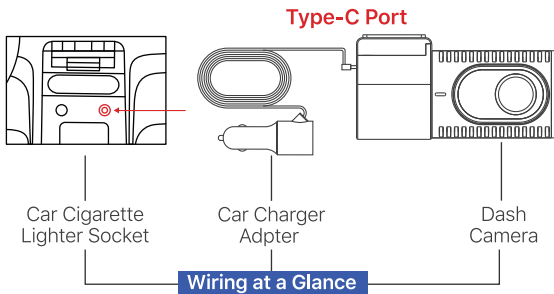
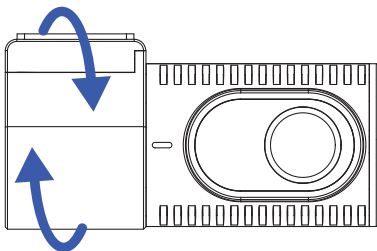

NOTE

After a test drive, check to ensure all videos were recorded correctly.

Power Supply Instructions

1. Using the Supplied Charger

Always use the included charger to power and charge your dash cam for optimal performance.

2. Connecting to the Cigarette Lighter Socket

Insert the car charger into the 12V cigarette lighter outlet of your car. The dash cam will automatically turn on and begin recording when power is supplied. When power is cut off, the device will save the current recording and shut down safely.

3. SD card Handling

- Insert the SD card before powering on the dash cam.
- Avoid inserting or removing the SD card while the device is powered on to prevent damage or data loss. Always turn off the dash cam first.

Connecting to Vehicle Power Outlets

1. Cars with Ignition-Controlled Outlets

In most cars, the 12V cigarette lighter outlet is linked to the ignition, providing power only when the engine is running or the key is in the ACC position. The dash cam will turn on and start recording when the car starts, and turn off when the engine shuts down.

Optional: To keep recording while the car is off (e.g., for parking monitoring), use a CIEVIE Type-C Hardwire Kit to connect the dash cam directly to the car's fuse box.

2. Car with Constant Power Outlets

Some cars have a 12V outlet that remains powered even when the car is turned off and locked. In this setup, the dash cam will continue recording after the car is turned off. This may lead to the car's battery being drained.

Solution:

- **Install a Hardwire Kit:**

Use a **CIEVIE Type-C Hardwire Kit** to connect the dash cam to car's fuse box. This provides proper power management and prevents excessive battery drain.

- **Reconfigure the Fuse Box:**

Adjust the fuse box to power the 12V outlet only when the key is in ACC or ON. Refer to the car manual or consult a professional.

- **Manually Disconnect the Dash Cam:**

Unplug the dash cam when leaving the car to prevent battery drain, remembering to reconnect it before the next drive.

Wi-Fi Configuration

Wi-Fi Feature and Range

The CIEVIE dash cam connects wirelessly to your smartphone via Wi-Fi, enabling you to view, download, and share recordings easily. The Wi-Fi range is up to 6 meters (19 feet) without obstructions. For faster file transfers, use within 3 meters.

How to Connect Wi-Fi

Follow these steps to connect your dash cam to Wi-Fi:

① Scan the QR code below to download the **GPU GO** app from the Google Play Store or Apple App Store. Ensure the C200 is connected to a power source while using the WiFi function. If not, the dash cam's WiFi may disconnect.









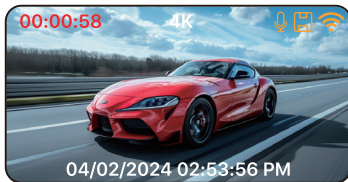

iOS/Android

- ② Enable WiFi on your smartphone.
- ③ Open the **GPU GO** app and grant the necessary permissions (album, location, WLAN, and cellular data). Failure to grant permissions may result in app malfunctions.
- ④ In the app, click "Add Camera", select "Connect Device", and then choose "Connect WiFi".
- ⑤ Locate the C200's WiFi network (e.g., CIEVIE_C200_xxxxxx) in the WiFi settings, connect, and enter the password: 12345678.

Screen Display



 00:00:00 Standard Video Recording Started	 00:00:00 Locked Video Recording Started
 Microphone ON	 Microphone OFF
 SD card Installed	 SD card NOT Installed SD card is Defective
 WiFi Connected	 WiFi Not Connected
4K Current Video Resolution	04/02/2024 02:53:56 PM Current Time & Current Date

Indicator Status

Blue light flashes slowly - Recording Video
Blue light flashes fast- Updating Firmware
Solid blue led - Not Recording Video

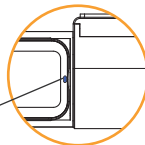

App Intro & Camera Settings

1. App Interface Overview

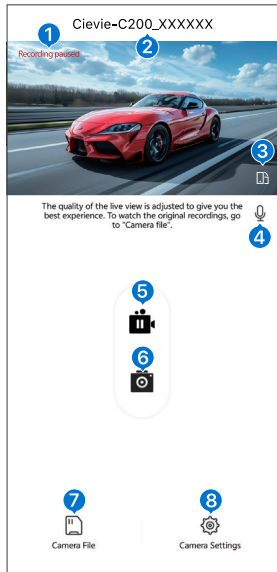

- 1 Recording/Pause Status
- 2 Camera's WiFi Name
- 3 Full Screen
- 4 Microphone
- 5 Start/Stop Recording
- 6 Take a Photo
- 7 Camera Files
- 8 Camera Settings

2. Camera Files

Loop: Video files are recorded in a loop, with the oldest files automatically overwritten when storage is full.

Snapshot: Captured photos are saved in the designated folder.

Locked: Emergency videos are protected and saved as locked files, triggered by the G-sensor or manual activation.

NOTE

For optimal quality, download the video for viewing, as the app's preview resolution is limited to 540P, while the actual video resolution is 4K.

3. Camera Settings

NOTE

New SD cards must be formatted in the app. Go to GKU Go App → Connect Camera → Camera Settings → Format SD Card. If formatting via the app fails, format the SD card to FAT32 on your computer, then reformat it in the app.

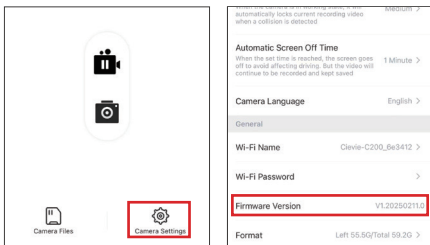

Video Settings

Sound Recording: Enable or disable voice recording based on your preference.

Speaker Volume: Adjust the speaker volume or turn it off if it's too loud.

Video Resolution: Available in 4K (Default) and 2.5K. Higher resolution provides better quality but uses more storage space.

Loop Recording: 1 Minute (Default)/3 Minutes/5 Minutes
Loop recording enables the dash cam to continuously record by overwriting the oldest video files when the SD card is full. The video files will be split into appropriate lengths based on the selected time.

Anti-Flicker/Light Source Frequency: 50Hz (Europe) / 60Hz (USA) (Default)

Time Stamp/Time Watermark: On (Default) / Off

Front Rotation: Adjust the dash camera's vertical flip.

24-Hour Time: Switch between 12-hour and 24-hour time formats.

Date Format: Adjust the time watermark format.

Status Lights: Toggle the dash camera's indicator light on or off.

5G Wi-Fi: Toggle between 5G Wi-Fi and 2.4G Wi-Fi.

Advanced Settings

Auto Screen Off Time: Off / 30 Seconds / 1 Minute / 3 Minutes
Set the auto-off time for the dash camera screen.

Collision Sensing: Off / Lowest / Lower / Low / Medium / High

The 6-axis impact gravitational accelerometer detects shocks or collisions. When triggered, the current video file is locked and saved to prevent overwriting. This ensures important footage is preserved. You can adjust the sensitivity through the app to suit your preferences and driving conditions.

Camera Language: Only works for switching the language on the dash cam display.

Parking Mode (Hardwire Kit Required)

NOTE

A Type-C hardwire kit is required for parking monitoring. Please contact support@cievie.co to obtain one.

The CIEVIE C200 features a built-in Parking Mode, allowing recording after parking your car.

Parking Monitoring Mode Options:

Off (Default); Wake up on Collision; Time-lapse Recording 12/24 Hours

Feature Explanations

1. Wake up on Collision:

When the car is parked, the dash cam will wake up and start recording in emergency mode if a collision is detected, and if the impact reaches the set "Collision Sensing" level. The video length will be based on your "Loop Recording" setting. For example, if Loop Recording is set to 1 minute, the dash cam will record a 1-minute video, lock and save it in the Lock Folder in the [GKU GO](#) app (Camera Files), then turn off. If you view the SD card files on a computer, the locked file will appear in the Event Folder.

2. Time-lapse Recording 12/24 Hours:

In parking mode, the dash cam will record in time-lapse mode for 12 or 24 hours before automatically turning off.

3. Time-lapse Video FPS:

Time-lapse mode captures images at a lower frame rate, making fast motion appear smooth and sped-up when played at normal speed. Select from 1, 2, or 5 frames per second, or turn off the feature. Once the preset time for parking mode is reached, the camera will stop recording and automatically turn off.

General Settings

Wi-Fi Name: The default name is **CIEVIE_C200_XXXXXX**. You can customize the name from the app.

Wi-Fi Password: The default password is **12345678**. When you forget the password, press and hold the function button for 3 seconds.

Firmware Version: Displays the current firmware version. Use this to check if a firmware update is needed.

Format: Formats the SD card, erasing all stored files. Back up important files before formatting.

Factory Reset: Restores the camera to its original factory settings.

Micro SD Card & Playback Videos

Inserting a Micro SD Card

To Install: Ensure the camera is OFF. Insert the SD card halfway, then push it fully in until it clicks and locks.

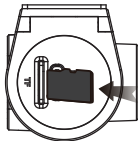

NOTE

A 64GB SD card is included. If replacing, use a Class 10 U3 or higher speed micro SD card (64GB minimum, 256GB maximum). Format the SD card using the **GPU GO** app before the first use.

Removing a Micro SD Card

To remove, gently push the edge inward until it clicks, then pull it out.

NOTE

Do not insert or remove the SD card while the camera is powered on to avoid shutdown or file damage. Be careful when removing the card as it may pop out easily due to the spring mechanism. If an error with the SD card appears on your C200, contact **support@cievie.co** for assistance.

Formatting a Micro SD Card

Go to Camera Settings > Format > Confirm.

We recommend formatting the SD card monthly to ensure smooth operation. SD cards have a limited lifespan and may eventually become inoperable after repeated use. Replace when necessary.

Playback Recorded Videos--You can access your videos in two ways:

a. On Smart Phone

Enable the WiFi function on the camera--Open the **GPU GO** app on your smartphone--Connect to the CIEVIE C200 network using the default password "**12345678**" (unless changed). Once connected, you can playback videos directly from the dash cam via the app.

b. On PC/MAC

- Connect the camera to your PC/Mac via a USB Type-C cable. The "CarDVRC200" drive will appear on your PC/Mac.

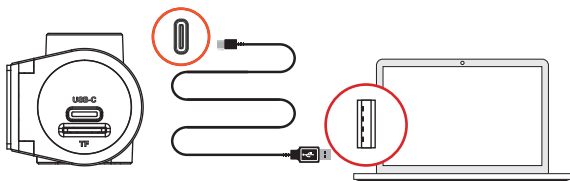

- Alternatively, remove the SD card from the camera and insert it into your PC's memory slot or use a USB Type-C card reader. Open the SD card drive and double-click the video to play.

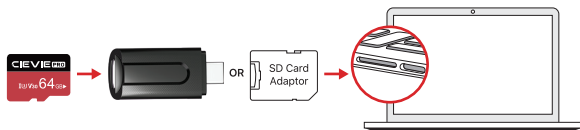

FAQ

Camera Does Not Turn On

Try using a different USB cable and your smartphone's USB charger. Plug it into a 110V wall outlet. If it doesn't respond, unplug the camera, then remove the SD card, plug the camera back in, and press the R button near the SD card slot with a pen or paperclip. If it still doesn't work, contact us.

Keep Saying "Format SD Card"

All new SD cards must be formatted in the **GPU GO** app. If it fails, format to FAT32 on your computer and reformat in the app. Use a Class 10, U3 SD card (64GB-256GB).

Error Message "Card Full"

Format the SD card in the **GPU GO** app. Set Loop Recording to 1, 3, or 5 minutes to overwrite old files automatically. Formatting deletes all data.

Can't Record 24 Hours?

The camera supports 24-hour parking monitoring only when using a Type-C hardwire kit (contact support@cievie.co to get).

Camera Automatically Shuts Down and Restarts

Check if the SD card is inserted correctly and ensure your car charger or power cable is compatible. Or try a different charger.

Video Playback Is Choppy

If streaming videos via Wi-Fi, especially 4K, slow speeds may cause buffering. We recommend downloading the video to your phone for smoother playback.

Video Quality on the App Doesn't Match 4K Resolution

The app preview is limited to 540P. For 4K quality, download the video and view it directly.

Camera Unresponsive or Freezes

Reset the camera by holding the function button for 3 seconds. If it still doesn't work, turn it off, remove the SD card, and power on again. If it works, try using a different SD card (preferably U3 or higher).

Contact Us

Thank you for choosing the CIEVIE C200 Dash Cam! We are committed to providing you with a high-quality product and excellent customer service. We hope you enjoy using your new dash cam and find it helpful in your daily driving.

We offer a one-year warranty for your peace of mind. If you have any questions or need assistance with setup or accessories, please feel free to contact us. Our team is here to ensure you get the best experience.



Email



WhatsApp

Warning Statement

The transmission of radio equipment is in vehicle use only.

FCC Warning Statement

Changes or modifications not expressly approved by the party responsible for compliance could void the user's authority to operate the equipment. This equipment has been tested and found to comply with the limits for a Class B digital device, pursuant to Part 15 of the FCC Rules. These limits are designed to provide reasonable protection against harmful interference in a residential installation. This equipment generates uses and can radiate radio frequency energy and, if not installed and used in accordance with the instructions, may cause harmful interference to radio communications. However, there is no guarantee that interference will not occur in a particular installation. If this equipment does cause harmful interference to radio or television reception, which can be determined by turning the equipment off and on, the user is encouraged to try to correct the interference by one or more of the following measures:

- Reorient or relocate the receiving antenna.
- Increase the separation between the equipment and receiver.
- Connect the equipment into an outlet on a circuit different from that to which the receiver is connected.
- Consult the dealer or an experienced radio/TV technician for help.

This device complies with part 15 of the FCC Rules. Operation is subject to the following two conditions:

- (1) This device may not cause harmful interference, and
- (2) This device must accept any interference received, including interference that may cause undesired operation.

RF Exposure Statement

To maintain compliance with FCC's RF Exposure guidelines, This equipment should be installed and operated with minimum distance of 20cm the radiator your body.

ISED Canada Statement:

This device contains licence-exempt transmitter(s)/receiver(s)/ that comply with Innovation Science and Economic Development Canada's licence-exempt RSS(s). Operation is subject to the following two conditions:

- (1) This device may not cause interference and
 - (2) This device must accept any interference, including interference that may cause undesired operation of the device.
- Radiation Exposure: This equipment complies with Canada radiation exposure limits set forth for an uncontrolled environment; To maintain compliance with IC's RF Exposure guidelines, this equipment should be installed and operated with minimum distance of 20cm the radiator your body. This device and its antenna(s) must not be co-located or operation in conjunction with any other antenna or transmitter.

Déclaration de l'ISED Canada:

Cet appareil contient des tasmittre (s) / récepteur (s) sans licence / conformes à l'innovationRSS exemptes de licence de Sciences et Développement économique Canada. L'opération est sous réserve des deux conditions suivantes:

- (1) Cet appareil ne peut pas causer d'interférences et
- (2) Cet dispositif doit accepter toute interférence, y compris peut provoquer le fonctionnement indésirable de l'appareil.

Exposition aux rayonnements: Cet équipement est conforme aux radiations du Canada limites d'exposition pour un environnement incontrôlé noncé d'exposition RF Pour maintenir le respect des guides d'exposition RF d'IC, cquipment doit être installé et actionné avec une distance minimale de 20cm le radiateur de votre corps. Cet appareil et ses antennes ne doivent pas être co-localisé ou en opération en conjonction avec toute autre antenne ou émetteur.

