

3 in 1 Wireless Charger

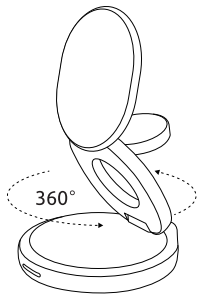

User Manual

Device Layout:

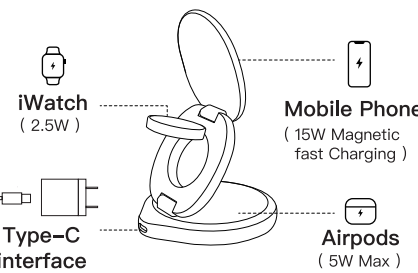
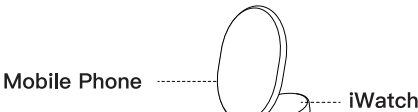

Horizontal / Vertical Mode

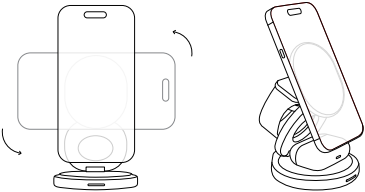

Folded Mode

Folds up minimally more portable

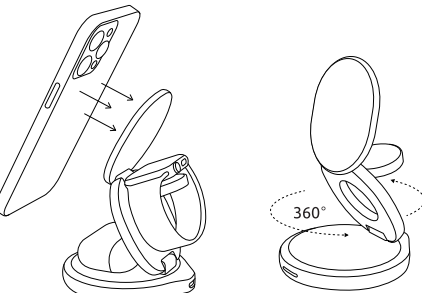
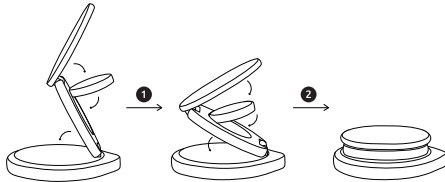

Magnetic Wireless Charging      Rotating 360° Mode

Product Parameter

Product Name: 3 In 1 Wireless Charger  
Product Size: 88\*80\*27mm  
Product Weight: 243g  
Product Material: Zinc Alloy+ ABS+Silicone  
Input: 9V/3A  
Mobile Phone Output: 15W max  
Airpods Output:5W max  
iWatch Output: 2.5W  
Charging interface: Type-C

Compatibility: support mobile phones, Airpods, and iWatch that comply with the Qi standard

Steps for usage

The device is connected to the power supply through the charging cable, and then it can be powered on.  
when charging the mobile phone, place the mobile phone in the mobile phone charging area to start charging, the magnetic wireless charging will automatically locate itself by magnetic force.

After fully charged, simply take off the phone;  
When charging the Apple Watch, place the iWatch flat in the charging area to start charging the watch. After fully charged, directly remove the iWatch;  
When charging the Airpods , place the Airpods flat in the charging area to start charging ;  
After fully charged, simply remove the Airpods;

Special Note:

1. Recommended to use the supplied charging cable for power supply, and not to use the original iPhone cable.
2. For optimal charging, please use the above 30W USB-C PD wall charger. This item certified by Qi2, requires iPhone software update into iOS 17.2 or higher.
3. If you use a protective shell, please use the mobile phone protection shell with magsafe function.

4. Please do not use the mobile phone protection shell with a metal back or the mobile phone protection shell which thicker than 4mm.

LED light status indication

Power on      LED red is on  
Standby      LED red light is on  
Charging      LED blue light is on  
Full charged      LED blue light always on  
Foreign body status: LED red and blue lights flash alternately

Packaging accessories

3 in 1 wireless charger \*1  
USB-C charging cable \*1  
Manual \*1

FCC WARNING

This device complies with part 15 of the FCC Rules. Operation is subject to the following two conditions: (1) this device may not cause harmful interference, and (2) this device must accept any interference received, including interference that may cause undesired operation. Any changes or modifications not expressly approved by the party responsible for compliance could void the user's authority to operate the equipment.

NOTE: This equipment has been tested and found to comply with the limits for a Class B digital device, pursuant to Part 15 of the FCC Rules. These limits are designed to provide reasonable protection against harmful interference in a residential installation. This equipment generates, uses and can radiate radio frequency energy and, if not installed and used in accordance with the instructions, may cause harmful interference to radio communications. However, there is no guarantee that interference will not occur in a particular installation.

If this equipment does cause harmful interference to radio or television reception, which can be determined by turning the equipment off and on, the user is encouraged to try to correct the interference by one or more of the following measures:

- Reorient or relocate the receiving antenna.
- Increase the separation between the equipment and receiver.
- Connect the equipment into an outlet on a circuit different from that to which the receiver is connected.
- Consult the dealer or an experienced radio/TV technician for help.

To maintain compliance with FCC's RF Exposure guidelines, This equipment should be installed and operated with minimum distance between 20cm the radiator your body: Use only the supplied antenna.

The content of this manual and product specifications are subject to change without notice