

miroir drivvplay

7" CarPlay & Android Auto

Quick Start Guide

Your Miroir DrivvPlay

The DrivvPlay unit connect to CarPlay and Android Auto, and features Voice Control and Bluetooth Audio.

Included in the Box



Drivvplay Unit: 7 -inch FHD display (1024x600) / touch control / Bluetooth / Wi-Fi / Audio output / Type C interface power supply



12 Volt Cord: Type C power cable / 12V-24V /3A current/integrated line/cigarette lighter



Aux Cable: 3.5 audio cable used to transmit sound to the car speakers



Tape Mount: Attach it to the center console or dash to support the DrivvPlay unit



Suction Cup Mount: Install to the back of DrivvPlay unit to attach to the windshield of the vehicle



Magnetic Mount: Attach it to the center console or dash to support the DrivvPlay unit



Manual

Learn More

To learn more about your Miroir DrivvPlay and its operations, to review specs, and find answers to frequently asked questions, please visit:

www.miroirusa.com/M1003-7

Product Description

System

Language:

Simplified Chinese / Traditional Chinese / English / Russian / Spanish / French / German / Japanese / Korean / Arabic / Italian / Portuguese

Operation Interface: Graphical menu operation

Mode of Operation: Touch

Video Display

Real-Time Display: 7-inch FHD IPS screen, 1024x600

Screen Saver:

Screen savers can be set to:

Turn off / 10 seconds / 30 seconds / 1 minute

Smart Connected

Wi-Fi: Supports Carplay / Android Auto / Airplay

Video Store

SD Card: Card can store movies and music, and play them on the smart screen after being inserted.
(SD Card not included)

Audio Port

Audio Emission: Support local speaker playback, BT Audio, FM, AUX

Microphone: Support voice control, menu can be set to turn off

Power Port

Power Input: The step-down line supports a wide voltage range of 12-24V, and has car-grade anti-surge, anti-reverse connection and other power protection.

Other

Working Temperature: -4 to 149°F

Wiring Instructions

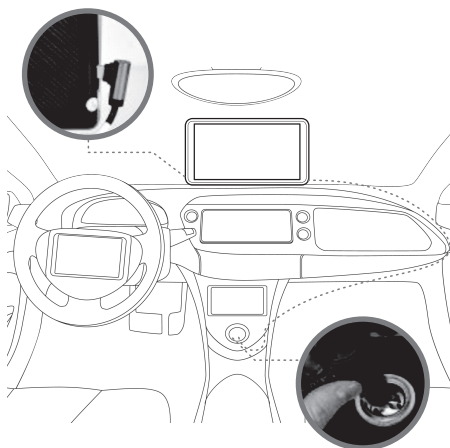

Ports:

Type C Port: Monitor power supply interface

Power Cord:

- Please use the provided power cord that was included in this package. Other power cords may provide insufficient voltage and heat control which may damage the DrivvPlay unit.
- To use Andriod Auto, you will need to use a device data cable (not included) to connect your Android device.

On-Screen Icons

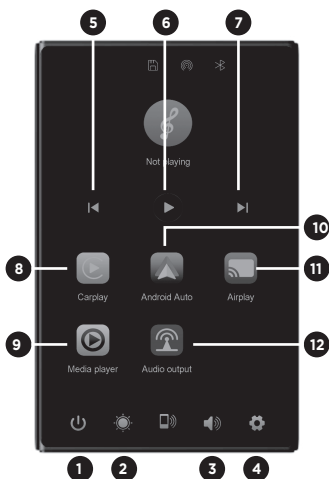

1. **Screen ON/OFF:** tap to turn off the screen
2. **Brightness:** tap to adjust screen brightness
3. **Volume:** Click to adjust the volume
4. **Settings:** Click to enter the settings interface
5. **Previous Song:** Click to play the previous song
6. **Play/Pause:** Play or pause the song
7. **Next Song:** Click to play the next song
8. **CarPlay:** Special connector for iPhone
9. **Media Player:** Click to enter the movie and music playback interface
10. **Android Auto:** Special connector for Android phone
11. **AirPlay:** Apple mobile phone can mirror screen
12. **Audio Output:** Click to select the audio playback mode

Apple CarPlay



DrivvPlay supports rotating the screen 90° and all button layouts will adjust accordingly to the rotation of the screen, but the functions will not change at all.

To rotate the screen, select the Screen Rotation button in the settings and click the Confirm button.

After clicking the confirmation button, the machine will automatically reboot and the layout adjustment will take effect after the reboot. Customers can choose to use the machine in landscape mode or portrait mode according to their own preferences.

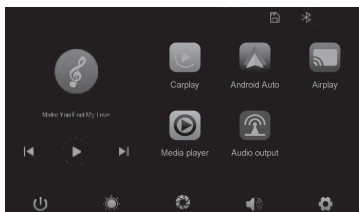

Landscape Mode

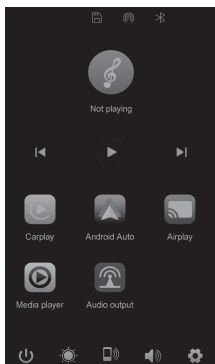

Portrait Mode

Apple CarPlay



As shown in the below figure, click the Carplay button, then select the Carplay option, and first turn on the phone's WiFi and Bluetooth, as shown in the above figure. Bluetooth will automatically turn on, named M1003. Once Bluetooth is successfully connected, you can connect to Carplay. (When the machine is powered on, it will attempt to automatically connect to the last connected phone)

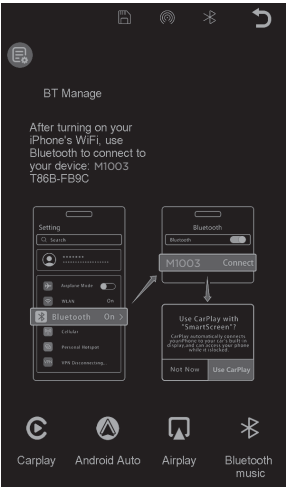

Prompting

- How to setup:
- 1.Click Carplay widget on SmartScreen
 - 2.Pair your iPhone to SmartScreen using Bluetooth: M1003
 - 3.When iPhone prompt "Use CarPlay with "SmartScreen"?", select "Use CarPlay"

- Tips:
- 1.Longer waiting for the first connection
 - 2.Only iPhone phones are supported
 - 3.After successful connection, Bluetooth will be disconnected automatically



Click the Details button for detailed connection steps and connection FAQs.



Click Assistive Touch
to display the
shortcut menu:
Back to Home
Volume Adjustment
Brightness Adjustment

NOTE: CarPlay option is only supported for Apple mobile phones. Please turn off the Bluetooth button and then the WiFi button in your phone's settings to disconnect.



1



2

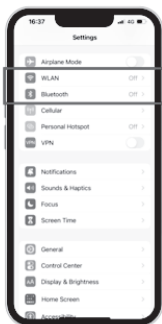

3

Android Auto



As shown in the below figure, click the Android Auto button, and then select the Android Auto option, first turn on the phone's WiFi and Bluetooth, as shown in the picture above. Bluetooth will be turned on automatically and the name will be M1003. Once the Bluetooth is successfully connected, you can connect to Android Auto. (When the machine is powered on, it will try to automatically connect to the last connected phone)

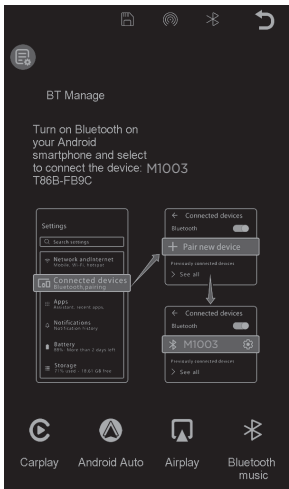

Prompting

How to setup:
1.Click Android Auto widget on SmartScreen
2.Pair your phone to SmartScreen using Bluetooth: M1003

Tips:
Please download the latest Android Auto application on your phone



Click the Details button for detailed connection steps and connection FAQs.

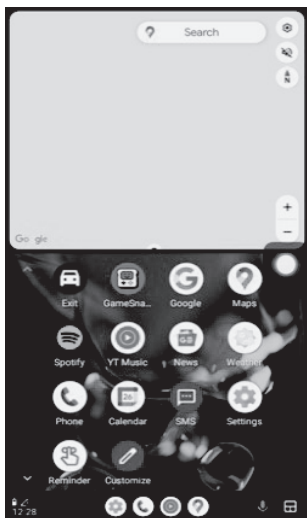

Click Assistive Touch
to display the
shortcut menu:
Back to Home
Volume Adjustment
Brightness Adjustment

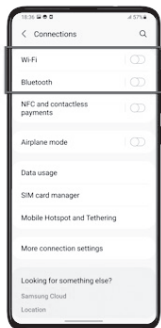

NOTE: Wireless Android Auto option is only supported for Android phones. Please forget Bluetooth in your phone's settings and turn off the WiFi button to disconnect.

AirPlay



Airplay can transmit video, audio and pictures from iPhone device to car equipment. The carrier of transmission is WiFi, which is fundamentally different from Bluetooth wireless.

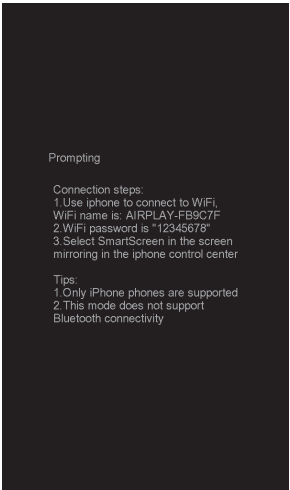
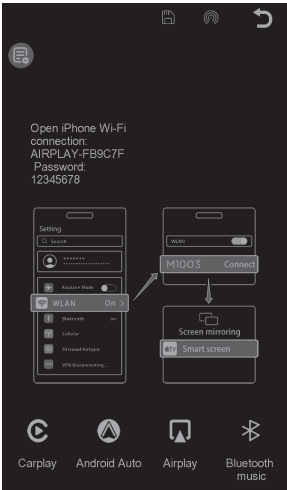

Click the Details button for detailed connection steps and connection FAQs.

1. Requires an iPhone to connect to WiFi
2. Select Smart Screen in Screen Mirroring in the iPhone Control Center

Note: Only support iPhone



Bluetooth Music



Turn on the Wi-Fi and Bluetooth of the mobile phone first, and select Bluetooth Music option. Click the BT Manage option on the interface to connect Bluetooth to the mobile phone and start playing music.

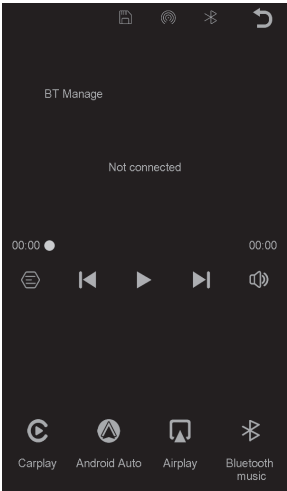

The buttons correspond to "previous song", "play/pause" and "next song" respectively.

Note: Some mobile music player apps do not support displaying lyrics

Media Player



As shown in the figure above, click the Media Player button to enter the movie and music playing interface.

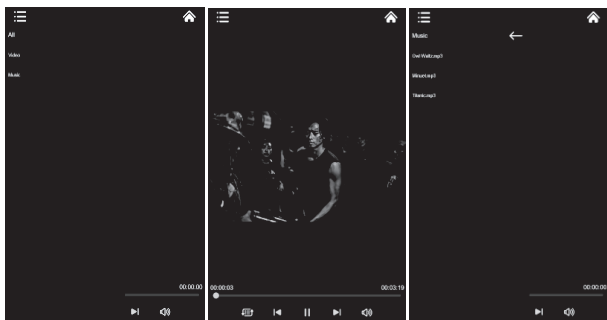

Tap to play or pause videos and music.



Tap to switch to the next video or music.



Tap to switch to the previous video or music.



List Loop / Random Play / Single Loop / Sequential Play



Click to return to the previous directory.



Click to view the video and music directory.



Click to return to the main interface.

Audio Output



As shown in the figure click the Audio Output button to enter the audio output selection interface.

Then see menu at bottom of screen:



The sound will be played from the speaker of the smart screen.



Select this mode, and then connect to CarPlay or Android Auto to cast the screen, you can use the phone's Bluetooth to directly connect to the original car's Bluetooth. After the connection is successful, all sounds from the device will be transmitted to the original car speakers via Bluetooth.



After selecting this mode, the volume icon will change to the Bluetooth transmission icon, and the volume cannot be adjusted on this device, so the volume must be adjusted on the original car.



After selecting this mode, the FM transmission mode will be turned on by default. For example, if the device's FM transmit band is tuned to FM 106.0 MHz (any unoccupied channel can be used), the car radio will also tune its receive band to the same FM 106.0 Hz. After the connection is successful, all the sounds of the device will be transmitted to the original car speakers through FM transmission.



After selecting this mode, the volume icon will change to an FM transmission icon, and the volume cannot be adjusted on this device, so the volume must be adjusted on the original car.

Note: Not using the original power cord may result in deterioration of the FM transmission signal or loss of function.



After selecting this mode, the AUX output mode will be turned on by default. Use the AUX sound source cable to connect the smart screen to the original car. After the connection is successful, all the sounds of the device will be transmitted to the original car speakers through the AUX sound source cable for playback.



After selecting this mode, the volume icon will change to the AUX output icon, and the volume cannot be adjusted on this device, so the volume must be adjusted on the original car.

Bluetooth



Click the Bluetooth button to switch on the device after entering the Bluetooth interface.

The page will display the device name, such as: M1003, and click the Modify button to modify the Bluetooth name of the device.



Select the device name with Bluetooth, and the remote device name of the phone will appear after successfully connecting.

At this time, you can play mobile phone music and other functions.

After connecting to Bluetooth, you can use the call function:



After turning on the "Auto Connect" button, even after the mobile phone is disconnected, the machine will automatically try to connect to the phone.



Click the Disconnect button to actively disconnect the Bluetooth.

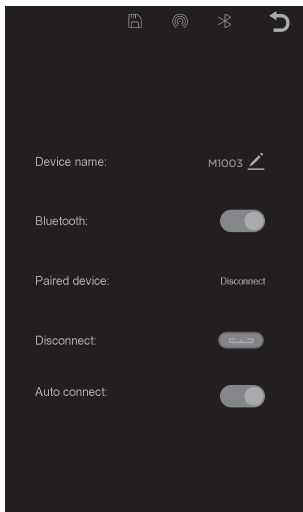

Settings



Click the settings button in the lower left corner to enter the setting interface

Reminder tone: Click to turn it off or on. After selecting off, the power on sound effect and touch and button sound effects will be turned off. *Different models may have different options, subject to the actual product.*

Reverse Line Calibration: Follow on-screen instructions.

Screen saver: Can be set as: Turn off / 10s / 30s / 1min. After setting for 10 seconds or 1 minute, if the system does not operate for the corresponding time, the screen will automatically turn off. After entering the screensaver, press the power button again to turn on the screen.

Wallpaper: Change the main interface wallpaper.

Auto-Dimming: automatically adjust the brightness time and brightness value.

Driving Position: You can choose between left-hand or right-hand drive, and the shortcut menu bar in CarPlay. Select left rudder on the left, select right rudder on the right.

Language: Can be set to: Simplified Chinese / Traditional Chinese / English / Russian / Spanish / French / German / Japanese / Korean / Arabic / Italian / Portuguese

Assistive Touch: This is the hover window button in your phone's screen casting mode, you can choose to close or open it. This feature is only supported by Carplay and Android auto mode to hide. If the customer has changed mobile phones, click to clear the connection records of all previous mobile phones.

Screen Rotation: Click to switch to portrait mode, and the machine will automatically reboot and take effect.

Factory Reset: Restore factory settings, and the system will restore all settings to their original state.

Firmware Version: This option allows you to see the current basic version for easy confirmation.

FAQs

1. You may hear a static noise when turning your car on when using your car FM radio to play CarPlay music through your car speakers. To avoid this, turn your FM radio off when you turn your car off.
2. When you use the FM to connect the DrivvPlay unit, please choose frequency that does not have a local radio station. If there is a competing signal, the DrivvPlay unit will not work. You can use the AUX cable to connect the DrivvPlay unit, which will prevent this issue.
3. Some Android phones may have wireless connection problems because different brands and system versions. So we offer wired connection for Android phone.
Method: There is a USB port on the car charger cable, you can connect your Android device to that USB port using a device data cable (not included).
4. Before connecting again, the system will auto connect your mobile phone if you have Bluetooth and Wi-Fi turned on.
5. Please use the provided power cord that was included in this package. Other power cords may provide insufficient voltage and heat control which may damage the car play unit

Miroir Safety and Warranty Information

SAVE THESE INSTRUCTIONS!

IMPORTANT SAFETY INSTRUCTIONS All of the safety and operating instructions should be read, adhered to and followed before the unit is operated.

CAUTIONS

- TO REDUCE THE RISK OF ELECTRIC SHOCK, DO NOT REMOVE COVER. THERE ARE NO SERVICEABLE PARTS INSIDE
- TO REDUCE THE RISK OF FIRE OR ELECTRIC SHOCK, DO NOT EXPOSE THIS UNIT TO RAIN OR MOISTURE.



The lightning flash with arrow-head symbol within an equilateral triangle is intended to alert the user to the presence of uninsulated "dangerous voltage" within the unit's enclosure that may be of sufficient magnitude to constitute a risk of electric shock



The exclamation point within an equilateral triangle is intended to alert the user to the presence of important operating and maintenance (servicing) instructions in the literature accompanying the unit.

DANGER

To reduce the risk of electric shock, burns, fire or injury:

1. Do not use while bathing or in a shower.
2. Do not place or store unit where it can fall or be pulled into a tub or sink.
3. Do not place in, drop or submerge in water or other liquid.
4. Do not reach for unit that has fallen into water. Unplug it immediately.
5. Care should be taken so that objects do not fall and liquids are not spilled onto the unit.

WARNING

1. Close supervision is necessary when this appliance/product is used by or near children or mentally disabled individuals.
2. Use this unit only for its intended use as described in this manual.
3. Unplug this unit during lightning storms or when unused for long periods of time.
4. Never drop or insert an object into any opening.
5. Never block the air openings of the unit with materials such as clothing, plastic bags or papers, or place it on a soft surface such as a bed or couch, where the air openings may be blocked.
6. Do not overload electrical outlet. Use only the power source as indicated.
7. Do not carry this unit by cord or use cord as handle.
8. Never operate this unit if it has a damaged cord or plug, if it is not working properly, or if it has been dropped or damaged, or dropped into water. If the unit's power supply cord or plug is damaged, do not attempt to fix it yourself.
9. To avoid the risk of electric shock, do not disassemble or attempt to repair the unit. Incorrect repair can cause risk of electric shock or injury to persons when unit is used.
10. Do not operate in the presence of explosive and/or flammable fumes.

FCC INFORMATION

This device complies with part 15 of the FCC rules. Operation is subject to the following two conditions:

1) This device may not cause harmful interference, and 2) This device must accept any interference received including interference that may cause undesired operation.

Warning: Changes or modifications to this unit not expressly approved by the party responsible for compliance could void the user's authority to operate the equipment.

Caution: To maintain compliance with the FCC's RF exposure guidelines, place the product at least 8 inches from nearby persons.

Note: This equipment has been tested and found to comply with the limits for a Class B digital device, pursuant to Part 15 of the FCC Rules. These limits are designed to provide reasonable protection against harmful interference in a residential installation. This unit generates, uses, and can radiate radio frequency energy and if not installed and used in accordance with the instructions, may cause harmful interference to radio communications. However, there is no guarantee that interference will not occur in a particular installation. If this equipment does cause harmful interference to radio or television reception, which can be determined by turning the equipment off and on, the user is encouraged to try and correct the interference by one or more of the following measures:

- Reorient or relocate the receiving antenna.
- Increase the separation between the equipment and receiver.
- Connect the equipment to an outlet on a circuit different from that to which the receiver is connected.
- Consult the dealer or an experienced radio/TV technician for help.

Shielded cables must be used with this unit to ensure compliance with the Class B FCC limits.

Caution: The radiated output power of the Wi-Fi technology is below the FCC radio frequency exposure limits. Nevertheless, it is advised to use the wireless equipment in such a manner that the potential for human contact during normal operation is minimized.

This equipment complies with FCC radiation exposure limits set forth for an uncontrolled environment. This equipment should be installed and operated with minimum distance 20cm between the radiator & your body.

ONE (1) YEAR LIMITED WARRANTY

USA & Canada Only

Miroir ("Miroir") warrants to you, the original retail purchaser ("Consumer"), that this product ("Product") will under normal use operate substantially in accordance with the accompanying documentation for a period of one (1) year from date of original purchase. Consumer's sole and exclusive remedy, and Miroir's sole and exclusive responsibility under this warranty will be, at Miroir's option, either to repair or replace the defective Product during the one (1) year limited warranty period so that it performs substantially in accordance with the accompanying documentation on the date of your initial purchase.

The forgoing warranty is limited and is not applicable to: (i) normal wear and tear; (ii) defects or damage caused by misuse, accident (including without limitation collision, fire and the spillage of food or liquid), neglect, abuse, alteration, unusual stress, modification, improper or unauthorized repair, installation, wiring, or testing, improper storage, use in an unapproved device or if the serial number has been removed; (iii) use not in accordance with the documentation; and (iv) damage caused by the equipment with which the Product is used.

To obtain warranty service for any Product that is subject to the foregoing warranty, Consumer must contact Miroir, provide proof of purchase and a description of the issue. Consumer shall bear the cost of returning the Product for repair or replacement under this limited warranty. Any Product returned without proof of purchase will not be honored under this limited warranty.

The limited warranty extends only to Consumer and is not assignable or transferable to any subsequent purchaser or user. THE LIMITED WARRANTY SET FORTH ABOVE IS PROVIDED IN LIEU OF ALL OTHER WARRANTIES AND MIROIR HEREBY DISCLAIMS ALL OTHER WARRANTIES OF ANY KIND, WHETHER EXPRESS, IMPLIED, STATUTORY OR OTHERWISE, INCLUDING WITHOUT LIMITATION ANY WARRANTIES OF MERCHANTABILITY, FITNESS FOR A PARTICULAR USE OR PURPOSE, NON-INFRINGEMENT, QUALITY AND TITLE. MIROIR DOES NOT WARRANT THAT THE PRODUCT IS ERROR FREE OR THAT IT WILL FUNCTION WITHOUT INTERRUPTION.

To the extent Miroir may not, as a matter of applicable law, disclaim certain implied warranties, the duration of any such implied warranty shall be limited to the shorter of the one (1) year limited warranty period or the minimum time period permitted under such law. Some states do not allow limitations on the duration of implied warranties, so the above limitation may not apply to you. This limited warranty gives you specific legal rights, and you may also have other rights that vary from state to state.

IN NO EVENT WILL MIROIR BE LIABLE FOR ANY SPECIAL, INDIRECT, INCIDENTAL, PUNITIVE OR CONSEQUENTIAL DAMAGES OF ANY NATURE WHATSOEVER INCLUDING BUT NOT LIMITED TO LOSS OF PROFITS OR REVENUES, LOSS OF DATA, LOSS OF USE OF THE PRODUCT OR ANY ASSOCIATED EQUIPMENT, COST OF ANY REPLACEMENT GOODS OR SUBSTITUTE EQUIPMENT, LOSS OF USE, CLAIMS OF ANY THIRD PARTIES, OR ANY OTHER DAMAGES ARISING FROM MIROIR'S BREACH OF THIS LIMITED WARRANTY OR THE USE OF THE PRODUCT, REGARDLESS OF THE FORM OF ACTION WHETHER IN CONTRACT, TORT (INCLUDING NEGLIGENCE) OR ANY OTHER LEGAL OR EQUITABLE THEORY, EVEN IF MIROIR HAS BEEN ADVISED OF THE POSSIBILITY OF SUCH DAMAGES. IN NO EVENT WILL MIROIR'S TOTAL CUMULATIVE LIABILITY EXCEED THE PRICE PAID BY CONSUMER FOR THE PRODUCT.

Some states do not allow the exclusion or limitation of incidental or consequential damages, so the above limitation or exclusion may not apply to you. If you have any questions concerning this statement of limited warranty please email Miroir at miroirusa.com for any more questions.

miroir

www.miroirusa.com

M1003-7.11.2024

© 2024 Miroir USA, LLC. All rights reserved. Miroir and the Miroir Logo are owned by Miroir USA, LLC. All other trademarks are the property of their respective owners. Miroir USA, LLC assumes no responsibility for any errors that may appear in this manual. Information contained herein is subject to change without notice.