

Wireless Charging Alarm Clock

Model: LLR068

Note before using

- To ensure the proper functioning of the wireless charging alarm clock, be sure to use the original adapter/cable to power it.



- Insert 2xAAA Batteries (Not Included) into the battery compartment to provide backup power to the clock in the event of a temporary.

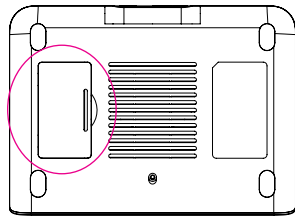

Switching 12/24 Hour Time Format

In time mode, single press **TIME-SET** button to switch 12/24-hour time format, and the time display will change correspondingly.



Time Setting

- Press and hold **TIME-SET** button for 2 seconds to enter into time-setting mode, the hour digits flash.

- Press **- +** to set the hour (hold to advance rapidly).



- Press **TIME-SET** button again, the minute digits flash.

- Press **- +** to set minute.



- Press **TIME-SET** button again, save and exit time-setting mode.

Switching Alarm ON/OFF

In time mode, single press **ALARM** button to switch ON/OFF the alarm, and the alarm's time will display on the screen correspondingly.

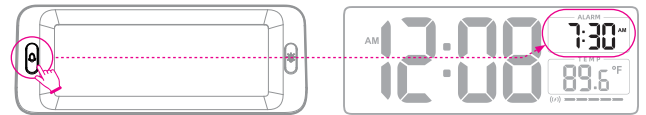

Setting Alarm Time

In time mode, press and hold **ALARM** button for 2 seconds to enter into alarm-setting mode, the hour digits flash.

- Press **- +** button to set hour (hold to advance rapidly).

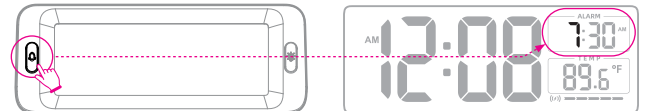

- Press **ALARM** button again, the minute digits flash.

- Press **- +** button to set minute.



- Press **ALARM** button again, save and exit the alarm-setting mode.

Stopping the Alarm When It Goes off

When Alarm is sounding, press **any buttons on the front/back** to stop and reset the alarm to go of the next day.

Setting Alarm Volume

- Press and hold **ALARM-VOL** button for 2 seconds to enter into alarm-volume setting mode. Then the buzzer will be sounding.

- Now press **- +** button to set your desired buzzer volume (65-75-85dB).



NEXT



Wireless Charging Alarm Clock

Model: LLR068

Setting Snooze Time

In time mode, press and hold **SNOOZE** button for 2 seconds to enter into snooze-time setting mode and the digits flash.

- Press **- +** button to set the snooze time.
- Press **SNOOZE** button again, save and exit snooze-time setting mode.

Snooze Time: Default 9 minutes (1-15 minutes adjustable)

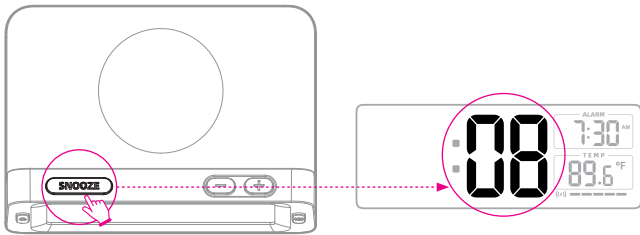

Activating Snooze When Alarm Goes off

When Alarm is sounding, press **SNOOZE** button, then the alarm will suspend and go off again after the set snooze time.

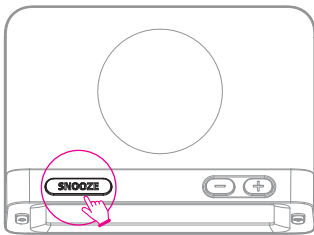

Specification of Wireless Charger

Wireless Charging Output: 10W/ 7.5W/ 5W

Compatibility with: Samsung Galaxy Phone, Apple iPhone, AirPods, OnePlus Phone and Wireless Earbuds etc.

Wireless Charging Indicators

(X)	(X)	Exception Detected
(X)		Standby...
(X)	■	Charging...
(X)	■■■■	Fully Charged

**Efficient
Charging Area**

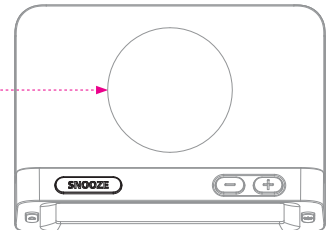

Attention

1. If your phone is not charged stably, please adjust the position.
2. The maximum effective charging distance is 5mm, so avoid wearing a very thick phone case when wireless charging.
3. Cases made of metal and attachments such as magnets, cards, and grips will interfere with charging.
4. If you have "Optimized Battery Charging" enabled on your iPhone, Apple's strategy for protecting the Battery will make wireless charging very slow and unable to fully charge your iPhone.

Specification of Alarm Clock

Backlight: 5-Level Dimmable LED Backlight

Time Format: 12/24 Hour Switchable

Alarm Duration: 5 Minutes

Buzzer Volume: 65-75-85 dB

Snooze Time: 1-15 Minutes Adjustable

Battery Backup: 2 x AAA Batteries (Not-included)

Specification of USB Charger

USB Wired Charging Output: DC 5V/2A MAX

Safely charge your non-wireless charging devices, such as Smart Watch, Tablet, Power Bank. . .

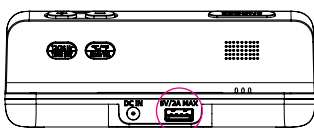

Package List

- 1 x Wireless Charging Alarm Clock
- 1 x AC-DC Adapter & Cable (DC 9V/2A)
- 1 x User Manual

Warranty

45-Day Full Refund: If you are not satisfied with the product or the product doesn't work as advertised, you can contact us for full refund.

18-Month Warranty: If there occur any quality problems within 18 months, you can contact us for replacement or partial refund.

XKX / LISRFNIEAN

Customer Service Team

Email: cst4lielongren@sina.com

FCC statement:

This device complies with Part 15 of the FCC rules. Operation is subject to the following two conditions: 1) this device may not cause harmful interference, and 2) this device must accept any interference received, including interference that may cause undesired operation.

Note: This equipment has been tested and found to comply with the limits for a Class B digital device, pursuant to part 15 of the FCC Rules. These limits are designed to provide reasonable protection against harmful interference in a residential installation.

This equipment generates uses and can radiate radio frequency energy and, if not installed and used in accordance with the instructions, may cause harmful interference to radio communications. However, there is no guarantee that interference will not occur in particular installation. If this equipment does cause harmful interference to radio or television reception, which can be determined by turning the equipment off and on, the user is encouraged to try to correct the interference by one or more of the following measures:

- Reorient or relocate the receiving antenna.
- Increase the separation between the equipment and receiver.
- Connect the equipment into an outlet on a circuit different from that to which the receiver is connected.
- Consult the dealer or an experienced radio/TV technician for help.

Changes or modifications not expressly approved by the party responsible for compliance could void the user's authority to operate the equipment.

Radiation Exposure Statement

This device complies with FCC RF radiation exposure limits set forth for an uncontrolled environment. This transmitter must not be co-located or operating in conjunction with any other antenna or transmitter. During the operation of device a distance of 15 cm surrounding the device and 20 cm above the top surface of the device must be respected.