



Contents

- English.....01-17

Important Safety Instructions

1. Please read this instruction manual carefully and follow all instructions, pay attention to all precautions.
2. Do not use this apparatus near water and clean only with dry cloth.
3. Do not block any ventilation openings, install in accordance with the installation instructions.
4. Do not install near any heat sources such as radiators, heat registers, stoves, or other apparatuses that may generate heat.
5. Do not defeat the safety purpose of the polarized or grounding-type plug: a polarized plug has two blades with one wider than the other; a grounding-type plug has two blades and a third grounding prong. If the provided ac adapter plug does not fit into your outlet, consult an electrician for replacement of the obsolete outlet.
6. Please protect the ac adapter from being walked on or pinched particularly the plugs, be careful when plugging and unplugging.
7. For better result, only use the accessories we provide.
8. Unplug this apparatus during lightning storms or when unused for long periods of time.
9. Refer all servicing to qualified service personnel. Servicing is required when the apparatus has been damaged in anyway, such as power supply cord or plug is damaged, liquid has been spilled or objects have fallen into the apparatus, the apparatus has been exposed to rain or moisture, does not operate normally, or has been dropped.
10. If you have any questions, please feel free to contact us, we will reply you as soon as possible.

Precautions

1. Please be careful not to drop and hit the sound bar, for it will damage the cavity structure and affect the sound quality.
2. Please charge with the provided AC power adapter. If you use other adapters, may cause damage to the product.
3. Please make sure the sound bar is off before you plug in.
4. Any individuals shall not be unauthorized to disassemble or left the product. Our company is not responsible for the damage to persons or product caused by this reason.
5. Never place the sound bar near fire sources, magnetic objects or anywhere with too much water.
6. To reduce the risk of fire or electric shock, do not expose this apparatus to rain or moisture.
7. As long as the machine is connected to an AC power outlet, the power will not be disconnected, even if the machine itself is turned off.
8. To reduce the fire hazard, please do not cover the vents of the device with newspapers, tablecloths, curtains, etc.
9. Do not place the appliance near fire sources like lighted candles.
10. Do not expose the appliance to drip or splash area, and do not place objects filled with liquids on the appliance.
11. As the AC power adapter is used to connect the unit with power outlet, please use an easily accessible AC outlet. If you notice an abnormality in the unit, disconnect the AC adapter from the AC outlet immediately.
12. Do not install the appliance in a confined space, such as a bookcase or built-in cabinet.
13. Do not expose the sound bar with battery-installed to overhead places, such as sunshine and fire, indoor use only.

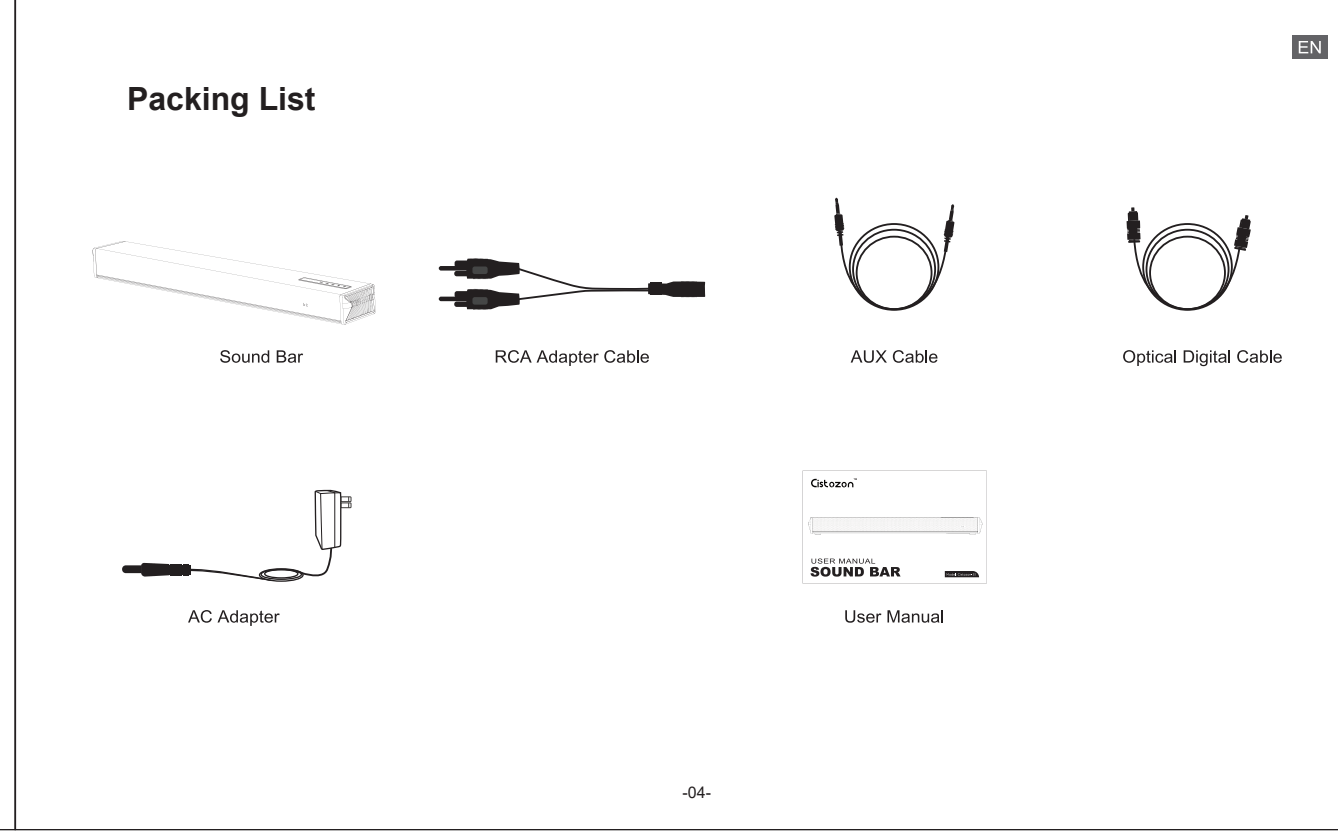
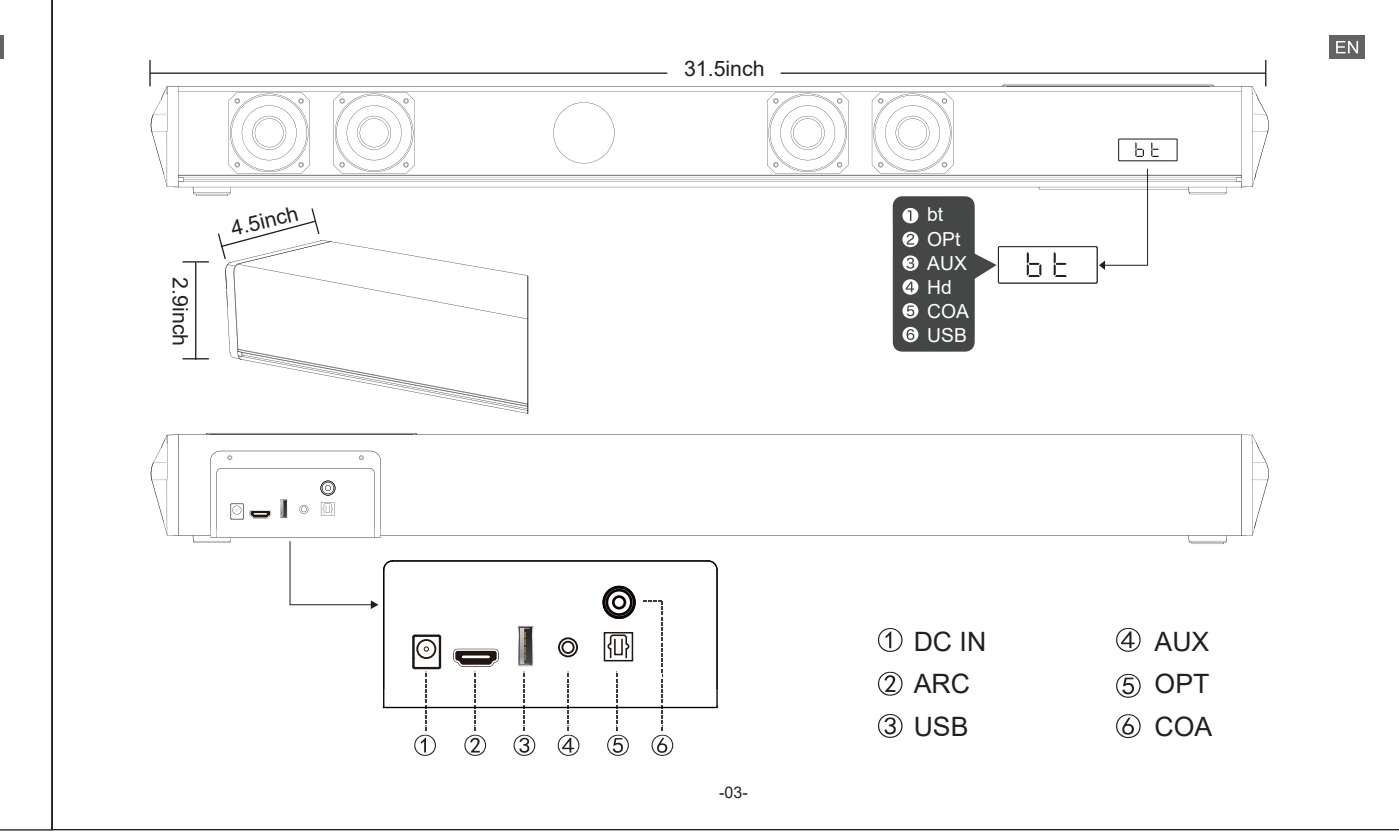

Specifications

Power Supply: DC 18V, 2.5A
Rated Power: 60W
Wireless Version: BT5.0
Frequency Response: 60Hz-20KHz

S/N Ratio: 85dB
Distortion: THD+N (1%)
Sensitivity: 95dBm(VRMS)
Dimension: 31.5x2.5x1.5 inch
Net weight: about 2.6kg

Installation Method

- You can put it just about anywhere, and it works better below your TV, will get high quality sound and clear voices.

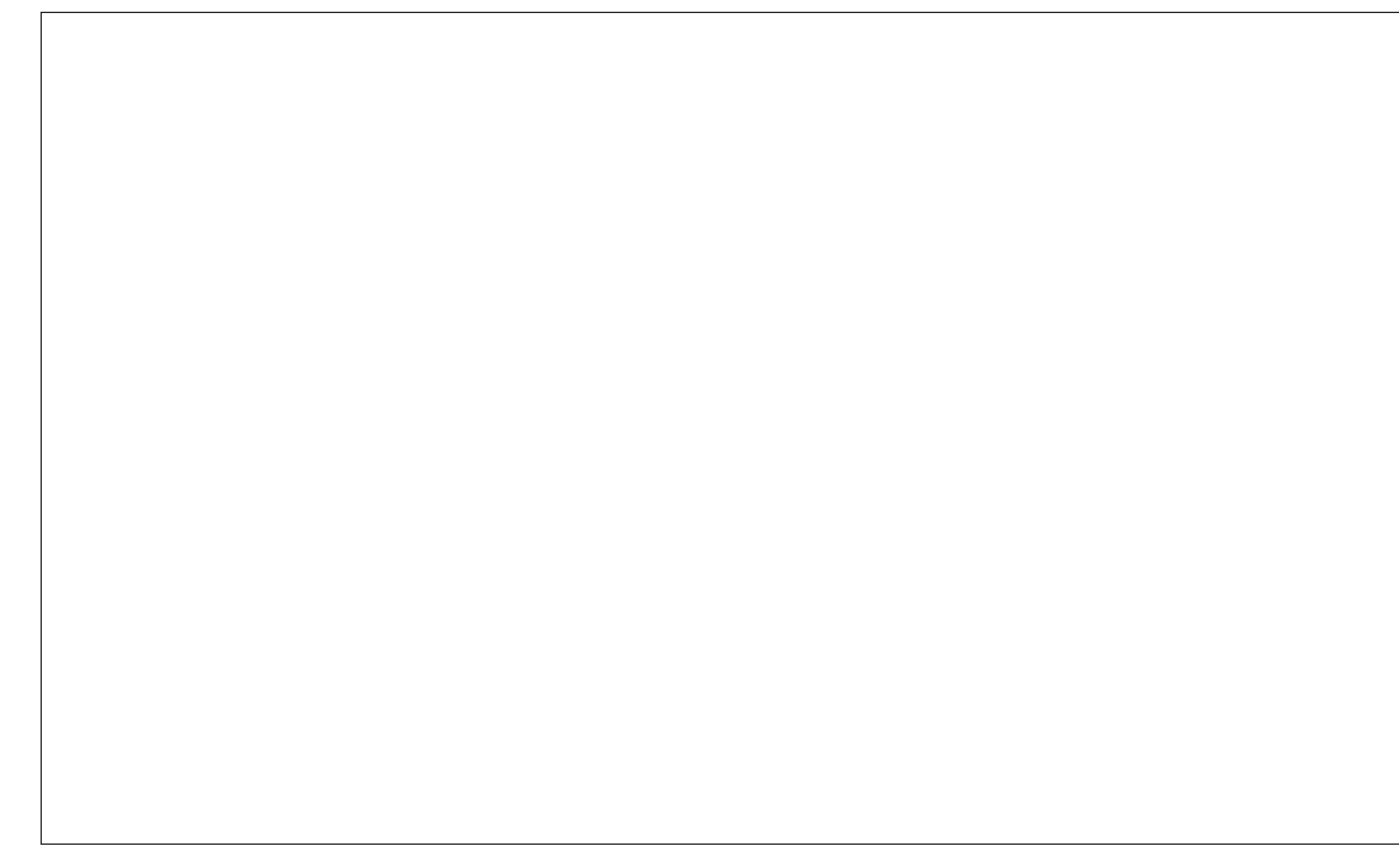
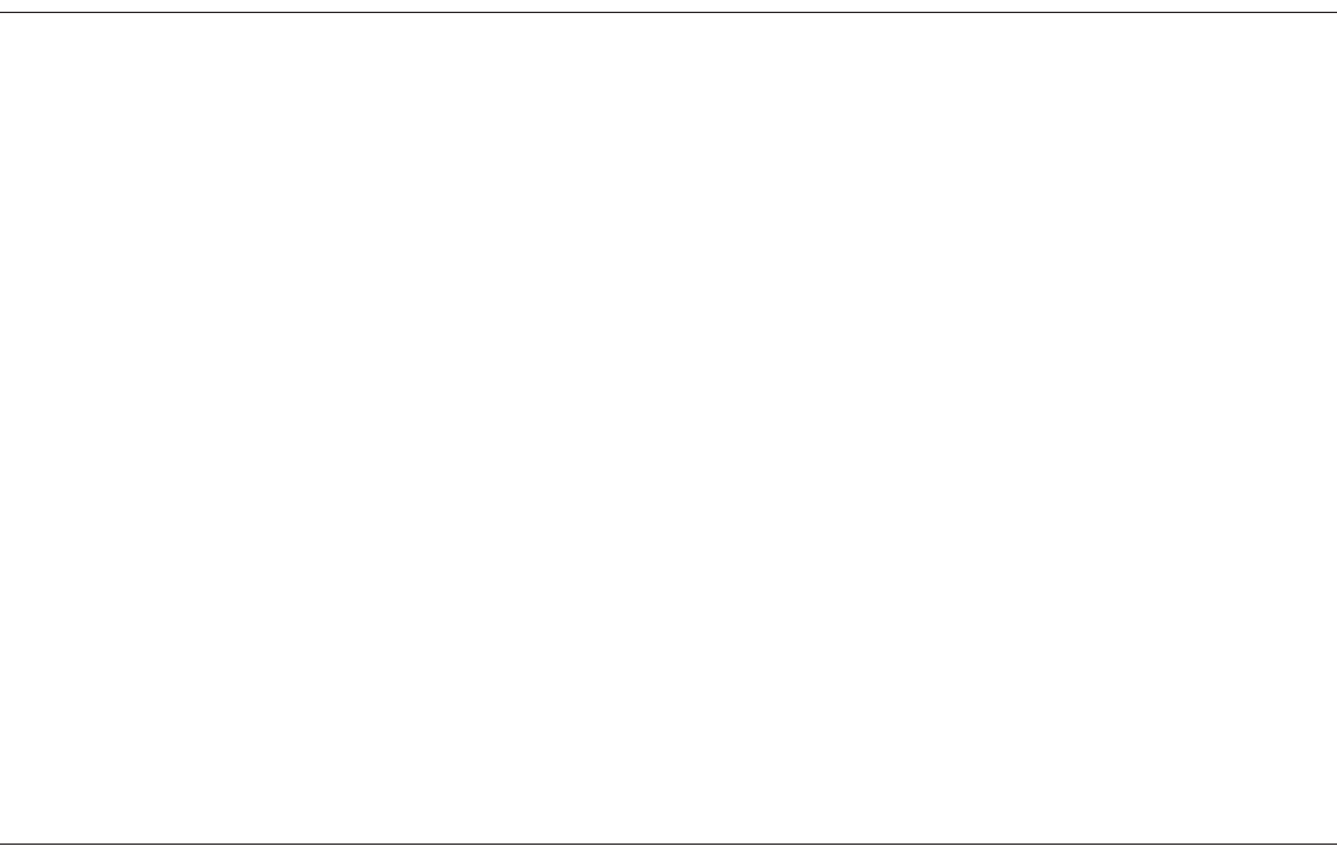

Use Guidance

1. POWER ON/OFF

1. Plug the AC adapter into power outlet, connect the DC port of adapter to the sound bar DC port, turn on the AC power switch on the back of the sound bar first, short press the power button on the sound bar for 2s to switch on, short press 2s again to switch off.
2. When disconnecting the power cable of the AC power adapter from a wall outlet, pull the plug, do not pull the cable.
3. Do not connect this unit or other components to AC power outlet until all connections of components are completed.
4. Make sure to place the AC adapter flat on a table or the floor. Please be careful not to let water or other foreign objects enter the adapter, for these objects may cause adapter malfunction.

2. AUDIO INPUT MODES

This sound bar provides with 6 audio input ways: Bluetooth, AUX, HDMI ARC, Optical Fiber, USB, Coaxial. You can switch the mode by pressing the "MODE" button on the top side of the soundbar or using the remote control.

1. BT (Bluetooth Mode)

Turn on the AC power switch of the sound bar, press the "BT" button on the remote control or on the top side of the sound bar to enter Bluetooth mode, use phone, TV or devices with Bluetooth function to search for the Bluetooth named "Cistozon S1" for pairing, the sound bar will play after pairing successfully. If you cannot connect with the sound bar, maybe someone else has connected to your sound bar already, at this time, you need to long press the "Play & Pause" button on the remote control or on the top side of the sound bar to disconnect the Bluetooth connection by force, after that, you can connect again.

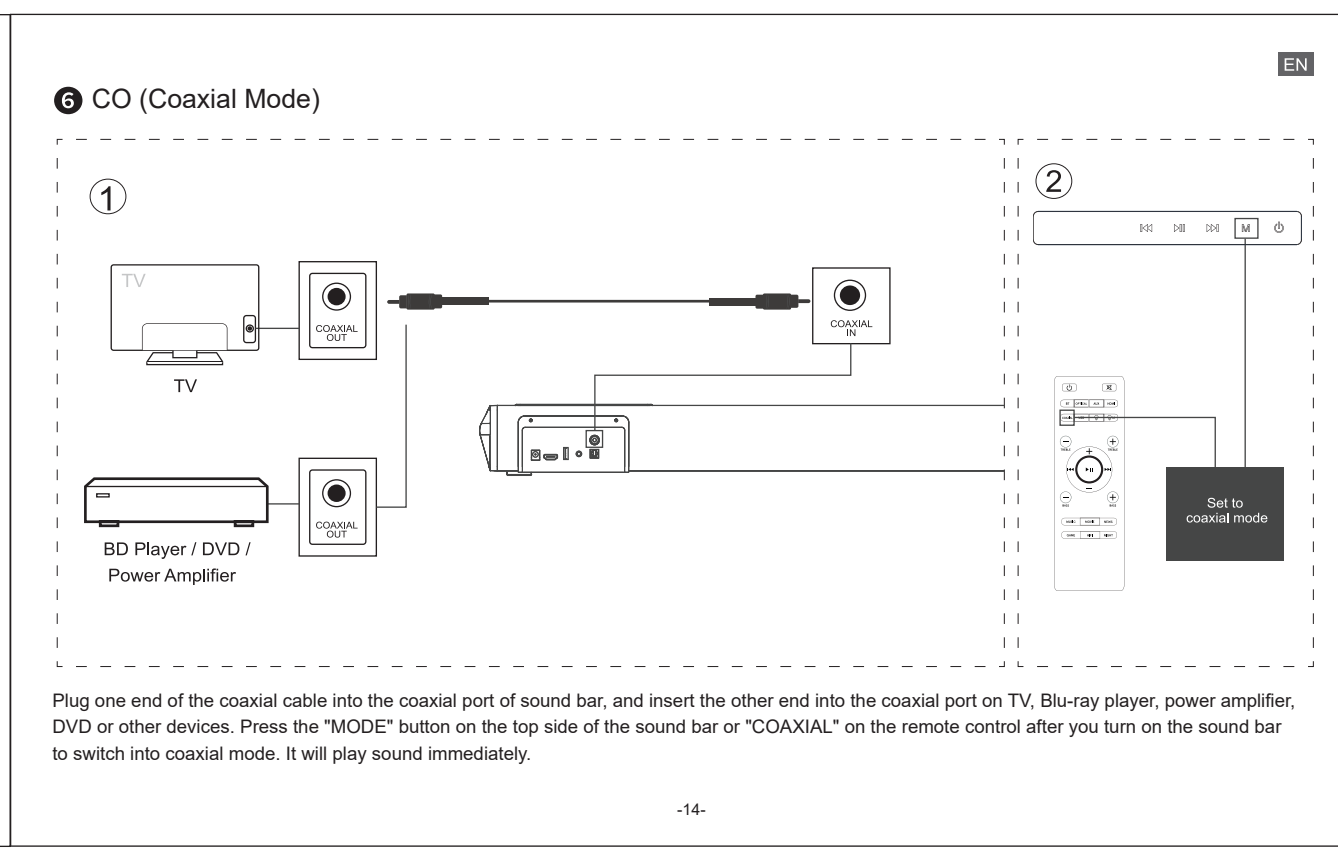
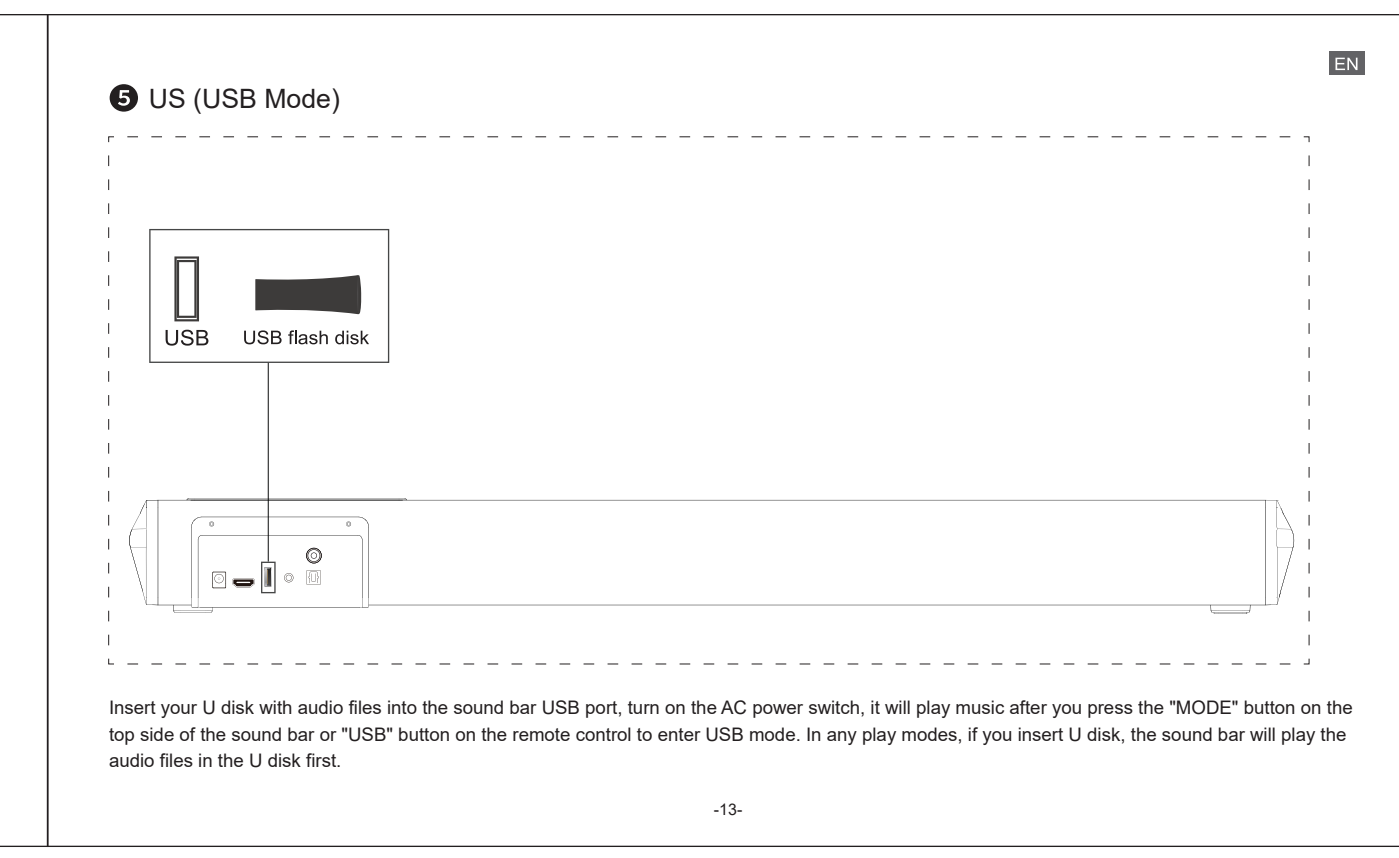
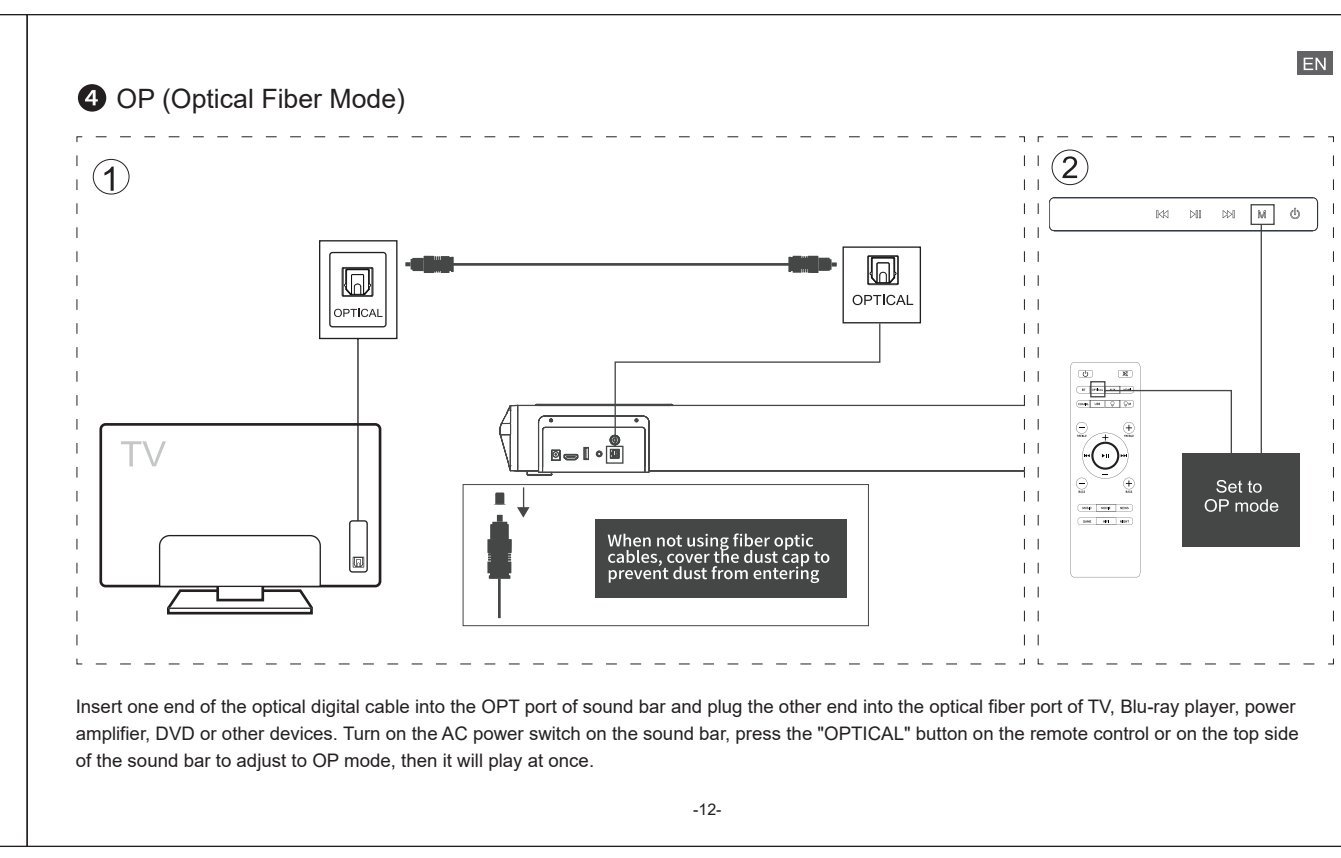
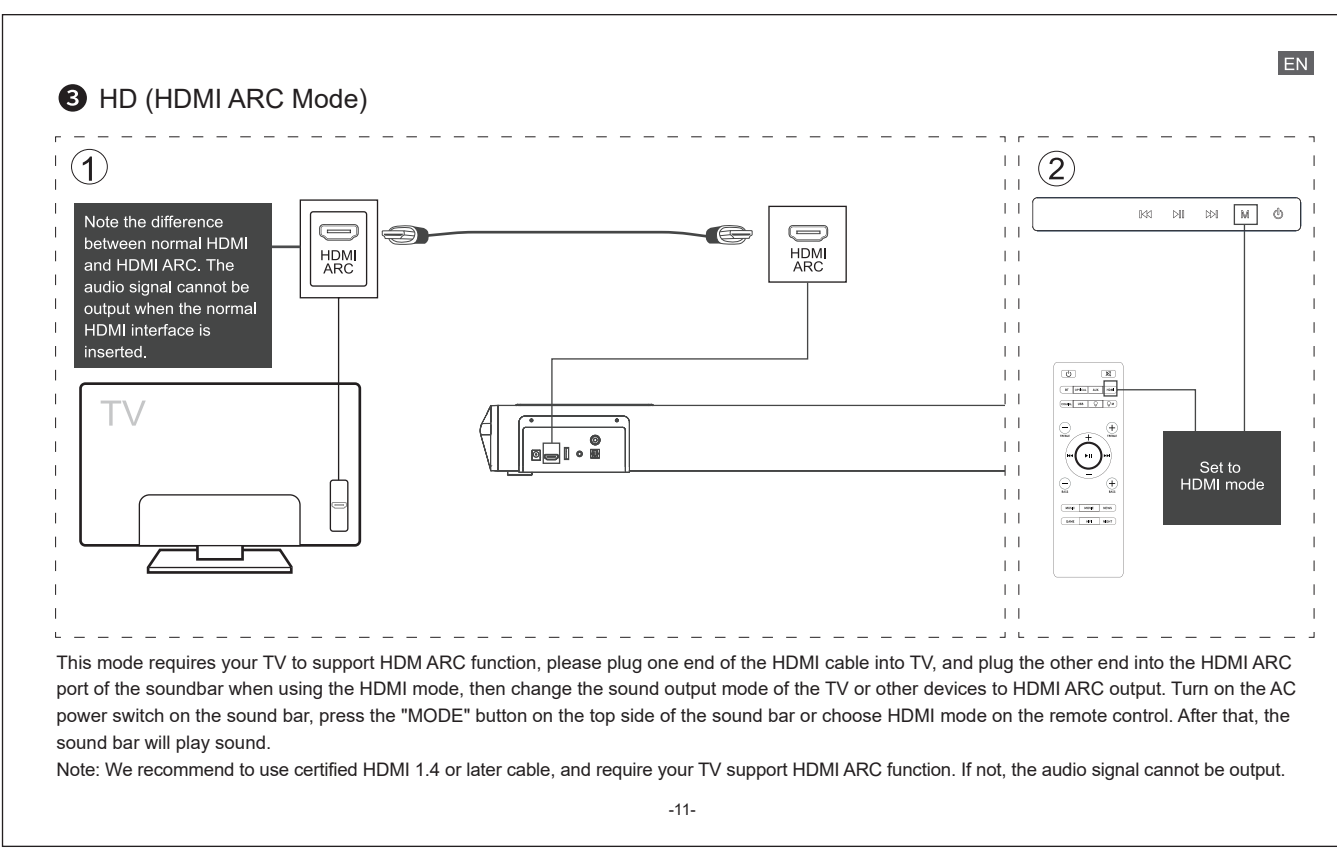
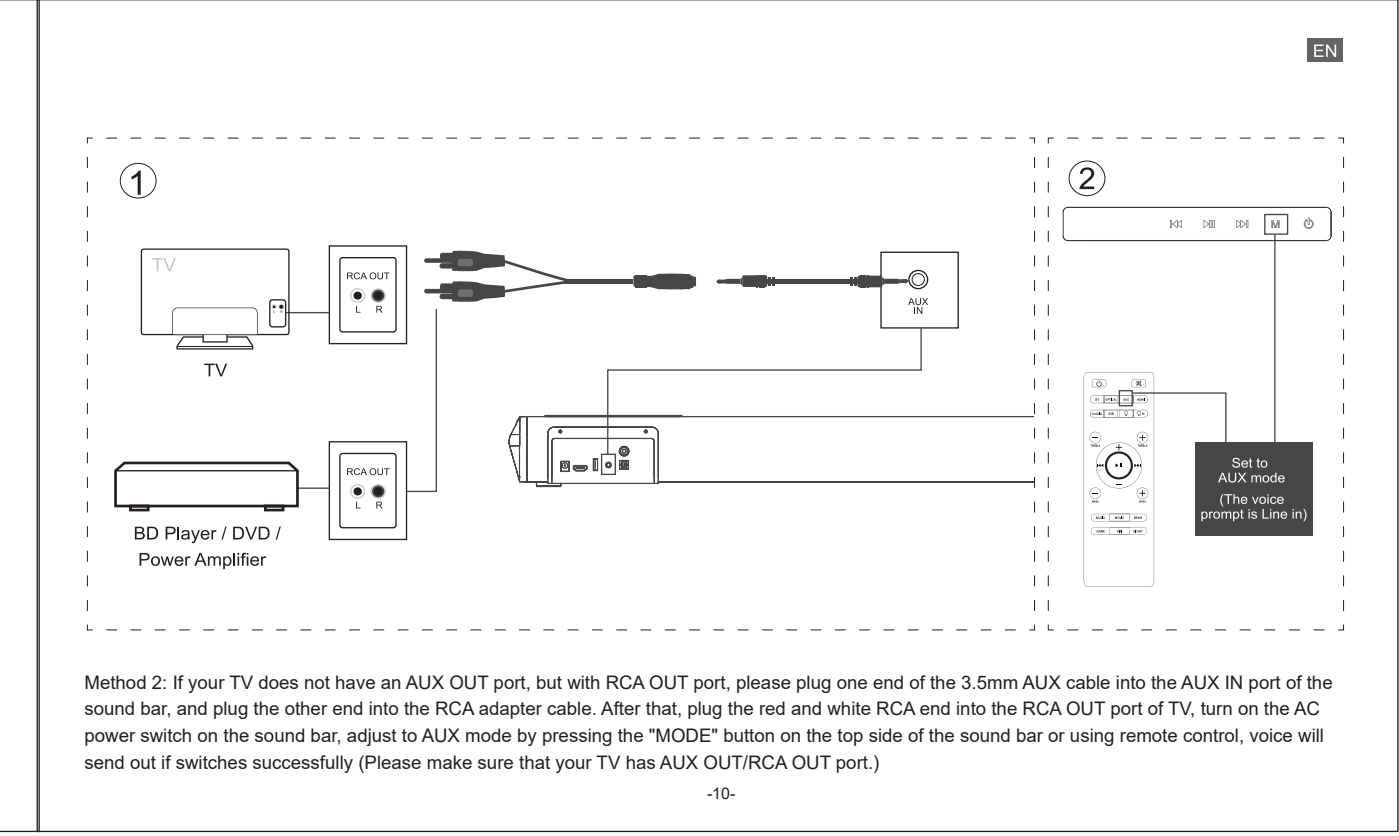
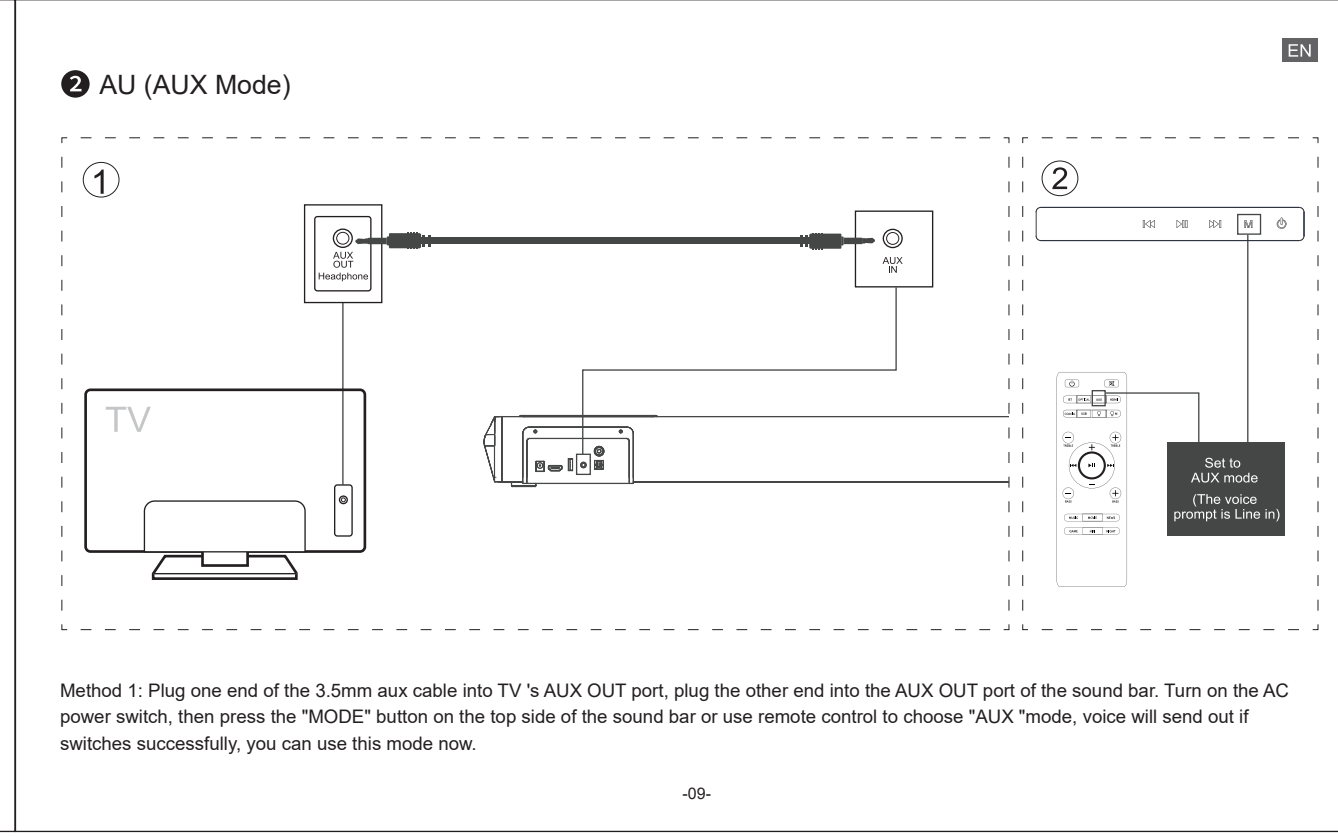
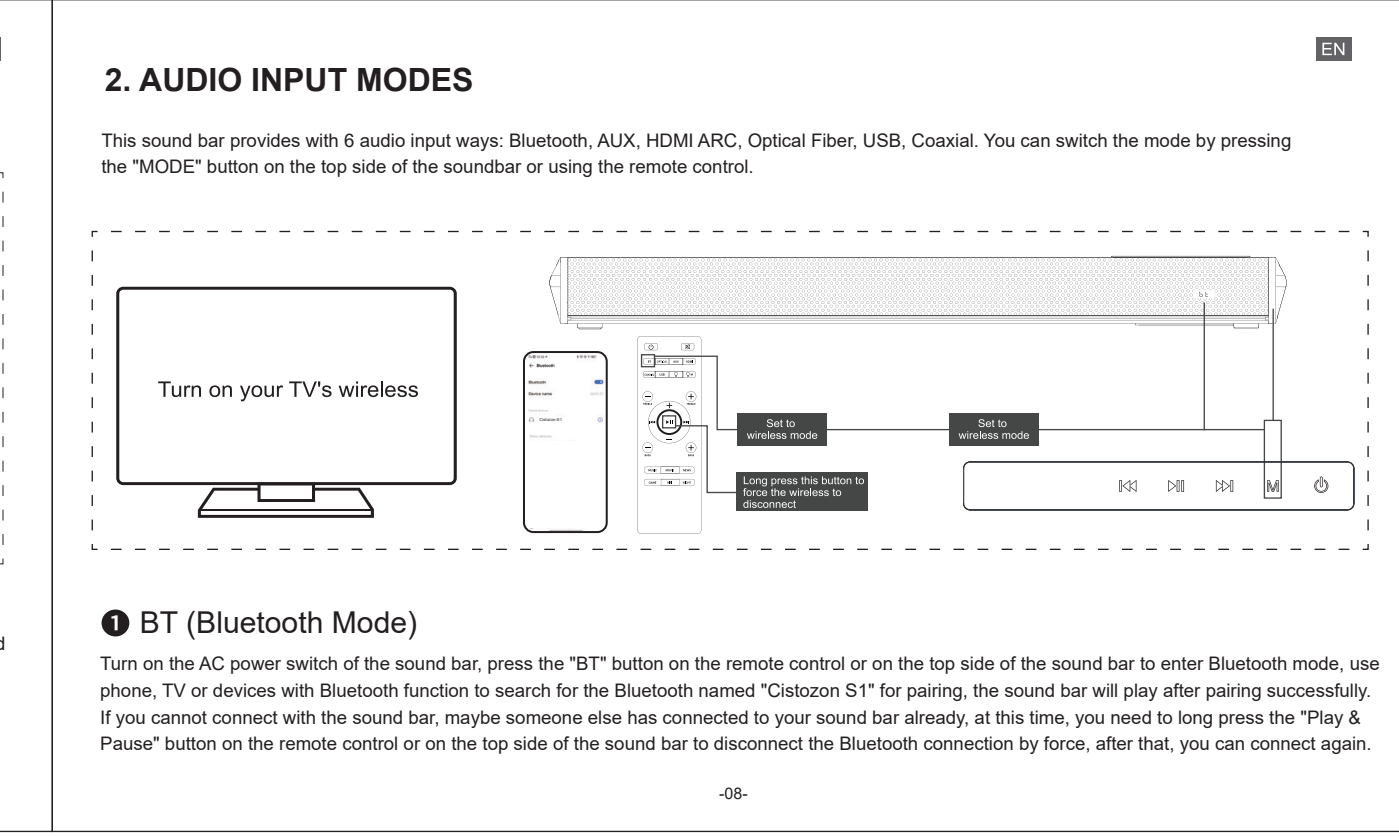

3. FUNCTION KEYS

- 1. Power on/off
- 2. Short press for mode conversion/Long press for Light on/off
- 3. Short press for next song / Long press volume up
- 4. Play & Pause
- 5. Short press for last song / Long press volume down

Connectable Devices: Smart TV, computer, mobile phone, tablet, game console (XBOX), projector, set-top box, MP3, etc.

LED Function: Turn on the power switch on the sound bar, the light is turned on by default, and you can long press "Light" button on the sound bar for 2s to turn off light.

Troubleshooting

Q) Why is there no sound come out after connecting to TV using ARC/Optical (Common)?

A) Please make sure your TV supports ARC output. Then go to "setting" in your TV (may vary due to different brand).

- 1) Setting-Sound>Select (Speaker to: external speaker (optical mode)) turn off TV speaker.
- 2) Setting-Sound(audio)-Advanced Audio-Digital Audio Output-PCM (Setting-Sound(audio)-audio output format-PCM) Dolby off-Please select the correct input mode.

Q) Why is there no sound or noise when watching Netflix, Disney+, Amazon prime (they have sound on smart TV)?

A) If your TV is a smart TV. Apps like Netflix was set default audio output is Dolby and DTS for the movie, but this sound bar does not support Dolby and DTS, so you will hear the crack sound or no sound, please kindly disable the Dolby and DTS on Netflix.

Q) Why can't my wireless device connect to the sound bar?

- A1) You have not enabled wireless on your device or sound bar.
- A2) Maybe someone else has connected to your sound bar already, at this time, you need to long press the "Play & Pause" button on the remote control or on the right side of the sound bar for 3s to disconnect the wireless connection by force.
- A3) When connecting wireless, try not to place routers and other devices next to the sound bar.

Q) Is this compatible with fire TV Firestick?

A) Yes, plug the fire TV to the TV, and connect the TV using any input mode. If using optical or arc please make sure you have followed our manual setting.

Q) Why doesn't the remote control work?

- A1) Double check if the batteries are correctly installed in the battery slot.
- A2) Replace two brand new AAA batteries (Point the remote to the center of the sound bar (R is built in the front of the sound bar)).
- A3) Please check if the positive and negative of batteries is right.
- A4) Please check if the receiving location is blocked.
- A5) The working distance of remote is 6-8m (empty place).

Q) Why is the battery not included?

A) The battery is not included due to Amazon Safety Regulation. We apologize for the inconvenience.

If the issue still exists after you did the above steps, please feel free to contact us on Amazon via e-mail.

FCC warning:

1. This device should be installed and operated with minimum distance 20cm between the radiator&your body.
2. This device complies with part 15 of the FCC Rules. Operation is subject to the following two conditions:
 - (1) This device may not cause harmful interference, and
 - (2) This device must accept any interference received, including interference that may cause undesired operation.
3. Changes or modifications not expressly approved by the party responsible for compliance could void the user's authority to operate the equipment.
4. This equipment has been tested and found to comply with the limits for a Class B digital device, pursuant to part 15 of the FCC Rules. These limits are designed to provide reasonable protection against harmful interference in a residential installation. This equipment generates, uses and can radiate radio frequency energy and, if not installed and used in accordance with the instructions, may cause harmful interference to radio communications. However, there is no guarantee that interference will not occur in a particular installation. If this equipment does cause harmful interference to radio or television reception, which can be determined by turning the equipment off and on, the user is encouraged to try to correct the interference by one or more of the following measures:
 - Reorient or relocate the receiving antenna.
 - Increase the separation between the equipment and receiver.
 - Connect the equipment into an outlet on a circuit different from that to which the receiver is connected.
 - Consult the dealer or an experienced radio/TV technician for help.